

FOR SALE

1685 Target Ct Unit 16

Fort Myers, FL 33905



COMMERCIAL
PROPERTY
SOUTHWEST FLORIDA



Cushman and Wakefield | Commercial Property Southwest Florida is pleased to present this light industrial Condo for sale. The available condo is located in the Landshore Business Condo Association on the cul de sac of Target Ct. Unit 16 doesn't have any weather related damage. Located just off Benchmark Corporate Park, at SR 82, the property offers a prime location with quick access to I-75.

Property Highlights

Address	1685 Target Ct Unit 16 Fort Myers, FL 33905
Sale Price	\$686,925.00
Price/SF	\$225.00
Year built	1982
Condo Dues	\$1,584.64 Quarterly
Unit Size	3,053 sf
Zoning	IL
Parking Ratio	4/1,000 sf

- CBS construction with steel truss roof
- Highly sought after limited inventory for property type
- 14' ground level overhead door
- Prime location just off I-75
- Industrial flex space

Gary Tasman
CEO & Principal Broker
+1 239 489 3600
gtasman@cpswfl.com



Gretchen Smith
Senior Director
+1 239 489 3600
sstoneburner@cpswfl.com



5220 Summerlin Commons Blvd. Suite 500
Fort Myers, FL 33907
239 489 3600
www.cpswfl.com

FOR SALE

1685 Target Ct Unit 16

Fort Myers, FL 33905



CUSHMAN & WAKEFIELD

COMMERCIAL
PROPERTY
SOUTHWEST FLORIDA



Gary Tasman
CEO & Principal Broker
+1 239 489 3600
gtasman@cpswfl.com



Gretchen Smith
Senior Director
+1 239 489 3600
sstoneburner@cpswfl.com



5220 Summerlin Commons Blvd. Suite 500
Fort Myers, FL 33907
239 489 3600
www.cpswfl.com

FOR SALE

1685 Target Ct Unit 16

Fort Myers, FL 33905



COMMERCIAL
PROPERTY
SOUTHWEST FLORIDA

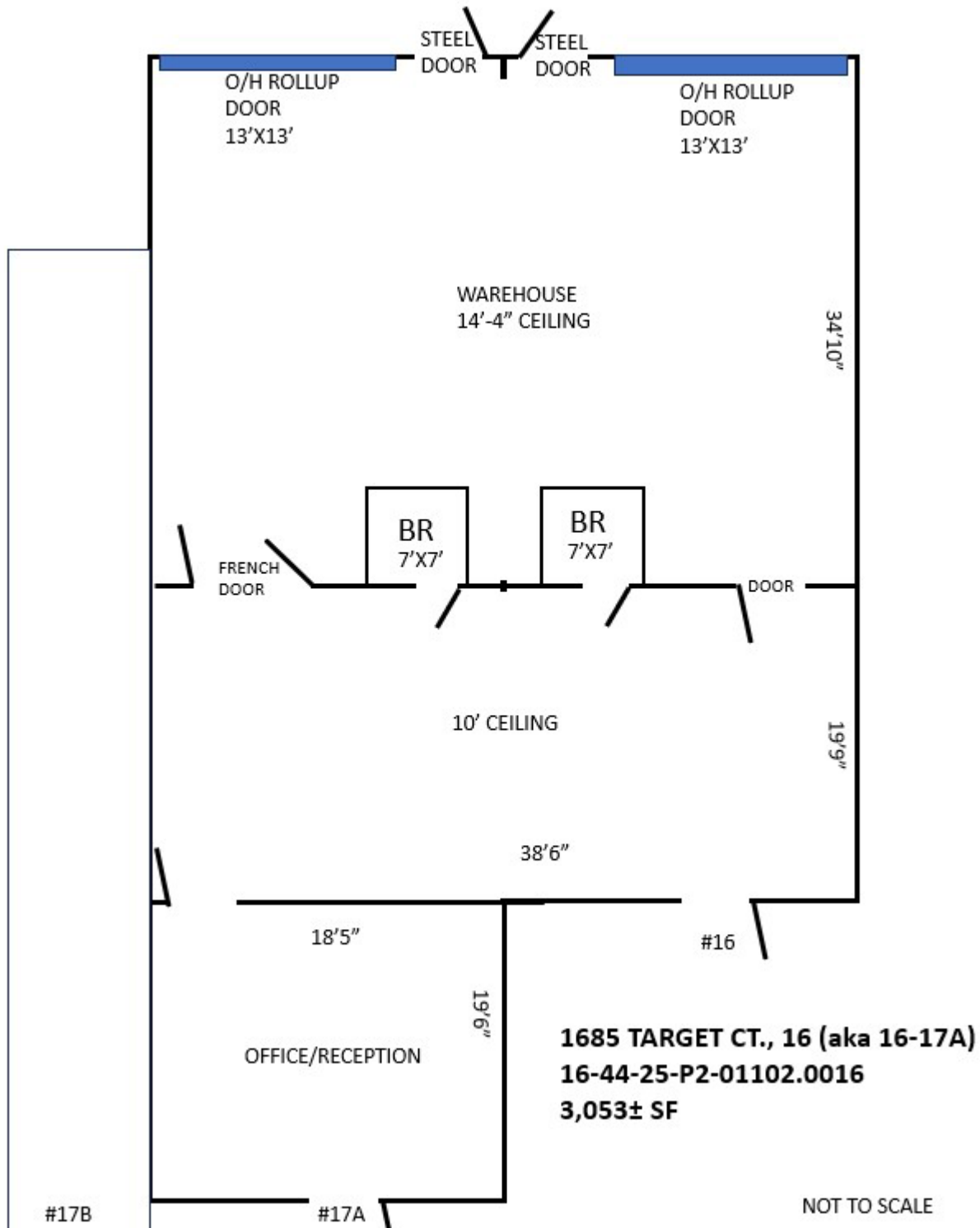

Gary Tasman
CEO & Principal Broker
+1 239 489 3600
gtasman@cpswfl.com



Gretchen Smith
Senior Director
+1 239 489 3600
sstoneburner@cpswfl.com



5220 Summerlin Commons Blvd. Suite 500
Fort Myers, FL 33907
239 489 3600
www.cpswfl.com