

FOR SUBLEASE

Harwood Center

1999 Bryan St | Dallas, Texas



Suite 1100 - 24,901 SF Suite 1200 - 24,901 SF CAN BE DEMISED TO SUIT

Property Highlights

- Class A building in the Dallas CBD
- Fully renovated in 2014
- Located adjacent to the Arts District
- Close proximity to walkable dining and entertainment options, including Klyde Warren Park and other high profile attractions
- Immediate access to the DART, McKinney Avenue Trolley and all major Downtown thoroughfares
- On-site amenities include: fitness center, 24/7 security desk, Tenant lounge, fully stocked wine bar, gaming area, six (6) fully furnished conference rooms, and sundry shop

Contact

MATT HEIDELBAUGH
Executive Managing Director
+1 972 633 9616
matt.heidebaugh@cushwake.com

Building Features

- Rate - \$13.90 FSG + E
- Available immediately
- Expiration - December 31, 2028
- Ample unreserved parking spaces available
- Prominent elevator lobby exposure
- Tenant ready, fully furnished Plug-n-Play sublease
- Large reception area
- Primarily open layout
- Robust infrastructure
- Well-maintained furniture
- Spacious break area
- Beautiful views of the Dallas CBD



[VIDEO TOUR](#)

PEYTON HALL
Associate
+1 817 908 2039
peyton.hall@cushwake.com

Suite 1200 24,901 SF

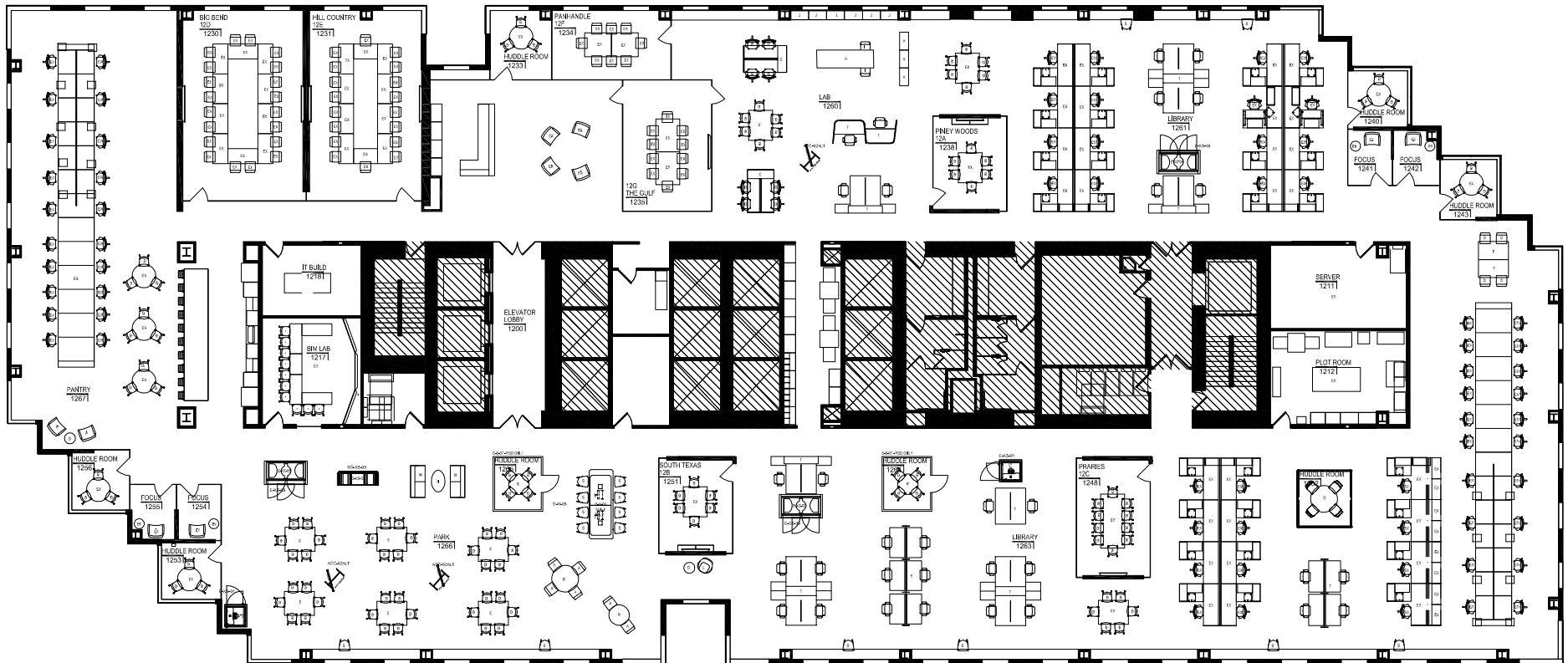

Contact

MATT HEIDELBAUGH
Executive Managing Director
+1 972 633 9616
matt.heidebaugh@cushwake.com

PEYTON HALL
Associate
+1 817 908 2039
peyton.hall@cushwake.com

FOR SUBLEASE
1999 Bryan St | Dallas, Texas



FOR SUBLEASE
1999 Bryan St | Dallas, Texas

