



# FEDERAL

BOSTON, MA



**Boston Realty Advisors** is pleased to present **up to 6,758 SF for lease** at 50 Federal Street. Located in the heart of Boston's Financial District, this 70,000 square foot, 10-story building overlooks the award-winning Post Office Square Park and is only steps away from countless amenities such as retail, dining, public transportation and parking.

The property is owned and managed by The Druker Company, Ltd.

Lobby  
Attendant

On-site property  
management/ownership

Commuter Rail & Amtrak  
at South Station

Red, Green & Orange T Lines  
at Downtown Crossing

Steps to several  
parking garages

Dunkin Donuts, Starbucks,  
Sweetgreen and a wide  
variety of other eateries.

## SPECIFICATIONS

**Building Size** 66,445 SF on 10 Floors

**Available Space** **Mezzanine:** 3,500 SF

**2nd Floor:** 1,950 SF | [Video Tour](#)  
2,315 SF  
2,461 SF

5,555 SF — **3rd Floor:** 3,094 SF | [Video Tour](#)

**4th Floor:** 6,758 SF | Available 2/1/26

**5th Floor:** 1,925 SF

**8th Floor:** 2,528 SF  
2,621 SF

**Lease Term** 3–5 Years

**Lease Rate** \$38-39/SF

# FLOOR PLANS

## 2<sup>ND</sup> FLOOR

1,950 SF | 2,315 SF | 2,461 SF

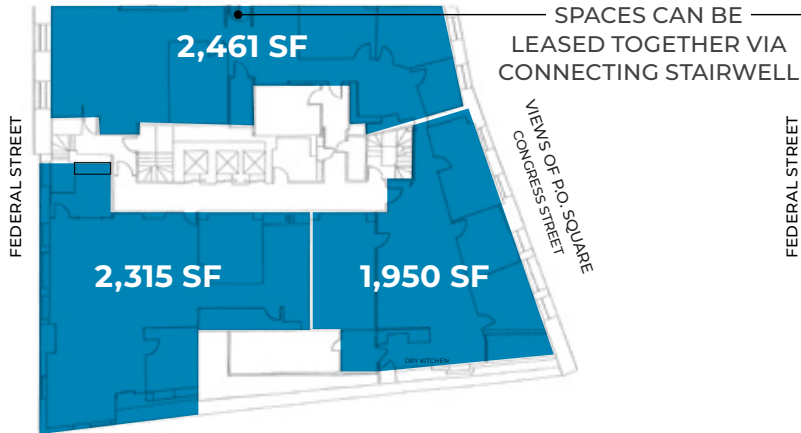

## 3<sup>RD</sup> FLOOR

3,094 SF

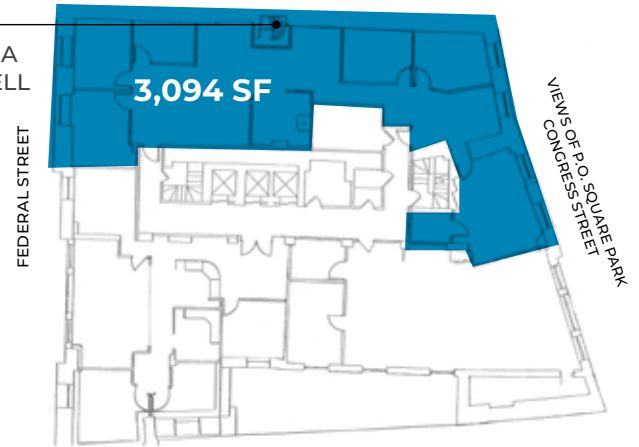

## 4<sup>TH</sup> FLOOR

6,758 SF

AVAILABLE 2/1/26

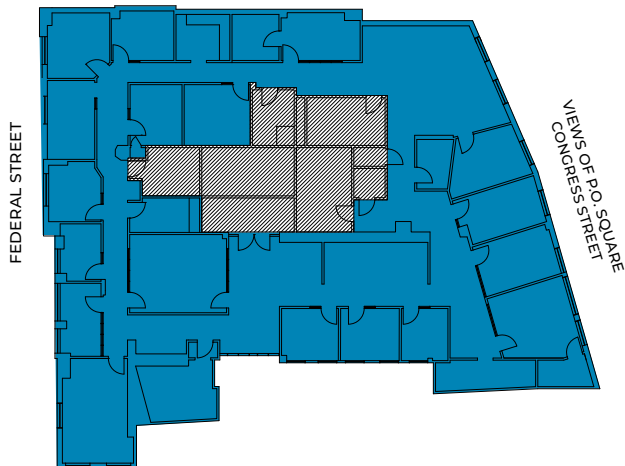

## 5<sup>TH</sup> FLOOR

1,925 SF

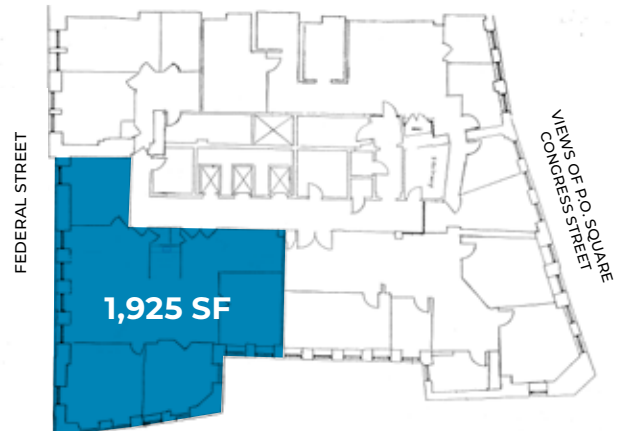

## 8<sup>TH</sup> FLOOR

2,528 SF | 2,621 SF

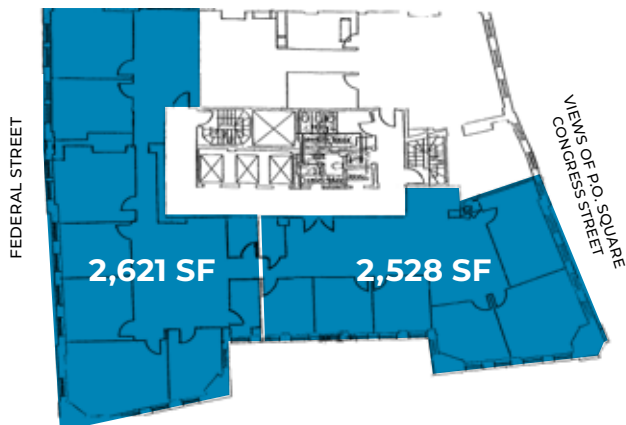



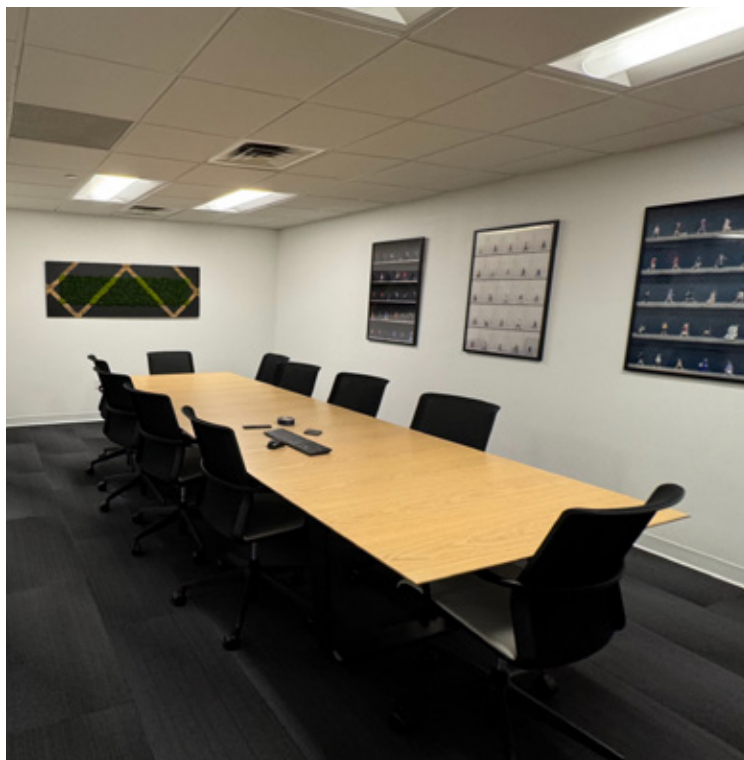

**BONNY L. DOORAKIAN**  
617.850.9655  
bdoorakian@bradvisors.com

136 Newbury Street | Boston, MA | 617.375.7900 | BRAdvisors.com

© Copyright Boston Realty Advisors. All rights reserved. The information contained here has been obtained through sources deemed reliable but cannot be guaranteed as to its accuracy. Any information of special interest should be obtained through independent verification.