

# TOK

COMMERCIAL

# VALLEY RIVER CENTER

RETAIL SPACES FOR LEASE | 125 VALLEY RIVER DRIVE | REXBURG, ID



LOCATED OFF MAJOR CORRIDOR

3,000 - 16,300 SF FOR LEASE

29,902 VPD  
N12ND E

CONTACT

**BRENT WILSON, CLS**

brent@tokcommercial.com  
208.656.2270

**BRIAN WILSON, CCIM**

brian@tokcommercial.com  
208.656.2271



HIGHLIGHTS

Hotel Pad for Sale – Contact Agent for Details.

Prime retail, office or call center location just north of the BYU-Idaho Campus and Madison Memorial Hospital.

Full-movement access via Rexburg’s primary arterial street (transit route).

Pylon signage and ample off-street parking.

Adjacent retailers include Albertsons, Harbor Freight Tools, Advance Auto Parts and many others.

DETAILS

SPACE	AVAILABLE SIZE	CONTACT AGENT FOR LEASE RATES
Building A	3,000 - 16,300 SF	
Building C	3,097 SF	
Hotel Pad	2.152 Acres	
Building B	Leased!	

UPDATED: 10.25.2024

THIS PROPERTY IS EXCLUSIVELY MARKETED BY TOK EASTERN IDAHO LLC DBA TOK COMMERCIAL

This information was obtained from sources believed reliable but cannot be guaranteed. Any opinions or estimates are used for example only.

TOKCOMMERCIAL.COM

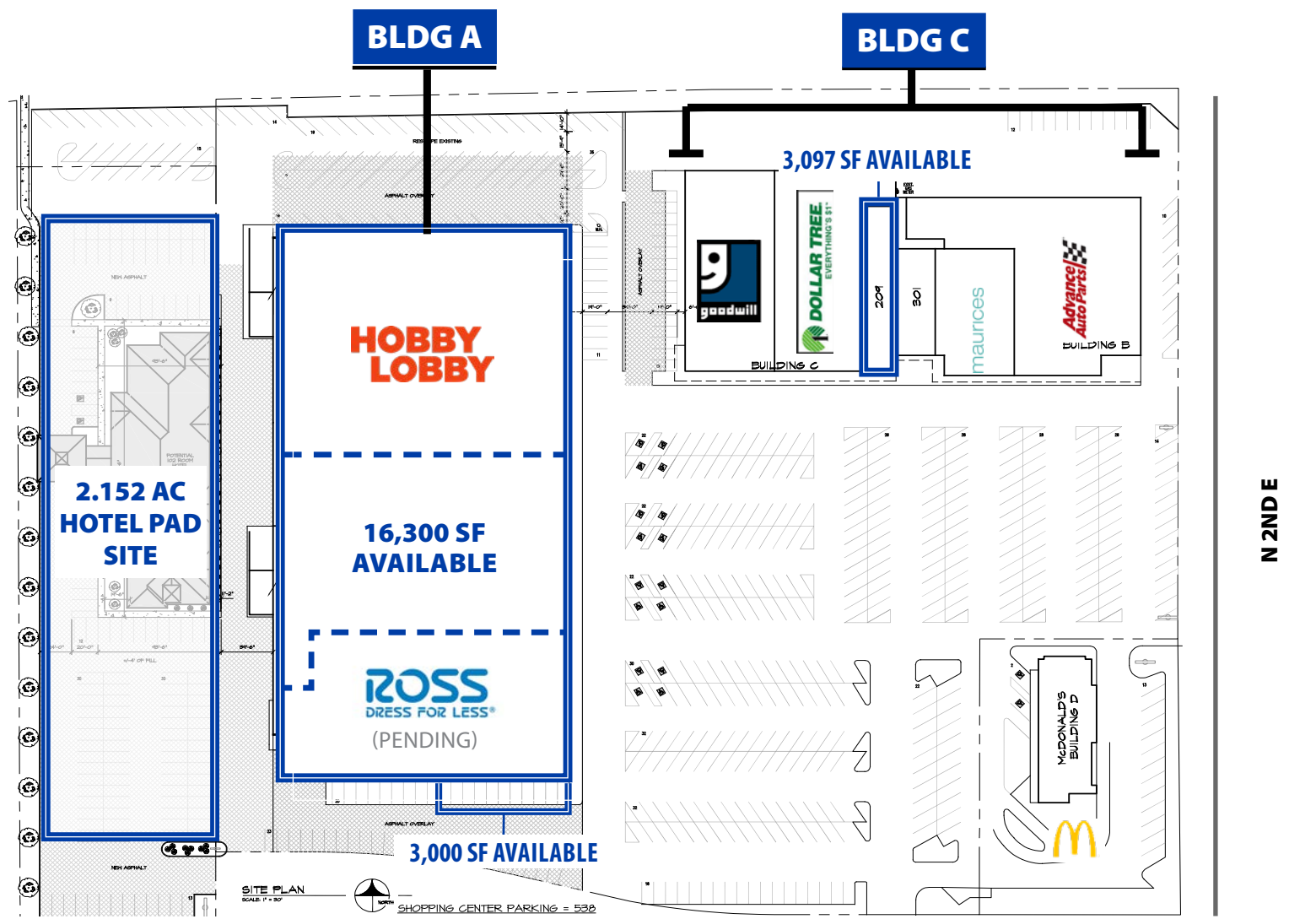

# SITE PLAN

UPDATED: 10.25.2024

THIS PROPERTY IS EXCLUSIVELY MARKETED BY TOK, EASTERN IDAHO LLC DBA TOK COMMERCIAL  
This information was obtained from sources believed reliable but cannot be guaranteed. Any opinions or estimates are used for example only.





**3,097 SF**  
BLDG C

**16,300 SF**  
BLDG A

**N 2NDE**

**29,902 VPD**

**3,000 SF**  
BLDG A

**2.152 AC**  
HOTEL PAD SITE

**MAJOR THOROUGHFARE**  
FROM YELLOWSTONE HWY



Hibbard



POPULATION  
**49,722**  
5 MI. RADIUS



HISTORIC ANN. GROWTH  
**4.5%**  
5 MI. RADIUS



AVG. HOUSEHOLD INC.  
**\$93,284**  
5 MI. RADIUS



**REXBURG**



UPDATED: 10.25.2024

THIS PROPERTY IS EXCLUSIVELY MARKETING BY TOK EASTERN IDAHO LLC DBA TOK COMMERCIAL  
This information was obtained from sources believed reliable but cannot be guaranteed. Any opinions or estimates are used for example only.