

OFFICE CONDO FOR SALE

PRENTICE PLACE

8301 E. PRENTICE AVENUE, GREENWOOD VILLAGE, CO 80111



PROPERTY DETAILS

AVAILABLE	Suite 300 & 307: 5,158 SF
SALE PRICE	\$1,289,500.00 (\$250.00 / SF)
PROPERTY TAXES	\$24,877.50 (Estimate)
ASSOCIATION DUES	\$3,923.00 / Month
PARKING	2.95:1,000
BUILDING SIZE	25,802 SF
Y.O.C.	1974 - Suite Remodeled 2022
ZONING	Office
CITY / COUNTY	Greenwood Village / Arapahoe

PROPERTY FEATURES

- Premier 5,158 SF Recently Renovated Office Condo in the Heart of the Denver Tech Center
- Fully Built-Out Counselor's Office
- Flexible Seller
- Option to Buy with a Lease-Back to Seller
- Reserved & Unreserved Covered / Uncovered Parking
- Updated Common Area & Suite Finish
- Prime Location with Excellent Access
- Easy Access to I-25, Belleview Ave., DTC Blvd. & I-225
- Conveniently Located Near Ample Amenities Including Restaurants, Retail & Hotels in the Denver Tech Center

2023 DEMOGRAPHICS

Radius	Population	Avg. HH Income	Home Value
2 Mile	39,469	\$125,802	\$630,210
5 Mile	258,522	\$116,601	\$475,244
10 Mile	1,141,227	\$112,233	\$449,677

TRAFFIC COUNTS

Vehicles Per Day (VPD)
Approx. 11,900 VPD on Prentice Ave. & DTC Pkwy.
Approx. 20,500 VPD on DTC Blvd. & E. Crescent Pkwy.
Approx. 104,000 VPD along I-25 at E. Belleview Ave.

TREVEY COMMERCIAL
 10510 Dransfeldt Rd, Suite 100
 Parker, Colorado 80134
 303-841-1400 | www.trevey.com

NICK BEACH
 V.P. Sales & Leasing
nbeach@trevey.com
 C: 719-237-0880

MITCH TREVEY
 Managing Director
mitch@trevey.com
 C: 303-619-7192

SUITE LAYOUT

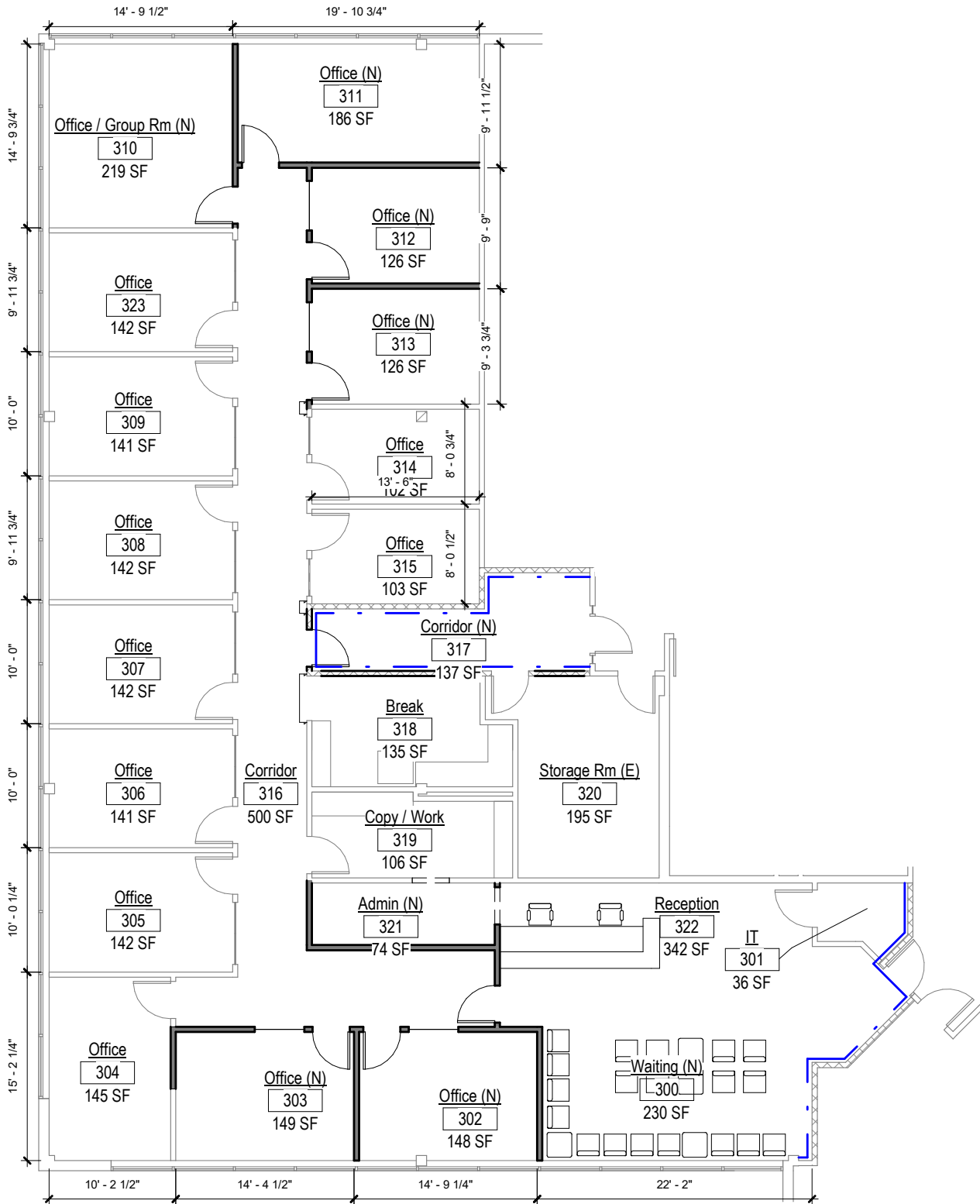

TREVEY COMMERCIAL
 10510 Dransfeldt Rd, Suite 100
 Parker, Colorado 80134
 303-841-1400 | www.trevey.com

NICK BEACH
 V.P. Sales & Leasing
 nbeach@trevey.com
 C: 719-237-0880

MITCH TREVEY
 Managing Director
 mitch@trevey.com
 C: 303-619-7192

[CLICK HERE TO DOWNLOAD CREC BROKERAGE DISCLOSURE](#)

Information contained herein, while not guaranteed, is from sources believed reliable. Price, terms and information subject to change. Please call to confirm current property status and accuracy of information contained herein.