



FOR LEASE

1125 S Blackhawk Blvd. Suites A-C
Mt. Pleasant, UT 84647

PROPERTY INFORMATION

- 600 - 1,600 SF Available
 - Main Level, Suite A: 600 SF
 - Main Level, Suite B: 1,000 SF
 - Second Level, Suite C: 1,300 SF
- Suite A & B: 6 Exam/office rooms, breakroom & reception area
- Suite C: 4 Private offices
- Medical/office space
- Main level suites may be combined
- Excellent HWY-89 visibility

Please contact agent for lease rate

CONTACT US

Cameron Fairbanks

Associate
+1 801 368 9146
cameron.fairbanks@colliers.com

Justin Irvine

Vice President
+1 801 400 4260
justin.irvine@colliers.com

Colliers

2100 Pleasant Grove Blvd., Suite 200
Pleasant Grove, UT 84062
Main: +1 801 947 8300
colliers.com

MT. PLEASANT OFFICE FOR LEASE

PHOTO GALLERY



Floor Plan

MAIN FLOOR

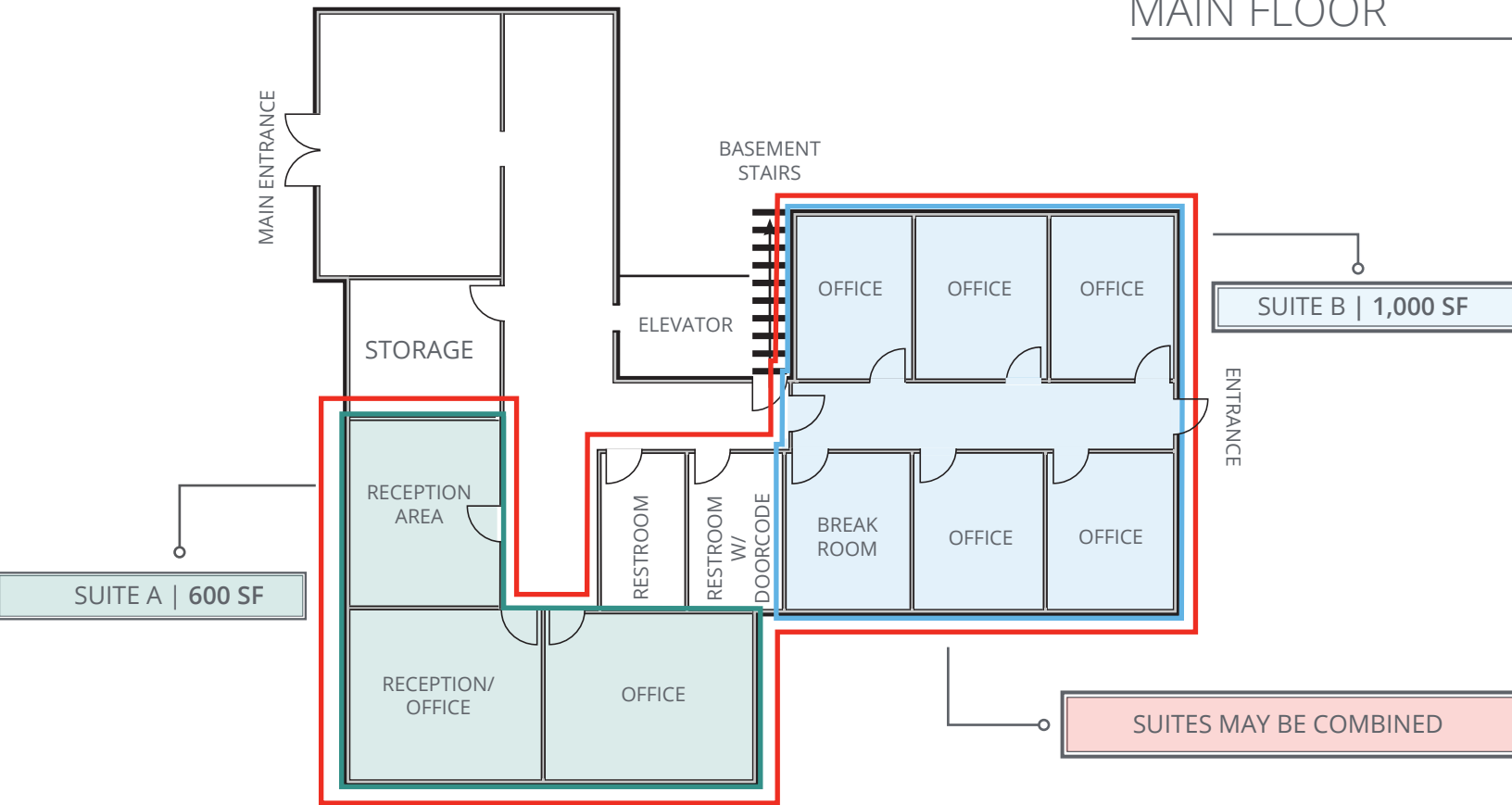

SECOND FLOOR

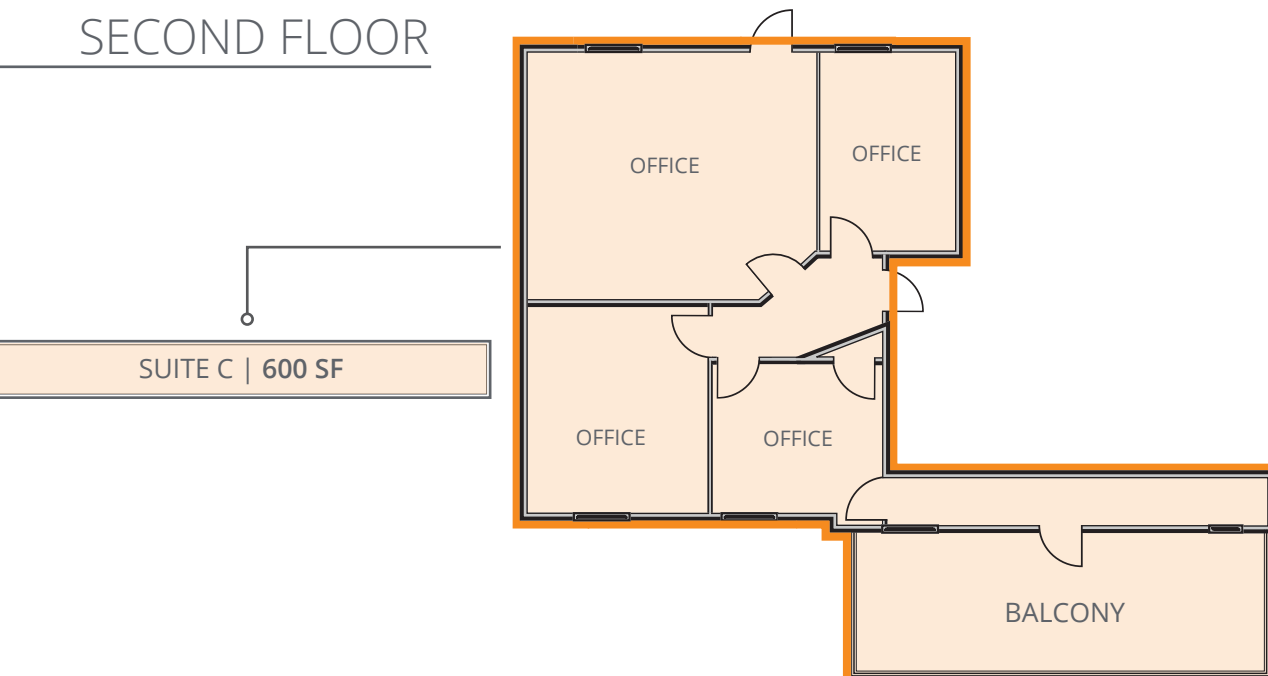



SITE

Mt. Pleasant Office Building | For Lease

Aerial Map



Colliers
2100 Pleasant Grove Blvd., Suite 200
Pleasant Grove, UT 84062
Main: +1 801 947 8300
colliers.com

Cameron Fairbanks
Associate
+1 801 368 9146
cameron.fairbanks@colliers.com

Justin Irvine
Vice President
+1 801 400 4260
justin.irvine@colliers.com

This document has been prepared by Colliers International for advertising and general information only. Colliers International makes no guarantees, representations or warranties of any kind, expressed or implied, regarding the information including, but not limited to, warranties of content, accuracy and reliability. Any interested party should undertake their own inquiries as to the accuracy of the information. Colliers International excludes unequivocally all inferred or implied terms, conditions and warranties arising out of this document and excludes all liability for loss and damages arising there from. This publication is the copyrighted property of Colliers International and/or its licensor(s). ©2026. All rights reserved.