

**ADD'L WAREHOUSE AND/OR
OUTSIDE STORAGE POSSIBLE**

1610 GARDEN OF THE GODS RD

FOR LEASE

**4,377 SF OF OFFICE/FLEX
FROM \$10.50 NNN YEAR 1**



Scan For

Virtual Tour

Office/Flex

- HIGH CEILINGS
- EXPOSED DUCTWORK
- ABUNDANT GLASS
- OPEN LANDSCAPE
- PRIVATE OFFICE
- CONFERENCE ROOM
- FROM \$10.50 NNN YEAR 1

CORE
COMMERCIAL
BROKERAGE CO.

MIKE HELWEGE
PRINCIPAL
+1.719.668.6811
MIKE@CORECOMMBC.COM

PARKER CURRY,
ASSOCIATE
+1.719.337.1367
PARKER@CORECOMMBC.COM



LOCATION

North side of Garden of the Gods, W of Centennial

ZONING

PIP 1 HS

AVAILABLE SPACE

4,377 SF OFFICE/FLEX WITH POTENTIAL FOR WAREHOUSE SPACE AND/OR OUTSIDE STORAGE

BUILDING

Built in 1979

CONSTRUCTION

Metal/Concrete Panels

LEASE RATE

From \$10.50 NNN Year 1

EXPENSES

\$2.76/SF excluding utilities and in-suite janitorial

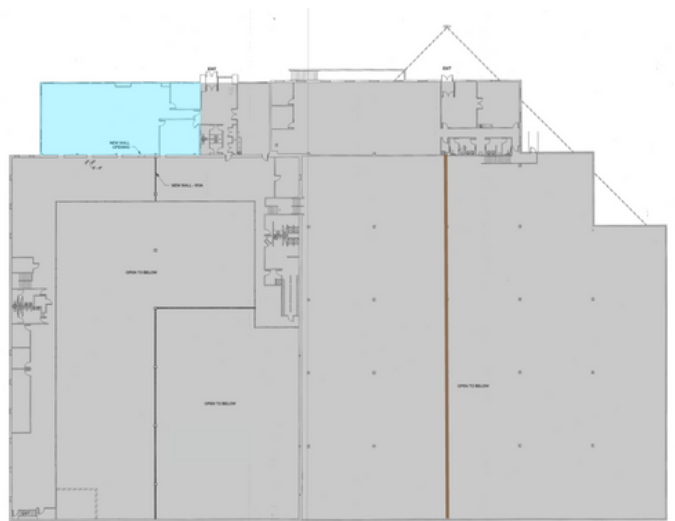

FOR MORE INFORMATION, PLEASE CONTACT:



MIKE HELWEGE
PRINCIPAL
+1.719.668.6811
MIKE@CORECOMMBC.COM

PARKER CURRY,
ASSOCIATE
+1.719.337.1367
PARKER@CORECOMMBC.COM