

FOR LEASE | 9,993 SF Office Space, Divisible

100 Bull Street, Suite 301

The Altmayer Building • Downtown • Savannah, Georgia



ESTD 100 1885
BULL STREET
ALTMAYER BUILDING

ASKING RATE
\$36.00 PSF Full Service

MORE INFORMATION:

John Gilbert, CCIM
Partner

T +1 912 547 4464

jgilbert@gilbertezelle.com

FLOOR PLAN

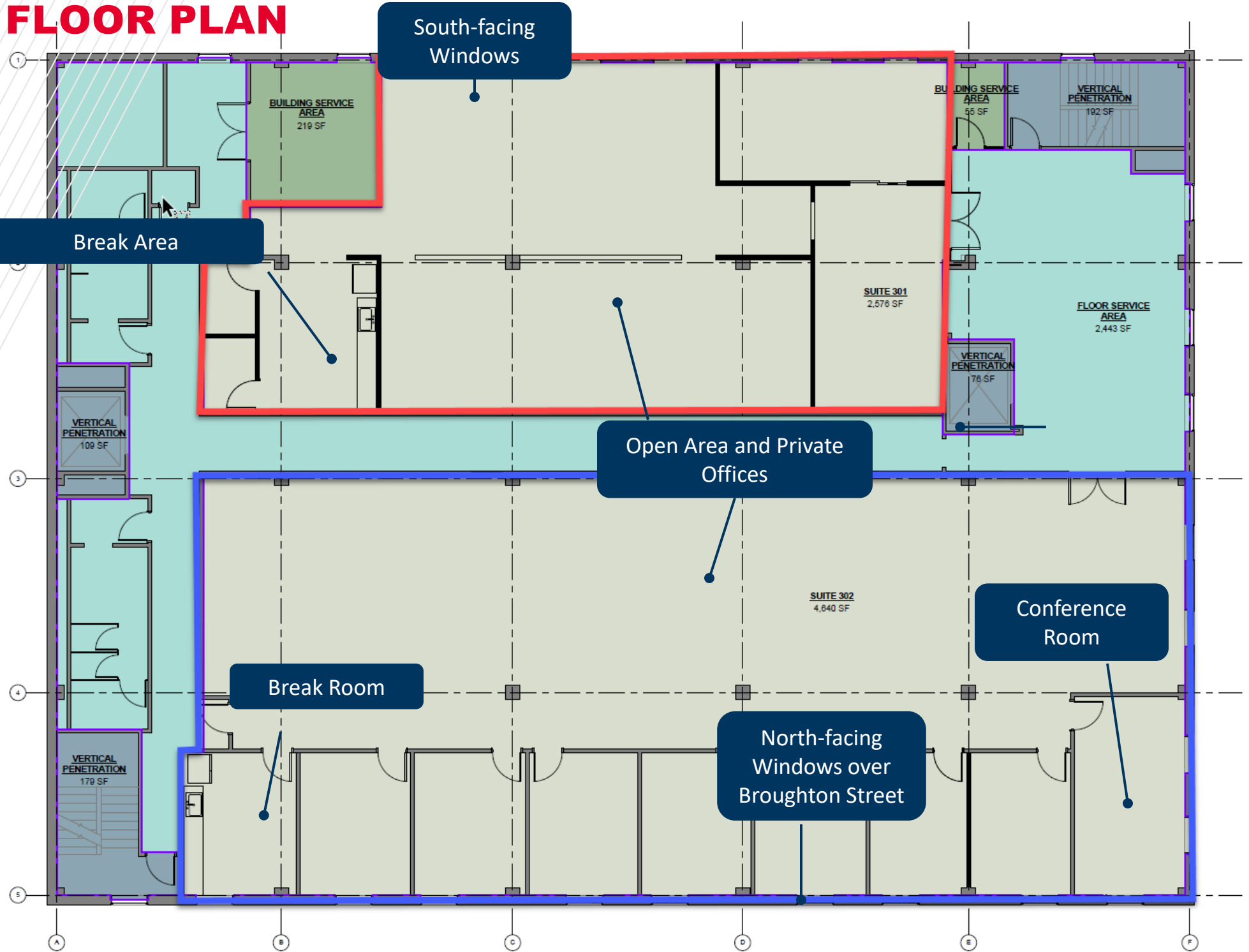

CLASS A OFFICE BUILDING • GREAT CBD LOCATION

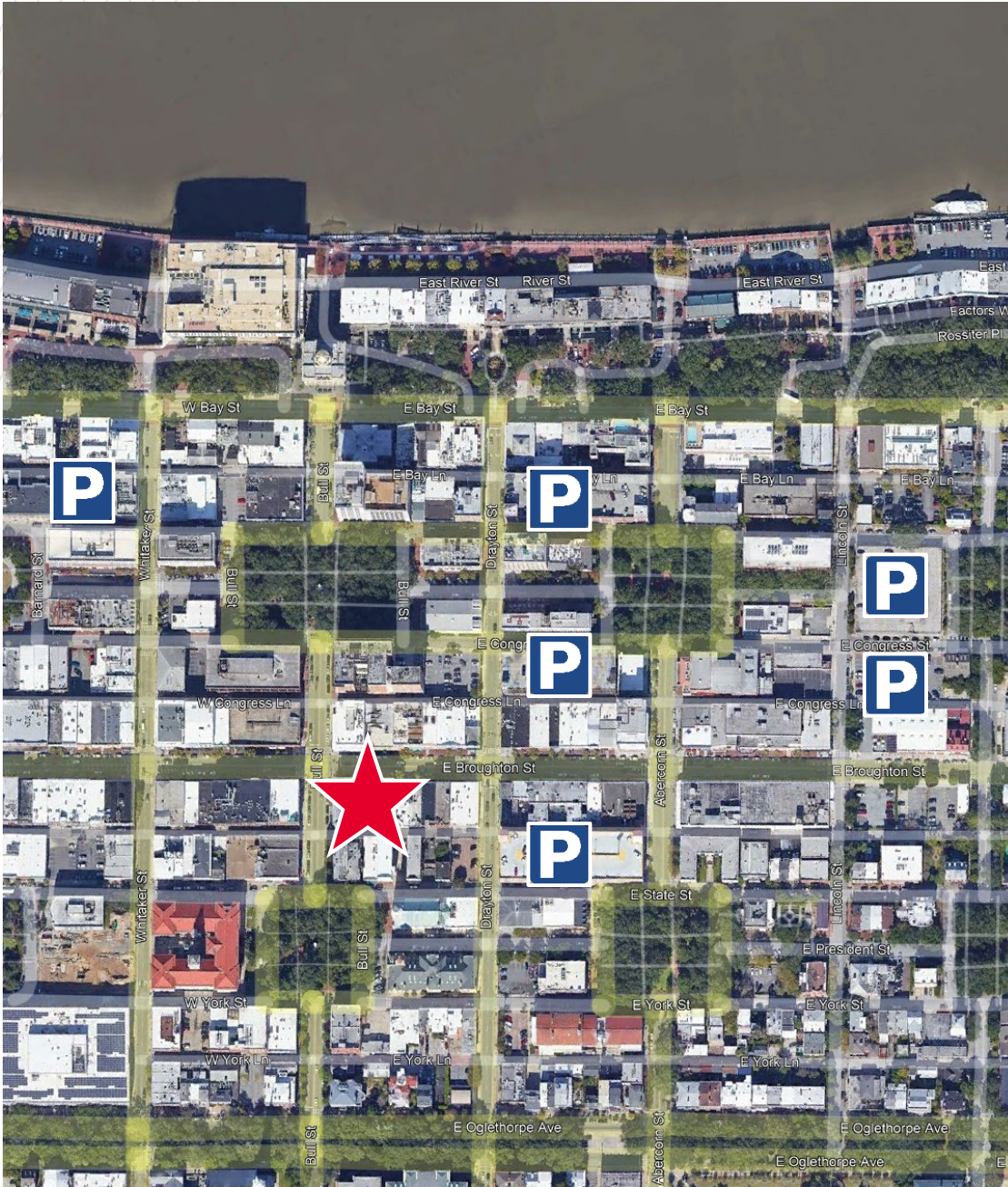

- Class A Office Space in Historic Building in Savannah's Landmark Historic District
- Located at primary corner in downtown Savannah, Broughton and Bull Streets
- Surrounded restaurants, shopping, hotel/hospitality, and the beauty of Savannah's historic squares
- Full 9,993 RSF Floor or Individual Suites of 3,564 or 6,387 RSF

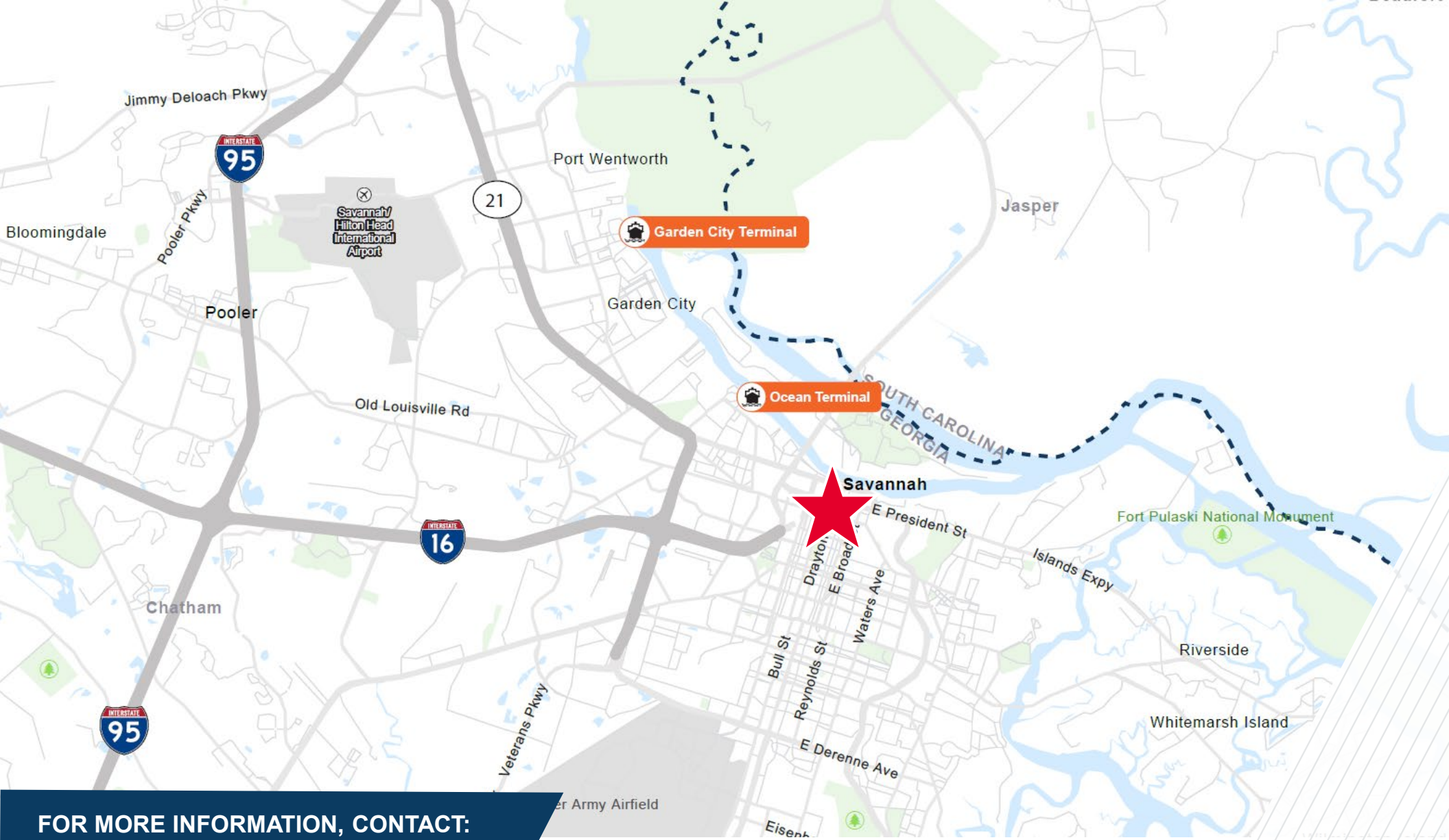

FOR MORE INFORMATION, CONTACT:

John Gilbert, CCIM
Partner
T +1 912 547 4464
jgilbert@gilbertezelle.com

Cushman & Wakefield | Gilbert & Ezelle
820 Abercorn Street
Savannah, GA 31401
www.gilbertezelle.com

