



WEWORK AT

Lantana

3000 OLYMPIC BOULEVARD
SANTA MONICA, CA

wework

© 2021 WeWork

Lantana at a glance

1
TOTAL WEWORK BUILDINGS

2
WEWORK FLOORS

43,596
RSF TOTAL

38,142
USF TOTAL



Creative Office Campus in the Entertainment, Media and Tech Heart of Santa Monica

BUILDING OVERVIEW

Lantana is in the heart of Santa Monica’s Media District. Built in 1959 with exterior renovations in 2006, WeWork has fully re-imagined these two buildings within the project. Formerly home to George Lucas’ Skywalker Sound, Todd-AO, and Digital Magic, Lantana is WeWork’s latest and greatest iteration of flexible office space, breathing new life into the campus with post-production and media specific fit-outs.

Designed for efficiency, collaboration, and productivity

In addition to WeWork’s full suite of amenities and perks—from super-fast WiFi to 24/7 security—Lantana members will be able to enjoy an outdoor balcony space, multiple courtyards, bathrooms and showers, screening rooms, large classroom breakout areas, phone booths, and a multitude of conference rooms. Looking for something in particular? Our onsite staff members will be sure to point members in the right direction.

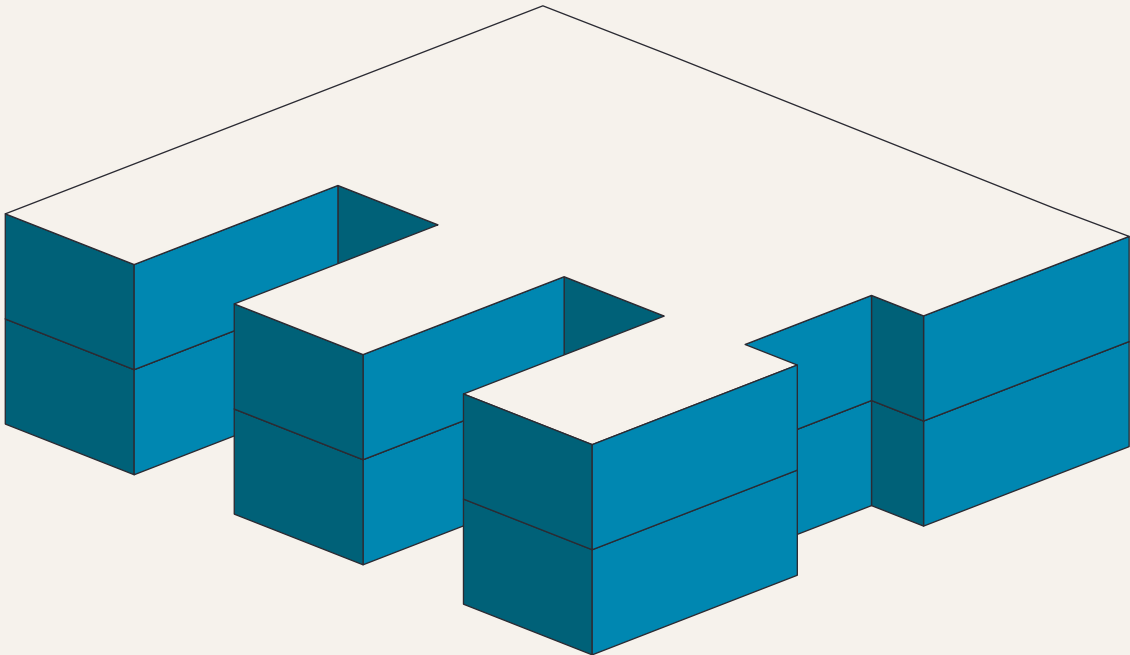

WEWORK FOOTPRINT

FLOOR	RSF
<u>BUILDING 4</u>	
1	21,560
2	22,036

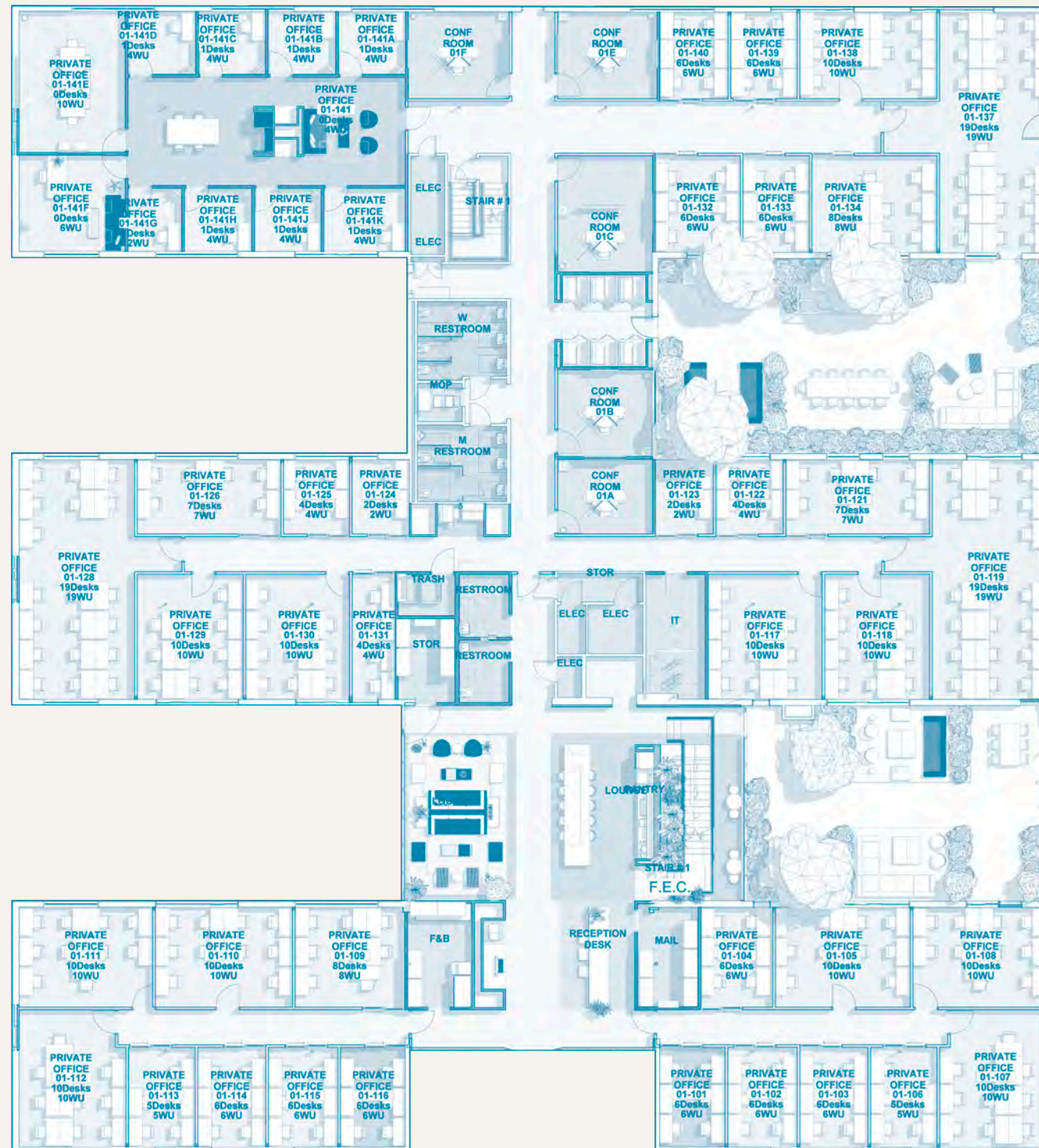

Building 4

1st Floor

21,560 RSF

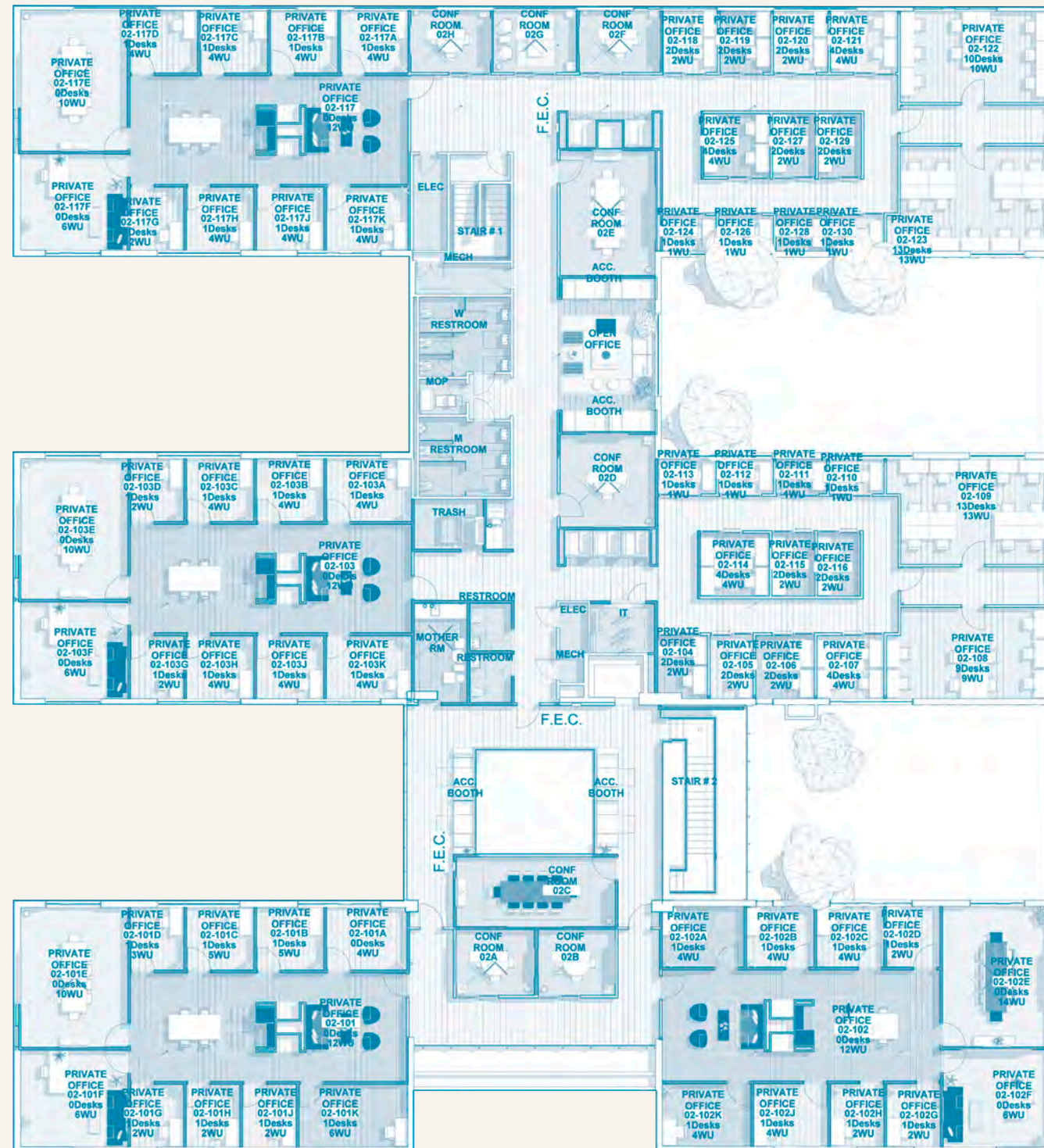

Building 4 2nd Floor

22,036 RSF

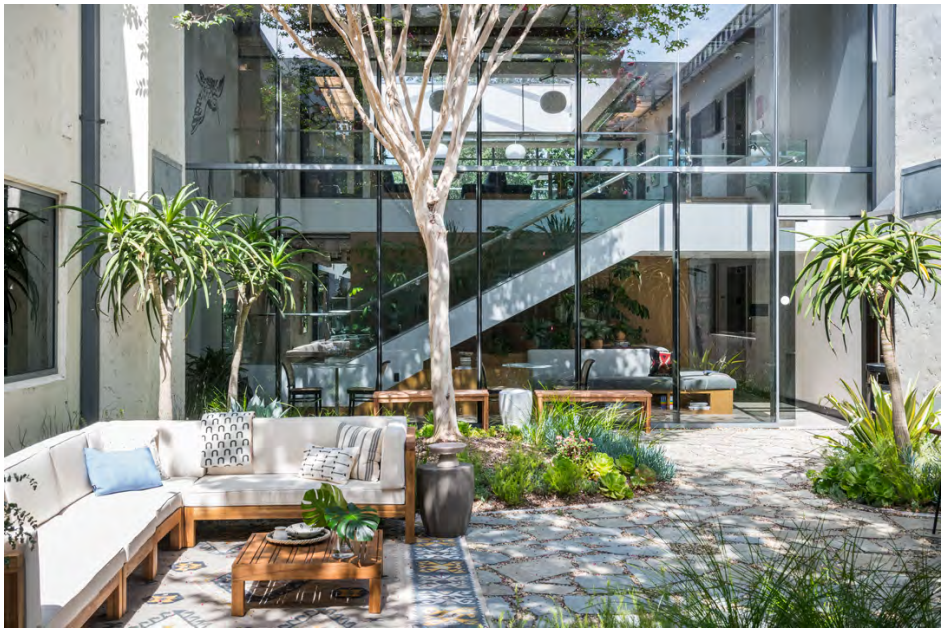

The city at your doorstep

Perched in the middle of Santa Monica, the location is accessible with several transit options nearby. In addition to its proximity to classic Santa Monica landmarks like the Santa Monica Pier and Third Street Promenade, Lantana is also close to restaurants and bars including Bluey’s Kitchen and Lime Cafe—perfect for business lunches or post-work happy hours.

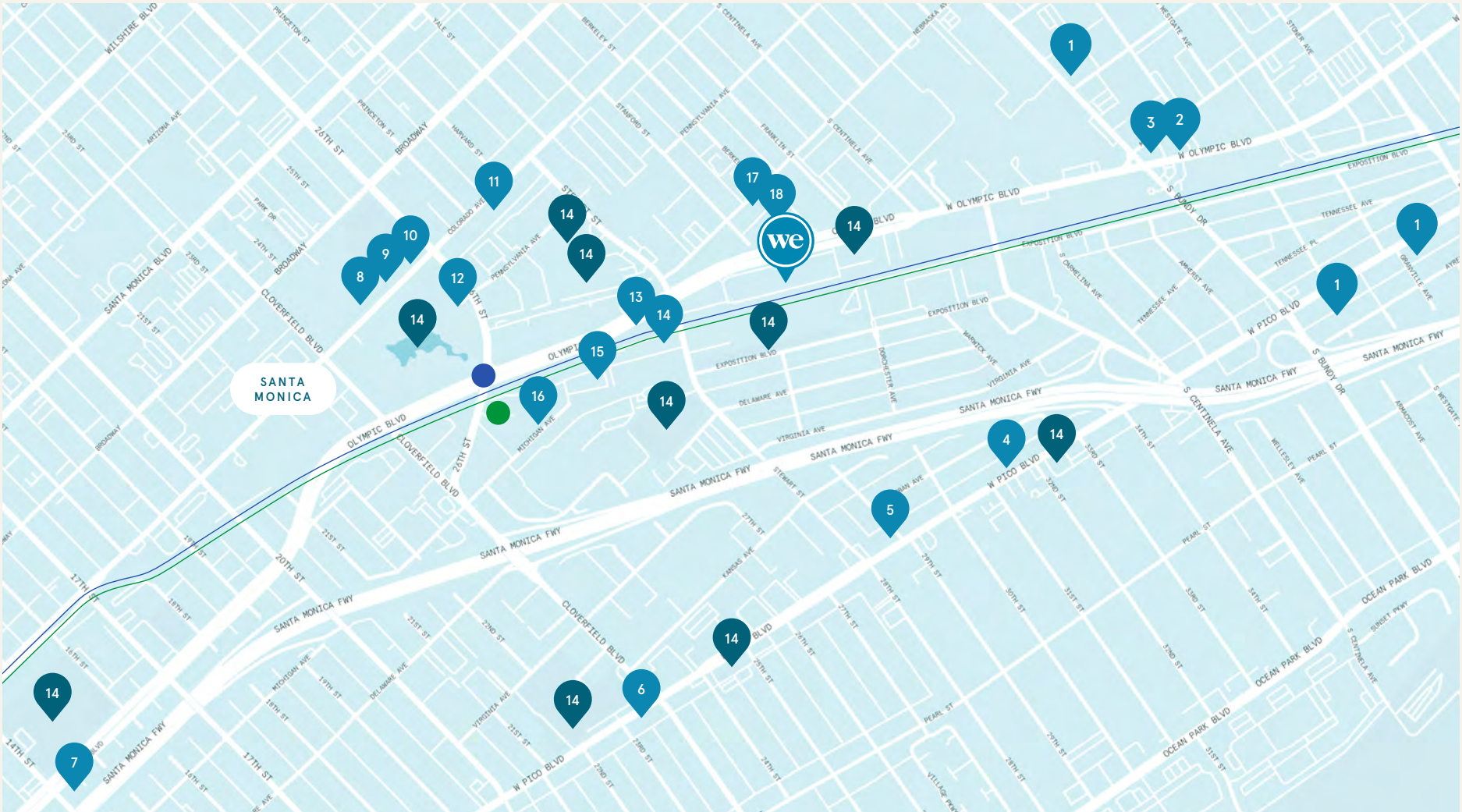

EAT & DRINK

- | | |
|--------------------|---------------------|
| 1. Garden Cafe | 13. Tiato |
| 2. Greek Kabob | 14. City Kitchen |
| 3. Jersey Mike’s | 15. Teddy’s Cafe |
| 4. Don Antonio | 16. Lime Cafe |
| 5. The Arsenal | 17. Bergamot Cafe |
| 6. Valentino | 18. Birdie G’s |
| 7. The Brixton | 19. Tenzo Tea |
| 8. The Daily Pint | 20. Bluey’s Kitchen |
| 9. Tacos Por Favor | |
| 10. Elabrew Coffee | |
| 11. Daily Grill | |
| 12. Subway | |

RETAIL, LIFESTYLE, & ENTERTAINMENT

1. The Recording Academy
2. Ishihara Park
3. Stewart Street Park
4. Trader Joe’s
5. Rite Aid
6. Pico Farmer’s Market
7. Memorial Park
8. The Water Garden
9. Santa Monica Center for Media and Design
10. Red Bull Headquarters

NEARBY TRANSPORTATION

26th / Bergamot	0.4 mi
(LA Metro Rail, E Line)	
Expo / Bundy	0.5 mi
(LA Metro Rail, E Line)	





3000 Olympic Boulevard Santa Monica, CA 90404

wework

© 2021 WeWork. The WeWork trademark and related logos are the property of WeWork Companies LLC. Any reference to third party names are for reference and informational purposes only and should not be considered an endorsement or association of WeWork or vice versa. Photographs contained herein are representative examples of various WeWork locations and do not necessarily depict the WeWork location referenced in the brochure. While reasonable efforts have been made to check the accuracy of the information contained here, WeWork, its officers, employees, directors, and representatives, make no warranty, express or implied, regarding the accuracy of the information and disclaim any liability arising from the use of the information contained herein. All dimensions are approximate and subject to variances. It is your obligation to independently verify particulars of the property. WeWork reserves the right to make changes.