



596 West Andrews Way

OGDEN, UTAH 84404

For Sublease

Property Highlights

- 120,000 total SF
 - 1,987 office SF
 - 118,013 warehouse SF
- Space is divisible to both 60,000 SF and 90,000 SF
- Sixteen (16) dock high doors equipped with bumpers, seals, and levelers
- One (1) ground level door
- 32' clear height
- Cross-dock configuration
- 480-277V 3-phase
- 268' building depth
- 50'x50' column spacing
- ESFR sprinkler system
- LED lighting
- 4,790 racked pallet positions available for purchase
- Quick access to I-15 and I-8

For information, please contact:

Eli Priest

Senior Managing Director

t 801-746-4746

epriest@newmarkmw.com

Jeff Heaton, SIOR

Executive Managing Director

t 801-578-5539

jheaton@newmarkmw.com

376 E. 400 S.

Suite 120

Salt Lake City, UT 84111

NEWMARK

 MOUNTAIN WEST

The information contained herein has been obtained from sources deemed reliable but has not been verified and no guarantee, warranty or representation, either express or implied, is made with respect to such information. Terms of sale or lease and availability are subject to change or withdrawal without notice.

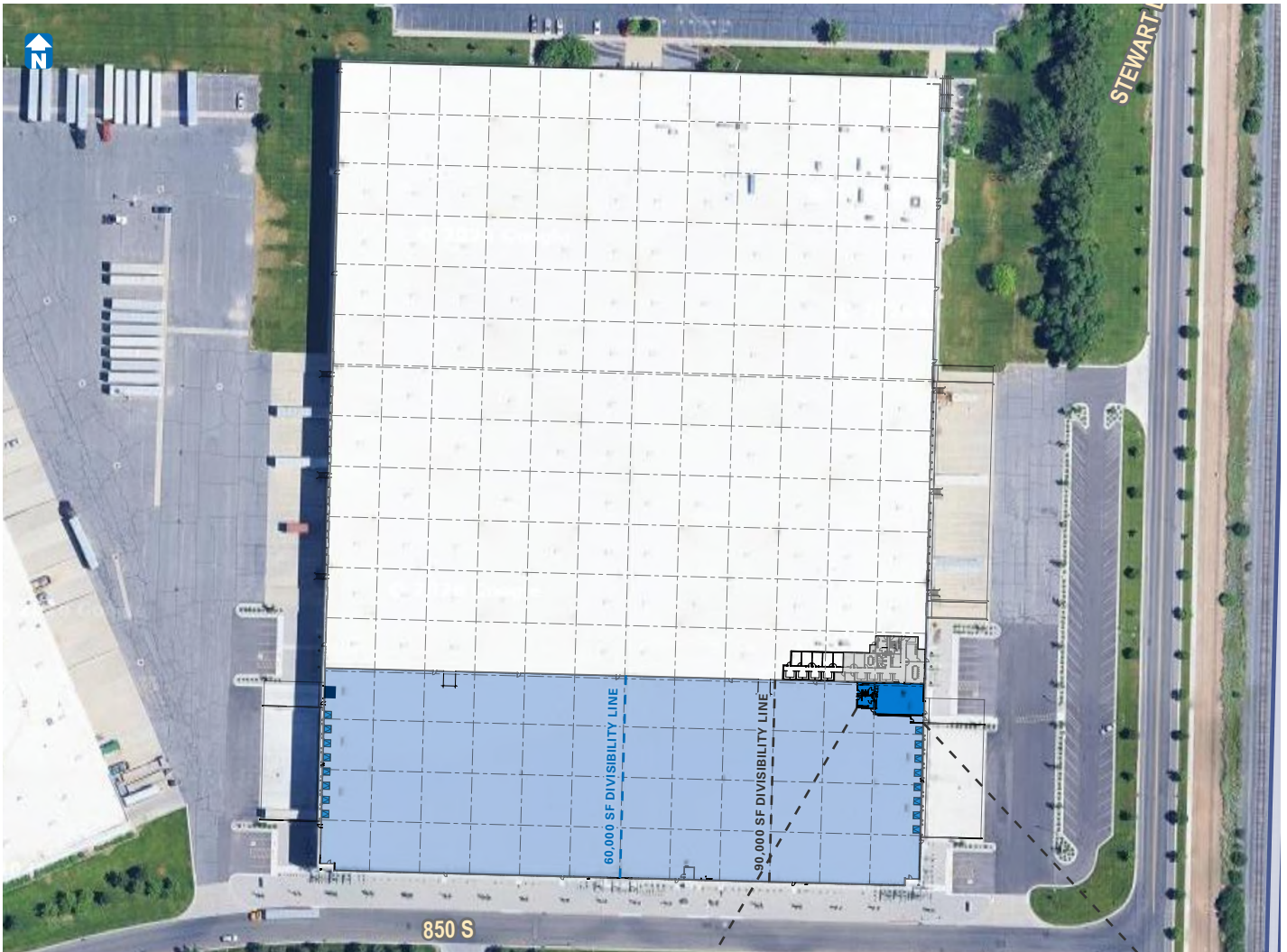

- Sixteen (16) Dock High doors equipped with bumpers, seals, and levelers
- One (1) Ground Level Door

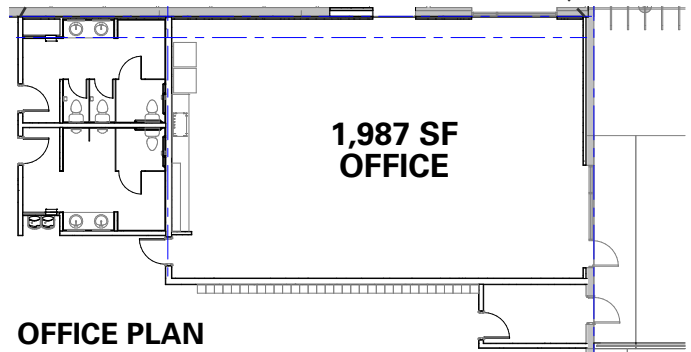

For information, please contact:

Eli Priest
 Senior Managing Director
 t 801-746-4746
 epriest@newmarkmw.com

Jeff Heaton, SIOR
 Executive Managing Director
 t 801-578-5539
 jheaton@newmarkmw.com

376 E. 400 S.
 Suite 120
 Salt Lake City, UT 84111



The information contained herein has been obtained from sources deemed reliable but has not been verified and no guarantee, warranty or representation, either express or implied, is made with respect to such information. Terms of sale or lease and availability are subject to change or withdrawal without notice.

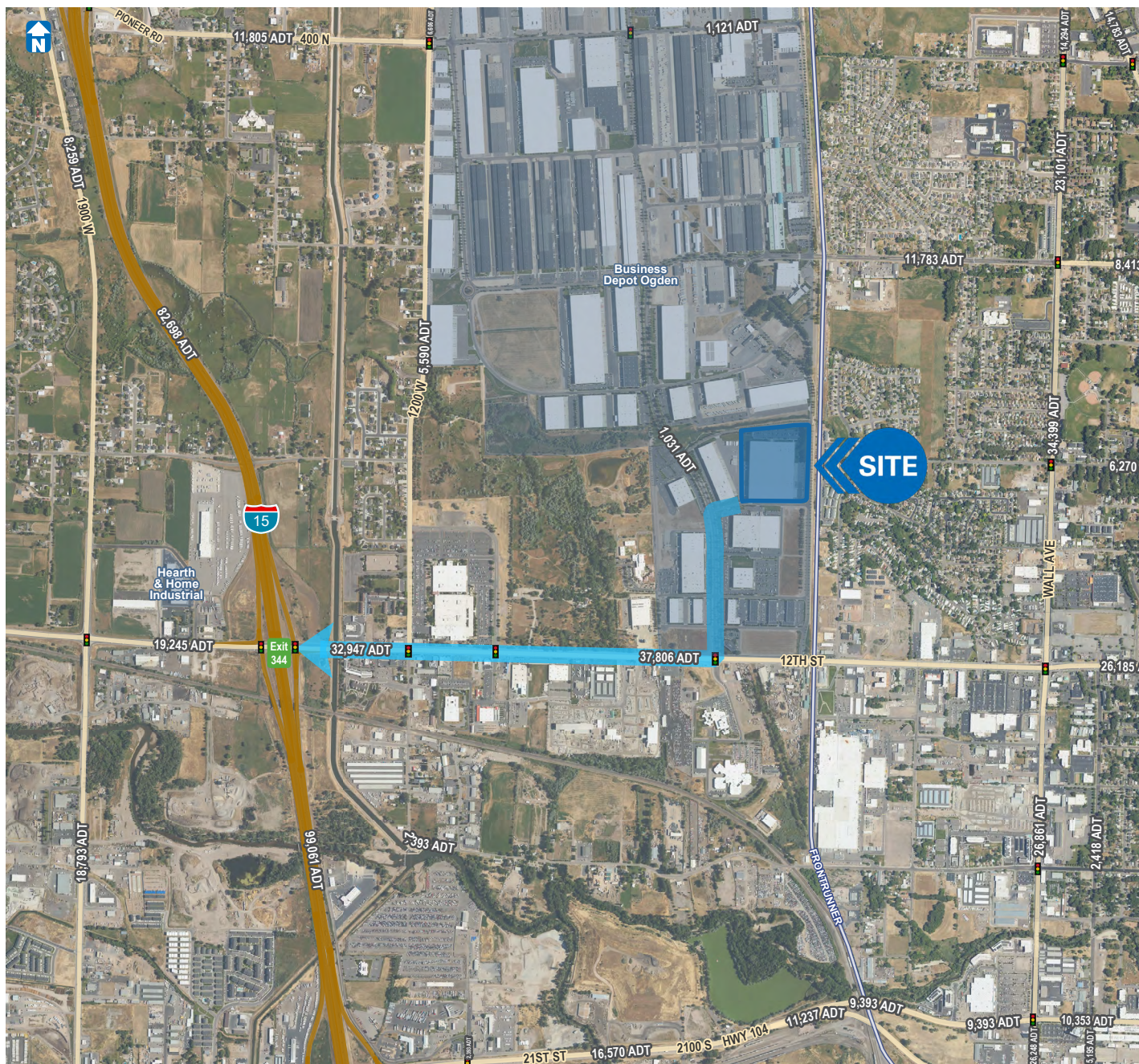

For information, please contact:

Eli Priest

Senior Managing Director

t 801-746-4746

epriest@newmarkmw.com

Jeff Heaton, SIOR

Executive Managing Director

t 801-578-5539

jheaton@newmarkmw.com

376 E. 400 S.

Suite 120

Salt Lake City, UT 84111

NEWMARK

MOUNTAIN WEST

The information contained herein has been obtained from sources deemed reliable but has not been verified and no guarantee, warranty or representation, either express or implied, is made with respect to such information. Terms of sale or lease and availability are subject to change or withdrawal without notice.