

ICONIC MARIN COUNTY RESTAURANT SPACE



125 E SIR FRANCIS DRAKE

± 5,800 SF FOR LEASE



**Jennifer Hibbitts**  
Senior Director  
+1 415 451 2433  
jennifer.hibbitts@cushwake.com  
Lic #: 01418027



# HIGHLIGHTS



Views of Mt. Tam  
and The Bay



Walking distance  
to SMART train,  
ferry, and Marin  
Country Mart



On-site parking



Easy access to  
580 and 101



Waterfront  
location



Exterior  
event/patio  
space

**Jennifer Hibbitts**  
Senior Director  
+1 415 451 2433  
jennifer.hibbitts@cushwake.com  
Lic #: 01418027

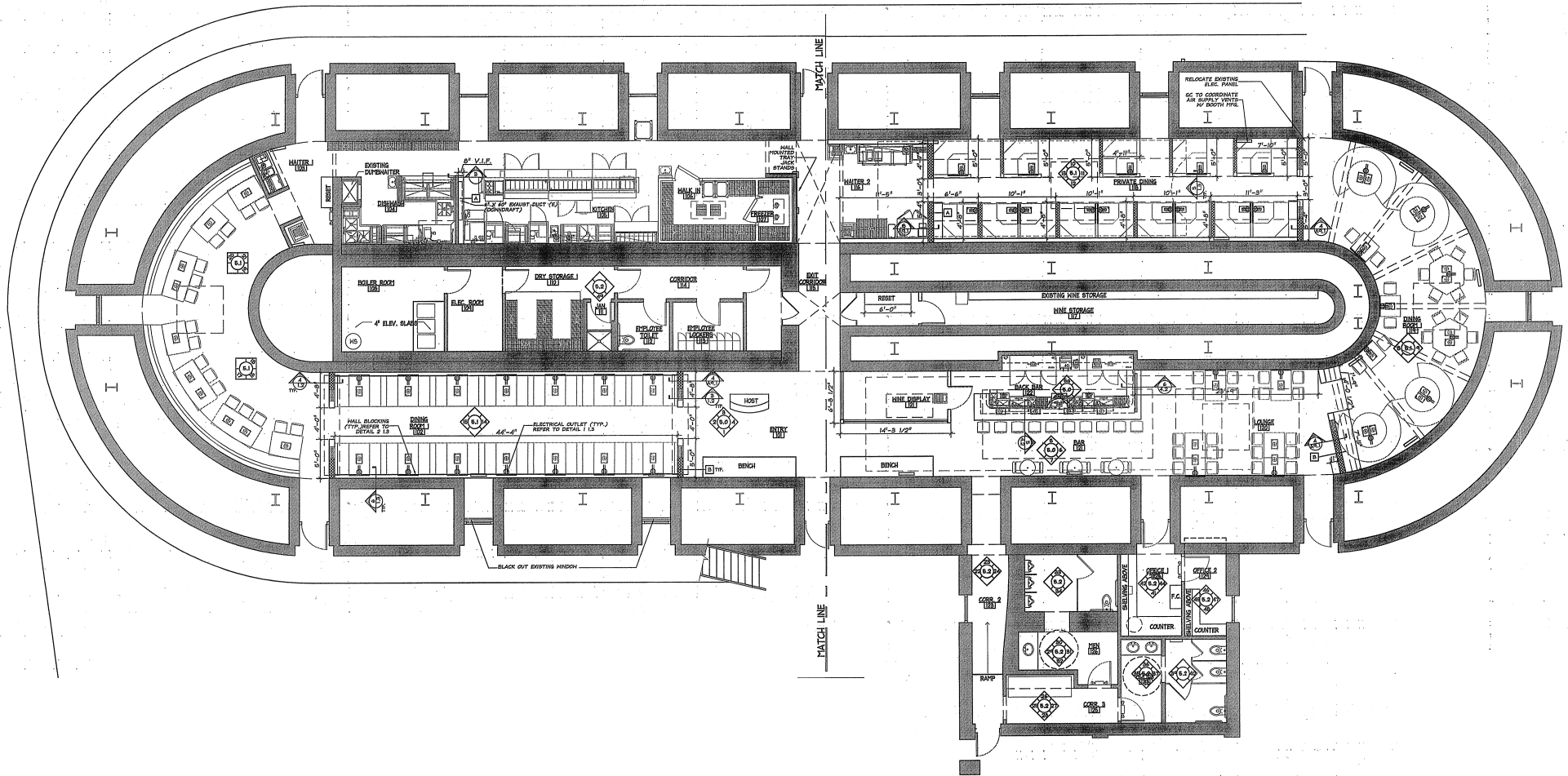

- ± 5,800 SF available
- For Lease- available now
- Built in 1889, originally a brick kiln
- Fixtures, furniture and equipment can be included in the lease
- Brick walls and ceilings
- Direct access to on site parking lot



INTERIOR

CUSHMAN & WAKEFIELD





EXTERIOR







San Rafael Bay

### Marin Country Mart

- Rustic Bakery
- Birkenstock
- International Orange
- The Real Real
- Soul Cycle
- Shake Shack
- Farmshop
- Hog Island
- Johnny Doughnuts
- Pressed Juicery
- Starbucks
- El Huarache Loco
- Sushi Ko
- Tutu School



125 E Sir Francis Drake Blvd



Sonoma Marin SMART Train

Courtyard Marriott

Larkspur Ferry Terminal

Sir Francis Drake Blvd



Corte Madera Creek

**Jennifer Hibbitts**  
Senior Director  
+1 415 451 2433  
jennifer.hibbitts@cushwake.com  
Lic #: 01418027



# USABLE OUTDOOR TENANT SPACE



Larkspur Ferry  
Terminal

Shared Outdoor  
Deck Space

**Jennifer Hibbitts**  
Senior Director  
+1 415 451 2433  
jennifer.hibbitts@cushwake.com  
Lic #: 01418027



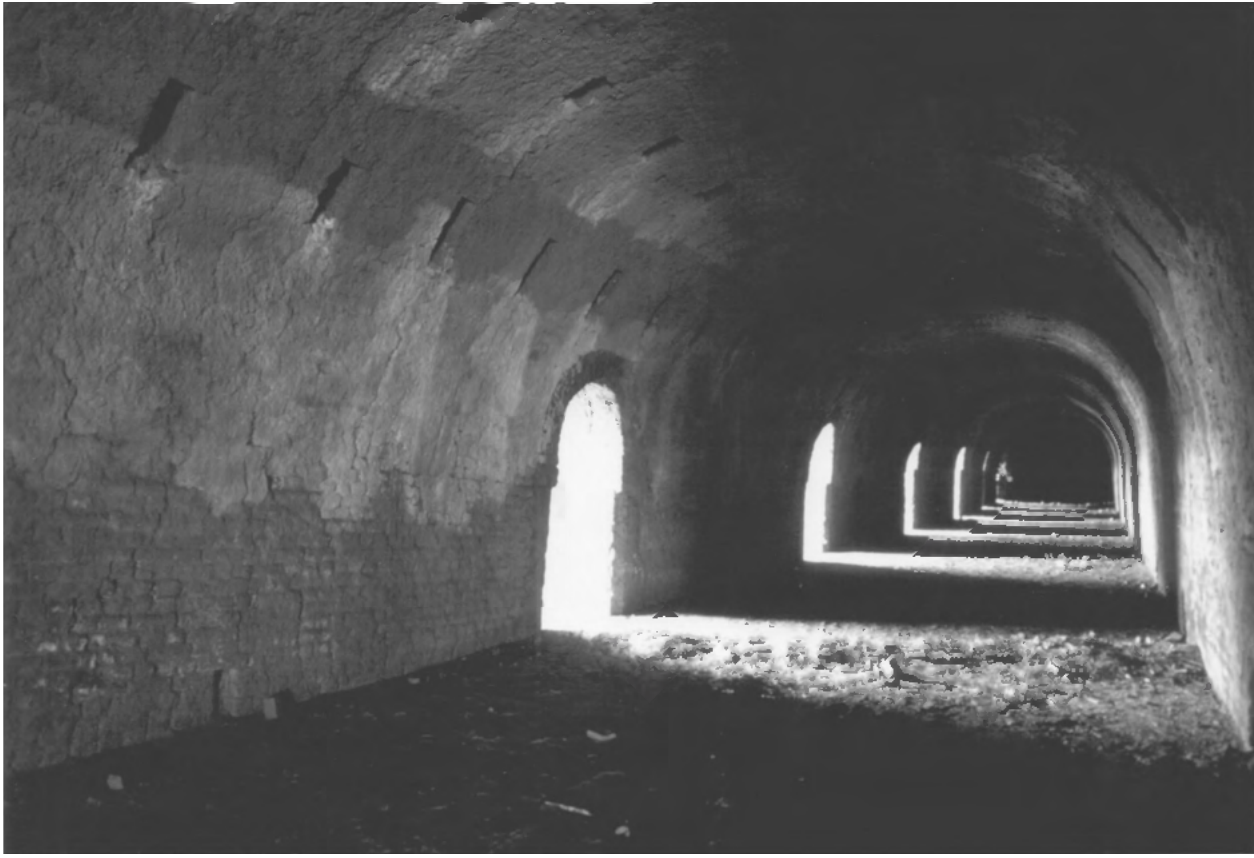

The Remillard Brick Company, of which the Green Brae Brick Kiln is the only surviving structure, was by 1900 the largest brickmaking firm on the Pacific Coast. The kiln is one of the few remaining examples of the Hoffman type kiln in the U.S. and is an engineering landmark of statewide significance. The kiln supplied much of the brick required to rebuild San Francisco after the 1906 Earthquake, and the Remillard Brick Company served as a chief supplier of bricks for the entire Pacific coast. It was closed in 1915.

California Registered Historical Landmark No. 917

Plaque placed by the State Department of Parks and Recreation in cooperation with Intermark Interests Inc., October 21, 1989.



ICONIC MARIN COUNTY RESTAURANT SPACE



125 E SIR FRANCIS DRAKE

± 5,800 SF FOR LEASE



**Jennifer Hibbitts**  
Senior Director  
+1 415 451 2433  
jennifer.hibbitts@cushwake.com  
Lic #: 01418027