



Riverpark VI

10897 S. RIVER FRONT PKWY.
SOUTH JORDAN, UT 84095

For Sublease

\$22.00 - \$26.00/SF Full Service

Property Highlights

- First floor available: 4,000 SF
- Fifth Floor available: 14,067 to 25,130 RSF
- Plug-and-play ready
- Fully remodeled interior
- Growth flexibility can be accommodated
- Project amenities include over a dozen on-site restaurants, access to the Jordan River Parkway, on-site showers/lockers, nearby fitness and childcare and more

For information, please contact:

Jeff Rossi
Executive Managing Director
t 801-578-5508
jeff.rossi@nmrk.com

Trigger Reital
Executive Managing Director
t 801-578-5507
trigger.reital@nmrk.com

376 E. 400 S.
Suite 120
Salt Lake City, UT 84111

For information, please contact:

Jeff Rossi
Executive Managing Director
t 801-578-5508
jeff.rossi@nmrk.com

Trigger Reital
Executive Managing Director
t 801-578-5507
trigger.reital@nmrk.com

376 E. 400 S.
Suite 120
Salt Lake City, UT 84111

RIVERPARK VI



FIRST FLOOR
4,000 SF Available
\$22.00/SF Full Service

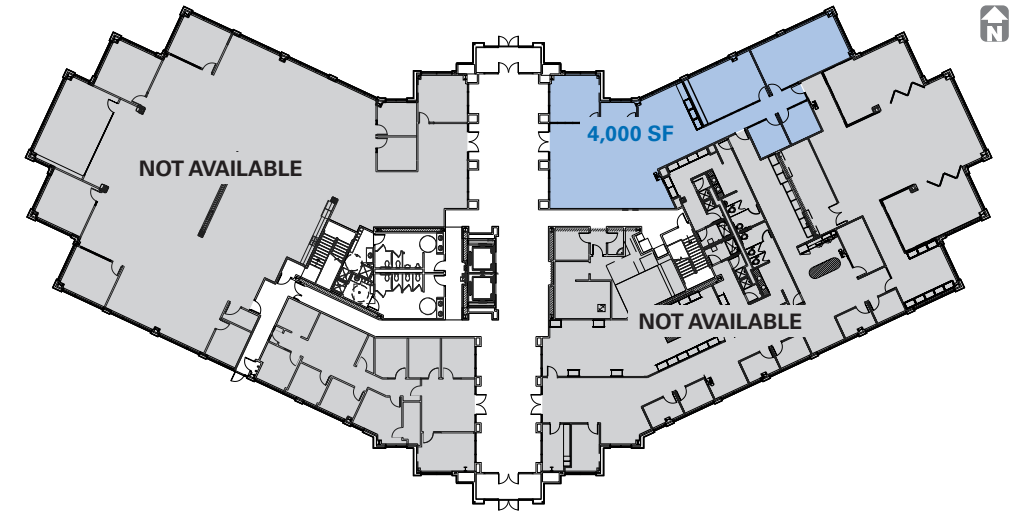

FIFTH FLOOR
25,130 SF Available
Divisible to 11-14,000 SF
\$26.00/SF Full Service

