



**SAURAGE ROTENBERG**  
COMMERCIAL REAL ESTATE

**MIKE STINSON, CCIM**

TEL: 225 448-2919  
MOBILE: 225 907-7793  
EMAIL: MIKE@SR-CRE.COM



## FOR LEASE

**9230 FLORIDA BOULEVARD  
BATON ROUGE, LA 70815**

**\$12/SQ.FT.**

**841 SQ.FT.**

### HIGHLIGHTS

- Retail/Office Space located near the intersection of Florida Blvd. and Airline Hwy.
- **SUITE F:** 841 SF \$12 PSF NNN
- Across from the new Amazon Fulfillment Center
- Easy Access
- High Traffic Counts
- Good Signage
- Priced to lease to right tenant
- Landlord to possibly contribute to TI Allowance
- Current Tenants are a Finance Company, Cash Allowance Company, Hair Salon and Fitness Studio

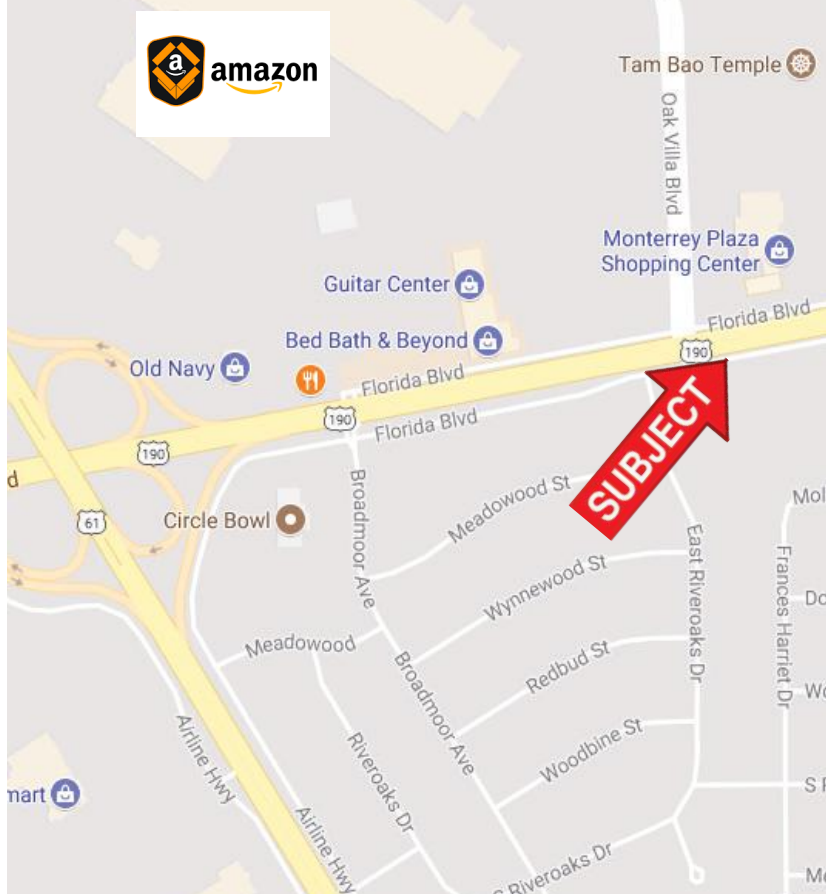

SAURAGE ROTENBERG COMMERCIAL REAL ESTATE, LLC  
5135 BLUEBONNET BLVD  
BATON ROUGE, LA 70809

TEL 225 766-0000  
FAX 225 766-2229

WEB SAURAGEROTENBERG.COM

The information contained herein has either been given to us by property owners or is from sources deemed reliable and is believed to be correct, it is not in any way warranted or guaranteed by Saurage Rotenberg Commercial Real Estate. This information is submitted subject to errors, omissions, changes in price, rental or other conditions, withdrawal without notice, and to any special listing conditions imposed by the principals. Licensed in Louisiana.



**SAURAGE ROTENBERG**  
COMMERCIAL REAL ESTATE

**MIKE STINSON, CCIM**

TEL: 225 448-2919  
MOBILE: 225 907-7793  
EMAIL: MIKE@SR-CRE.COM



SAURAGE ROTENBERG COMMERCIAL REAL ESTATE, LLC  
5135 BLUEBONNET BLVD  
BATON ROUGE, LA 70809

TEL 225 766-0000  
FAX 225 766-2229

WEB SAURAGEROTENBERG.COM

The information contained herein has either been given to us by property owners or is from sources deemed reliable and is believed to be correct, it is not in any way warranted or guaranteed by Saurage Rotenberg Commercial Real Estate. This information is submitted subject to errors, omissions, changes in price, rental or other conditions, withdrawal without notice, and to any special listing conditions imposed by the principals. Licensed in Louisiana.





**SAURAGE ROTENBERG**  
COMMERCIAL REAL ESTATE

**MIKE STINSON, CCIM**

TEL: 225 448-2919

MOBILE: 225 907-7793

EMAIL: MIKE@SR-CRE.COM

FLORIDA BOULEVARD

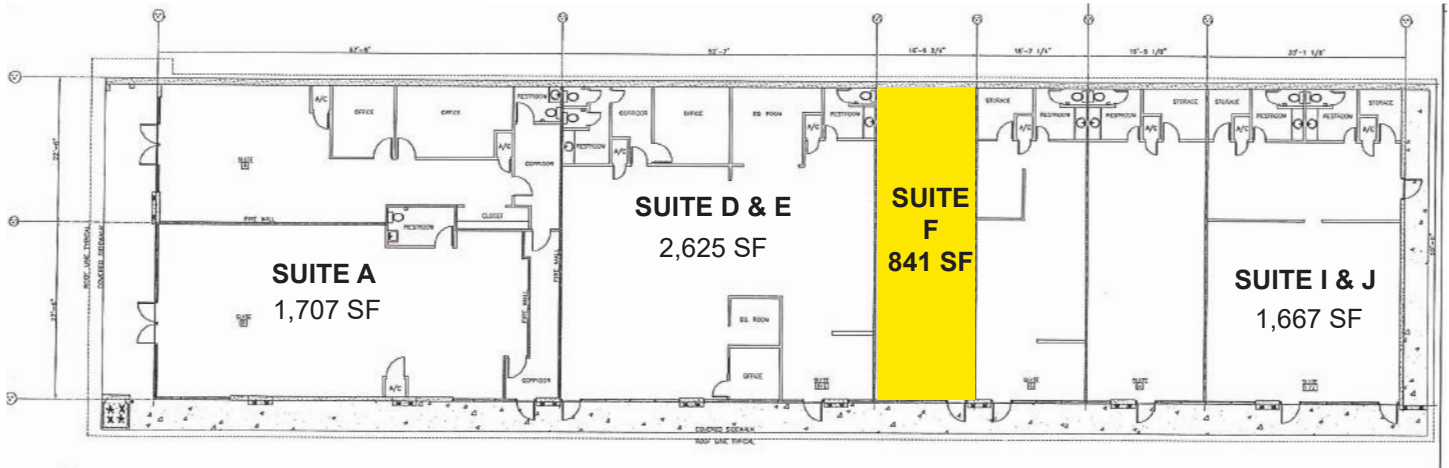

PARKING

PARKING



SAURAGE ROTENBERG COMMERCIAL REAL ESTATE, LLC  
5135 BLUEBONNET BLVD  
BATON ROUGE, LA 70809

TEL 225 766-0000  
FAX 225 766-2229

WEB SAURAGEROTENBERG.COM

The information contained herein has either been given to us by property owners or is from sources deemed reliable and is believed to be correct, it is not in any way warranted or guaranteed by Saurage Rotenberg Commercial Real Estate. This information is submitted subject to errors, omissions, changes in price, rental or other conditions, withdrawal without notice, and to any special listing conditions imposed by the principals. Licensed in Louisiana.





**SAURAGE ROTENBERG**  
COMMERCIAL REAL ESTATE

**MIKE STINSON, CCIM**

TEL: 225 448-2919  
MOBILE: 225 907-7793  
EMAIL: MIKE@SR-CRE.COM



SAURAGE ROTENBERG COMMERCIAL REAL ESTATE, LLC  
5135 BLUEBONNET BLVD  
BATON ROUGE, LA 70809

TEL 225 766-0000  
FAX 225 766-2229

WEB SAURAGEROTENBERG.COM

The information contained herein has either been given to us by property owners or is from sources deemed reliable and is believed to be correct, it is not in any way warranted or guaranteed by Saurage Rotenberg Commercial Real Estate. This information is submitted subject to errors, omissions, changes in price, rental or other conditions, withdrawal without notice, and to any special listing conditions imposed by the principals. Licensed in Louisiana.