



ARES
INDUSTRIAL
MANAGEMENT

LITTLE ORCHARD BUSINESS PARK

1712 LITTLE ORCHARD, SAN JOSE, CA 95125

±6,636 Leasable Square Feet

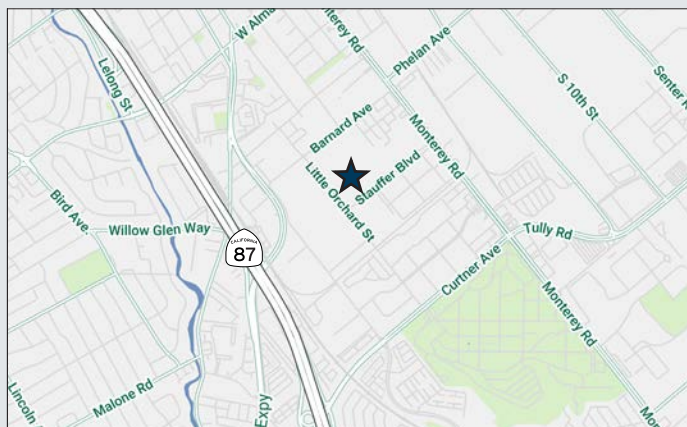

BUILDING HIGHLIGHTS

- ±6,636 SF Manufacturing/Industrial Space
- Approximately 1,000 SF of HVAC Office
- Two Restrooms
- One Dock Door
- One Grade Door
- 200 Amps @ 277/480 Volt Panel
- Available March 2025

FRANK FRIEDRICH
Senior Vice President
+1 408 453 7495
frank.friedrich@cbre.com
Lic. 01159876

CHIP SUTHERLAND
Vice Chairman
+1 408 453 7410
chip.sutherland@cbre.com
Lic. 01014633

CBRE



ARES
INDUSTRIAL
MANAGEMENT

LITTLE ORCHARD BUSINESS PARK

1712 LITTLE ORCHARD, SAN JOSE, CA 95125

Site Plan

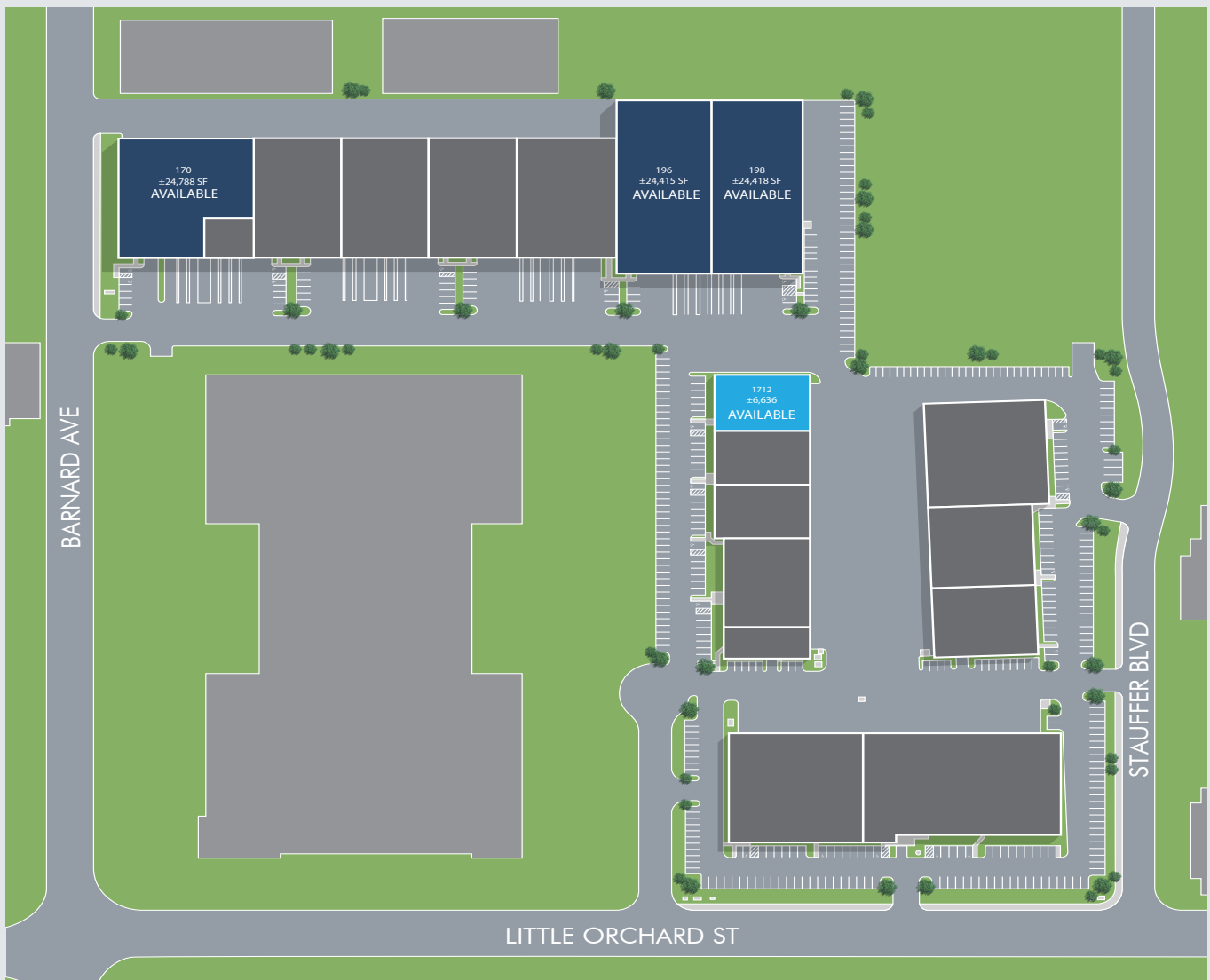

© 2024 CBRE, Inc. All rights reserved. This information has been obtained from sources believed reliable, but has not been verified for accuracy or completeness. You should conduct a careful, independent investigation of the property and verify all information. Any reliance on this information is solely at your own risk. CBRE and the CBRE logo are service marks of CBRE, Inc. All other marks displayed on this document are the property of their respective owners, and the use of such logos does not imply any affiliation with or endorsement of CBRE. Photos herein are the property of their respective owners. Use of these images without the express written consent of the owner is prohibited.



ARES
INDUSTRIAL
MANAGEMENT

LITTLE ORCHARD BUSINESS PARK

1712 LITTLE ORCHARD, SAN JOSE, CA 95125

±6,636 Leasable Square Feet

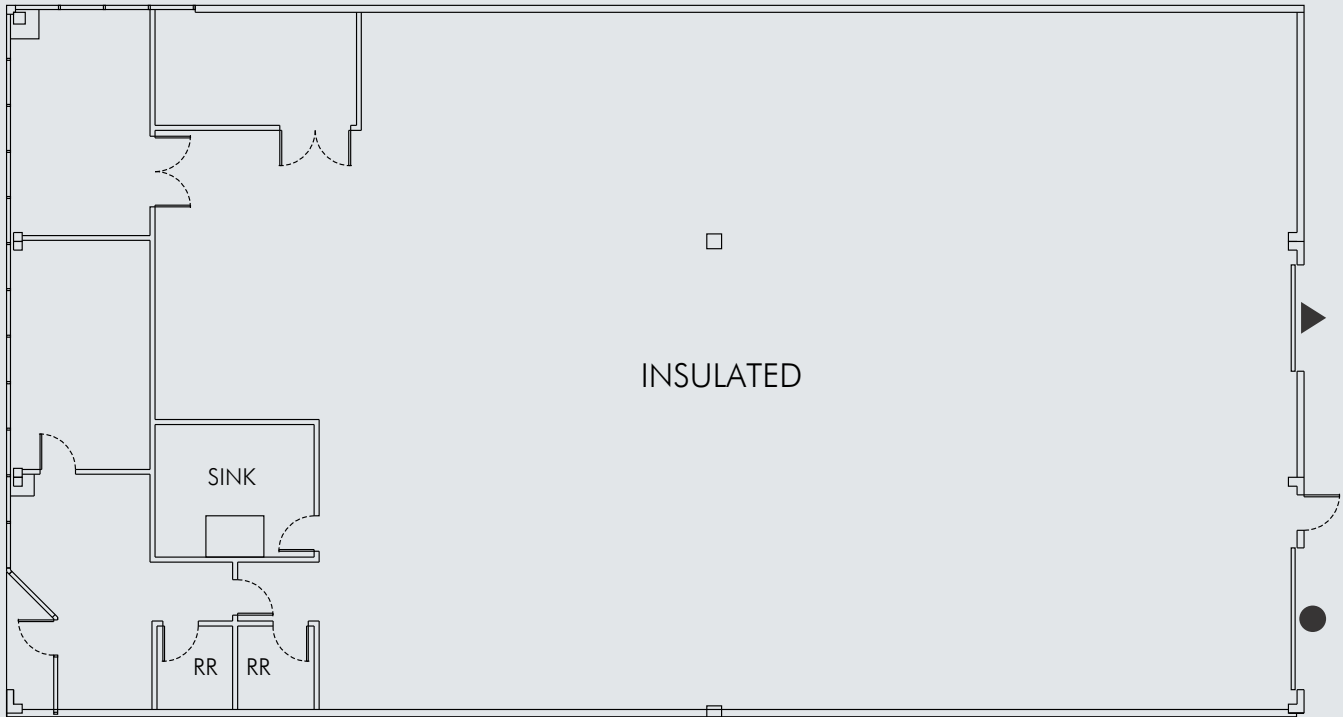

- ▲ DOCK DOOR
- GRADE LEVEL DOOR

© 2024 CBRE, Inc. All rights reserved. This information has been obtained from sources believed reliable, but has not been verified for accuracy or completeness. You should conduct a careful, independent investigation of the property and verify all information. Any reliance on this information is solely at your own risk. CBRE and the CBRE logo are service marks of CBRE, Inc. All other marks displayed on this document are the property of their respective owners, and the use of such logos does not imply any affiliation with or endorsement of CBRE. Photos herein are the property of their respective owners. Use of these images without the express written consent of the owner is prohibited.



ARES
INDUSTRIAL
MANAGEMENT

LITTLE ORCHARD BUSINESS PARK

1712 LITTLE ORCHARD, SAN JOSE, CA 95125

±6,636 Leasable Square Feet



FRANK FRIEDRICH
Senior Vice President
+1 408 453 7495
frank.friedrich@cbre.com
Lic. 01159876

CHIP SUTHERLAND
Vice Chairman
+1 408 453 7410
chip.sutherland@cbre.com
Lic. 01014633

