

EYDE DEVELOPMENT

3080 S. LINDEN ROAD
FLINT, MI 48507



FOR LEASE

SPACE AVAILABLE:

- 37,920 SF space available
- 34,404 SF space available
- 25,316 SF space available

ADVANTAGES:

- Well located across the street from Genesee Valley Mall
- Adjacent to one of the top producing stores in the state - Kohl's

FEATURES/AMENITIES:

- High ceilings
- Loading dock
- All HVAC replaced within 3 years
- Roof in excellent condition
- Close proximity to restaurants, gyms, grocery and retail

STRATEGIC LOCATION:

- Strategically located at the southeast corner of Linden Road and W. Lennon Road
- Easy access to highway



CONTACT

Eyde Development
517-903-3933 | eyde.com

EYDE DEVELOPMENT

3080 S. LINDEN ROAD
FLINT, MI 48507

FLOOR PLAN

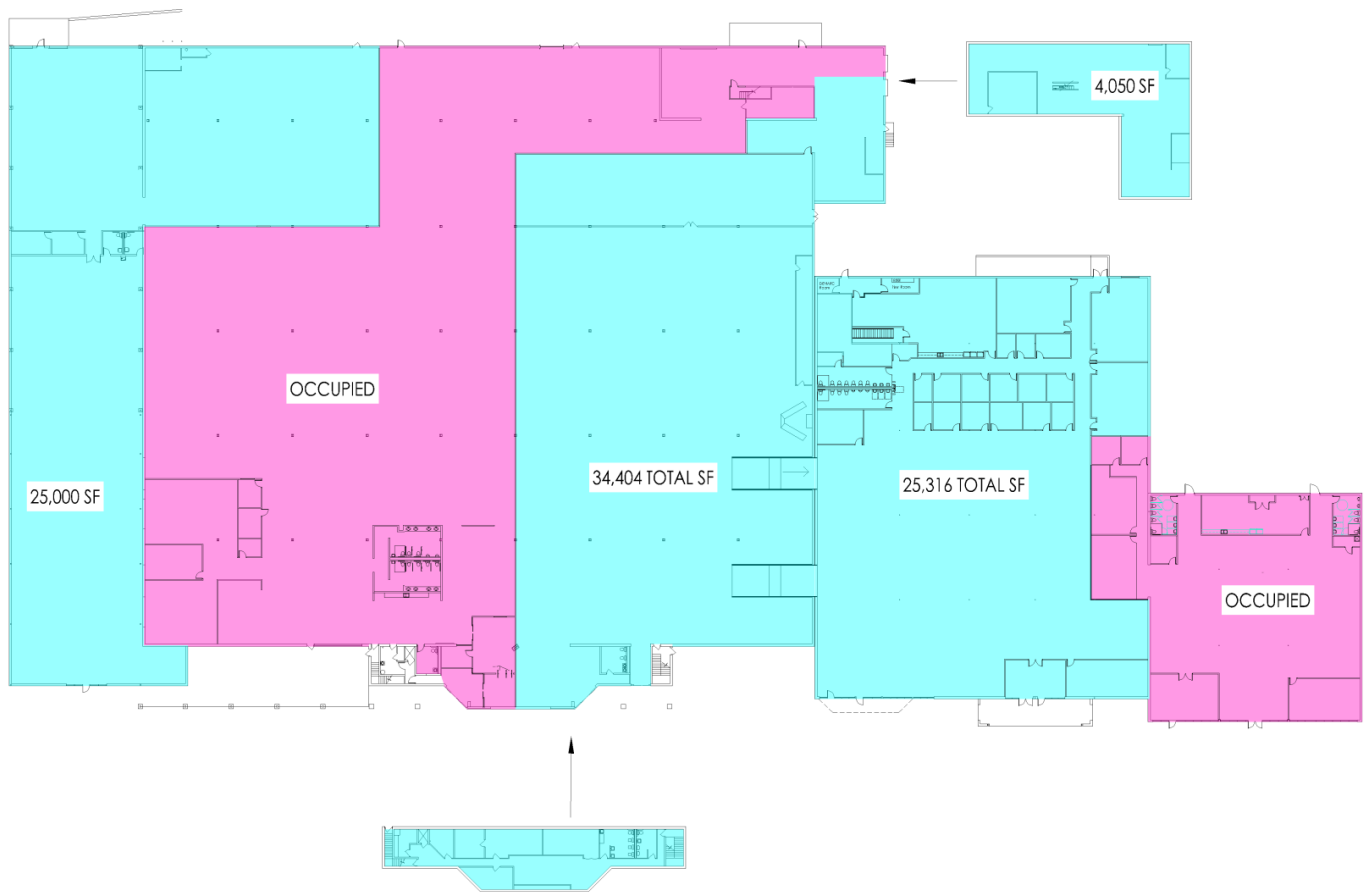

SPACE AVAILABLE:

88,770 SF

CONTACT

Eyde Development
517-903-3933 | eyde.com



| Eyde Development | 300 S. Washington Square #400 Lansing, MI 48933 |
| Phone: 517-903-3933 | Fax: 517-484-5695 | www.eyde.com |