

OWNERS:
 SAHTECH LLC, MOHAMMAD FAZI
 6528 TERRACE RIDGE CT
 DUBLIN, CA 94568

BASIS OF BEARINGS:
 MONUMENT LINE WITHIN TUNNEL ROAD PER GWIN UNIT OF THE MAP OF THE
 HIGHLANDS OF OAKLAND (5 M 39)
 BEARING: N73°54'00"E

BENCHMARK:
 CITY OF OAKLAND BENCHMARK DESIGNATION 865 - STANDARD CITY OF OAKLAND MONUMENT
 (04 NW 76) LOCATED WITHIN TUNNEL ROAD OPPOSITE LOT 112 (5 M 39)
 ELEVATION = 753.420' (CITY OF OAKLAND VERTICAL DATUM)

NOTE:
 THERE ARE VERTICAL CURVES WITHIN 300 FEET OF THE PROPERTY
 THERE ARE HORIZONTAL CURVES WITHIN 300 FEET OF THE PROPERTY
 THERE ARE PROTECTED TREES ON THE PROPERTY
 THERE ARE NO EXISTING BUS STOPS WITHIN 100 FEET OF THE PROPERTY
 THERE ARE EXISTING CROSSWALKS WITHIN 100 FEET OF THE PROPERTY

BASIS OF SURVEY:
 THE LOT LOCATION WAS BASED UPON THE MAP GWIN UNIT OF THE MAP OF THE HIGHLANDS OF
 OAKLAND (5 M 39) AND THE MONUMENTS ESTABLISHING THE RIGHTS OF WAY OF TUNNEL AND
 CHARING CROSS ROADS.

SURVEYOR'S STATEMENT:
 THIS MAP CORRECTLY REPRESENTS A FIELD SURVEY MADE BY ME OR UNDER MY DIRECTION IN
 CONFORMANCE WITH THE REQUIREMENTS OF THE CALIFORNIA LAND SURVEYORS ACT AT THE
 REQUEST OF HANA TAREQ IN MAY, 2023.

I HEREBY STATE THAT ALL EXISTING GRADES AND CONTOURS ARE BASED UPON CITY OF
 OAKLAND DATUM. I HEREBY FURTHER STATE THAT TO THE BEST OF MY KNOWLEDGE ALL
 PROVISIONS OF APPLICABLE STATE LAWS AND ORDINANCES HAVE BEEN FULLY SATISFIED.

I FURTHER STATE THAT THE LOT DESIGNATED BY MY SURVEY AND SHOWN ON THIS MAP IS THE
 SAME AS DESCRIBED IN THAT CERTAIN MAP ENTITLED, 'GWIN UNIT OF THE HIGHLANDS OF
 OAKLAND', FILED ON NOVEMBER 10, 1925, IN BOOK 5 OF MAPS, AT PAGE 39, IN THE OFFICE
 OF THE ALAMEDA COUNTY RECORDER, AND IDENTIFIED ON THE CURRENT EQUALIZED
 ASSESSMENT ROLL OF THE ALAMEDA COUNTY ASSESSOR AS PARCEL NO. 048H-7620-033-01.

I HEREBY FURTHER STATE THAT IN ACCORDANCE WITH THE PROFESSIONAL LAND SURVEYORS
 ACT, THE PERFORMANCE OF THIS SURVEY REQUIRES THAT A CORNER RECORD BE FILED AND I
 WILL FILE A CORNER RECORD WITHIN THE TIME LIMITS PRESCRIBED BY STATE LAW, ONCE FILED
 BY THE COUNTY SURVEYOR IN OFFICIAL RECORDS I WILL PROVIDE A COPY TO THE CITY
 SURVEYORS' OFFICE.

I HEREBY ACKNOWLEDGE THAT THIS SURVEY SHALL BE A PUBLIC RECORD AND MAY BE
 AVAILABLE FOR INSPECTION AND DISTRIBUTION TO THE GENERAL PUBLIC.

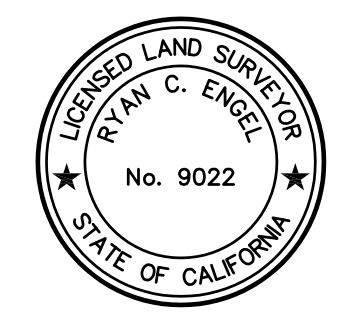

Ryan C. Engel
 RYAN C. ENGEL, PLS 9022
 DATE: 05/23/2023

BOUNDARY & TOPOGRAPHIC SURVEY

THAT REAL PROPERTY DESCRIBED IN THAT CERTAIN DEED
 RECORDED APRIL 4, 2023
 SERIES NO. 2023-038192
 OFFICIAL RECORDS ALAMEDA COUNTY
 BEING LOTS 111, 112, 113 AND 114
 GWIN UNIT OF THE MAP OF THE HIGHLANDS OF OAKLAND (5 M 39)
 CITY OF OAKLAND ALAMEDA COUNTY CALIFORNIA
 MAY, 2023 SCALE: 1" = 20'

BA LS BAY AREA LAND SURVEYING INC
 3065 RICHMOND PARKWAY, SUITE 101
 RICHMOND, CA 94806
 (510) 223-5167

- LEGEND**
- FOUND CITY OF OAKLAND MONUMENT
 - () RECORD DATA
 - (R) RADIAL BEARING
 - #T DIAMETER OF TREE (INCHES)
 - DI DRAIN INLET
 - EB ELECTRIC BOX
 - EP EDGE OF PAVEMENT
 - FH FIRE HYDRANT
 - FL FLOW LINE
 - GR GROUND SPOT ELEVATION
 - LH SANITARY SEWER LAMP HOLE
 - P PAVEMENT
 - PBMH PAC BELL MANHOLE
 - SL STREET LIGHT
 - SLB STREET LIGHT BOX
 - SSMH SANITARY SEWER MANHOLE
 - TOE TOE OF SLOPE
 - TOP TOP OF SLOPE
 - TVB TELECOM BOX
 - SSMH SANITARY SEWER MANHOLE
 - VLT VAULT
- SUBJECT PROPERTY
 - - - RIGHT OF WAY/ADJACENT LOT LINE
 - - - MONUMENT LINE
 - - - HISTORIC PARCEL/LOT LINE
 - - - TIE LINE
 - - - EASMENT

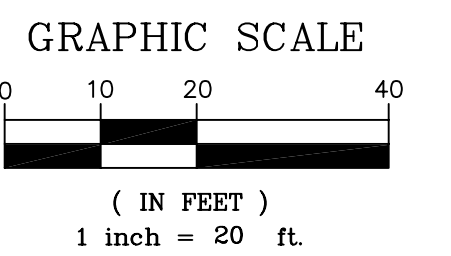

PUBLIC ADVISORY STATEMENT:
 THIS MAP IS BASED ON PRIVATE SURVEYS PERFORMED BY LICENSED PROFESSIONALS AND WILL NOT BE
 UPDATED OR CORRECTED BY THE CITY OF OAKLAND AFTER ITS FILING. NO WARRANTY, EITHER EXPRESSED OR
 IMPLIED, IS MADE BY THE CITY OF OAKLAND THAT THIS MAP AND THE SURVEY INFORMATION ON WHICH IT IS
 BASED IS CORRECT, ACCURATE, AND CURRENT, NOR THAT THE CITY WILL RETAIN FOR PUBLIC INSPECTION ANY
 RELATED INFORMATION WHICH MAY BE SUBSEQUENTLY SUBMITTED TO THE CITY, INCLUDING ALLEGED OR
 ACTUAL DISCREPANCIES, INACCURACIES, DEFICIENCIES, AND ERRORS.