



  
TRANSWESTERN  
REAL ESTATE  
SERVICES

140  
HAWTHORNE  
SF | CA  
AVAILABLE  
NOW



FURNITURE AVAILABLE



# 140 HAWTHORNE SF | CA

140 Hawthorne sits in the heart of one of the most sought-after commercial neighborhoods in San Francisco. Located just 3 blocks from South Park and a short walk to public transportation, the building is surrounded by restaurants, coffee shops and other amenities. Built in 1948 and fully renovated in 2013, the building boasts soaring ceilings and abundant natural light.

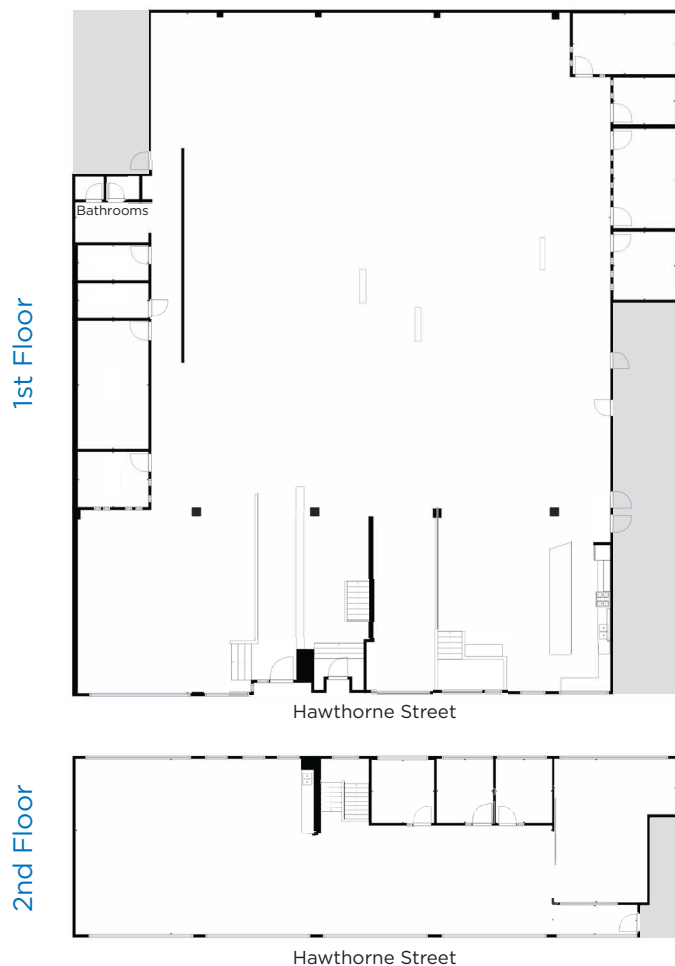

## BUILDING FEATURES

- High \$60s IG
- 14,250 RSF
- Fully Furnished with High-End Furniture
- Free-Standing Building With Possible Exterior Signage
- Showers
- Full Commercial Kitchen
- Skylights
- Between Folsom & Harrison
- Walking Distance to BART/MUNI & Caltrain

1st Floor



VIRTUAL TOUR

2nd Floor



VIRTUAL TOUR



## CONTACT

**MIKE MCCARTHY**

LIC# 00929942

mike.mccarthy@transwestern.com

415.489.1756

**BRIAN MCCARTHY**

LIC# 01840990

brian.mccarthy@transwestern.com

415.489.1753

**MADDIE MEYERSIECK**

LIC# 01961652

maddie.meyersieck@transwestern.com

415.489.1757