

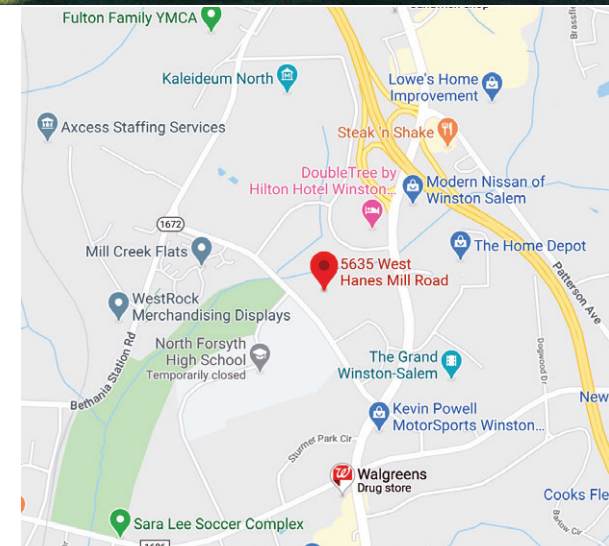

29,570 +/- SF AVAILABLE
SUBLEASE OPPORTUNITY

Property Highlights

- **29,570 +/- SF Plug and play office space available for Sublease**
- Available Q3 2020
- Sublease Expiration Date: March 31, 2027
- Space completely renovated in 2017
- Furniture and fixtures available
- Generator: Caterpillar - 1600 KW, 480 V
- Furniture: EVOLVE workstations, GLOBAL conference rooms, break and huddle rooms and SITONIT seating
- Parking: Abundant surface parking and a 1,200 space parking deck
- Amenities: Corporate campus with walking trails and close proximity to restaurants, retail and hotels.
- Access: Convenient access to Highway 52 and University Parkway
- **Asking Lease Rate: \$15.00 PSF, Full Service (Includes furniture and fixtures)**



Bobby Finch
Executive Managing Director
+1 336 812 3303
bobby.finch@cushwake.com

William Woltz
Vice Chairman
+1 336 821 3824
william.woltz@cushwake.com

Seth Constable
Senior Associate
+1 336 885 7815
seth.constable@cushwake.com

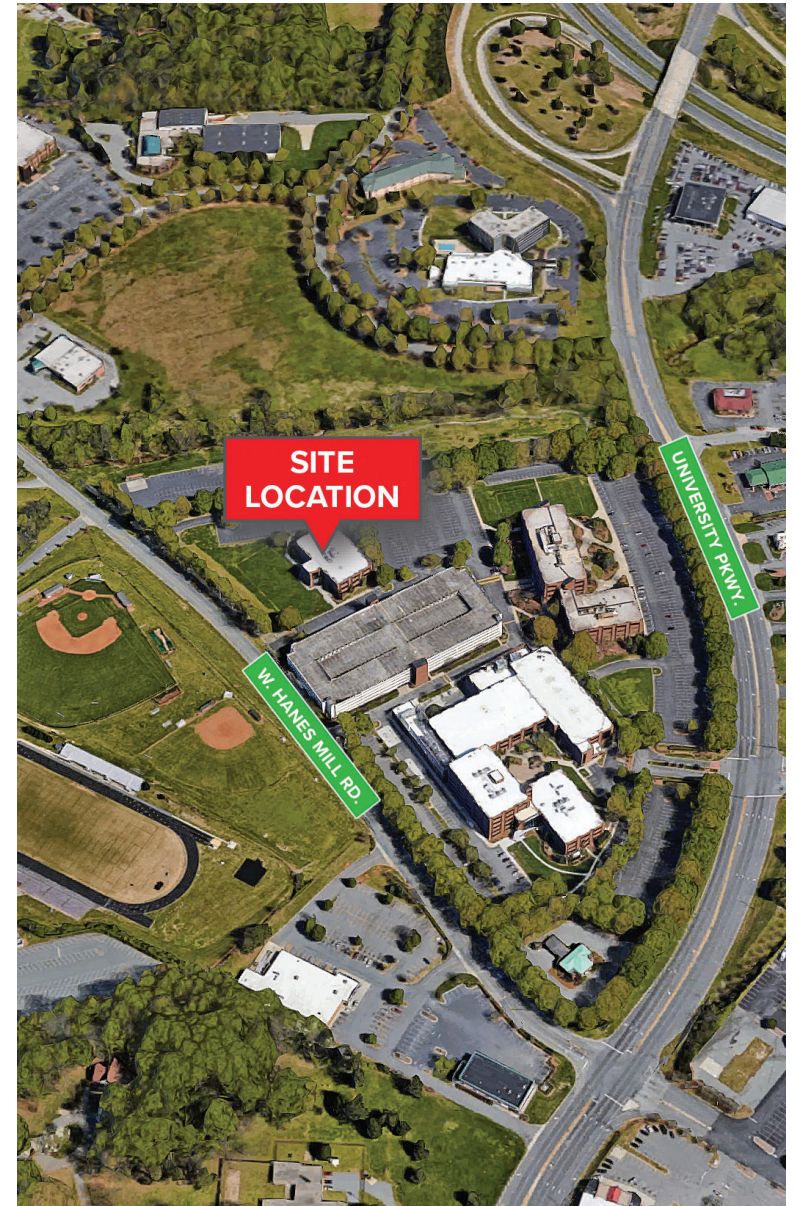



5635 W. Hanes Mill Road – Madison Park

Winston-Salem, NC 27105



Bobby Finch
Executive Managing Director
+1 336 812 3303
bobby.finch@cushwake.com

William Woltz
Vice Chairman
+1 336 821 3824
william.woltz@cushwake.com

Seth Constable
Senior Associate
+1 336 885 7815
seth.constable@cushwake.com

121-D Reynolda Village
Winston-Salem, NC 27106 | USA
Main +1 336 668 9999
Fax +1 336 668 0888
cushmanwakefield.com

2nd Floor

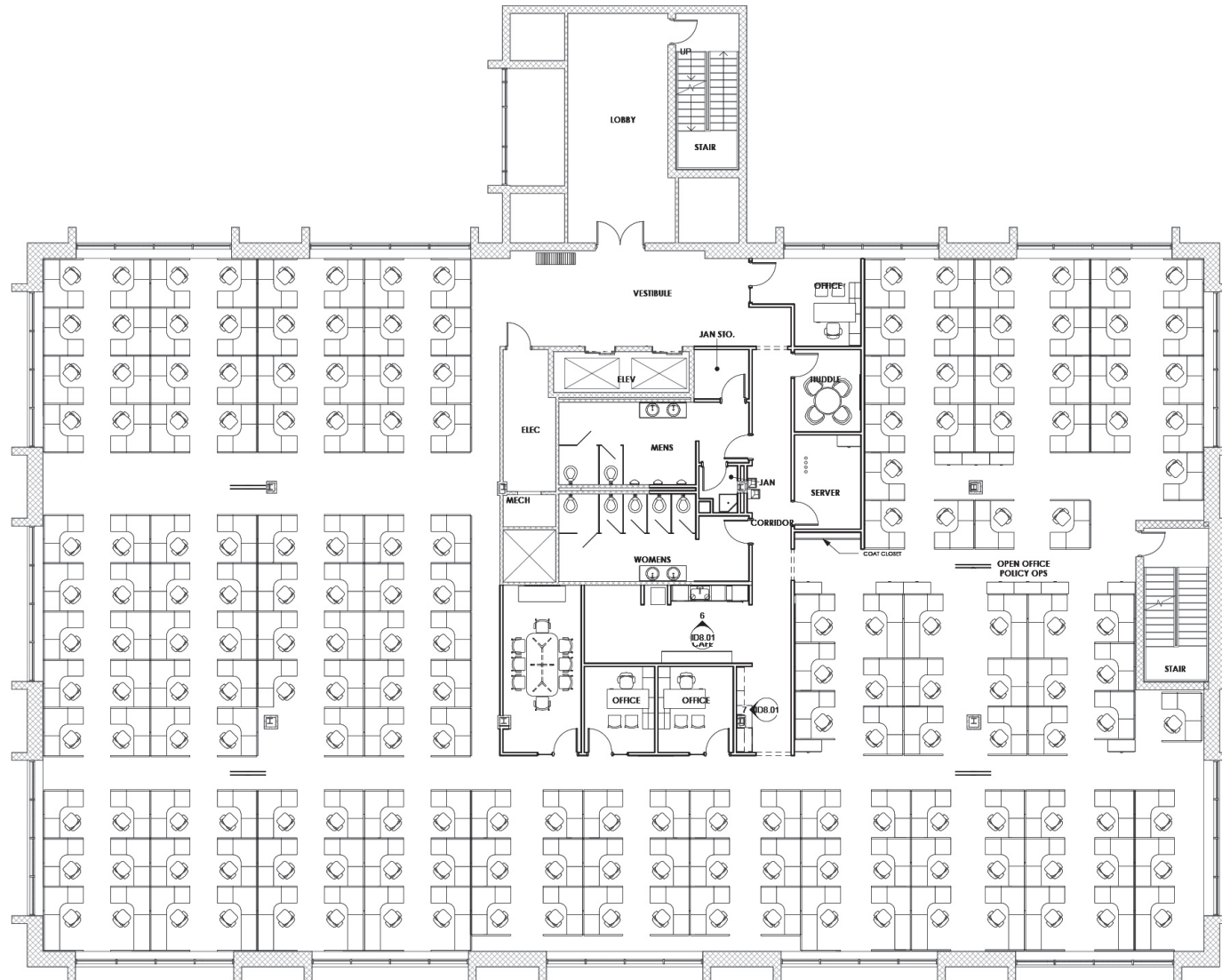

① SPACE PLAN - SECOND FLOOR
1/8" = 1'-0"

3rd Floor

