

703 ANNORENO DRIVE

ADDISON, IL 60101

RARE SMALL INDUSTRIAL SPACE FOR LEASE



OFFERING SUMMARY

Available RSF:	1,505 RSF
Clear Height:	12 Ft. Clear
Loading:	Drive-in Doors
Power:	200 Amps
Fire Protection:	Wet Sprinklers
Access:	24-Hour Access
Parking Ratio:	1/1,000 SF Ratio
Complex Size:	24,038 SF
Lease Rate:	\$13.00 PSF (MG)

PROPERTY HIGHLIGHTS

- Institutionally Owned and Managed
- Conveniently located close to many area restaurants and amenities, close to I- 355

PROFESSIONALLY OWNED AND MANAGED BY



JBSCRE.COM | 650 E DEVON AVE, SUITE 105, ITASCA, IL 60143 | 312.462.1020

JASON SHIBATA
PARTNER
312.462.1022
JASON@JBSCRE.COM

MICHAEL WHETSTONE
SENIOR BROKER
312.462.1024
MICHAEL@JBSCRE.COM

ALL INFORMATION IS DEEMED TO BE RELIABLE BUT NOT GUARANTEED



703 ANNORENO DRIVE

ADDISON, IL 60101

SITE PLAN

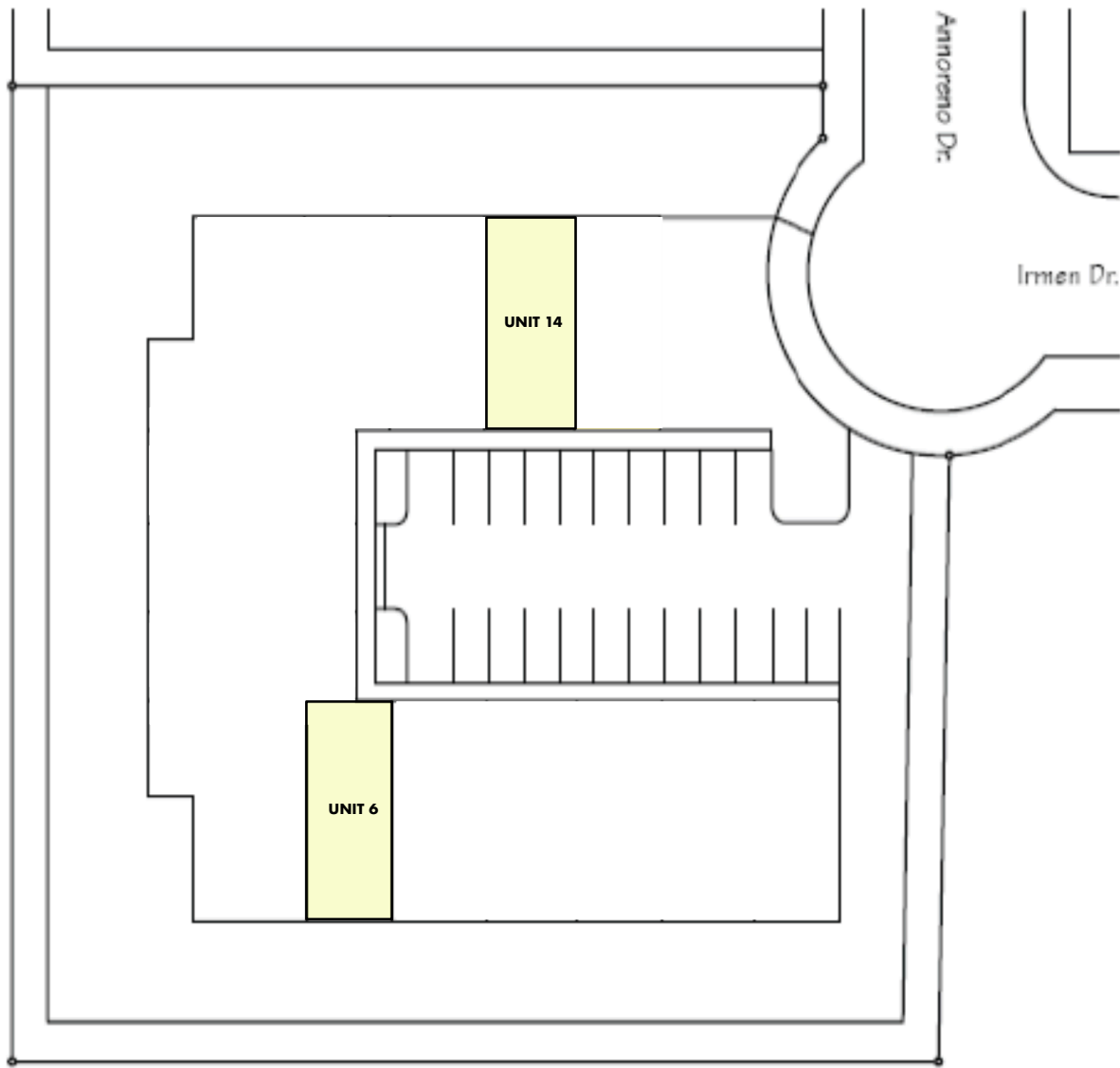

SPACE	LEASE RATE	SIZE (SF)	OFFICE (SF)	LOADING	AVAILABILITY
6	\$13.00 PSF (MG)	1,500 SF	335 SF (22%)	Drive-in Door	December 1, 2025
14	\$13.00 PSF (MG)	1,505 SF	335 SF (22%)	Drive-in Door	December 1, 2025

JBSCORE.COM | 650 E DEVON AVE, SUITE 105, ITASCA, IL 60143 | 312.462.1020

JASON SHIBATA
PARTNER
312.462.1022
JASON@JBSCORE.COM

MICHAEL WHETSTONE
SENIOR BROKER
312.462.1024
MICHAEL@JBSCORE.COM

ALL INFORMATION IS DEEMED TO BE RELIABLE BUT NOT GUARANTEED

