

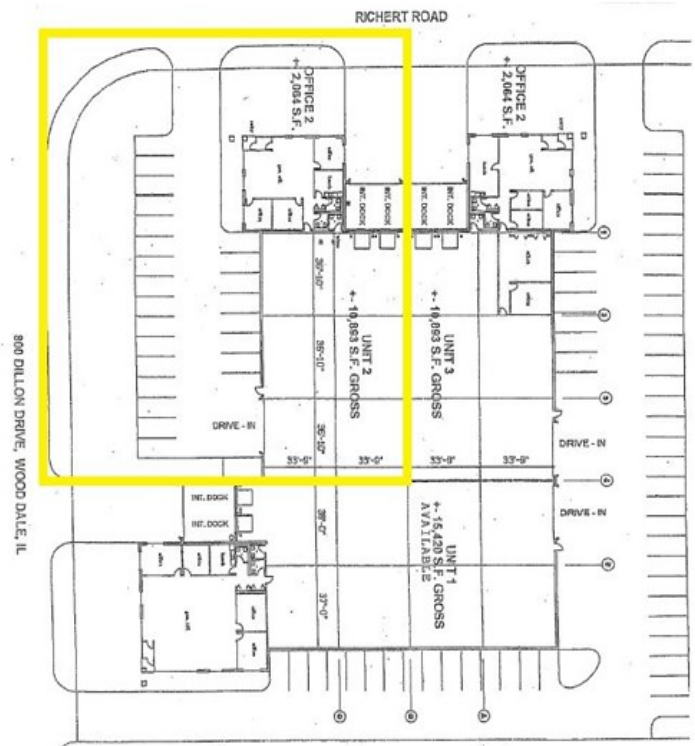

Building a better image.

Building Highlights

- 87,636 s.f. +/- Gross Land
- 37,206 s.f. +/- Total Building
- 10,893 s.f. +/- 345 Richert Unit Available
- 2,064 s.f. +/- Total Office
- 18' +/- Clear
- 23 Car Stalls
- 2 Interior Docks
- 1 Drive In Door (12' x 12')
- 200 Amps, 120/240 Volt, 3-Phase, 4-Wire
- Gas Unit Heaters
- Air Conditioned Office
- Sprinklers
- I-1 Industrial
- DuPage County
- Rental Rate: Subject to Offer
- CAM: Lessee Responsibility
- Ideal for Sales Office, Showroom, Warehouse & Distribution



CONTACT: Giovanni Gullo or Mariann Gullo Phone: 847.364.7000 • Fax: 847.364.7030 • Email: info@gullo.com

Gullo International Realty Group • 1100 Landmeier Road • Elk Grove Village, IL 60007

All information herein is from sources deemed reliable but not guaranteed accurate. Subject to errors, omissions, and to change of price and terms, prior sale or lease, all without notice. In compliance with Illinois law, Gullo International Realty Group (broker) hereby gives written notice of the existence of an agency relationship between broker and the owner of the above referenced property. All Gullo International Realty Group real estate agents represent the owner of the above property in negotiation of price terms, conditions, and the consummation of any lease or sale contract.