



AIRPORT EAST INDUSTRIAL PARK

4915-4995 Steptoe Street, Las Vegas, NV 89122

FOR LEASE

DOCK-HI INDUSTRIAL UNITS AVAILABLE

MIKE WILLMORE

Senior Associate
(702) 369-4823
mike.willmore@cbre.com
Lic. # S.0183520

ALEX STANISIC, SIOR

First Vice President
(702) 369-4874
alex.stanisic@cbre.com
Lic. # S.0179950

LAUREN WILLMORE

Senior Associate
(702) 369-4825
lauren.willmore@cbre.com
Lic. # S.0188698

KYLE KIRCHMEIER

Senior Associate
(702) 369-4862
kyle.kirchmeier@cbre.com
Lic. # S.0197013

DEAN WILLMORE, SIOR

Executive Vice President
(702) 369-4808
dean.willmore@cbre.com
Lic. # BS.0023886

CBRE

PROPERTY HIGHLIGHTS

Airport East Industrial Park is located off East Tropicana Avenue and Steptoe Street, with an average daily traffic exceeding 20,000 cars. There is easy access to Boulder Highway via Tropicana, and the Property is minutes from I-93 and I-515 freeways. The Industrial buildings are zoned IP (Industrial Park). The project consists of five (5) multi-tenant industrial buildings for a total of $\pm 177,889$ SF situated on approximately 11.54 acres. Airport East Industrial park offers a parking ratio of 2.00 per 1,000 SF, and numerous retail and service amenities are near the site.



PROJECT SIZE
 $\pm 177,881$ SF



POWER
120/208V, 3 PHASE



ACREAGE
 ± 11.54



PARKING RATIO
2.0/1000 SF



ZONING
IP (INDUSTRIAL PARK)
CITY OF HENDERSON



SPRINKLER SYSTEM
FULLY FIRE SPRINKLERED



GRADE LEVEL DOORS
 $\pm 12' \times \pm 16'$



YEAR BUILT
2000



DOCK-HI DOORS
 $\pm 9' \times \pm 10'$



APN
161-270-114-001



CLEAR HEIGHT
 $\pm 24'$



SITE PLAN

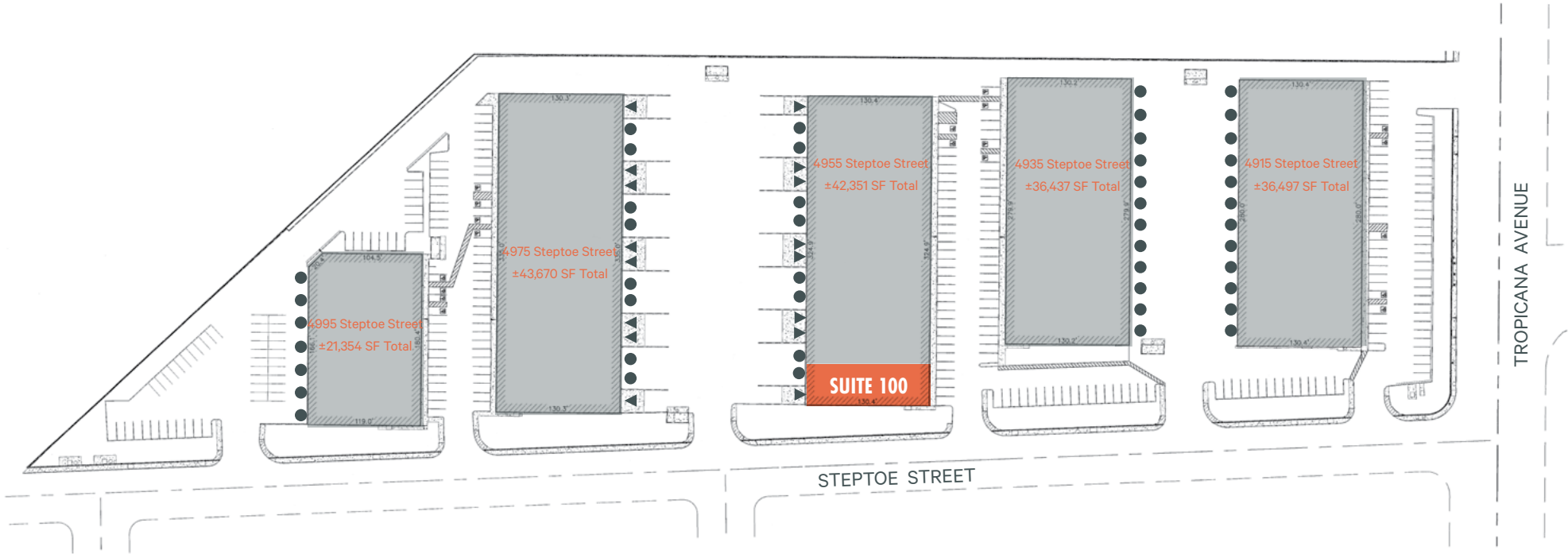

- = Available
- ▲ = Dock-Hi Doors
- = Grade-Level Doors

*not to scale
*all measurements are approximate

AVAILABLE JUNE 2026

Building 4955 Suite 100

- 5,700 Total SF
- 660 SF of HVAC Office Space
- 5,040 SF Evaporative-Cooled Warehouse
- One (1) Private Office
- One (1) Restroom
- Reception
- Break Room
- 24' Clear Height
- 120/208 Volt, 3-Phase Power
- One (1) 12' x 16' Grade Level Roll-Up Door
- One (1) 9' x 10' Dock-Hi Door

LEASE RATE : \$1.25/SF (NNN)

CAMS : \$0.165/SF

TOTAL MONTHLY : \$8,065.50

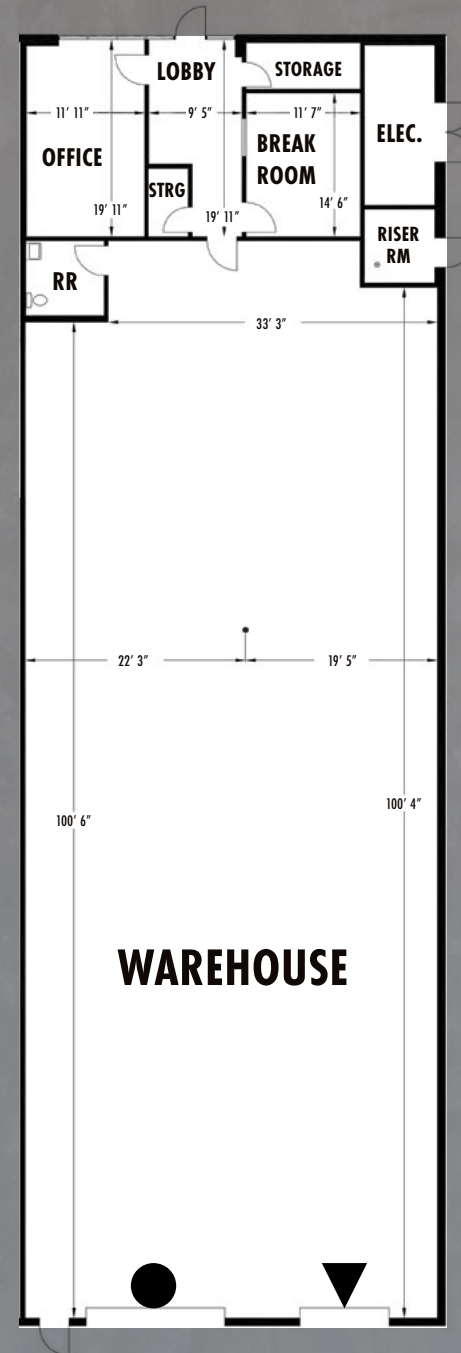

▲ = Dock-Hi Doors
● = Grade-Level Doors

AERIAL MAP

AIRPORT EAST INDUSTRIAL PARK



AIRPORT EAST INDUSTRIAL PARK

4915-4995 Steptoe Street, Las Vegas, NV 89122

DOCK-HI INDUSTRIAL UNITS AVAILABLE



CONTACT US

MIKE WILLMORE

Senior Associate
(702) 369-4823
mike.willmore@cbre.com
Lic. # S.0183520

ALEX STANISIC, SIOR

First Vice President
(702) 369-4874
alex.stanisic@cbre.com
Lic. # S.0179950

LAUREN WILLMORE

Senior Associate
(702) 369-4825
lauren.willmore@cbre.com
Lic. # S.0188698

KYLE KIRCHMEIER

Senior Associate
(702) 369-4862
kyle.kirchmeier@cbre.com
Lic. # S.0197013

DEAN WILLMORE, SIOR

Executive Vice President
(702) 369-4808
dean.willmore@cbre.com
Lic. # BS.0023886

© 2026 CBRE, Inc. All rights reserved. This information has been obtained from sources believed reliable but has not been verified for accuracy or completeness. You should conduct a careful, independent investigation of the property and verify all information. Any reliance on this information is solely at your own risk. CBRE and the CBRE logo are service marks of CBRE, Inc. All other marks displayed on this document are the property of their respective owners, and the use of such logos does not imply any affiliation with or endorsement of CBRE. Photos herein are the property of their respective owners. Use of these images without the express written consent of the owner is prohibited.

CBRE