

380

# FIFTH AVENUE

BETWEEN 35TH & 36TH STREETS | HERALD SQUARE



# 380 FIFTH AVENUE

BETWEEN 35TH & 36TH STREETS | HERALD SQUARE

## PROPERTY HIGHLIGHTS

- Across the street from CUNY Graduate Center
- Above the NW Corner of W 35th St.
- One block north of the Empire State Building
- The Empire State Building attracts over 4.3 million visitors each year
- Walking distance to Madison Square Garden & Penn Station

### SIZE

Ground Floor	5,000 SF
+ Mezzanine	2,350 SF
<b>Total</b>	<b>7,350 SF</b>

### FRONTAGE

50'

### CEILING HEIGHTS

18'

### POSSESSION

Arranged

### ASKING RENT

Upon Request

### TRANSPORTATION



### NEIGHBORS



CONTACT OUR BROKERS FOR MORE INFORMATION:

**MARC SITT**  
MSitt@ksrny.com

**917.757.8863**

**DOREL MELLOUL**  
DMelloul@ksrny.com

**347.992.4563**



All information supplied in this marketing presentation and/or flyer is from sources deemed reliable and is furnished subject to errors, omissions, modifications, removal of listings from sale/lease and to any listing condition. Any square footage, dimensions, floor plans and/or technical data set forth are approximations and are subject to further elaboration/confirmation.

# 380 FIFTH AVENUE

BETWEEN 35TH & 36TH STREETS | HERALD SQUARE

## FLOORPLANS

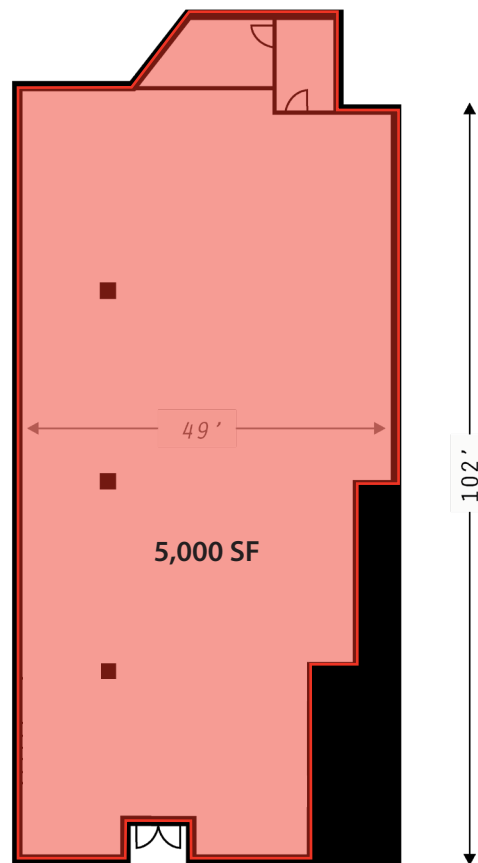

**GROUND FLOOR**

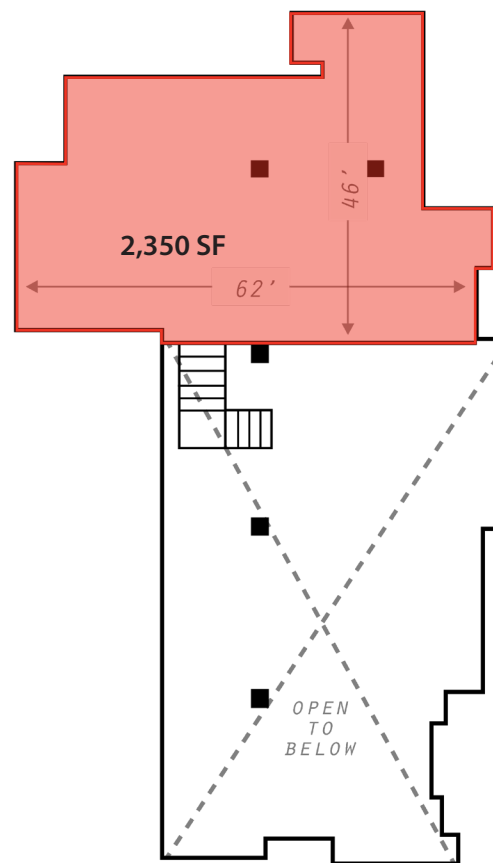

**MEZZANINE**

CONTACT OUR BROKERS FOR MORE INFORMATION:



All information supplied in this marketing presentation and/or flyer is from sources deemed reliable and is furnished subject to errors, omissions, modifications, removal of listings from sale/lease and to any listing condition. Any square footage, dimensions, floor plans and/or technical data set forth are approximations and are subject to further elaboration/confirmation.

**MARC SITT**  
MSitt@ksrny.com

**917.757.8863**

**DOREL MELLOUL**  
DMelloul@ksrny.com

**347.992.4563**