

## 1350 Tidwell Dr, Alpharetta, GA 30004



### *PROPERTY DESCRIPTION*

**This well-maintained office space offers four private offices, a spacious open area ideal for a conference room or team meetings, a dedicated storage room, and two private bathrooms. The unit is freshly painted, vacant, and move-in ready, with ample parking on site. Located in a highly accessible area just minutes from GA 400, this property provides a great location at an excellent price—ideal for businesses seeking both convenience and value.**

**CONTACT:**



CATHERINE CLARK  
CATHERINE.CLARK@KW.COM  
(404) 388-0758



# FOR LEASE

1350 Tidwell Dr, Alpharetta, GA 30004



**CONTACT:**



CATHERINE CLARK  
CATHERINE.CLARK@KW.COM  
(404) 388-0758

# FOR LEASE

1350 Tidwell Dr, Alpharetta, GA 30004

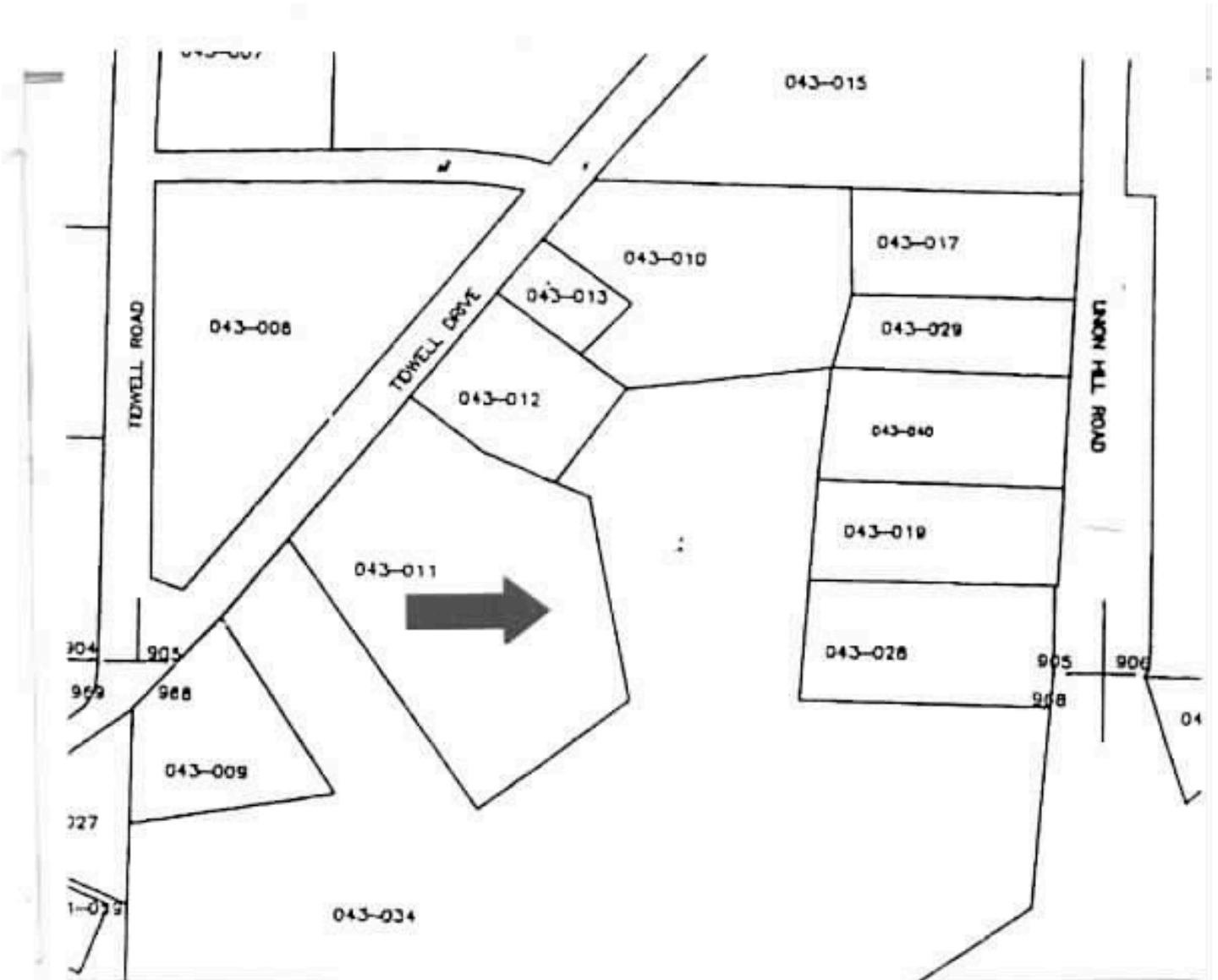

**CONTACT:**



CATHERINE CLARK  
CATHERINE.CLARK@KW.COM  
(404) 388-0758



# FOR LEASE

## 1350 Tidwell Dr, Alpharetta, GA 30004

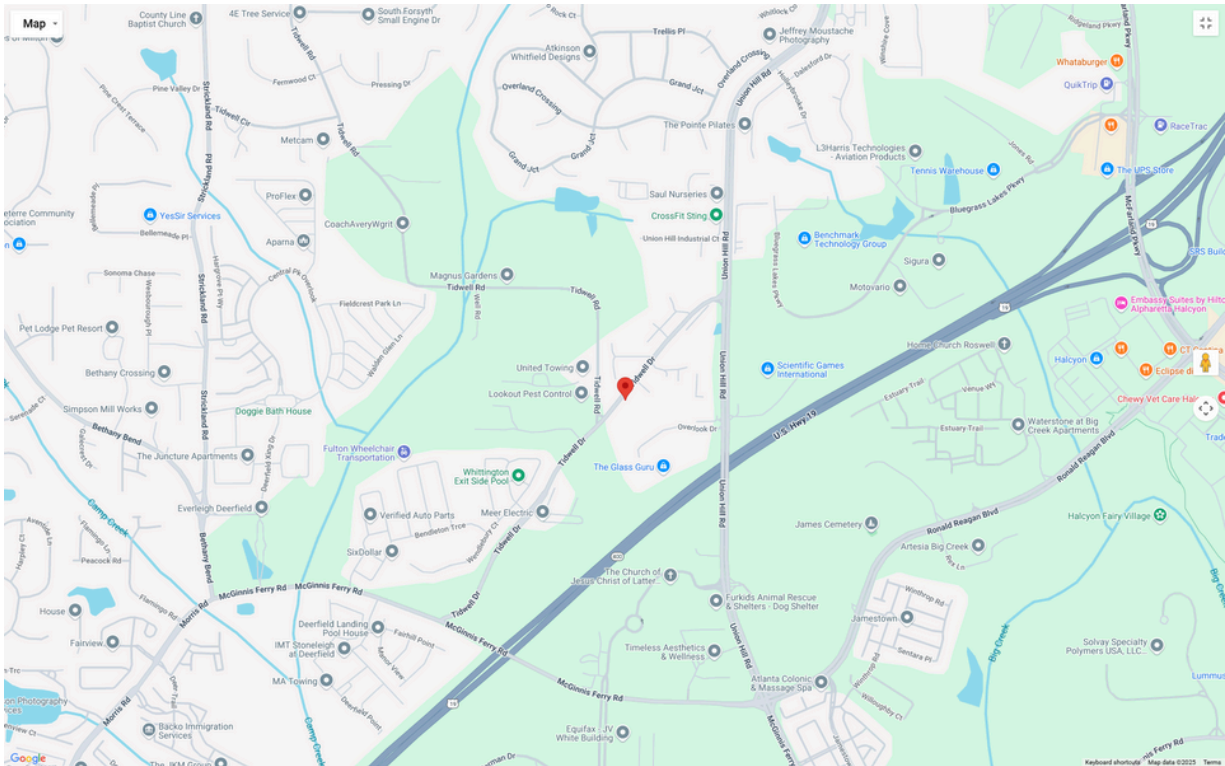

### LOCATION DESCRIPTION:

Ideally located in Alpharetta with easy access to GA 400, this property offers convenience to major business hubs, dining, and local amenities—making it a prime spot for growing companies.

### PROPERTY HIGHLIGHTS

- **Flexible Layout:** Features 4 private offices plus a large open area perfect for a conference room, team collaboration, or training space
- **Convenience Built In:** Includes 2 private, in-suite bathrooms and a dedicated storage area for added functionality
- **Abundant Parking:** Plenty of on-site parking available for staff and visitors
- **Prime Alpharetta Location:** Strategically located with easy access to GA 400, restaurants, and business services

**CONTACT:**



CATHERINE CLARK  
CATHERINE.CLARK@KW.COM  
(404) 388-0758