



# ONE CAMPUS MARTIUS

Detroit, MI 48226

# BUSINESSES + TALENT ARE CHOOSING DETROIT



The Detroit region is home to more than 120,000 businesses, 17 Fortune 1000 companies, 5.4 million people and some of the top educational institutions in the world. The business-friendly region has the talent, resources and cutting-edge facilities that drive innovation.



## AFFORDABILITY

The cost of space and talent in Detroit is lower than in other major markets, which allows for more investment opportunities.

## TALENT

The Detroit region leads the nation in engineers per capita, thanks in large part to its proximity to world-renowned colleges and universities that issue thousands of STEM degrees each year.

## CAPACITY

In 2021, Michigan continued its strong economic recovery with a 10.29% growth in real GDP. Bloomberg ranked Michigan's economic improvement the best among the 37 states with a population greater than 2 million.

## BUSINESS-FRIENDLY

After reworking its approach to business and development this decade, Detroit and the state of Michigan have adapted their respective approaches to attracting and retaining businesses. In 2023, CNBC ranked Michigan #10 in America's Top States for Business.<sup>1</sup>

## MILLENNIAL POPULATION GROWTH

# +52%



The population of adults ages 25-34 in Greater Downtown Detroit has increased by 52% since 2013.<sup>2</sup>

## INCREASED SPENDING POWER

# \$11.4B

Greater Downtown Detroit tallied a total annual earnings of \$11.4B in 2022.<sup>2</sup>

1. CNBC's America's Top States for Business 2023  
2. Lightcast.io, Q3 2023

# DETROIT'S CONNECTIVITY

DETROIT IS A MAJOR POINT FOR EAST-TO-WEST U.S. FLIGHT CONNECTIONS

## PASSENGER SATISFACTION

**#1 RATED AIRPORT**

DTW has the highest customer satisfaction rating among mega airports in North America, as rated by JD Power.<sup>1</sup>

## DAILY FLIGHTS

**1,100+**

Detroit is a major Delta hub and focus city for Spirit Airlines. The airport is home to 17 scheduled passenger airlines with flights to and from more than 140 nonstop destinations on 4 continents.<sup>2</sup>

## ON-TIME FLIGHTS

**#3 MOST PUNCTUAL**

DTW is ranked the third most-punctual airport in the U.S. in 2024.<sup>3</sup>

**36M+** ANNUAL PASSENGERS<sup>2</sup>

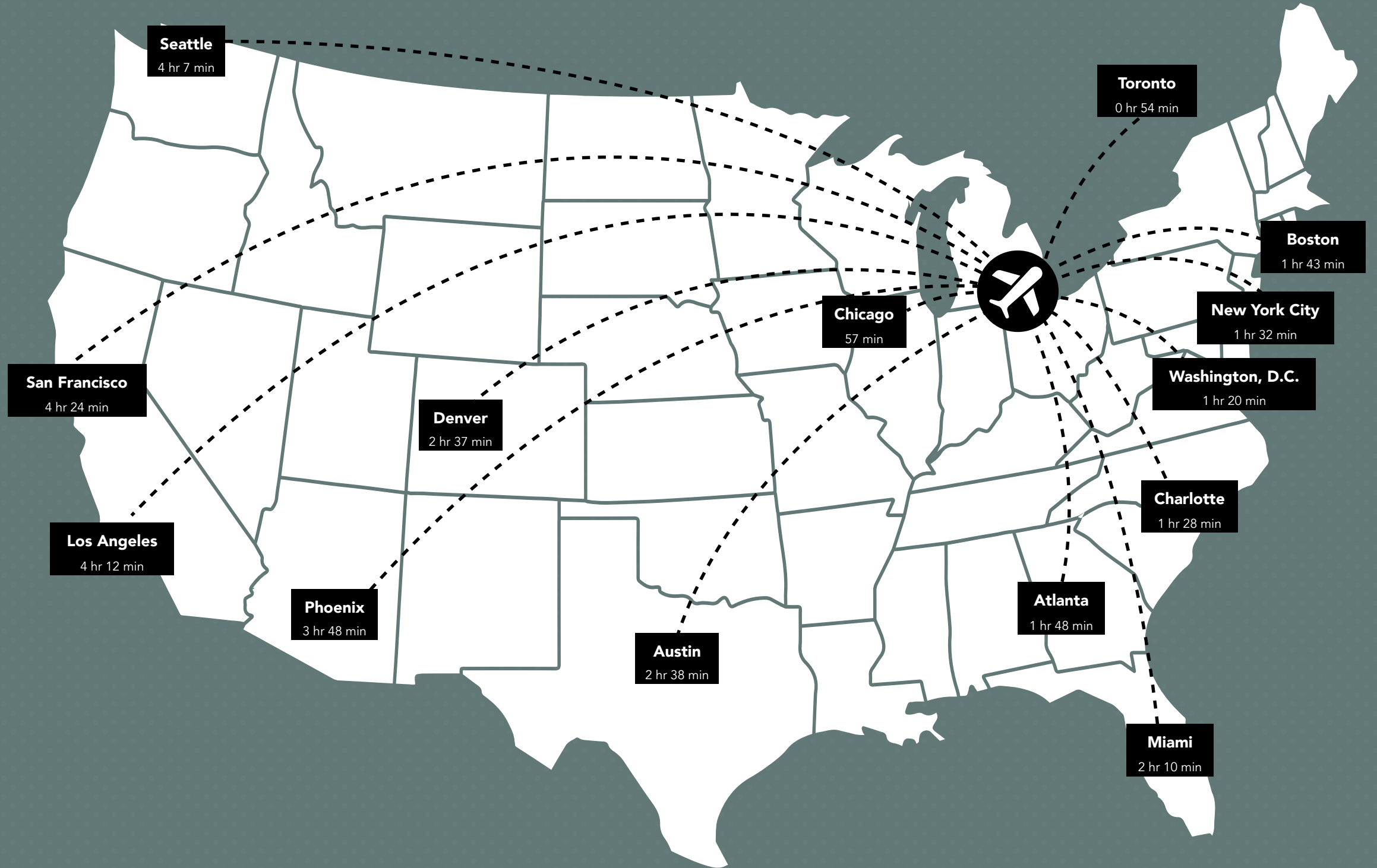

1. J.D. Power 2023 Customer Satisfaction Survey  
 2. Detroit Metro Airport  
 3. Detroit Free Press

# BUILDING TALENT

Southeastern Michigan is home to one of the most robust higher-education regions, with schools like the University of Michigan, Michigan State University and Wayne State University annually ranking among the best research institutions in the nation each year.

The Detroit region employs nearly 300,000 people in science, technical, engineering and math (STEM) occupations.

From high-tech to skilled trades, Michigan is on its way to becoming one of the top states in the nation for job creation. Developing talent for jobs that are in-demand right now and in the future is a top priority for the state.



University of Michigan

**2.5X THE NATIONAL AVERAGE**

The city's STEM occupation job growth is nearly triple the national average rate since 2010.<sup>1</sup>

## 2ND IN INNOVATION POWER

The University Research Corridor (URC) is a collaborative partnership with the University of Michigan, Michigan State University and Wayne State University.

Their research has led to advancements in medicine, mobility and business, and the most recent study showed that the URC had a statewide economic impact of \$18.7 billion and generated 78,845 jobs.

URC is the number-one university cluster in the United States, not only attracting talent from around the world, but also delivering one of the strongest talent bases in the country. Additionally, URC is ranked second in innovation power in the nation – using talent, technology, research and development as metrics.<sup>2</sup>

1. Lightcast Q4 2022

2. University Research Corridor 2019 Annual Report

## EDUCATION + TALENT

MAJOR UNIVERSITIES WITHIN 300 MILES OF DETROIT<sup>1</sup>

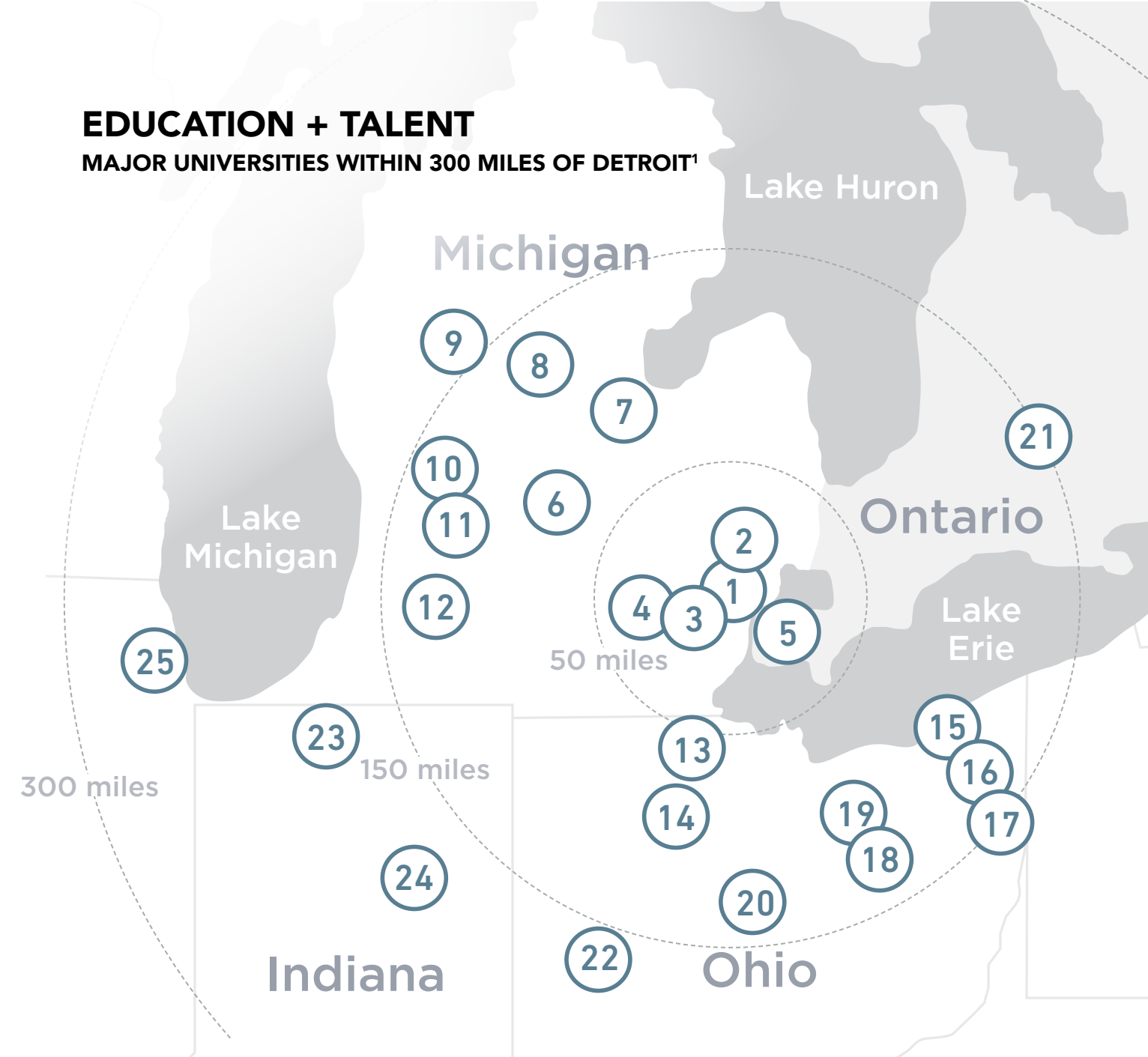

- |                                   |                                    |
|-----------------------------------|------------------------------------|
| 1 Wayne State University          | 14 Bowling Green University        |
| 2 Oakland University              | 15 Cleveland State University      |
| 3 Eastern Michigan University     | 16 Case Western Reserve University |
| 4 University of Michigan          | 17 Youngstown State University     |
| 5 University of Windsor           | 18 Kent State University           |
| 6 Michigan State University       | 19 University of Akron             |
| 7 Saginaw Valley State University | 20 The Ohio State University       |
| 8 Central Michigan University     | 21 University of Waterloo          |
| 9 Ferris State University         | 22 University of Dayton            |
| 10 Grand Valley State University  | 23 University of Notre Dame        |
| 11 Davenport University           | 24 Ball State University           |
| 12 Western Michigan University    | 25 University of Illinois          |
| 13 University of Toledo           |                                    |

### DEGREES AWARDED FROM REGIONAL COLLEGES IN 2021<sup>2</sup>

<b>265,437</b>	BACHELOR'S DEGREES
<b>110,340</b>	MASTER'S DEGREES
<b>97,925</b>	ASSOCIATE'S DEGREES
<b>27,813</b>	DOCTORAL DEGREES

# A CITY WORTH VISITING

Greater Downtown Detroit experiences more than 65 million visits annually, with visitors traveling from throughout Southeastern Michigan and the Midwest to attend a game, concert, special event or festival.<sup>1</sup> With all four major league sports teams within a four-block radius, Detroit hosts 171 regular season games every year.

## 15 MAJOR MUSEUMS WITHIN DETROIT

There are 15 major museums within Greater Downtown including the Detroit Institute of Arts, Charles H. Wright Museum of African American History, Museum of Contemporary Art Detroit, Detroit Historical Museum, Motown Museum. There are 150 museums in the Southeast Michigan region.



Motown Museum

## VISITORS TO DOWNTOWN DETROIT 8M+

In 2023, Greater Downtown Detroit welcomed 8.1 million unique annual visitors.<sup>1</sup>

## TOTAL CONCERTS 250+

Detroit hosted over 250 concerts in 2023. From large arenas like Little Caesars to historical spaces like The Fox Theatre, Detroit is a destination for concertgoers.

## HOTEL ROOMS 5,400+

Detroit has over 5,400 hotel rooms with another 1,589 rooms currently under development.<sup>2</sup>

## DOWNTOWN RETAILERS 320+

There are more than 320 retailers, from nationally known brands to locally owned establishments in the Central Business District.<sup>3</sup>



Woodward Retail



Afro Nation



Jazz Fest



Campus Martius Park



Woodward Avenue

1. Placer.ai data  
2. Downtown Detroit Partnership  
3. ESRI Business Summary

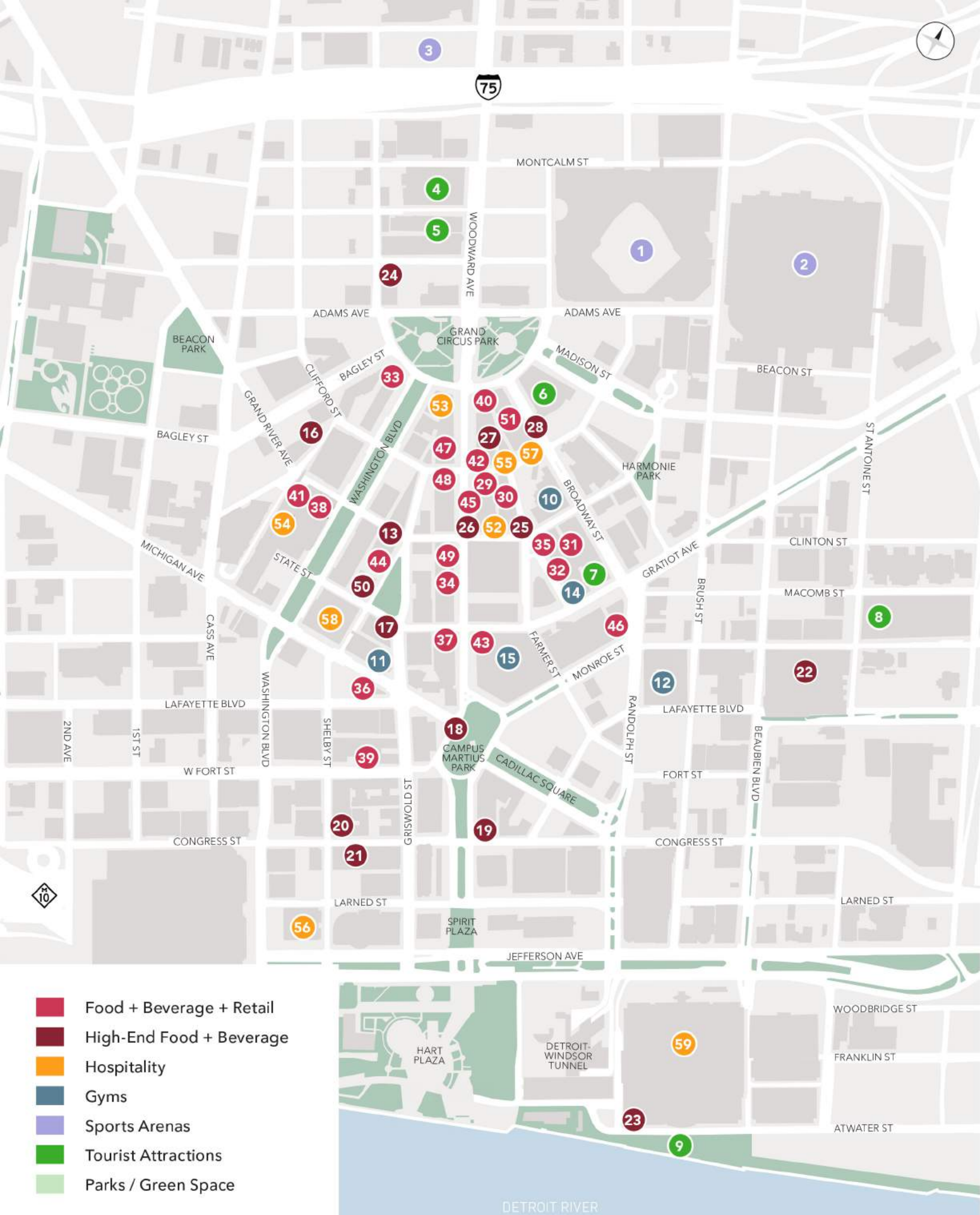

- Food + Beverage + Retail
- High-End Food + Beverage
- Hospitality
- Gyms
- Sports Arenas
- Tourist Attractions
- Parks / Green Space

# DETROIT CENTRAL BUSINESS DISTRICT

KEY	
	Bedrock Owned/Controlled
	Bedrock Owned/Controlled - Development
	Bedrock Owned Parking
	QLINE Route
	People Mover Route

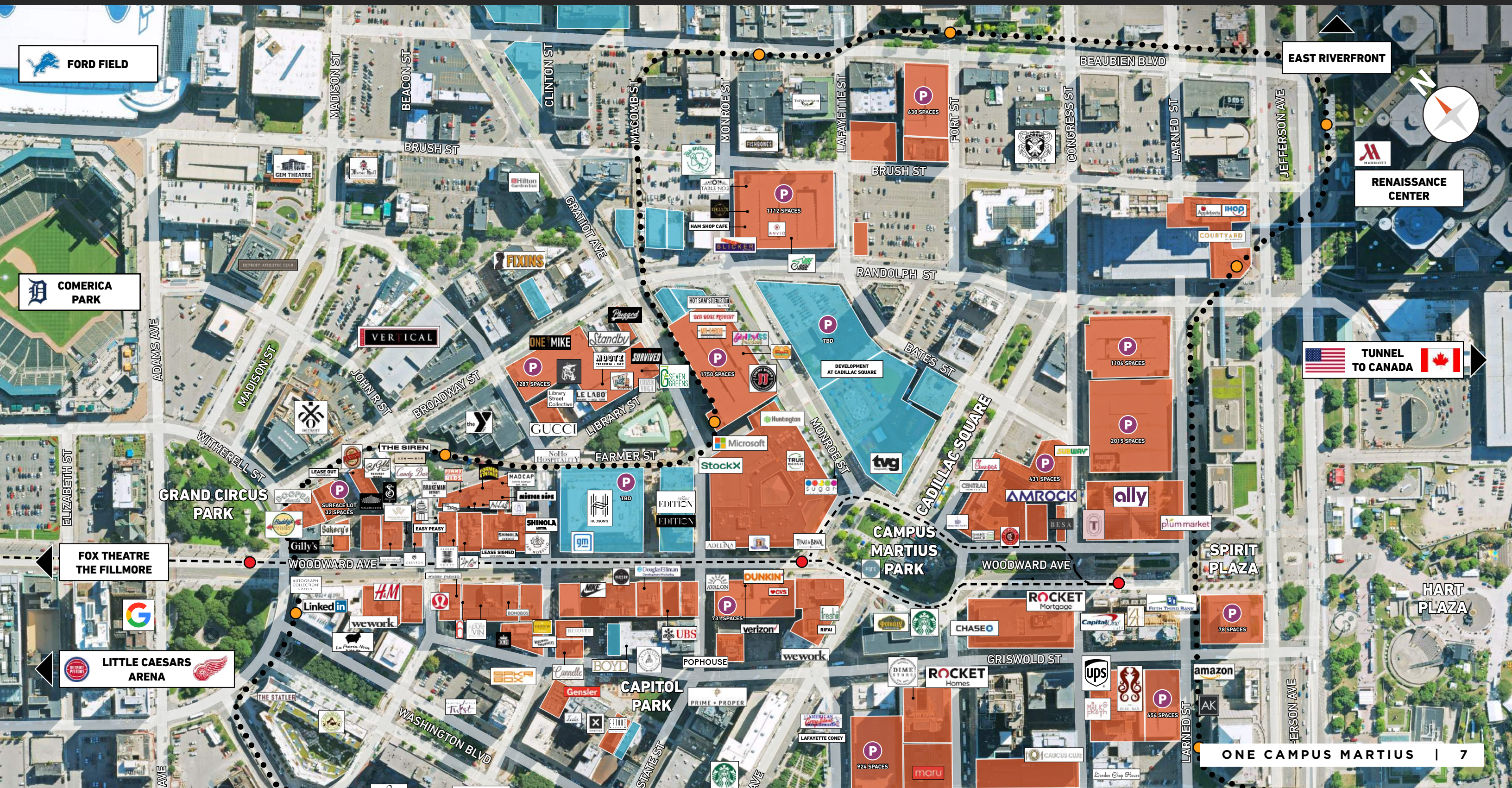

FORD FIELD

COMERICA PARK

FOX THEATRE THE FILLMORE

LITTLE CAESARS ARENA

EAST RIVERFRONT

RENAISSANCE CENTER

TUNNEL TO CANADA

SPRIT PLAZA

HART PLAZA

# ABOUT BEDROCK

Bedrock is a full-service real estate firm specializing in innovative city building strategies. Since its founding in 2011, Bedrock and its affiliates have invested and committed more than \$7.5 billion to acquire, develop and operate more than 140 properties in Detroit and Cleveland with landmark developments at Hudson's Detroit, Book Tower, City Modern, Tower City and the May Company Building.

Bedrock's projects include new construction, adaptive reuse and a portfolio totaling more than 21 million square feet of office, retail, residential, industrial, hospitality and parking.



## BEDROCK PROPERTIES

# 140+

Bedrock has over 140 properties in Detroit and Cleveland.

## SQUARE FOOTAGE

# 21M+

Bedrock's portfolio includes over 21 million square feet in Detroit and Cleveland.

## OFFICE + RETAIL TENANTS

# 400+

With award-winning tenant relation programs and a customer-focused team, Bedrock prides itself on providing the best care and service to its buildings and tenants.



Property Management



Leasing + Acquisition



Construction



Development

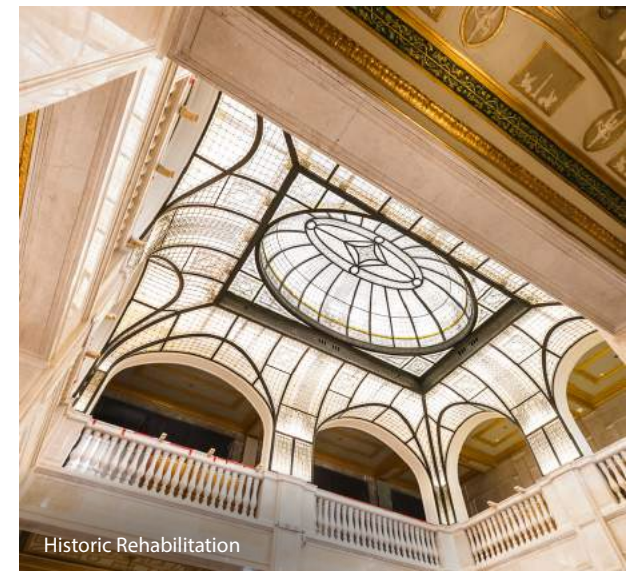

Historic Rehabilitation



**MAIN LOBBY/ENTRANCE**



**RETAIL - SUGAR FACTORY**



**DAYCARE CENTER**



**FITNESS CENTER**

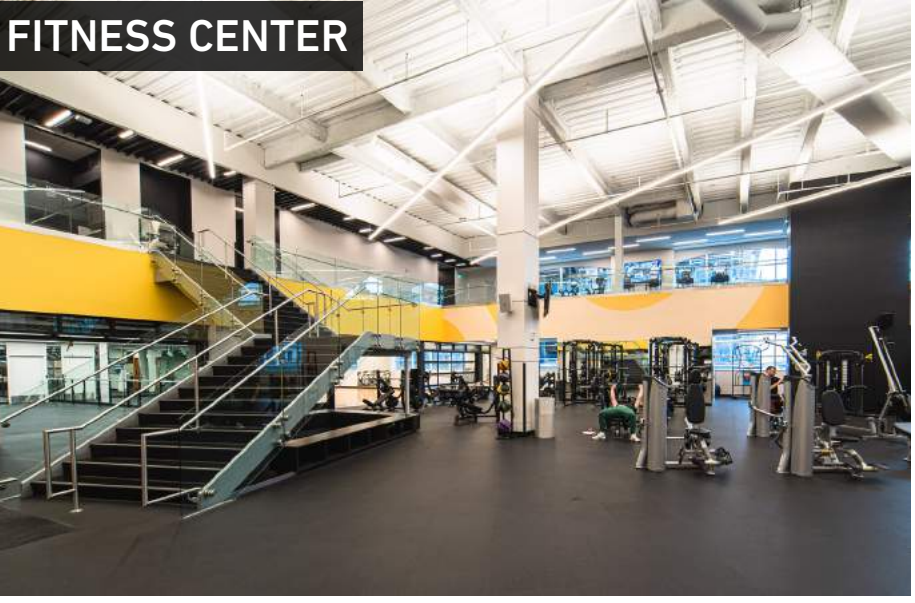

**CONFERENCE & EVENT CENTER**

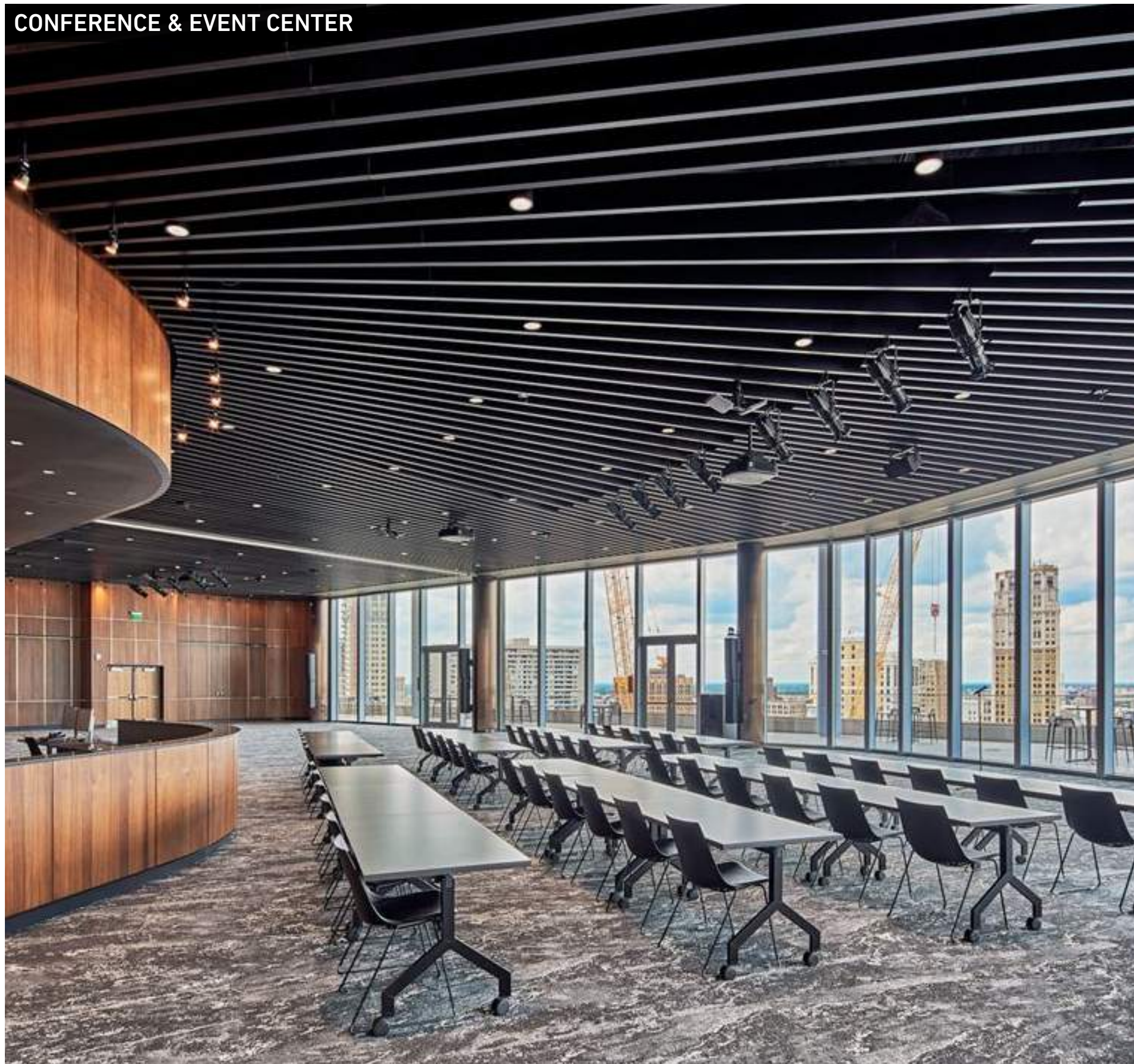

**SECURITY DESK**

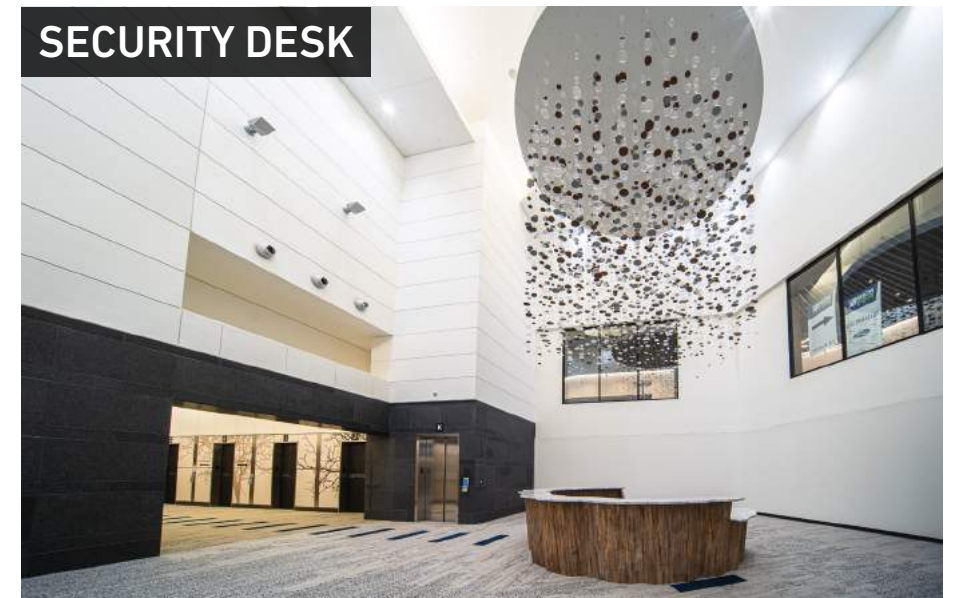

**BALCONY**



**OFFICE SPACE**

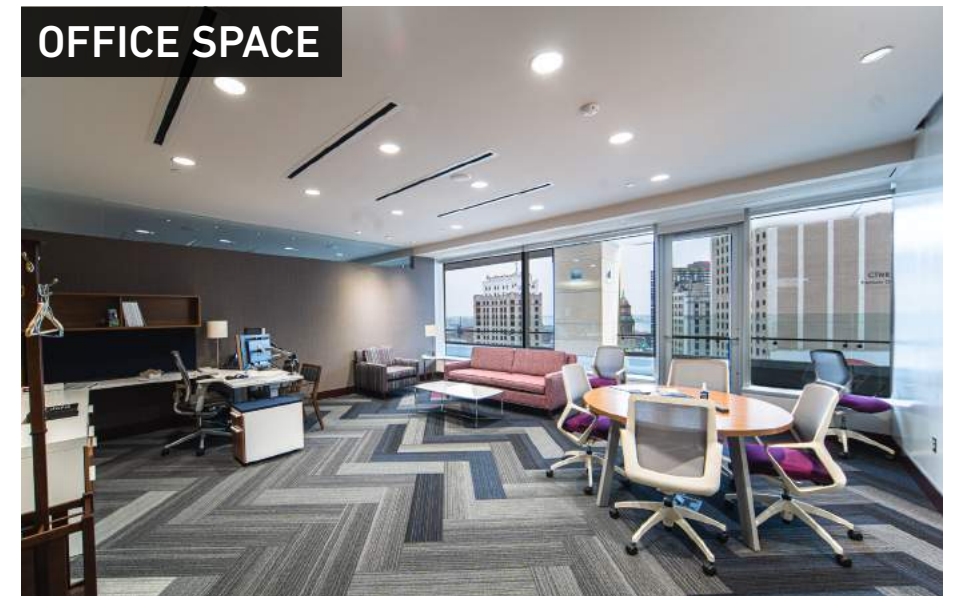

RECEPTION AREA



IN-SUITE LOUNGE



OFFICE SPACE



CONFERENCE ROOM



**OFFICE SPACE**



**OFFICE SPACE**



**OFFICE SPACE**

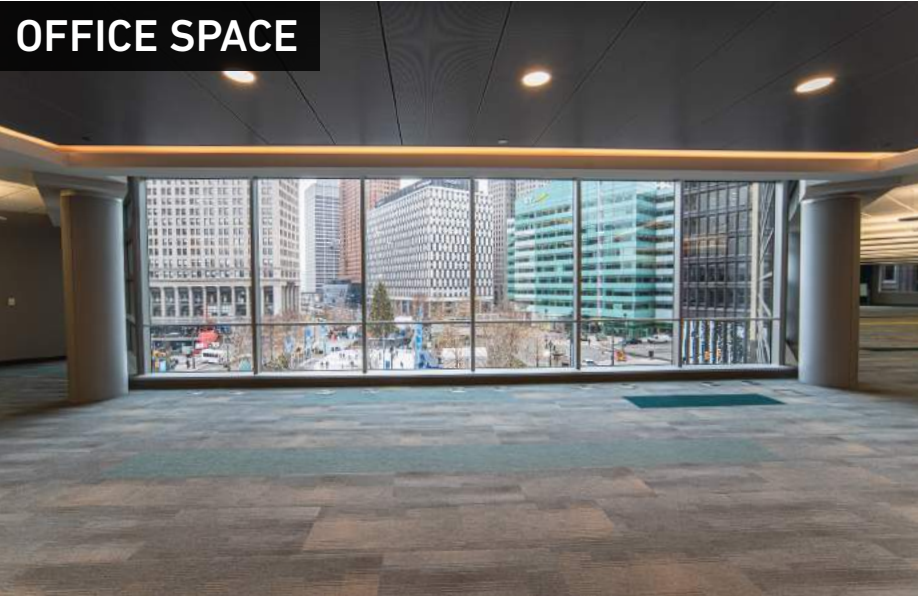

**OFFICE SPACE**





# ONE CAMPUS MARTIUS

PROPERTY DETAILS	
eCode	236
Total Building Size	1,295,089 SF
Location	Detroit, MI
Parking Spaces	±1750
Signage	Yes
Year Built/Renovated	2003/2020
Property Type	Office
Rental Rate	Contact Broker

## HIGHLIGHTS

- Landmark Class A office building
- Up to ± 263,055 SF available - best office space in southeast Michigan
- Large floor plates
- Adjacent to Campus Martius Park, high end retailers, and fine dining
- On-site fitness center, daycare, and event space
- Soaring lobby atrium & waterfall
- Professionally owned and managed by Bedrock Management Services LLC
- Attached covered parking in One Campus Garage
- Prominent building signage and interior/exterior monument signage available

## AMENITIES

- Fitness center
- 1st floor dining & retail
- Daycare
- Signature event/meeting space
- Attached parking garage
- Atrium

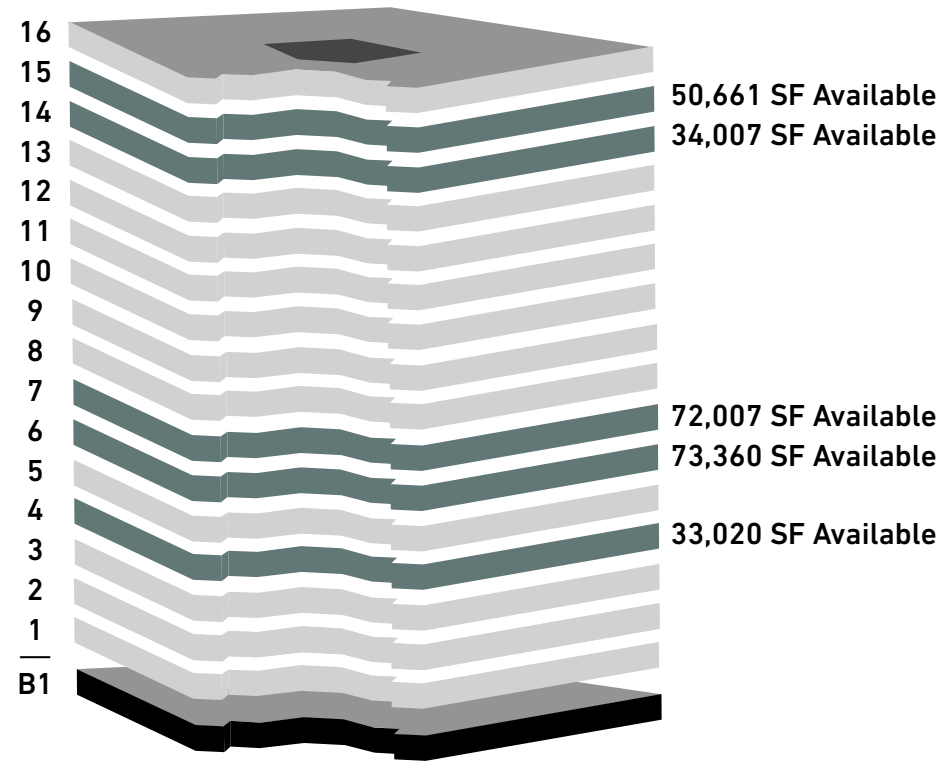

① Top of Building Signage



② Lower Building Signage

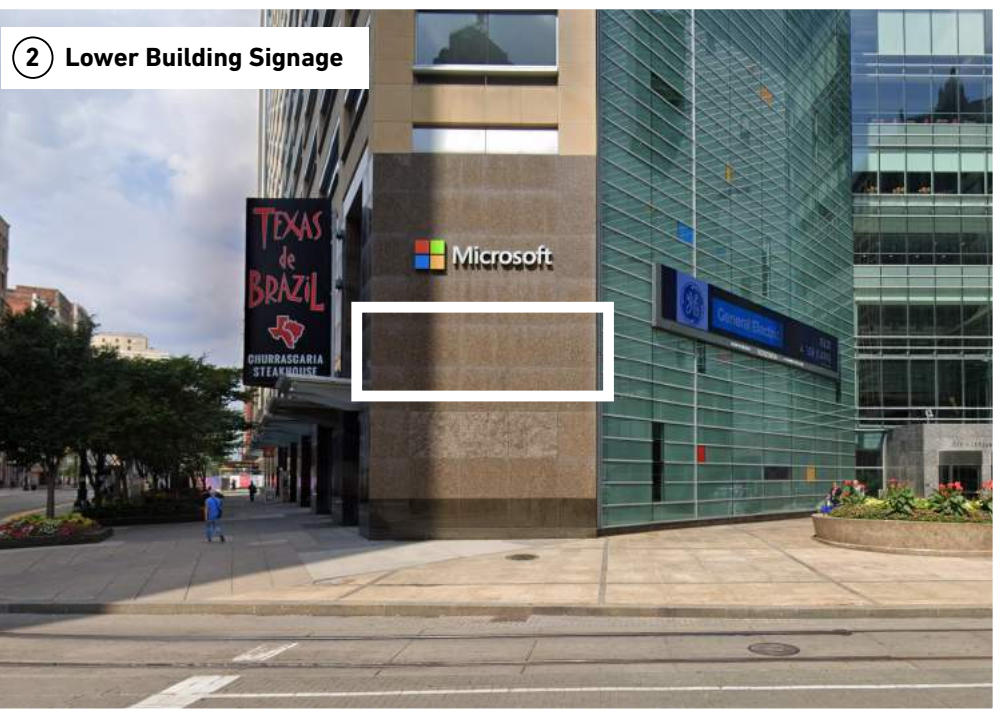

③ Monument Signage

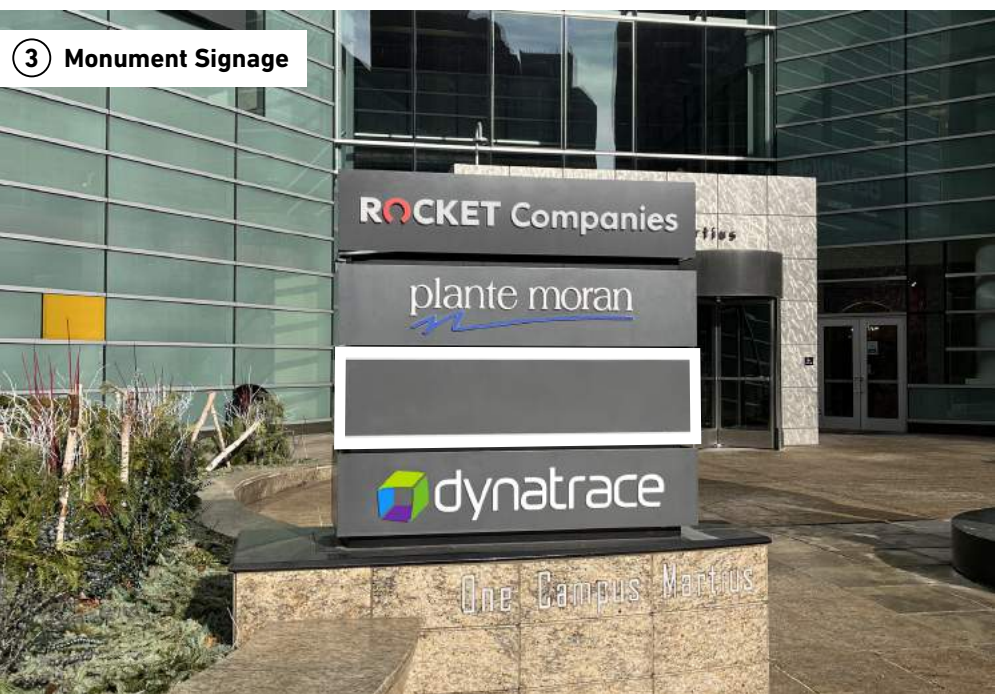

# SIGNAGE OPPORTUNITIES



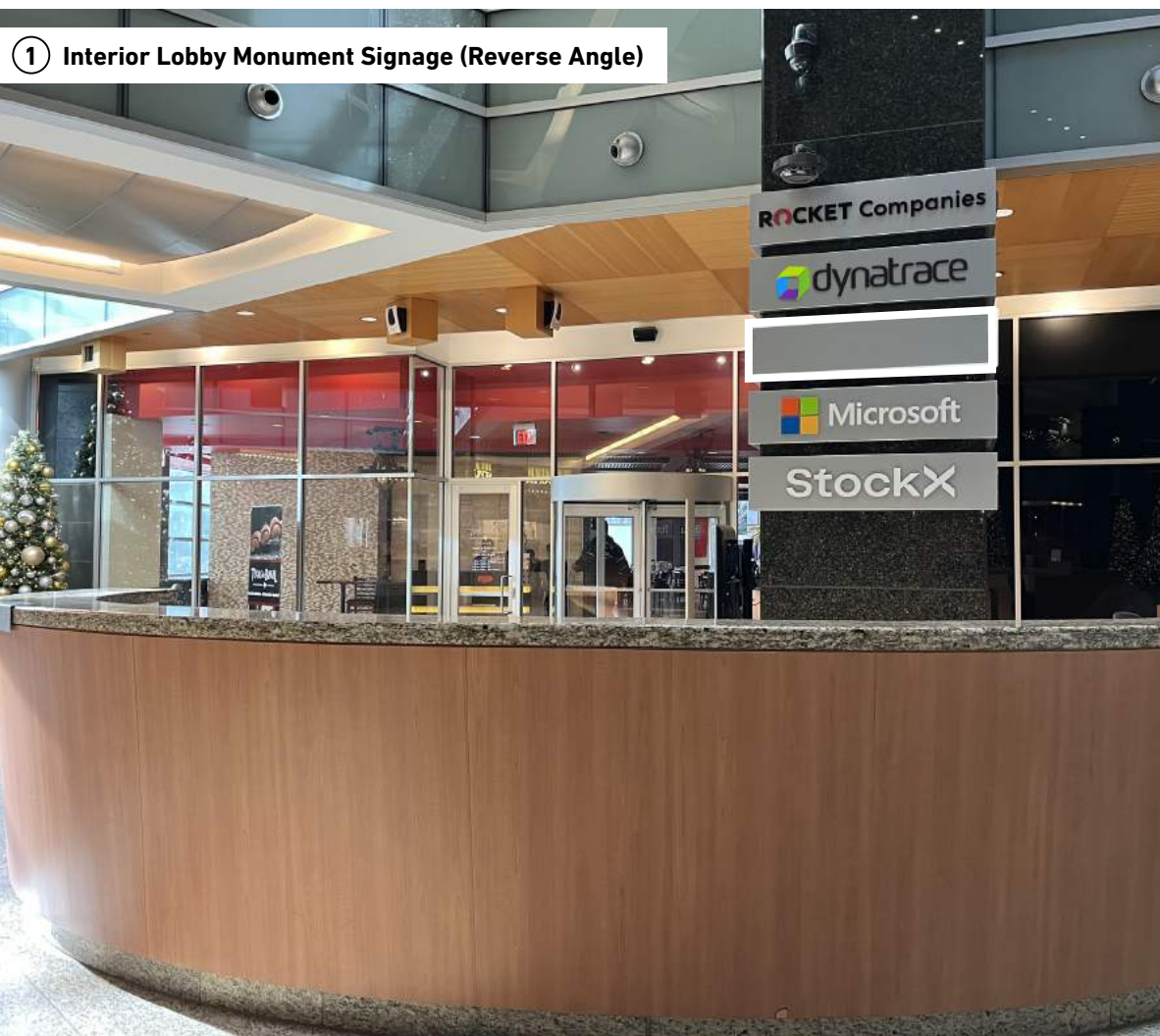



---

WWW.FRIEDMANREALESTATE.COM  
248.324.2000 | INFO@FREG.COM

---

STEVE EISENSHTADT | STEVE.EISENSHTADT@FREG.COM  
KEVIN GEORGE | KEVIN.GEORGE@FREG.COM  
ANDREW BOWER | ANDREW.BOWER@FREG.COM

---

34975 W 12 MILE ROAD  
FARMINGTON HILLS, MICHIGAN 48331