



FOR LEASE

REGION

1105 RIVERDALE ST

WEST SPRINGFIELD, MA 01089

Region Commercial Real Estate is pleased to present, on an exclusive basis, this approximately 2,807 square foot of prime retail space is a rare opportunity to locate on Riverdale Street, West Springfield's 'Golden Retail Mile'.

Conveniently situated at the I-91 on ramp, this space is adjacent to Big Y's flagship Table & Vine store offering easy highway access, high traffic counts and ample parking.

PRICE **\$25/SF NNN**

CAM/TAXES	\$5/SF
ZONING	RETAIL
SIZE	2,807 SF
YEAR BUILT	1962
HEAT AND A/C	GAS HEAT ELECTRIC A/C
ELECTRIC	200 AMPS +/-
WATER	MUNICIPAL
SEWER	MUNICIPAL

CONTACT

MITCH BOLOTIN

P: 413-415-1200 C: 413-537-2020
E: MITCH@REGIONCO.COM
LIC (MA): 134459
REGION CO LLC

BEN BOLOTIN

P: 413-415-1200 C: 413-530-3215
E: BEN@REGIONCO.COM
LIC (MA): 9582125
REGION CO LLC



Demographics			
Population		Median Income	
1 mile	4,340	1 mile	\$96,500
3 miles	92,251	3 miles	\$96,500
5 miles	225,714	5 miles	\$96,500



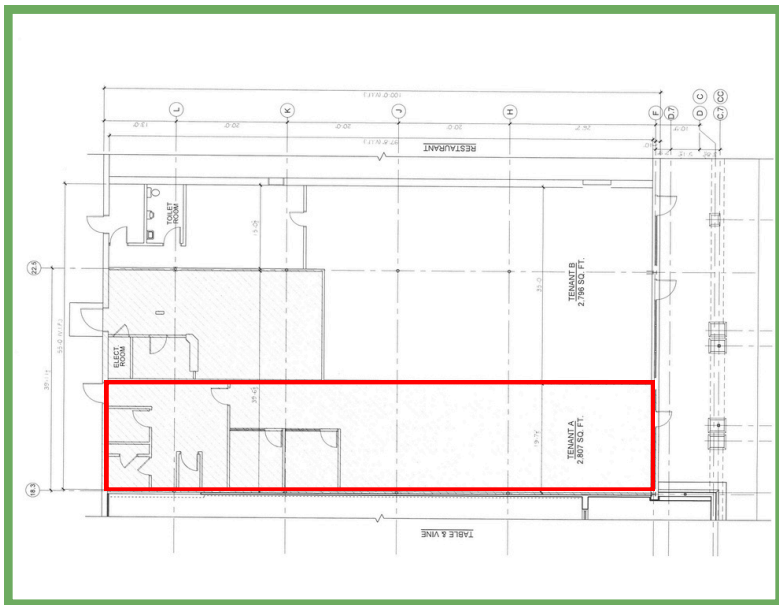

REGION

THE INFORMATION CONTAINED HEREIN HAS NOT BEEN VERIFIED AND IS FROM THIRD PARTY SOURCES. ALL INDIVIDUALS CONSIDERING THE SUBJECT PARTY MUST CONDUCT THEIR OWN ANALYSIS AND DETERMINE THE ACCURACY OF THE INFORMATION PROVIDED.

CONTACT

MITCH BOLOTIN

P: 413-415-1200 C: 413-537-2020
E: MITCH@REGIONCO.COM
LIC (MA): 134459
REGION CO LLC

BEN BOLOTIN

P: 413-415-1200 C: 413-530-3215
E: BEN@REGIONCO.COM
LIC (MA): 9582125
REGION CO LLC