



Gateway Building

9975 Tavistock Lakes Blvd
Orlando, FL 32827

- > Premium location at the main entrance and intersection into Laureate Park on the northwest corner of Tavistock Lakes Blvd and Narcoossee Road
- > 11,000± SF in shell condition
- > Negotiable rental rate
- > Within close proximity to Lake Nona Town Center and Medical City, which includes tenants such as:
 - VA Hospital
 - UCF College of Medicine
 - UF's Research and Academic Center
 - Nemours Children's hospital
 - Sanford Burnham Prebys Medical Discovery Institute

For Sublease

Class A Medical Office Space
Premises: 18,400 SF

Contact

Carey Jaffee, MSRE
+1 727 430 5539
carey.jaffee@jll.com

Aaron Gray, MSRE
+1 407 982 8772
aaron.gray@jll.com



Aerial Overview



107,959

2027 Projected Population
5 Mile Radius



3,400±

Homes To Be Built
1-mile radius



\$126,837

Average HH Income
5-Mile Radius



\$150,627

2027 Projected Avg. HH Income
5-Mile Radius



\$423,977

Average Home Value
2022 3-Mile Radius



39,500 AADT

Traffic Counts
(Narcoossee Rd)

Gateway Building

9975 Tavistock Lakes Blvd
Orlando, FL 32827



Site Plan

3rd Floor Available

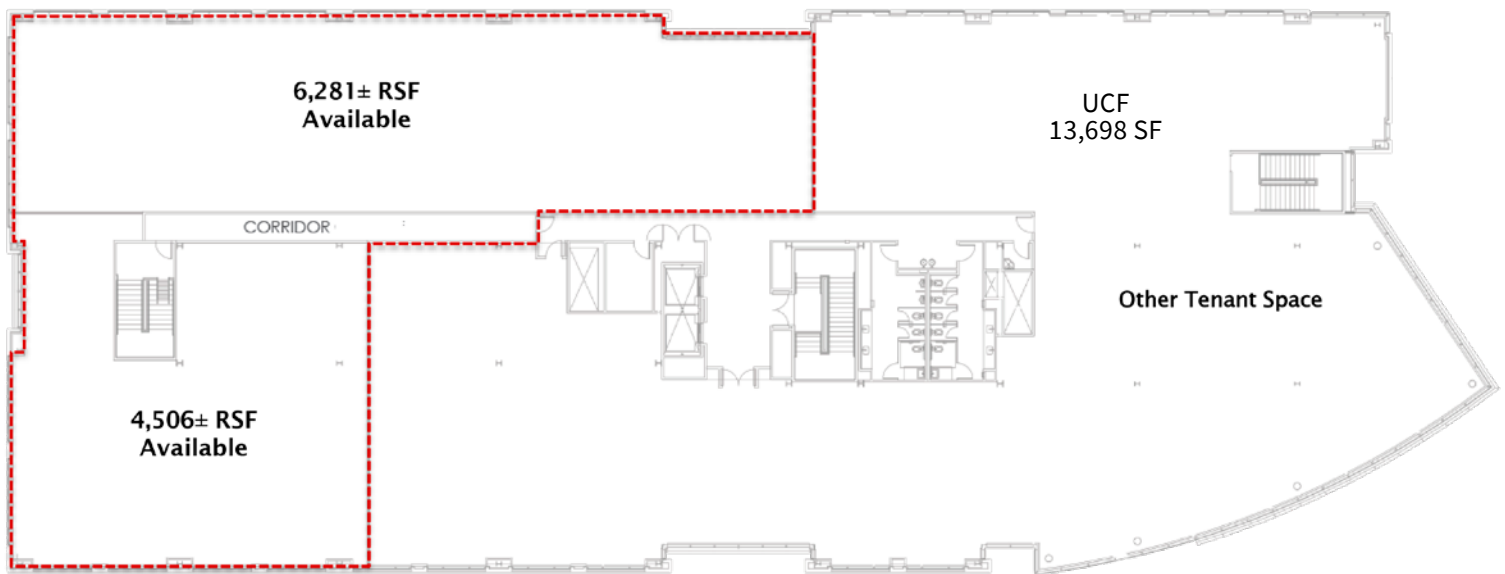

CONTACT

Carey Jaffee, MSRE

+1 727 430 5539
carey.jaffee@jll.com

Aaron Gray, MSRE

+1 407 982 8772
aaron.gray@jll.com

Although information has been obtained from sources deemed reliable, JLL does not make any guarantees, warranties or representations, express or implied, as to the completeness or accuracy as to the information contained herein. Any projections, opinions, assumptions or estimates used are for example only. There may be differences between projected and actual results, and those differences may be material. JLL does not accept any liability for any loss or damage suffered by any party resulting from reliance on this information. If the recipient of this information has signed a confidentiality agreement with JLL regarding this matter, this information is subject to the terms of that agreement. ©2020. Jones Lang LaSalle IP, Inc. All rights reserved.