



# 510 N Guadalupe St Suite C1 - C2

SANTA FE, NM 87501

FOR LEASE

**LEASE RATE:**

\$17.50/SF

**LEASE TYPE:**

Modified Gross

**SPACE AVAILABLE:**

Total 7,371/SF

Demisable

C1- 3,860/SF

C2- 3,511/SF

**SUBMARKET:**

Downtown Area

**ZONING:**

SC-2 (Planned Shopping Center District)



Cozette Hansen

Associate Broker / License # 49928

505 399 0538 / [cozettecre@gmail.com](mailto:cozettecre@gmail.com)

John Hancock

Associate Broker / License # 6739

[jhancock@santaferealestate.com](mailto:jhancock@santaferealestate.com)

505 470 5604 / Owner/Broker

## Downtown Location without Downtown Prices

We obtained the information above from sources we believe to be reliable. However, we have not verified its accuracy and make no guarantee, warranty or representation about it. It is submitted subject to the possibility of errors, omissions, change of price, rental or other conditions, prior sale, lease or financing, or withdrawal without notice. We include projections, opinions, assumptions or estimates for example only, and they may not represent current or future performance of the property. You and your tax and legal advisors should conduct your own investigation of the property and transaction.

**BARKER REALTY**  
COMMERCIAL

530 S. GUADALUPE STREET, SANTA FE, NM 87501  
505 982 9836 / [SANTAFEREALESTATE.COM](http://SANTAFEREALESTATE.COM)



# 510 N Guadalupe St Suite C1 - C2

SANTA FE, NM 87501

FOR LEASE

## PROPERTY HIGHLIGHTS

Retail location walking distance to Downtown without the Downtown pricing. Space is located in a high retail traffic area with successful neighboring Tenants that include Jinja Bar and Bistro, Edward Jones, Del Norte Credit Union, and Santa Fe Association of Realtors. Great visibility, with over 385' of frontage along Guadalupe St. Northern most shopping center in Santa Fe with easy access to 599 Hwy and US Hwy 285.



Cozette Hansen

Associate Broker / License # 49928  
505 399 0538 / [cozettecre@gmail.com](mailto:cozettecre@gmail.com)

John Hancock

Associate Broker / License # 6739  
[jhancock@santaferealestate.com](mailto:jhancock@santaferealestate.com)  
505 470 5604 / Owner/Broker

## Downtown Location without Downtown Prices

530 S. GUADALUPE STREET, SANTA FE, NM 87501  
505 982 9836 / [SANTAFEREALESTATE.COM](http://SANTAFEREALESTATE.COM)

We obtained the information above from sources we believe to be reliable. However, we have not verified its accuracy and make no guarantee, warranty or representation about it. It is submitted subject to the possibility of errors, omissions, change of price, rental or other conditions, prior sale, lease or financing, or withdrawal without notice. We include projections, opinions, assumptions or estimates for example only, and they may not represent current or future performance of the property. You and your tax and legal advisors should conduct your own investigation of the property and transaction.

**BARKER REALTY**  
COMMERCIAL



510 N Guadalupe St Suite C1 - C2  
SANTA FE, NM 87501

FOR LEASE

AERIAL VIEW



Cozette Hansen

Associate Broker / License # 49928

505 399 0538 / cozettecre@gmail.com

John Hancock

Associate Broker / License # 6739

[jhancock@santaferealestate.com](mailto:jhancock@santaferealestate.com)

505 470 5604 / Owner/Broker

Downtown Location without Downtown Prices

We obtained the information above from sources we believe to be reliable. However, we have not verified its accuracy and make no guarantee, warranty or representation about it. It is submitted subject to the possibility of errors, omissions, change of price, rental or other conditions, prior sale, lease or financing, or withdrawal without notice. We include projections, opinions, assumptions or estimates for example only, and they may not represent current or future performance of the property. You and your tax and legal advisors should conduct your own investigation of the property and transaction.

530 S. GUADALUPE STREET, SANTA FE, NM 87501  
505 982 9836 / SANTAFEREALESTATE.COM

**BARKER REALTY**  
COMMERCIAL



# 510 N Guadalupe St Suite C1 - C2

SANTA FE, NM 87501

## FOR LEASE

### FLOORPLAN

- Total: 7,371/SF
- Demisable
- C1- 3,860/SF
- C2- 3,511/SF

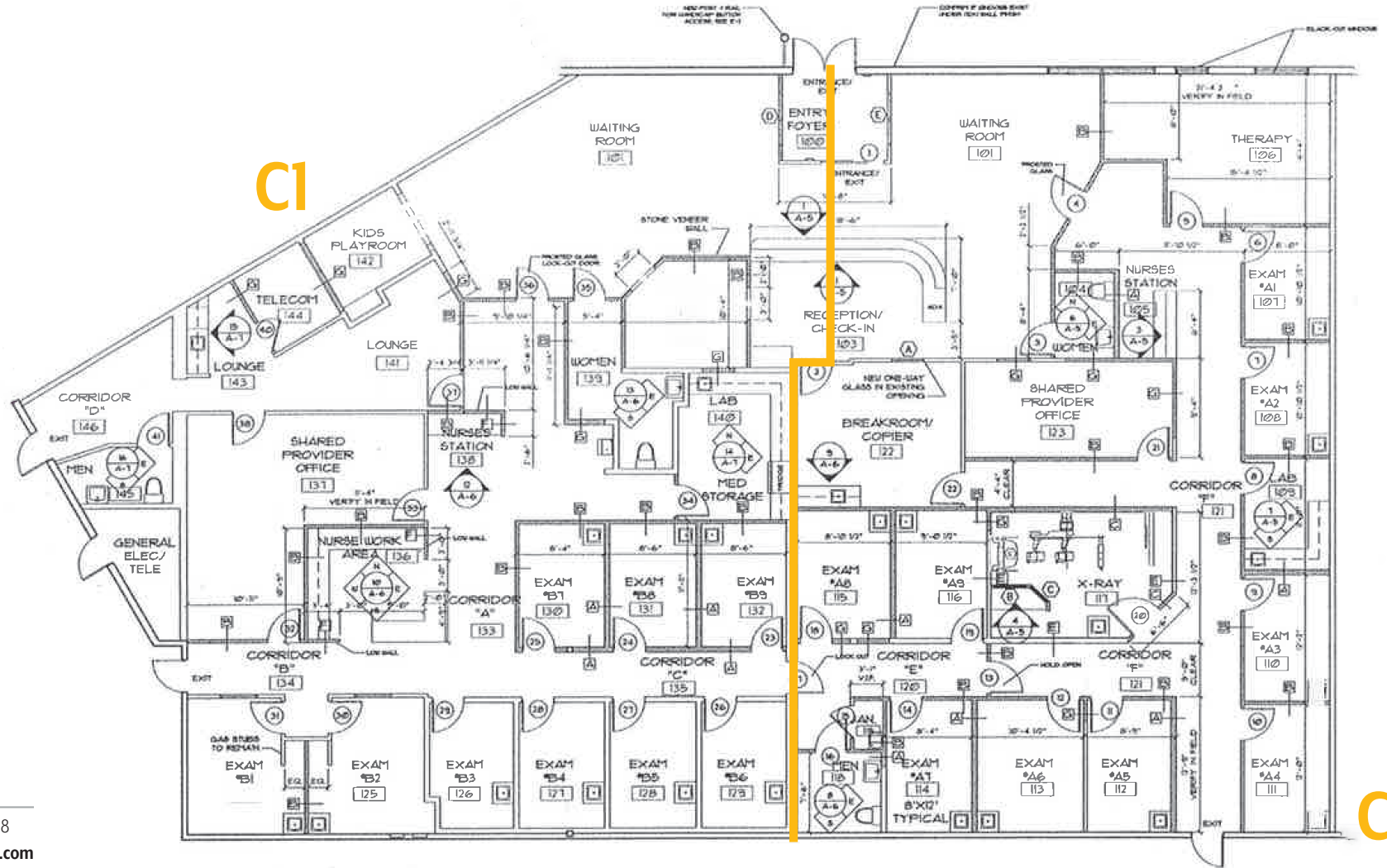

Cozette Hansen

Associate Broker / License # 49928

505 399 0538 / cozettecre@gmail.com

John Hancock

Associate Broker / License # 6739

jhancock@santaferealestate.com

505 470 5604 / Owner/Broker

## Downtown Location without Downtown Prices

We obtained the information above from sources we believe to be reliable. However, we have not verified its accuracy and make no guarantee, warranty or representation about it. It is submitted subject to the possibility of errors, omissions, change of price, rental or other conditions, prior sale, lease or financing, or withdrawal without notice. We include projections, opinions, assumptions or estimates for example only, and they may not represent current or future performance of the property. You and your tax and legal advisors should conduct your own investigation of the property and transaction.

**BARKER REALTY**  
COMMERCIAL

530 S. GUADALUPE STREET, SANTA FE, NM 87501  
505 982 9836 / SANTAFEREALESTATE.COM