

Hub State Street

101 West State Street West Lafayette, Indiana 47906

ANTUNOVICH ASSOCIATES - ARCHITECT
 224 WEST HURON STREET, CHICAGO IL 60654
 MAIN: 312.266.1126 FAX: 312.266.7123

CORE SPACES, UP CAMPUS PROPERTIES - OWNER
 1643 N Milwaukee Avenue, Chicago, Illinois 60647
 MAIN: 773.969.5740

RETAIL 1 | LOD 01

03/13/19

THE INFORMATION PROVIDED ON THIS DRAWING IS FROM DOCUMENTATION AVAILABLE AND MAY NOT REFLECT ACTUAL FIELD CONDITIONS. SERVICE CHASES AND UTILITIES PROVIDED BY THE LANDLORD FOR THE BASE BUILDING MAY EXIST WITHIN THE TENANT'S DEMISED PREMISES. IT SHALL BE THE RESPONSIBILITY OF THE TENANT TO FIELD-VERIFY ALL INFORMATION SHOWN. THE DEVELOPER AND ARCHITECT MAKE NO REPRESENTATIONS AS TO THE ACCURACY AND CORRECTNESS OF ANY DIMENSIONS OR SQUARE FOOTAGES. ALL DIMENSIONS AND SQUARE FOOTAGES SHALL BE FIELD VERIFIED BY THE TENANT IN THE FIELD.

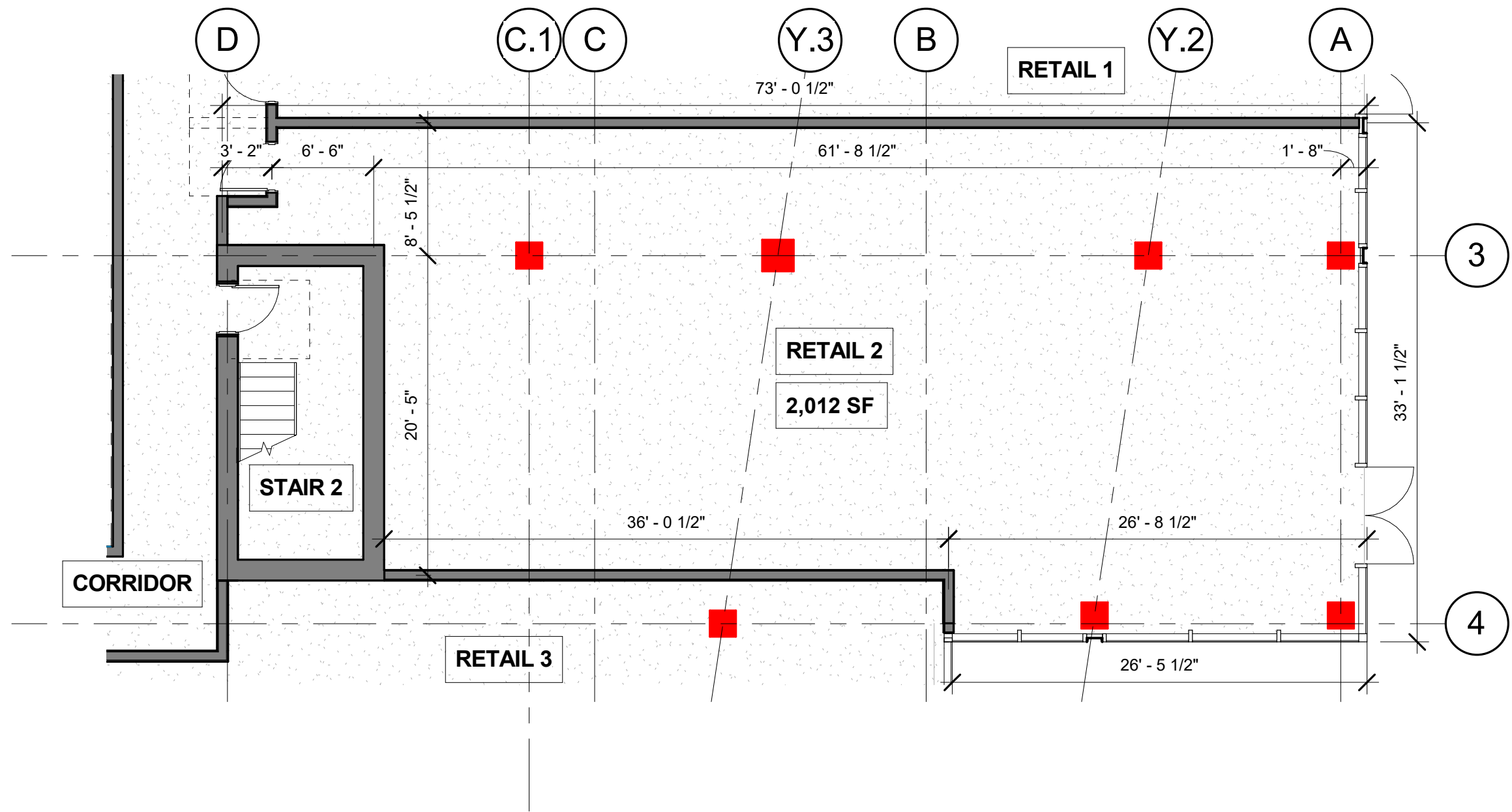

Hub State Street

101 West State Street West Lafayette, Indiana 47906

ANTUNOVICH ASSOCIATES - ARCHITECT
 224 WEST HURON STREET, CHICAGO IL 60654
 MAIN: 312.266.1126 FAX: 312.266.7123

CORE SPACES, UP CAMPUS PROPERTIES - OWNER
 1643 N Milwaukee Avenue, Chicago, Illinois 60647
 MAIN: 773.969.5740

RETAIL 2 | LOD 02

03/13/19

THE INFORMATION PROVIDED ON THIS DRAWING IS FROM DOCUMENTATION AVAILABLE AND MAY NOT REFLECT ACTUAL FIELD CONDITIONS. SERVICE CHASES AND UTILITIES PROVIDED BY THE LANDLORD FOR THE BASE BUILDING MAY EXIST WITHIN THE TENANT'S DEMISED PREMISES. IT SHALL BE THE RESPONSIBILITY OF THE TENANT TO FIELD-VERIFY ALL INFORMATION SHOWN. THE DEVELOPER AND ARCHITECT MAKE NO REPRESENTATIONS AS TO THE ACCURACY AND CORRECTNESS OF ANY DIMENSIONS OR SQUARE FOOTAGES. ALL DIMENSIONS AND SQUARE FOOTAGES SHALL BE FIELD VERIFIED BY THE TENANT IN THE FIELD.

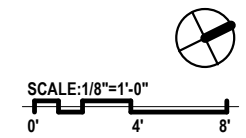
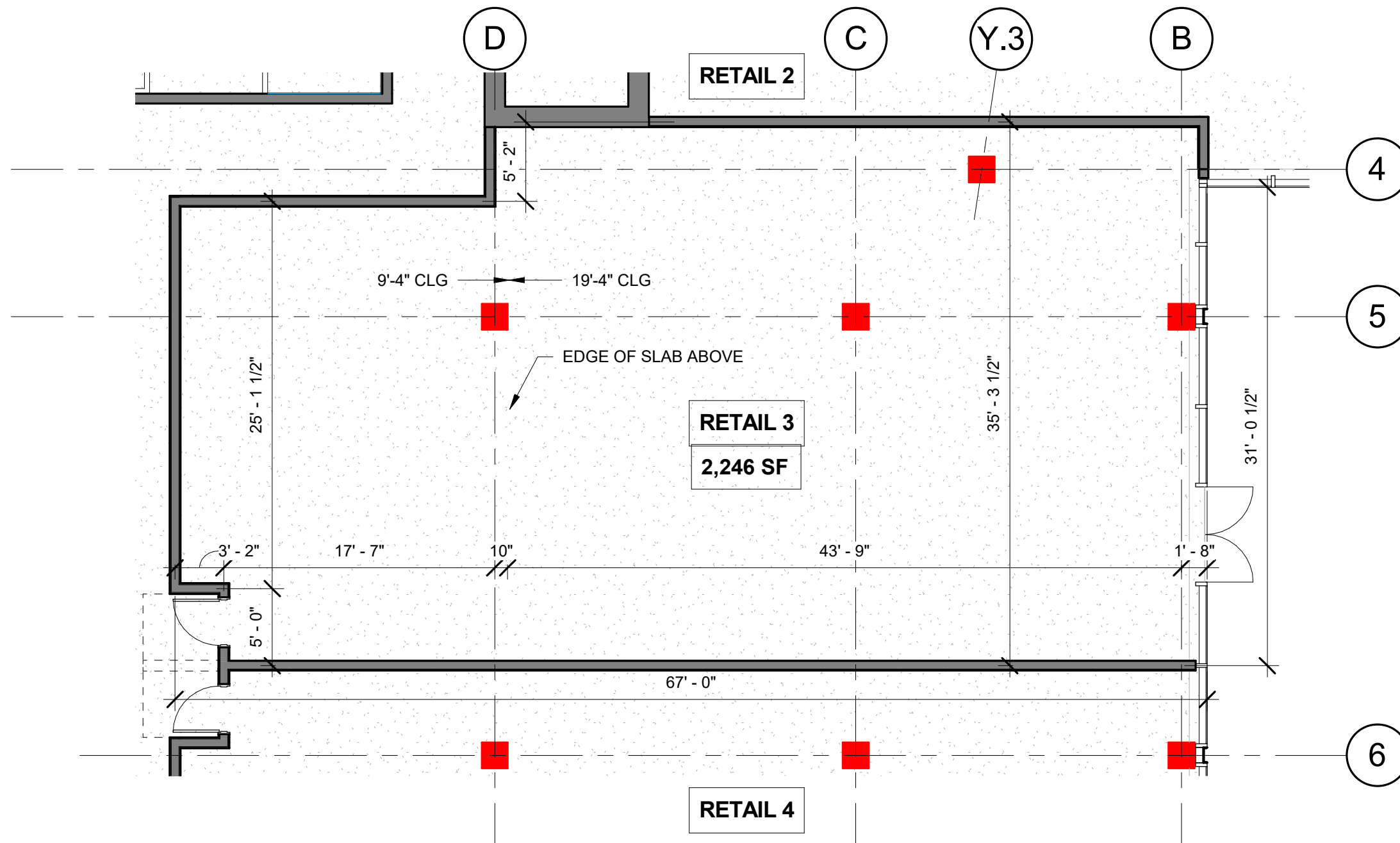

Hub State Street

101 West State Street West Lafayette, Indiana 47906

ANTUNOVICH ASSOCIATES - ARCHITECT
 224 WEST HURON STREET, CHICAGO IL 60654
 MAIN: 312.266.1126 FAX: 312.266.7123

CORE SPACES, UP CAMPUS PROPERTIES - OWNER
 1643 N Milwaukee Avenue, Chicago, Illinois 60647
 MAIN: 773.969.5740

RETAIL 3 | LOD 03

03/13/19

THE INFORMATION PROVIDED ON THIS DRAWING IS FROM DOCUMENTATION AVAILABLE AND MAY NOT REFLECT ACTUAL FIELD CONDITIONS. SERVICE CHASES AND UTILITIES PROVIDED BY THE LANDLORD FOR THE BASE BUILDING MAY EXIST WITHIN THE TENANT'S DEMISED PREMISES. IT SHALL BE THE RESPONSIBILITY OF THE TENANT TO FIELD-VERIFY ALL INFORMATION SHOWN. THE DEVELOPER AND ARCHITECT MAKE NO REPRESENTATIONS AS TO THE ACCURACY AND CORRECTNESS OF ANY DIMENSIONS OR SQUARE FOOTAGES. ALL DIMENSIONS AND SQUARE FOOTAGES SHALL BE FIELD VERIFIED BY THE TENANT IN THE FIELD.

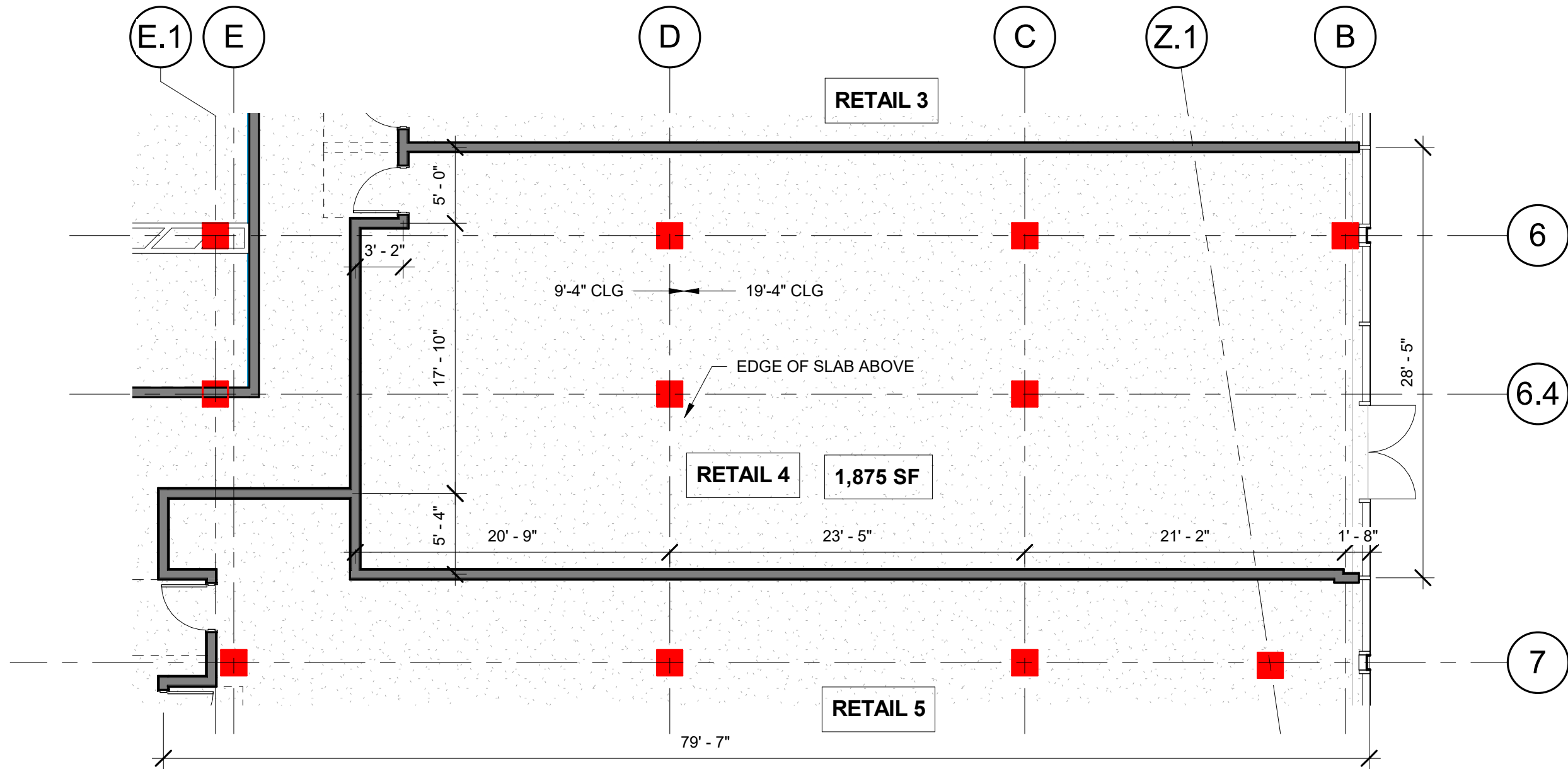

Hub State Street

101 West State Street West Lafayette, Indiana 47906

ANTUNOVICH ASSOCIATES - ARCHITECT
 224 WEST HURON STREET, CHICAGO IL 60654
 MAIN: 312.266.1126 FAX: 312.266.7123

CORE SPACES, UP CAMPUS PROPERTIES - OWNER
 1643 N Milwaukee Avenue, Chicago, Illinois 60647
 MAIN: 773.969.5740

RETAIL 4 | LOD 04

03/13/19

THE INFORMATION PROVIDED ON THIS DRAWING IS FROM DOCUMENTATION AVAILABLE AND MAY NOT REFLECT ACTUAL FIELD CONDITIONS. SERVICE CHASES AND UTILITIES PROVIDED BY THE LANDLORD FOR THE BASE BUILDING MAY EXIST WITHIN THE TENANT'S DEMISED PREMISES. IT SHALL BE THE RESPONSIBILITY OF THE TENANT TO FIELD-VERIFY ALL INFORMATION SHOWN. THE DEVELOPER AND ARCHITECT MAKE NO REPRESENTATIONS AS TO THE ACCURACY AND CORRECTNESS OF ANY DIMENSIONS OR SQUARE FOOTAGES. ALL DIMENSIONS AND SQUARE FOOTAGES SHALL BE FIELD VERIFIED BY THE TENANT IN THE FIELD.

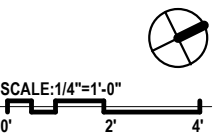
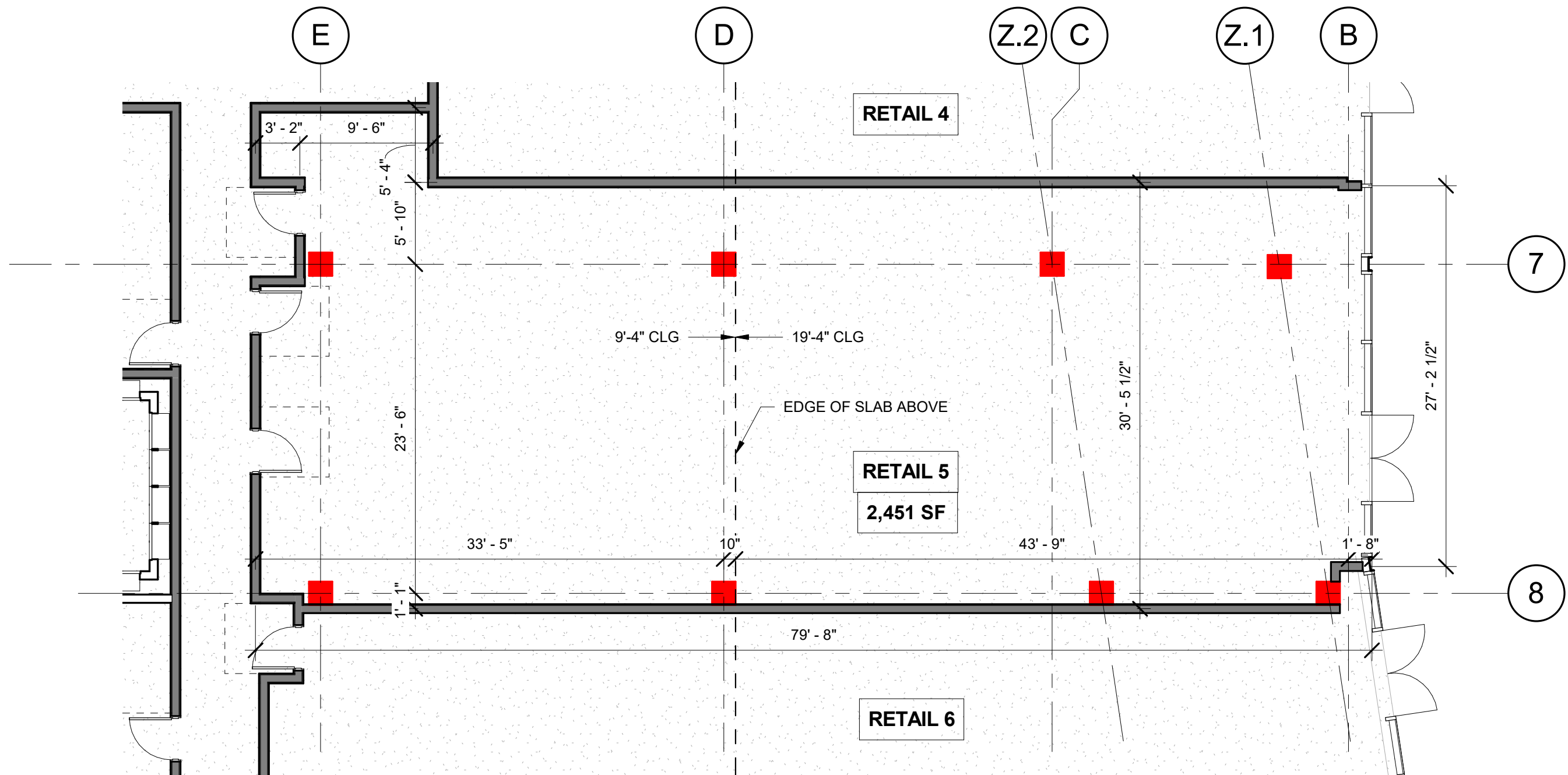

Hub State Street

101 West State Street West Lafayette, Indiana 47906

ANTUNOVICH ASSOCIATES - ARCHITECT
 224 WEST HURON STREET, CHICAGO IL 60654
 MAIN: 312.266.1126 FAX: 312.266.7123

CORE SPACES, UP CAMPUS PROPERTIES - OWNER
 1643 N Milwaukee Avenue, Chicago, Illinois 60647
 MAIN: 773.969.5740

BOKA/LITTLE MOMMA (RETAIL 5) | LOD 05

03/13/19

THE INFORMATION PROVIDED ON THIS DRAWING IS FROM DOCUMENTATION AVAILABLE AND MAY NOT REFLECT ACTUAL FIELD CONDITIONS. SERVICE CHASES AND UTILITIES PROVIDED BY THE LANDLORD FOR THE BASE BUILDING MAY EXIST WITHIN THE TENANT'S DEMISED PREMISES. IT SHALL BE THE RESPONSIBILITY OF THE TENANT TO FIELD-VERIFY ALL INFORMATION SHOWN. THE DEVELOPER AND ARCHITECT MAKE NO REPRESENTATIONS AS TO THE ACCURACY AND CORRECTNESS OF ANY DIMENSIONS OR SQUARE FOOTAGES. ALL DIMENSIONS AND SQUARE FOOTAGES SHALL BE FIELD VERIFIED BY THE TENANT IN THE FIELD.

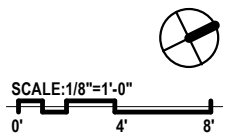
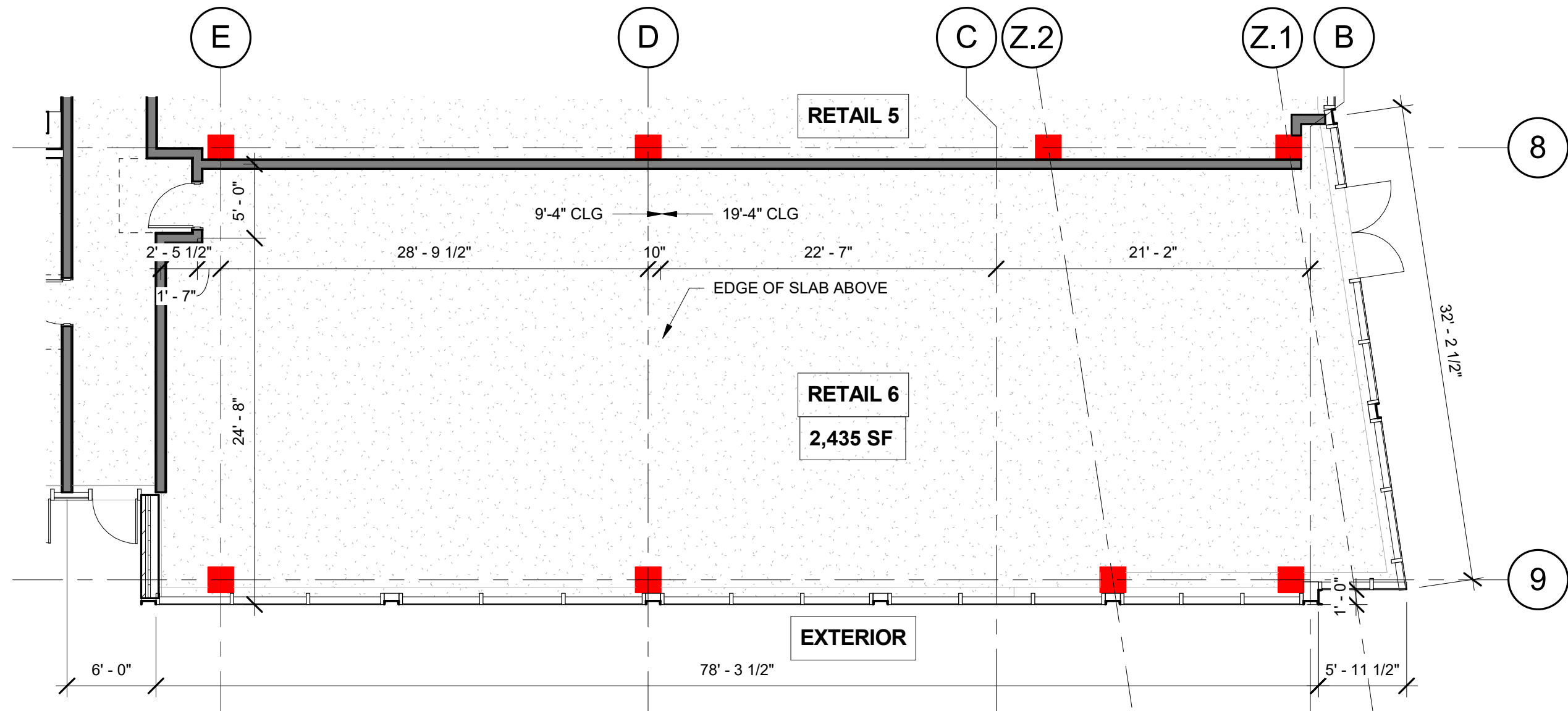

Hub State Street

101 West State Street West Lafayette, Indiana 47906

ANTUNOVICH ASSOCIATES - ARCHITECT
 224 WEST HURON STREET, CHICAGO IL 60654
 MAIN: 312.266.1126 FAX: 312.266.7123

CORE SPACES, UP CAMPUS PROPERTIES - OWNER
 1643 N Milwaukee Avenue, Chicago, Illinois 60647
 MAIN: 773.969.5740

RETAIL 6 | LOD 06

03/13/19

THE INFORMATION PROVIDED ON THIS DRAWING IS FROM DOCUMENTATION AVAILABLE AND MAY NOT REFLECT ACTUAL FIELD CONDITIONS. SERVICE CHASES AND UTILITIES PROVIDED BY THE LANDLORD FOR THE BASE BUILDING MAY EXIST WITHIN THE TENANT'S DEMISED PREMISES. IT SHALL BE THE RESPONSIBILITY OF THE TENANT TO FIELD-VERIFY ALL INFORMATION SHOWN. THE DEVELOPER AND ARCHITECT MAKE NO REPRESENTATIONS AS TO THE ACCURACY AND CORRECTNESS OF ANY DIMENSIONS OR SQUARE FOOTAGES. ALL DIMENSIONS AND SQUARE FOOTAGES SHALL BE FIELD VERIFIED BY THE TENANT IN THE FIELD.

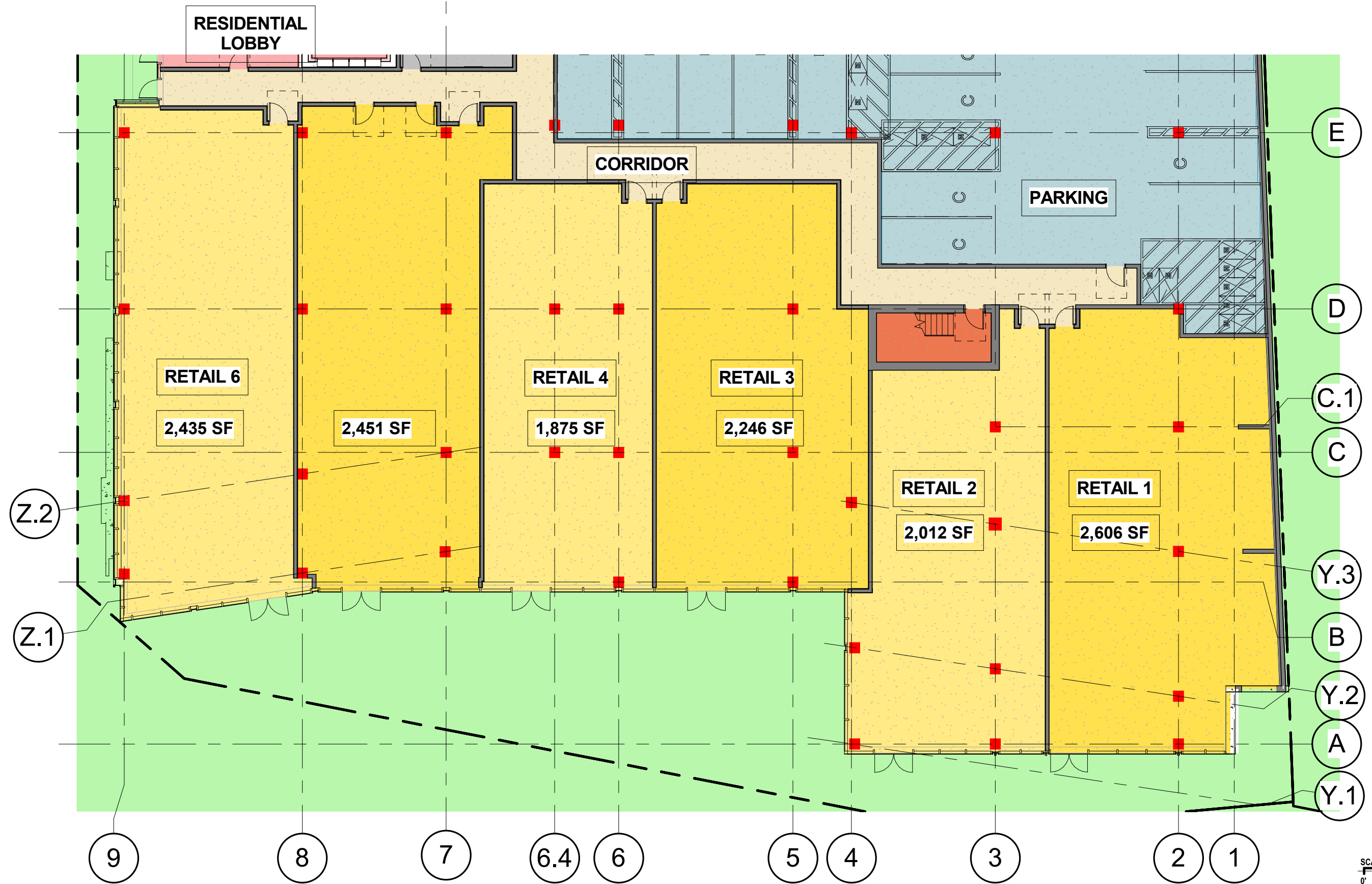

SCALE: 1/16"=1'-0"
 0' 8' 16'

Hub State Street

101 West State Street West Lafayette, Indiana 47906

ANTUNOVICH ASSOCIATES - ARCHITECT
 224 WEST HURON STREET, CHICAGO IL 60654
 MAIN: 312.266.1126 FAX: 312.266.7123

CORE SPACES, UP CAMPUS PROPERTIES - OWNER
 1643 N Milwaukee Avenue, Chicago, Illinois 60647
 MAIN: 773.969.5740

RETAIL | LOD 07

03/13/19

THE INFORMATION PROVIDED ON THIS DRAWING IS FROM DOCUMENTATION AVAILABLE AND MAY NOT REFLECT ACTUAL FIELD CONDITIONS. SERVICE CHASES AND UTILITIES PROVIDED BY THE LANDLORD FOR THE BASE BUILDING MAY EXIST WITHIN THE TENANT'S DEMISED PREMISES. IT SHALL BE THE RESPONSIBILITY OF THE TENANT TO FIELD-VERIFY ALL INFORMATION SHOWN. THE DEVELOPER AND ARCHITECT MAKE NO REPRESENTATIONS AS TO THE ACCURACY AND CORRECTNESS OF ANY DIMENSIONS OR SQUARE FOOTAGES. ALL DIMENSIONS AND SQUARE FOOTAGES SHALL BE FIELD VERIFIED BY THE TENANT IN THE FIELD.