



## 161 WASHINGTON STREET | CONSHOHOCKEN, PA

### PROPERTY HIGHLIGHTS:

- Four year term remaining
- Up to a full floor.

### Onsite Amenities

- 1200+ space parking garage
- Amenities Center – Café Food Service
- Modern Fitness Center
- On Demand Conference Rooms

### Easy Access to

- Septa Regional Rail to Phila. And Beyond
- Hotels (3 within easy walk)
- Abundant Conshohocken restaurants within walking distance
- 130 mile Schuylkill bike/walking trail, Phila. to Pottstown with interconnecting trails.
- Interstate Highway System intersection of I76 and I476



For more information call:

**Jere Shertzer** [jshertzer@beaconcre.com](mailto:jshertzer@beaconcre.com)

**Colin McHale** [cmchale@beaconcre.com](mailto:cmchale@beaconcre.com)

610-828-0100

# Beacon

Commercial Real Estate, LLC



For more information call: **Jere Shertzer** [jshertzer@beaconcre.com](mailto:jshertzer@beaconcre.com) 484-433-5090

290 King of Prussia Road | Building 1 | Suite 200 | Radnor, PA 19087 | 610.828.0100 (o) | 610.828.3873 (f) | [www.beaconcre.com](http://www.beaconcre.com)

No warranty or representation, expressed or implied, is made as to the accuracy of the information contained herein, and same is submitted subject to errors, omissions, change of price, rental or other conditions, withdrawal without notice, and to any special listing conditions imposed by our principals.

# Beacon

Commercial Real Estate, LLC

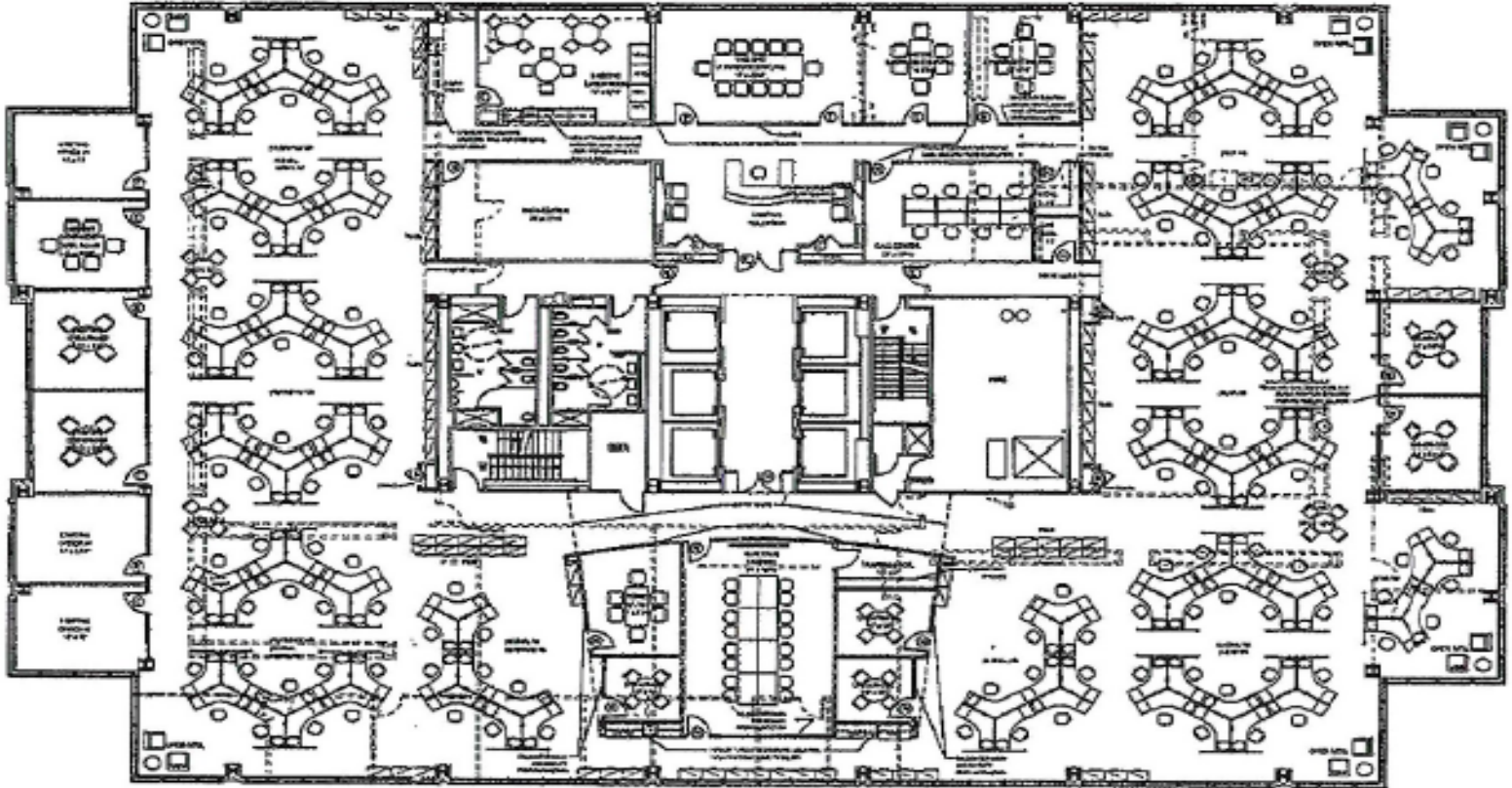

**Jere Shertzer** [jshertzer@beaconre.com](mailto:jshertzer@beaconre.com) | 610.828.0100

290 King of Prussia Road | Building 1 | Suite 200 | Radnor, PA 19087 | 610.828.0100 (o) | 610.828.3873 (f) | [www.beaconre.com](http://www.beaconre.com)

No warranty or representation, expressed or implied, is made as to the accuracy of the information contained herein, and same is submitted subject to errors, omissions, change of price, rental or other conditions, withdrawal without notice, and to any special listing conditions imposed by our principals.