

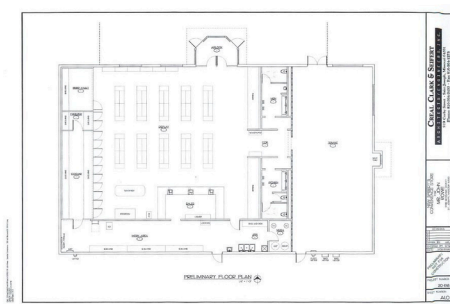

**FOR LEASE WITH
DRIVE-THRU**

**\$18.00
1500 +/- SF**



PROPERTY FEATURES

New construction- Ideal for quick service restaurant (QSR) or coffee shop/smoothie shop. The existing building will be demolished and a new larger convenience store built, with a 1500 +/- SF retail suite for lease with drive-thru potential. . Located near Central High School, the largest high school in the city, and St. Joseph Aquatic Park, the city's only public pool/ water park. Located on St. Joseph's Urban Trail system. Estimated completion by end of 2025.

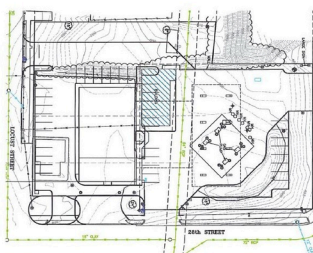

- Price: \$18.00/SF
- Year Built: 2025
- AADT - 7,000 Messaine - 9,000 Noyes (28th St)
- Population - 13,600 - 1 mile; 55,400 - 3 mile; 77,260 - 5 mile
- Avg. HH Income - \$66,600 - 1 mile; \$71,200 - 3 mile; \$77,700 -5 mile
- Zoning Description: C-3
- Lot Size: 1.19 AC



Berkshire Hathaway HomeServices Stein & Summers Real Estate

Raymond Sisson

Director of Commercial Services

816-390-7478

ray@raysisson.net

www.raysisson.net

**BERKSHIRE
HATHAWAY**
HOMESERVICES

STEIN & SUMMERS
REAL ESTATE

COMMERCIAL

MO Lic #: 1999020688, KS Lic #: BR00003466
1007 E. St. Maartens Dr. Saint Joseph, MO 64506

©2024 BHH Affiliates, LLC. Real Estate Brokerage Services are offered through the network member franchisees of BHH Affiliates, LLC. Most franchisees are independently owned and operated. Berkshire Hathaway HomeServices and the Berkshire Hathaway HomeServices symbol are registered service marks of Columbia Insurance Company, a Berkshire Hathaway affiliate. Information not verified or guaranteed. If your property is currently listed with a Broker, this is not intended as a solicitation. Equal Housing Opportunity.

2728 Messanie St., Saint Joseph, MO 64506