

# 2110 E. 25<sup>th</sup> STREET

VERNON, CA 90058

FOR LEASE  
21,247 SF  
BUILDING

\$.90 PSF NNN



## PROPERTY FEATURES:

Available SF	21,247 SF	Lighting	Fluorescent
Office SF	2,127 SF	Construction	CTU
Power	400 Amp	Roof	WDF
	240 Volt	Clearance	18' – 21'
	3-Phase, 3-Wire	Year Built	1961
Parking	18	NNN	\$0.26 psf
Dock High Positions	4	Possession	Immediate

- Prime Vernon Location
- Gated Yard
- Proximity to 10 Freeway and Downtown
- Between Alameda and Santa Fe

The above statement was made based upon information furnished by the owner or from sources which we believe are reliable. While we do not doubt its accuracy we have not verified it and we do not make any guarantee, warranty or representation about it. It is your responsibility to independently verify its accuracy and completeness. Your tax, financial, legal and toxic substance advisors should conduct a careful independent investigation of the property and its suitability for your needs, including contacting the appropriate governmental offices for zoning and land use information.

For Information, contact:

**Michael J. Dunn**  
213.580.1400  
mike@dunnpropertygroup.com  
CA Lic. No. 00949670

**Kenneth E. Horn**  
213.840.0320  
ken@dunnpropertygoup.com  
CA Lic. No. 01040077

Dunn Property Group, Inc.  
1200 Wilshire Boulevard  
Suite 208  
Los Angeles, CA 90017  
CA Lic No. 01788640

[www.dunnpropertygroup.com](http://www.dunnpropertygroup.com)



**Dunn Property Group**  
BUSINESS REAL ESTATE SOLUTIONS

# 2110 E. 25<sup>th</sup> STREET

VERNON, CA 90058

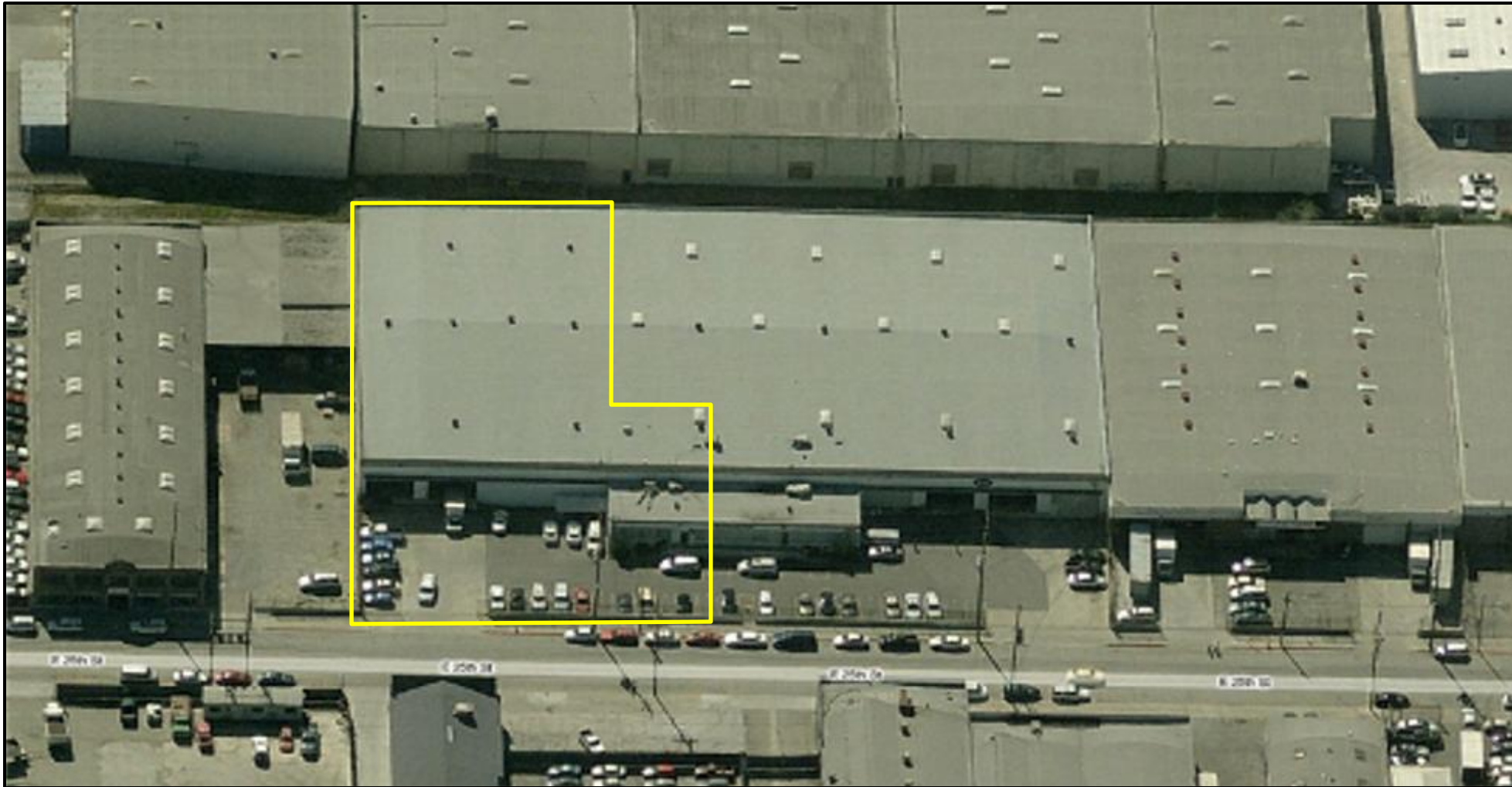

The above statement was made based upon information furnished by the owner or from sources which we believe are reliable. While we do not doubt its accuracy we have not verified it and we do not make any guarantee, warranty or representation about it. It is your responsibility to independently verify its accuracy and completeness. Your tax, financial, legal and toxic substance advisors should conduct a careful independent investigation of the property and its suitability for your needs, including contacting the appropriate governmental offices for zoning and land use information.



**Dunn Property Group**  
BUSINESS REAL ESTATE SOLUTIONS

# 2110 E. 25<sup>th</sup> STREET

VERNON, CA 90058



The above statement was made based upon information furnished by the owner or from sources which we believe are reliable. While we do not doubt its accuracy we have not verified it and we do not make any guarantee, warranty or representation about it. It is your responsibility to independently verify its accuracy and completeness. Your tax, financial, legal and toxic substance advisors should conduct a careful independent investigation of the property and its suitability for your needs, including contacting the appropriate governmental offices for zoning and land use information.

# 2110 E. 25<sup>th</sup> STREET

VERNON, CA 90058

FOR LEASE  
21,247 SF  
BUILDING

\$1.05 PSF NNN

For Information, contact:

**Michael J. Dunn**  
213.580.1400  
mike@dunnpropertygroup.com

**Kenneth E. Horn**  
213.840.0320  
ken@dunnpropertygroup.com

Dunn Property Group, Inc.  
1200 Wilshire Boulevard  
Suite 208  
Los Angeles, CA 90017

[www.dunnpropertygroup.com](http://www.dunnpropertygroup.com)

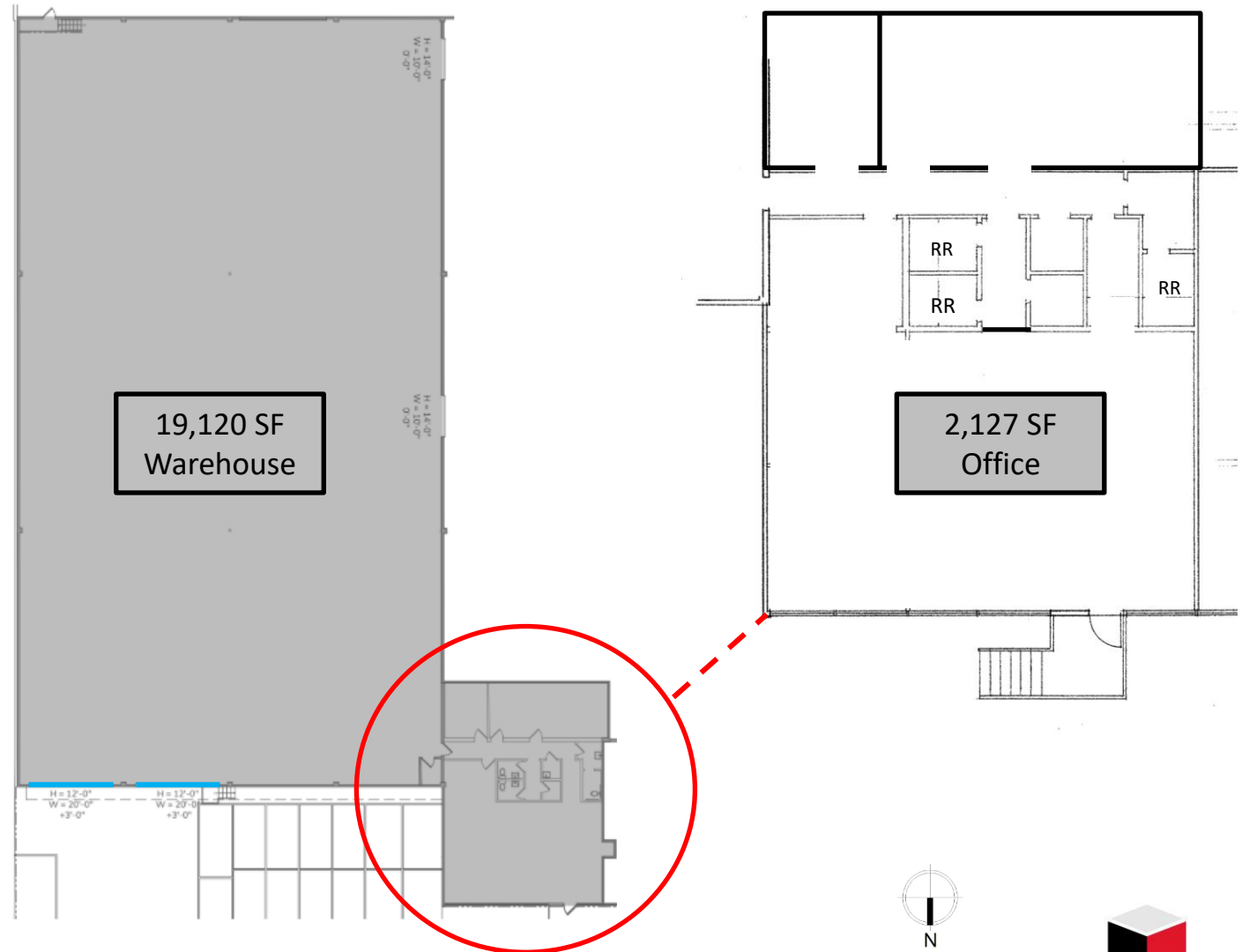

The above statement was made based upon information furnished by the owner or from sources which we believe are reliable. While we do not doubt its accuracy we have not verified it and we do not make any guarantee, warranty or representation about it. It is your responsibility to independently verify its accuracy and completeness. Your tax, financial, legal and toxic substance advisors should conduct a careful independent investigation of the property and its suitability for your needs, including contacting the appropriate governmental offices for zoning and land use information.



**Dunn Property Group**  
BUSINESS REAL ESTATE SOLUTIONS