

*Picture*

**YOUR  
BUSINESS  
HERE**

3300 Monroe Ave

3300 Monroe Ave 700-9,000 SF OFFICE SPACE

## Pittsford Place

Highlights of having a **3300 Monroe Avenue** address

- Surrounded by amenities, including Pittsford Plaza and the area's "flagship" Wegmans store.
- Highly identifiable building along a major corridor
- Pittsford Place mall is an indoor shopping and office center owned and managed by Graywood Companies.
- Population of 58,000+ within 3-mile radius has an average household income of over \$150,000

**Retail & Office  
space available**

Across from Pittsford Plaza & Wegmans • Competitive rates • Affluent population  
Regional draw • Building signage available

**CALL JENNIFER ROSS 585-397-1895 FOR DETAILS**

**Graywood**  
Companies, Inc.

# 3300 Monroe Ave

Greater Rochester, NY  
Monroe Ave ▪ Pittsford

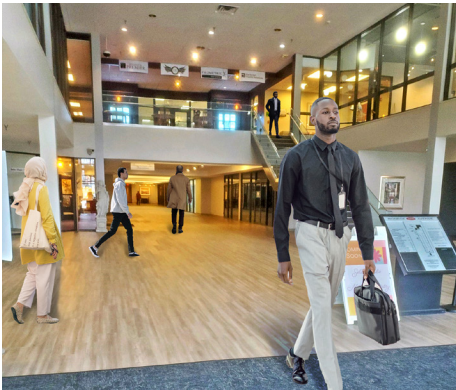

## Professional Office Space

### 700–870 SF

Just the right size for a start-up or satellite office

### 1,250–1,650 SF

Very efficient space that is ideal for a variety of businesses

### 2,900 SF

A blank canvas that is ready to be designed to suit your needs

### 5,500 SF

Many upgrades and lots of natural light

### 9,000 SF

Dedicated entrance right off the parking lot & superior building signage

3300 Monroe also features retail availabilities ranging from 6,000–19,000 SF. Join the list of national retailers along Monroe Avenue—Barnes & Noble, Cheesecake Factory, TJ Maxx, Trader Joes, Black & Blue and more!

## CALL JENNIFER ROSS 585-397-1895 FOR DETAILS

*All information furnished is from sources deemed reliable, but no warranty or representation is made as to its accuracy. All information subject to change.*

Graywood  
Companies, Inc.