

# 600 MAIN STREET

Riverton, NJ 08077



**SALE OR LEASE**



**OFFICE**



**3,800 SF**



## PROPERTY DESCRIPTION

Located in the charming town of Riverton, NJ, the area surrounding 600 Main Street exudes a welcoming small-town vibe with easy access to modern amenities. Just a short stroll away are local restaurants, boutique shops, and scenic views along the Delaware River, with convenient access to major urban centers. Riverton Light Rail across the street from the building.

## PROPERTY HIGHLIGHTS

- 3,800+/- SF in two units: Unit 5: 1,200 SF & Unit 6: 2,600 SF
- Ideal for medical, professional, business services and retail users
- Space newly renovated with fresh paint, exposed brick, marble tile & vinyl flooring
- Abundance of natural light
- Ample parking

**SALE: \$475,000/\$125 PSF**

**LEASE: \$1.00 PSF NNN PER MONTH**

## LOCATION

- Situated on the corner of S. Broad Street & Main Street in Riverton
- Within a short walking distance to the Delaware River and Riverton Yacht Club
- 15 minute drive to Palmyra Nature Cove
- Riverton Rail Line just across the street
- Easy access to Tacony-Palmyra Bridge & Betsy Ross Bridge
- Minutes to Routes 73 & 130

## FOR MORE INFORMATION

**Julie Kronfeld**



856.802.6516



julie.kronfeld@naimertz.com

**Rebecca Ting, SIOR**



856.234.9600 x206



rebecca.ting@naimertz.com

NAI MERTZ DISCLAIMER: NO WARRANTY OR REPRESENTATION, EXPRESS OR IMPLIED, IS MADE AS TO THE ACCURACY OF THE INFORMATION CONTAINED HEREIN, AND THE SAME IS SUBMITTED SUBJECT TO ERRORS, OMISSIONS, CHANGE OF PRICE, RENTAL OR OTHER CONDITIONS, PRIOR SALE, LEASE OR FINANCING, OR WITHDRAWAL WITHOUT NOTICE, AND OF ANY SPECIAL LISTING CONDITIONS IMPOSED BY OUR PRINCIPALS NO WARRANTIES OR REPRESENTATIONS ARE MADE AS TO THE CONDITION OF THE PROPERTY OR ANY HAZARDS CONTAINED THEREIN ARE ANY TO BE IMPLIED. OUTLINES ARE APPROXIMATE AND SHOWN ONLY TO IDENTIFY THE PARCEL IN CONSIDERATION.

# NAIMertz



**NAI Mertz** | 21 Roland Avenue  
Mount Laurel, NJ 08054

856.234.9600 | [naimertz.com](http://naimertz.com)





# 600 MAIN STREET

Riverton, NJ 08077

 **SALE OR LEASE**

 **OFFICE**

 **3,800 SF**



## FOR MORE INFORMATION

**Julie Kronfeld**

 856.802.6516

 [julie.kronfeld@naimertz.com](mailto:julie.kronfeld@naimertz.com)

**Rebecca Ting, SIOR**

 856.234.9600 x206

 [rebecca.ting@naimertz.com](mailto:rebecca.ting@naimertz.com)

NAI MERTZ DISCLAIMER: NO WARRANTY OR REPRESENTATION, EXPRESS OR IMPLIED, IS MADE AS TO THE ACCURACY OF THE INFORMATION CONTAINED HEREIN, AND THE SAME IS SUBMITTED SUBJECT TO ERRORS, OMISSIONS, CHANGE OF PRICE, RENTAL OR OTHER CONDITIONS, PRIOR SALE, LEASE OR FINANCING, OR WITHDRAWAL WITHOUT NOTICE, AND OF ANY SPECIAL LISTING CONDITIONS IMPOSED BY OUR PRINCIPALS NO WARRANTIES OR REPRESENTATIONS ARE MADE AS TO THE CONDITION OF THE PROPERTY OR ANY HAZARDS CONTAINED THEREIN ARE ANY TO BE IMPLIED. OUTLINES ARE APPROXIMATE AND SHOWN ONLY TO IDENTIFY THE PARCEL IN CONSIDERATION.

# NAI Mertz

 **NAI Mertz** | 21 Roland Avenue  
Mount Laurel, NJ 08054  
856.234.9600 | [naimertz.com](http://naimertz.com)





# 600 MAIN STREET

Riverton, NJ 08077

 **SALE OR LEASE**

 **OFFICE**

 **3,800 SF**

## SUITE 5

## SUITE 6

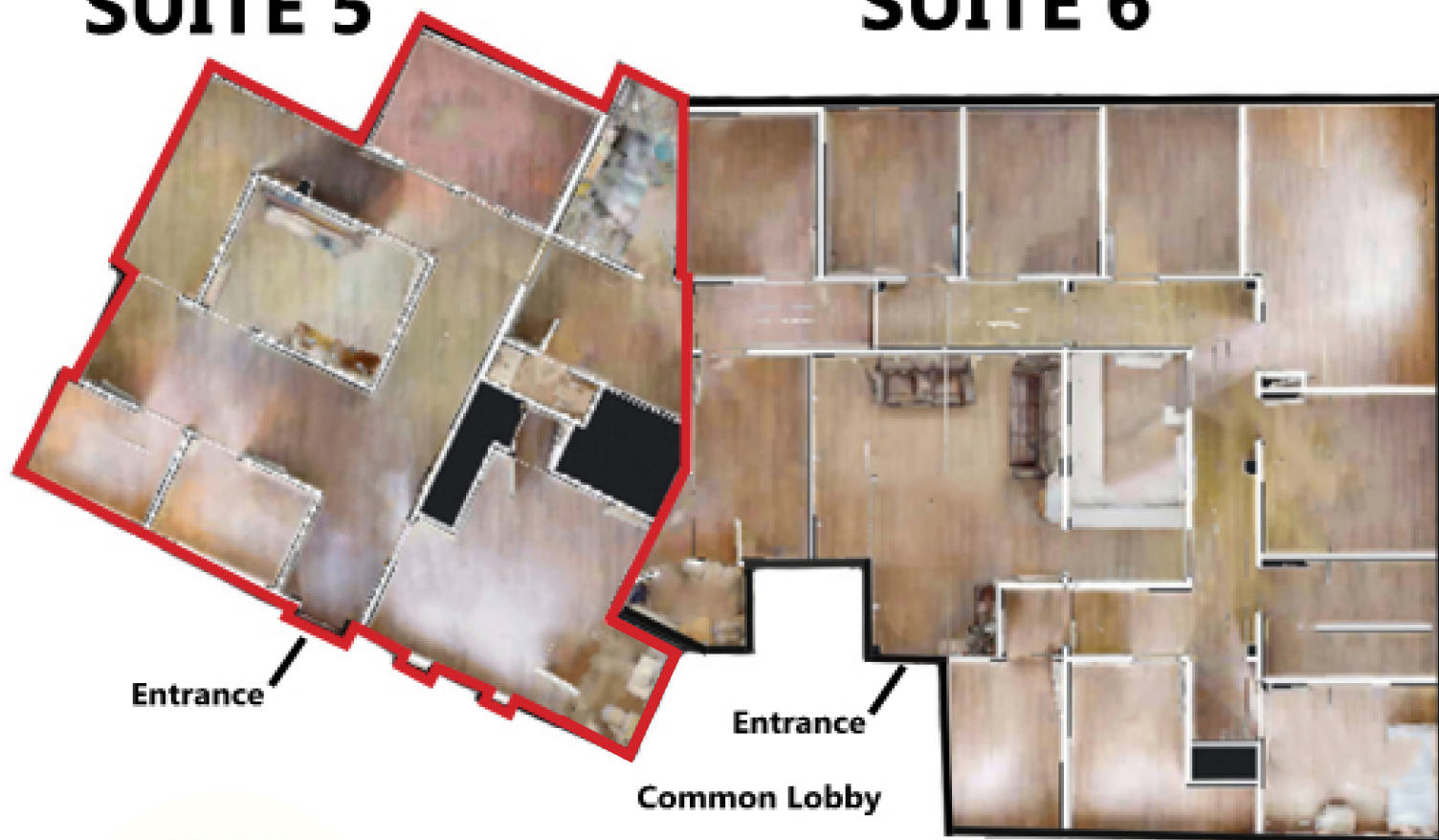

**CLICK HERE FOR A  
VIRTUAL TOUR**

### FOR MORE INFORMATION

**Julie Kronfeld**

 856.802.6516

 [julie.kronfeld@naimertz.com](mailto:julie.kronfeld@naimertz.com)

**Rebecca Ting, SIOR**

 856.234.9600 x206

 [rebecca.ting@naimertz.com](mailto:rebecca.ting@naimertz.com)

NAI MERTZ DISCLAIMER: NO WARRANTY OR REPRESENTATION, EXPRESS OR IMPLIED, IS MADE AS TO THE ACCURACY OF THE INFORMATION CONTAINED HEREIN, AND THE SAME IS SUBMITTED SUBJECT TO ERRORS, OMISSIONS, CHANGE OF PRICE, RENTAL OR OTHER CONDITIONS, PRIOR SALE, LEASE OR FINANCING, OR WITHDRAWAL WITHOUT NOTICE, AND OF ANY SPECIAL LISTING CONDITIONS IMPOSED BY OUR PRINCIPALS NO WARRANTIES OR REPRESENTATIONS ARE MADE AS TO THE CONDITION OF THE PROPERTY OR ANY HAZARDS CONTAINED THEREIN ARE ANY TO BE IMPLIED. OUTLINES ARE APPROXIMATE AND SHOWN ONLY TO IDENTIFY THE PARCEL IN CONSIDERATION.

# NAIMertz



**NAI Mertz** | 21 Roland Avenue  
Mount Laurel, NJ 08054

856.234.9600 | [naimertz.com](http://naimertz.com)





# 600 MAIN STREET

Riverton, NJ 08077

 **SALE OR LEASE**

 **OFFICE**

 **3,800 SF**

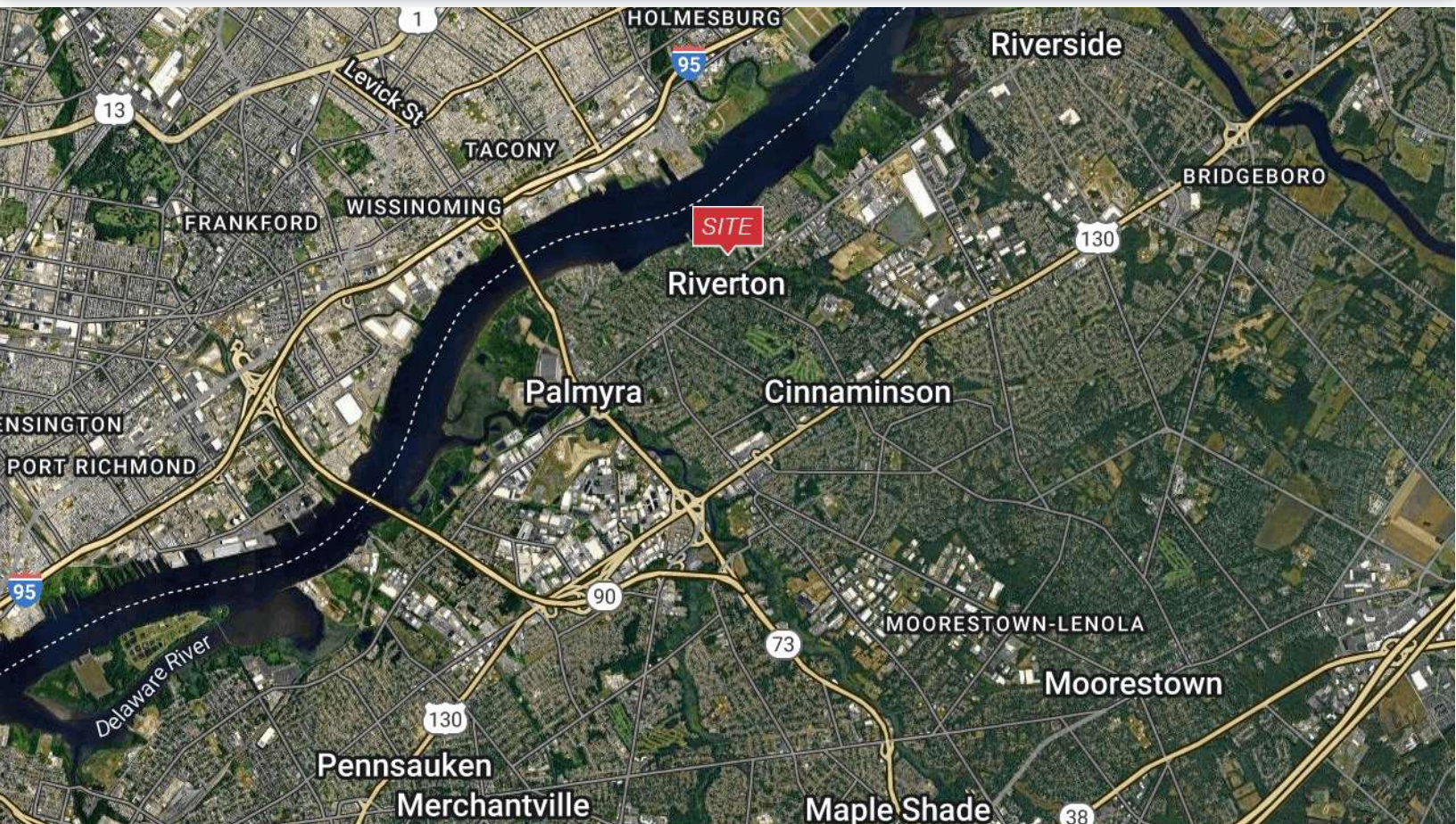

## POPULATION

	1 MILE	3 MILES	5 MILES
Total Population	10,515	127,228	440,004
Average Age	42	39	39
Average Age (Male)	41	38	38
Average Age (Female)	43	40	40

## HOUSEHOLDS & INCOME

	1 MILE	3 MILES	5 MILES
Total Households	4,202	46,070	161,256
# of Persons per HH	2.5	2.8	2.7
Average HH Income	\$138,707	\$91,000	\$89,404
Average House Value	\$358,998	\$241,651	\$254,517

Demographics data derived from AlphaMap

## FOR MORE INFORMATION

**Julie Kronfeld**

 856.802.6516

 julie.kronfeld@naimertz.com

**Rebecca Ting, SIOR**

 856.234.9600 x206

 rebecca.ting@naimertz.com

# NAIMertz



**NAI Mertz** | 21 Roland Avenue  
Mount Laurel, NJ 08054

856.234.9600 | [naimertz.com](http://naimertz.com)

NAI MERTZ DISCLAIMER: NO WARRANTY OR REPRESENTATION, EXPRESS OR IMPLIED, IS MADE AS TO THE ACCURACY OF THE INFORMATION CONTAINED HEREIN, AND THE SAME IS SUBMITTED SUBJECT TO ERRORS, OMISSIONS, CHANGE OF PRICE, RENTAL OR OTHER CONDITIONS, PRIOR SALE, LEASE OR FINANCING, OR WITHDRAWAL WITHOUT NOTICE, AND OF ANY SPECIAL LISTING CONDITIONS IMPOSED BY OUR PRINCIPALS NO WARRANTIES OR REPRESENTATIONS ARE MADE AS TO THE CONDITION OF THE PROPERTY OR ANY HAZARDS CONTAINED THEREIN ARE ANY TO BE IMPLIED. OUTLINES ARE APPROXIMATE AND SHOWN ONLY TO IDENTIFY THE PARCEL IN CONSIDERATION.

