

HOOVER OFFICE/WAREHOUSE

HOOVER, AL 35216

GrahamCompany.com



FOR LEASE | 3433-3439 Lorna Lane | Hoover, AL 35216

FOR LEASE

Hoover Office/Warehouse FOR LEASE

3433-3439 Lorna Ln
Hoover, AL 35216

BUILDING SIZE 10,000 SF

AVAILABLE SPACE Suite 3433: 2,500 SF

LEASE RATE: \$11.00 PER SF
INDUSTRIAL GROSS

PROPERTY HIGHLIGHTS

- Excellent access to I-459 and US Hwy 31
- Located in City of Hoover; no Occupational Tax
- (1) Dock high door
- 12' Clear height
- I-1; Light Industrial Zoning; City of Hoover
- End unit
- Situated between Vestavia Hills and Hoover, this flex space is in a prime location to serve the Over-the-Mountain communities

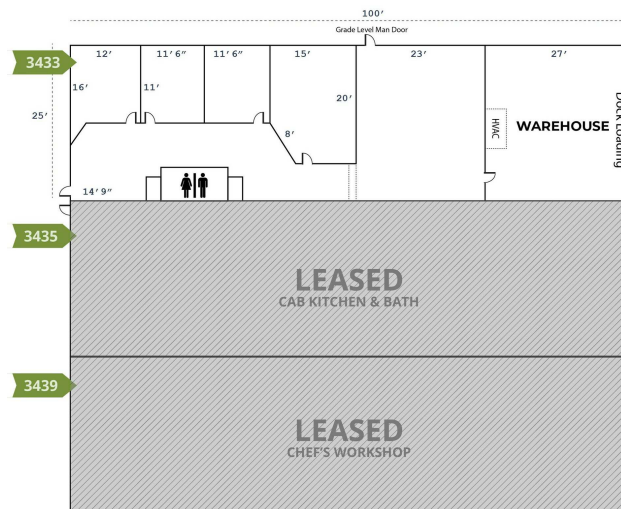

Information deemed reliable; not guaranteed.

JORDAN TUBB, SIOR
jordant@grahamcompany.com
205.871.7100

205.871.7100
GrahamCompany.com

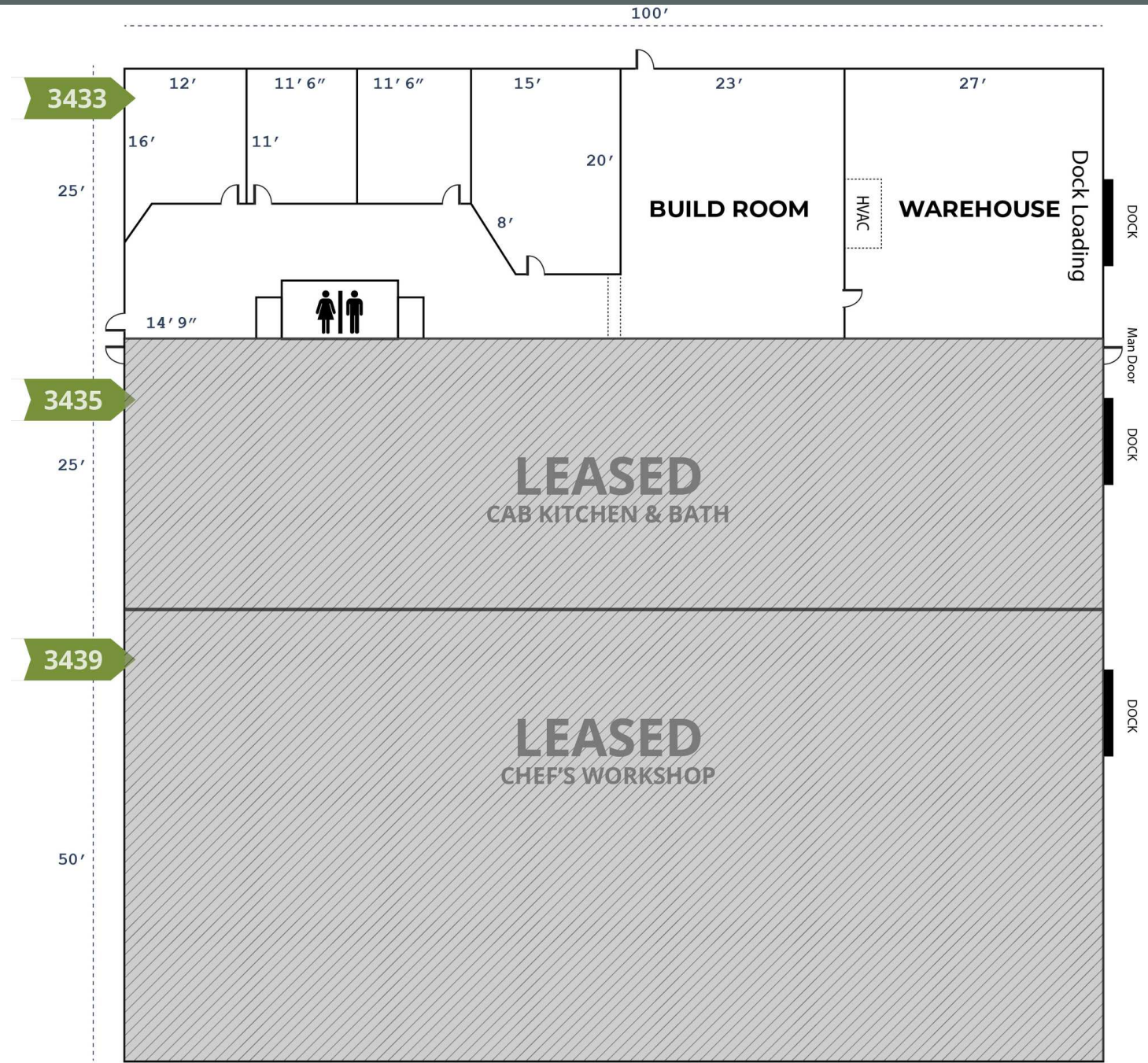

:: NOT TO SCALE ::