

Property Measurements

Parcel				
Legal:	Parcel No.:			
Property Address: 223 S Battleground Ave				
City: Kings Mountain	County: Cleveland	State: NC	ZipCode: 28086	
Owner:				
:				
Measurer: Square Up Measuring		Inspection Date: 10/29/2025		

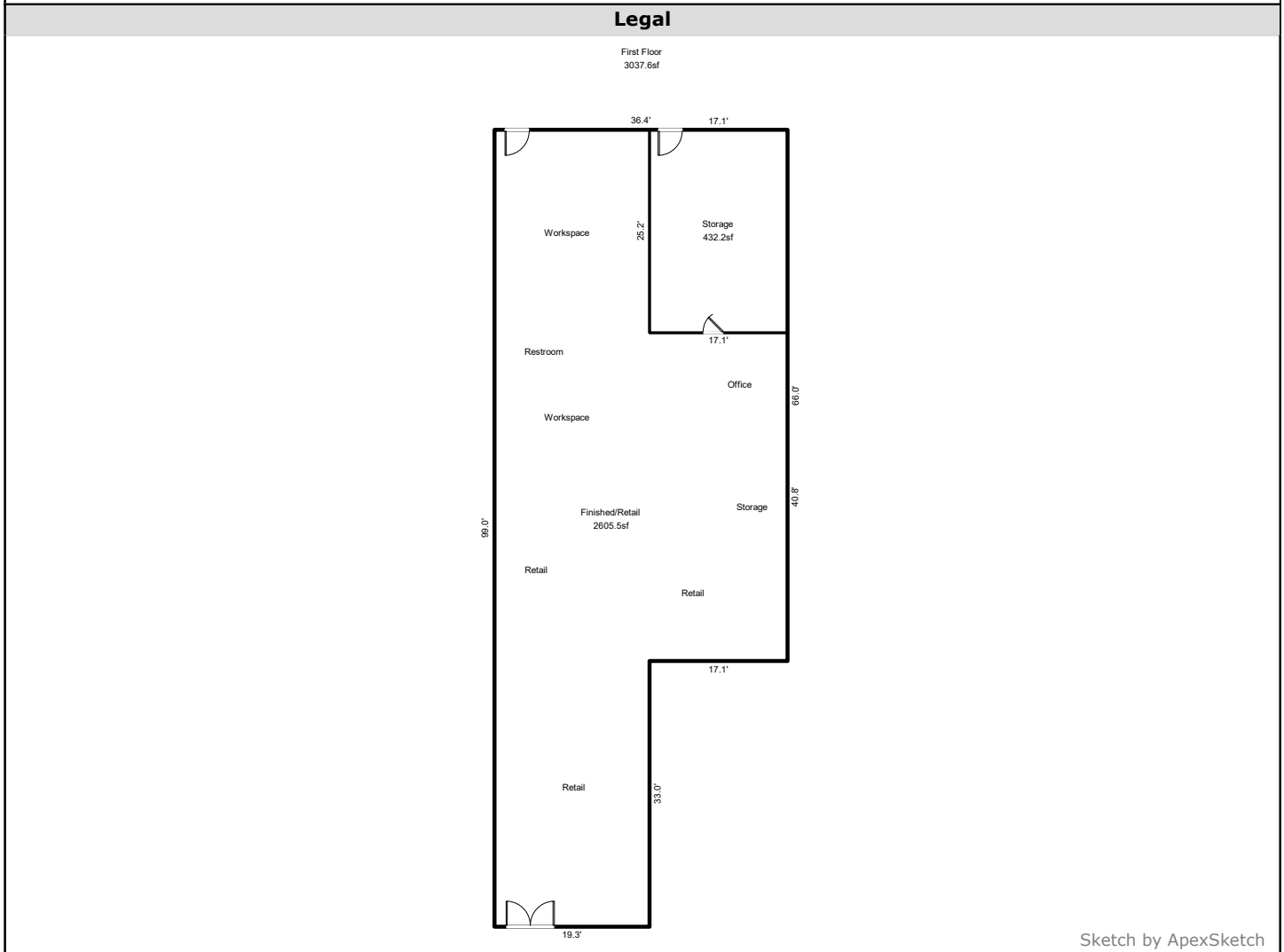

Sketch by ApexSketch

AREA CALCULATIONS SUMMARY						COMMENT TABLE 1	
Code	Description	Factor	Net Size	Perimeter	Net Totals		
GBA1	First Floor	1.0	3037.7	270.8	3037.7		
OTH	Storage	1.0	432.2	84.7			
	Finished/Retail	1.0	2605.5	270.8	3037.7		
						COMMENT TABLE 2	COMMENT TABLE 3
						Measurements based on interior dimensions	
Net BUILDING		cnt	1	(rounded)	3,038		

Property Measurements

Parcel			
Legal:	Parcel No.:		
Property Address: 223 S Battleground Ave			
City: Kings Mountain	County: Cleveland	State: NC	ZipCode: 28086
Owner:			
:			
Measurer: Square Up Measuring		Inspection Date: 10/29/2025	
Legal			
First Floor (GBA1)			
$99.00 \times 19.25 = 1905.75$			
$66.00 \times 17.15 = 1131.90$			
Total area: 3037.65			
Storage (OTH)			
$25.20 \times 17.15 = 432.18$			
Total area: 432.18			
Finished/Retail (OTH)			
$99.00 \times 19.25 = 1905.75$			
$40.80 \times 17.15 = 699.72$			
Total area: 2605.47			