

# MOUNT CARMEL EAST

## MEDICAL OFFICE FOR LEASE

5969 E. BROAD STREET, COLUMBUS, OH 43113



**LAURAH HALLOCK** *ADVISOR*

**MOBILE** 614.705.9571 | **DIRECT** 614.334.7841  
**LHALLOCK@EQUITY.NET**



**MATT COOPER** *SENIOR V.P.*

**MOBILE** 614.403.4732 | **DIRECT** 614.334.7831  
**MCOOPER@EQUITY.NET**



The information contained herein has been obtained from the property owner or other sources that we deem reliable. Although we have no reason to doubt its accuracy, no representation or warranty is made regarding the information, and the property is offered "as is". The submission may be modified or withdrawn at any time by the property owner.

# PROPERTY HIGHLIGHTS

- Medical outpatient building adjacent to Mt. Carmel East Hospital
- Prime location at East Broad Street (63,252 vpd) and I-270 (122,890 vpd)
- Refreshed common areas in 2024
- Anchored by Mt. Carmel Imaging and Radiation Oncology
- Generous concession packages
- Ample parking (4.5 per 1,000 SF)
- Covered drop-offs and north and south entrances limit patient walk distance

## MOUNT CARMEL EAST

MEDICAL OFFICE FOR LEASE  
5969 E. BROAD STREET, COLUMBUS, OH 43213

### 1,548 SF to 19,667 SF AVAILABLE

SUITE	SIZE	
200	13,788 SF	} 19,657 SF contiguous
201	1,548 SF	
202	4,321 SF	
301	4,256 SF	
302	2,570 SF	
401	3,599 SF	} 4,053 SF contiguous
402	2,417 SF	
404	1,636 SF	



# AERIALS





# AERIALS





# SPACE PLAN: 2<sup>nd</sup> FLOOR

## 2nd Floor

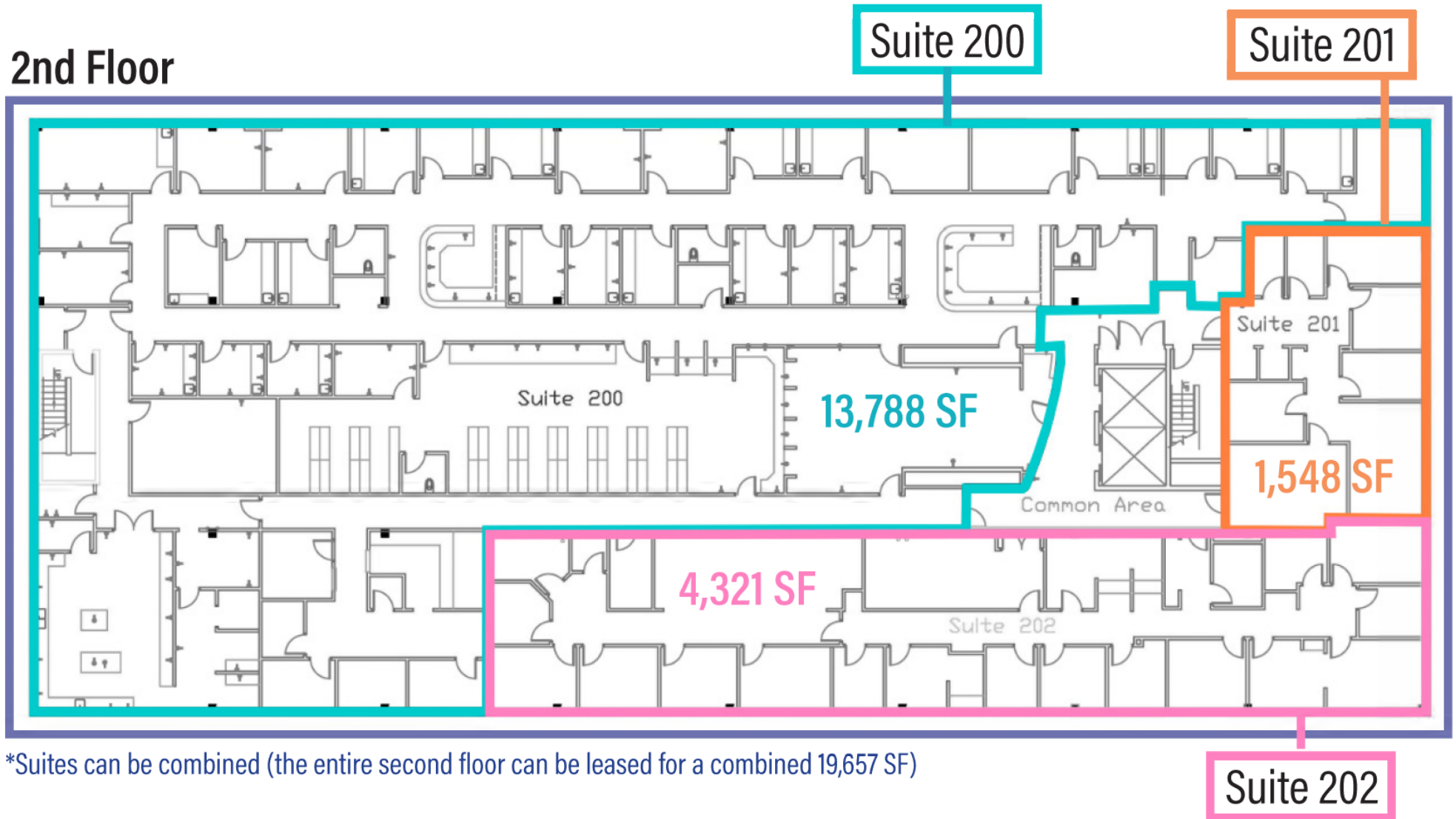

\*Suites can be combined (the entire second floor can be leased for a combined 19,657 SF)

# SPACE PLAN: 3<sup>rd</sup> FLOOR

3rd Floor

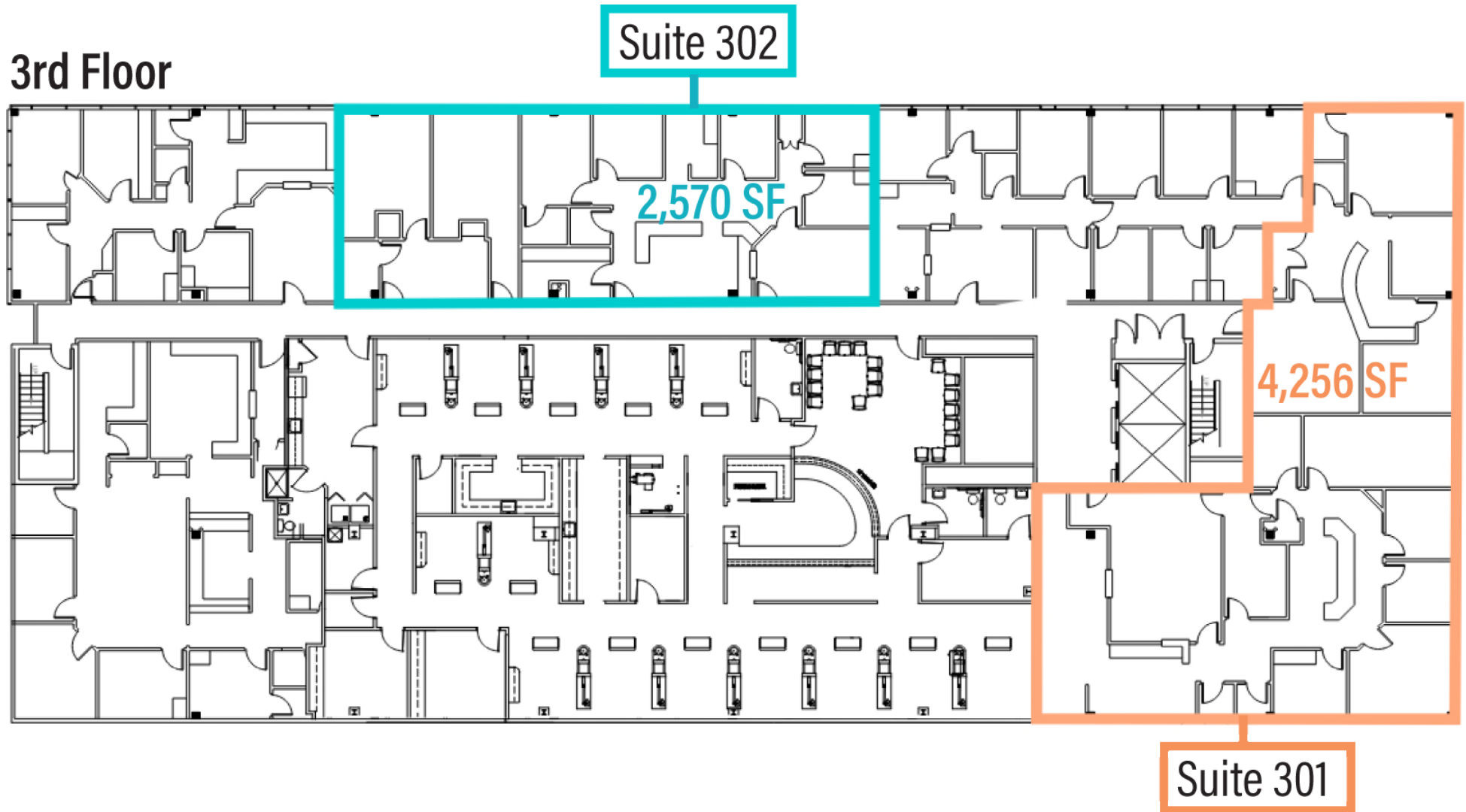

# SPACE PLAN: 4<sup>th</sup> FLOOR

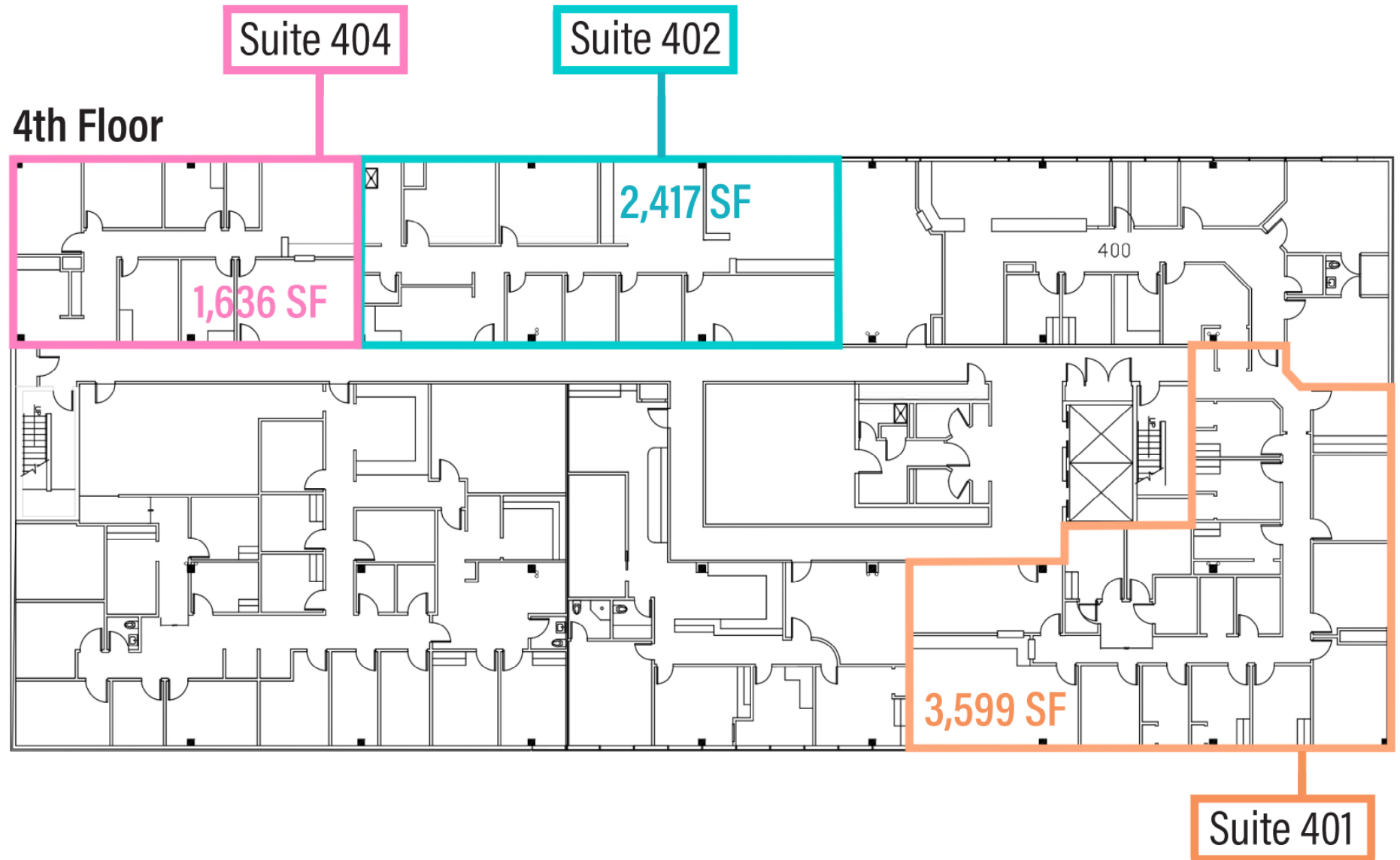



# INTERIOR PHOTOS





# EAST BROAD STREET AERIAL

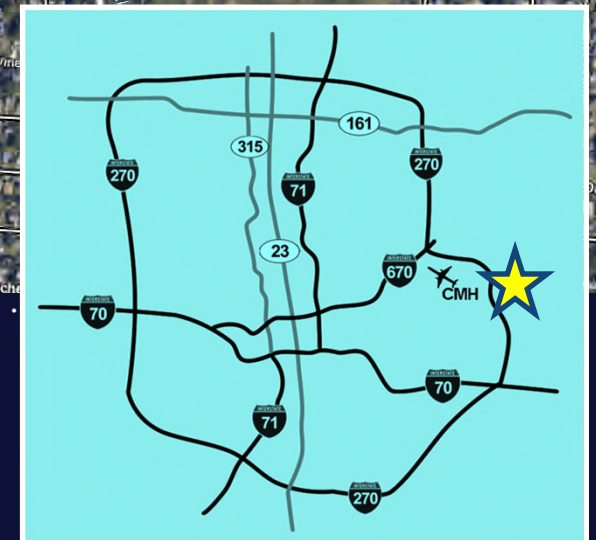
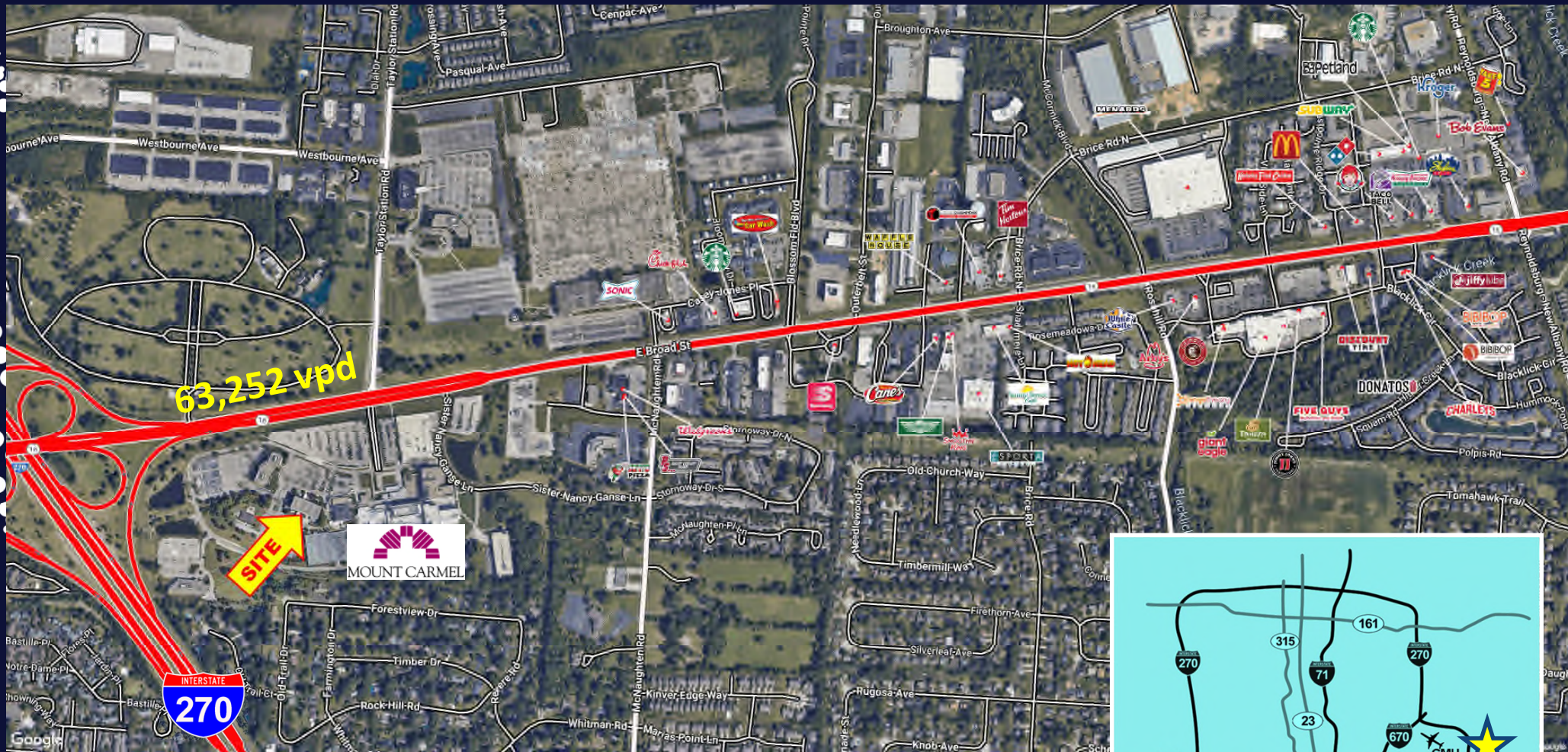



# 1-MILE RADIUS DEMOS

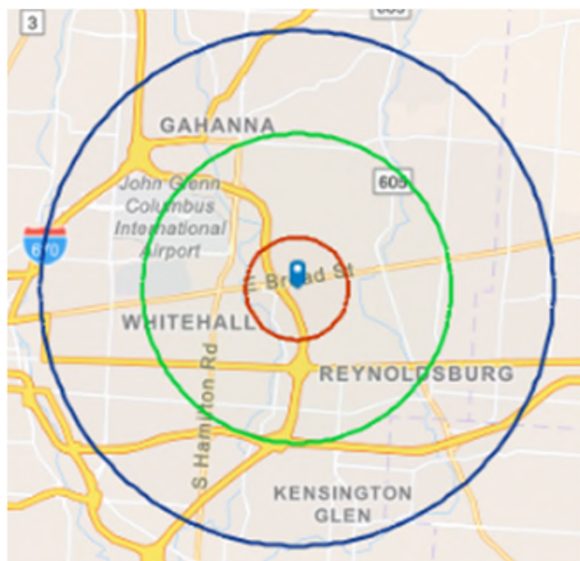

**equity** | brokerage

The information contained herein has been obtained from the property owner or other sources that we deem reliable. Although we have no reason to doubt its accuracy, no representation or warranty is made regarding the information, and the property is offered "as is." The submission may be modified or withdrawn at any time by the property owner.

## KEY FACTS

**7,859**

Population



Average  
Household Size



Median Age

**\$69,287**

Median Household Income

## BUSINESS



**318**

Total Businesses



**5,933**

Total Employees

## EDUCATION



**4%**

No High School  
Diploma



**25%**

High School  
Graduate



**29%**

Some  
College



**42%**

Bachelor's/Grad/Prof  
Degree

## INCOME



**\$45,087**

Per Capita  
Income



**\$69,287**

Median  
Household  
Income



**\$93,060**

Average  
Household  
Income

## EMPLOYMENT



**68.3**

White  
Collar %



**17.4**

Blue  
Collar %



**14.3**

Services  
%



# 3-MILE RADIUS DEMOS

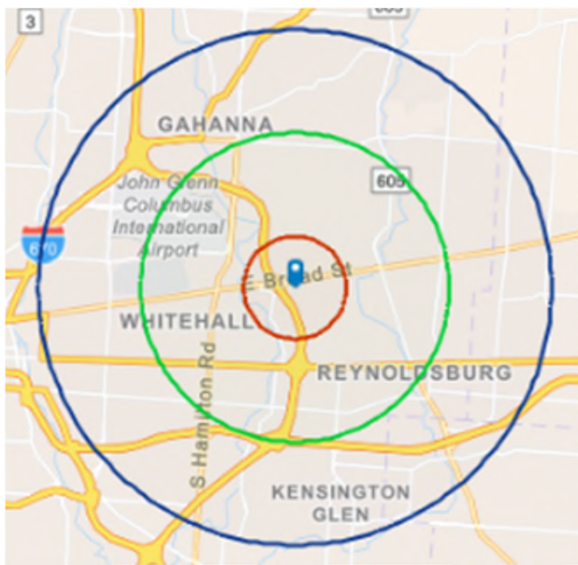

**equity** | brokerage

The information contained herein has been obtained from the property owner or other sources that we deem reliable. Although we have no reason to doubt its accuracy, no representation or warranty is made regarding the information, and the property is offered "as is." The submission may be modified or withdrawn at any time by the property owner.

## KEY FACTS

**93,557**

Population



Average  
Household Size



Median Age

**\$62,010**

Median Household Income

## BUSINESS



**3,327**

Total Businesses



**48,899**

Total Employees

## EDUCATION



**8%**

No High School  
Diploma



**32%**

High School  
Graduate



**31%**

Some  
College



**29%**

Bachelor's/Grad/Prof  
Degree

## INCOME



**\$36,413**

Per Capita  
Income



**\$62,010**

Median  
Household  
Income



**\$88,393**

Average  
Household  
Income

## EMPLOYMENT



**57.0**

White  
Collar %



**25.8**

Blue  
Collar %



**17.1**

Services  
%

# 5-MILE RADIUS DEMOS

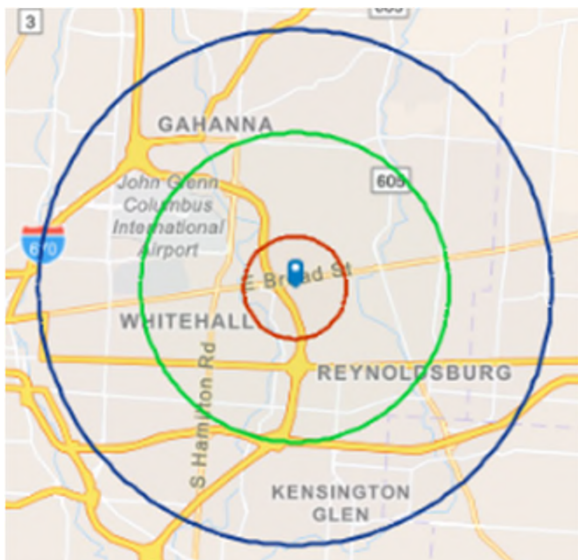

**equity** | brokerage

The information contained herein has been obtained from the property owner or other sources that we deem reliable. Although we have no reason to doubt its accuracy, no representation or warranty is made regarding the information, and the property is offered "as is." The submission may be modified or withdrawn at any time by the property owner.

## KEY FACTS

**261,167**

Population



Average  
Household Size



Median Age

**\$67,896**

Median Household Income

## BUSINESS



**7,528**

Total Businesses



**103,095**

Total Employees

## EDUCATION



**8%**

No High School  
Diploma



**29%**

High School  
Graduate



**28%**

Some  
College



**34%**

Bachelor's/Grad/Prof  
Degree

## INCOME



**\$39,013**

Per Capita  
Income



**\$67,896**

Median  
Household  
Income



**\$98,766**

Average  
Household  
Income

## EMPLOYMENT



**59.6**

White  
Collar %



**23.3**

Blue  
Collar %



**17.1**

Services  
%