

300 N PASADENA ST | GILBERT, AZ 85233
INDUSTRIAL CONDO AVAILABLE FOR LEASE

KOBBE
CONDOMINIUMS



COMMERCIAL PROPERTIES INC.

Locally Owned. Globally Connected. CORFAC INTERNATIONAL

TEMPE: 2323 W University Drive, Tempe, AZ 85281 | 480.966.2301
SCOTTSDALE: 8767 E Via de Commercio, Suite 101, Scottsdale, AZ 85258 | www.cpi.az.com

TYSON BREINHOLT

D 480.966.7513
M 602.315.7131
TBREINHOLT@CPIAZ.COM

CALEB ALLEN

D 480.621.3290
M 480.622.4174
CALLEN@CPIAZ.COM

JACK ELDER

D 480.968.9618
M 602.573.3210
JELDER@CPIAZ.COM

The information contained herein has been obtained from various sources. We have no reason to doubt its accuracy; however, J & J Commercial Properties, Inc. has not verified such information and makes no guarantee, warranty or representation about such information. The prospective buyer or lessee should independently verify all dimensions, specifications, floor plans, and all information prior to the lease or purchase of the property. All offerings are subject to prior sale, lease, or withdrawal from the market without prior notice.

INDUSTRIAL CONDO AVAILABLE FOR LEASE

Address	300 N Pasadena St Gilbert, AZ 85233
Building Size	±9,304 SF
Year Built	2011
Zoning	LI, City of Gilbert
Clear Height	16'
Project Near	Elliot Rd & McQueen



SPACES AVAILABLE

Suite #	Size	Lease Rate	Notes
104	±1,900 SF	\$1.40 NNN	Reception, Closet Storage, Restroom, Automatic Roll-Up Door
105	±2,948 SF	\$1.49 NNN	Includes 4 Offices, Restroom, Break Galley, Automatic Roll-Up Door, Outdoor Storage with 40'x9' Conex Box w/ Electrical, & HVAC

Suite 104 & 105 are contiguous up to ±4,848 SF.

SUITE 104

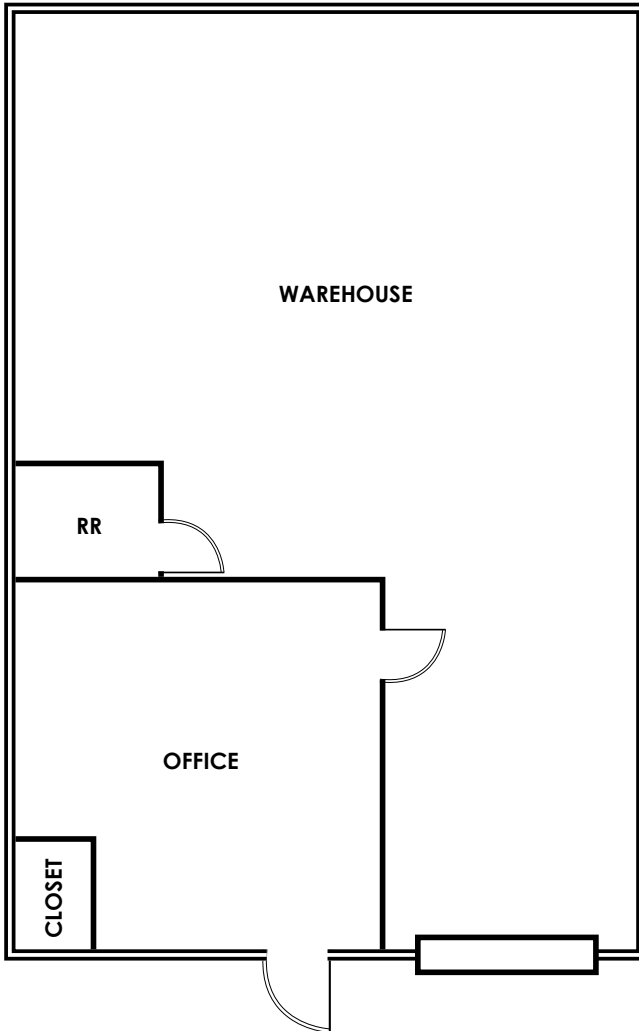

SUITE 105

