



FOR LEASE

3655 Atlanta Industrial Drive, Bldgs. 200 & 300, Atlanta, GA 30331

Total Available: 227,487 SF

Bldg. 200	Bldg. 200
Suite 200	Suite 250
» WH: 78,459 SF	» WH: 62,774 SF
» Office: 2,117 SF	» Office: 3,337 SF

Bldg. 300	Bldg. 300
Suite 100	Suite 300
» WH: 59,860 SF	» WH: 15,602 SF
» Office: 2,117 SF	» Office: 2,798 SF

Property Highlights

- Contiguous Space: Up to 182,939
- Configuration: Front Load
- Sprinklers: ESFR
- Power: 200 amp 480v 3-phase
- Clear Height: 22'-28'
- Building Depth: 230'-240'

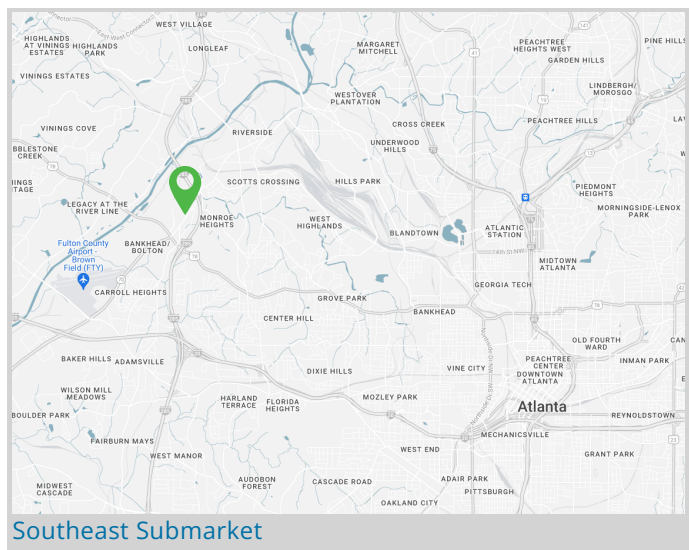

For Leasing Information:

Nat Weikert
 C 678.575.4607
 Nat.weikert@onpacepartners.com

Calvin O'Keeffe
 C 404.281.6404
 Calvin@onpacepartners.com

Riley Buttorff
 C 813.708.4301
 Riley.buttorff@onpacepartners.com



FOR LEASE

3655 Atlanta Industrial Drive, Bldg. 200

 Office SF
6,802

 Warehouse SF
176,137

 Clear Height
22 - 26'

 Total SF
182,939

 Column Spacing
40'-40'

 Loading Doors
28 DH / 2 DI

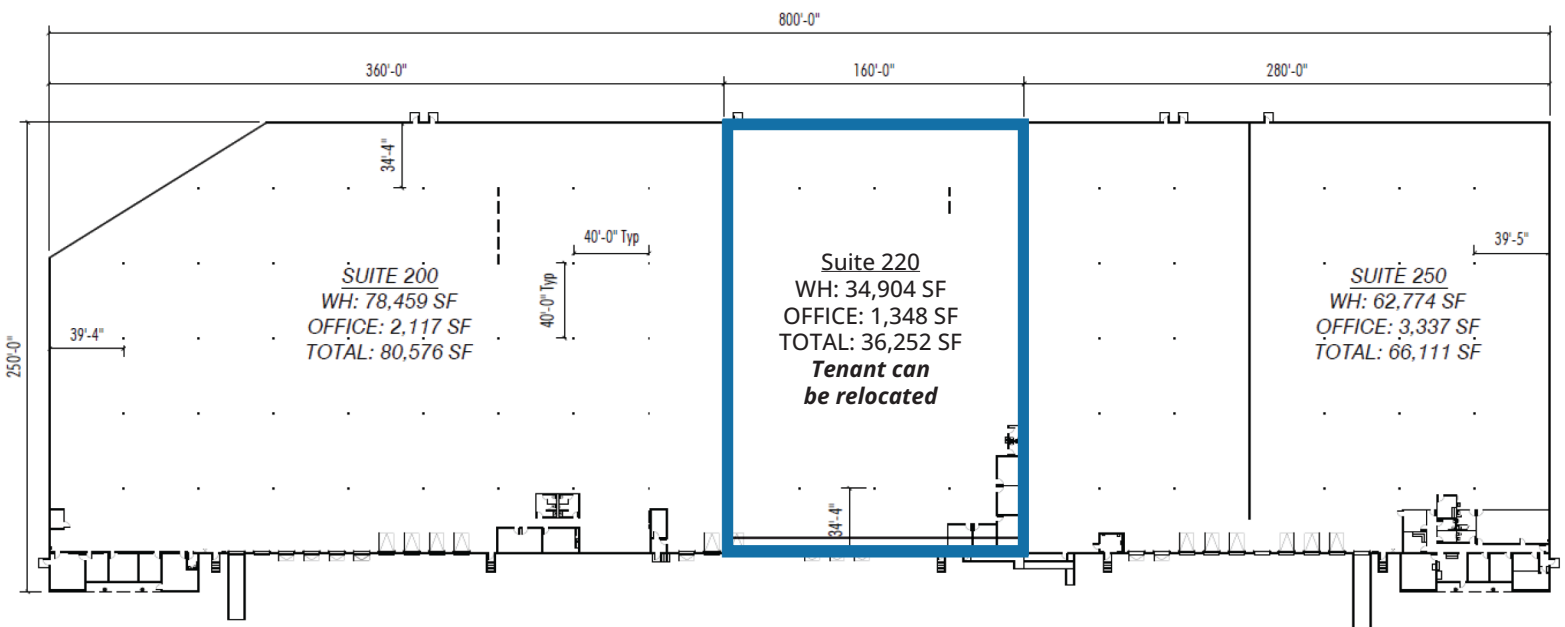

For Leasing Information:

Nat Weikert
C 678.575.4607
Nat.weikert@onpacepartners.com

Calvin O'Keeffe
C 404.281.6404
Calvin@onpacepartners.com

Riley Buttorff
C 813.708.4301
Riley.buttorff@onpacepartners.com



FOR LEASE

3655 Atlanta Industrial Drive, Bldg. 300

 Office SF
5,338

 Warehouse SF
75,462

 Clear Height
28'

 Total SF
80,800

 Column Spacing
40'-40'

 Loading Doors
19 DH

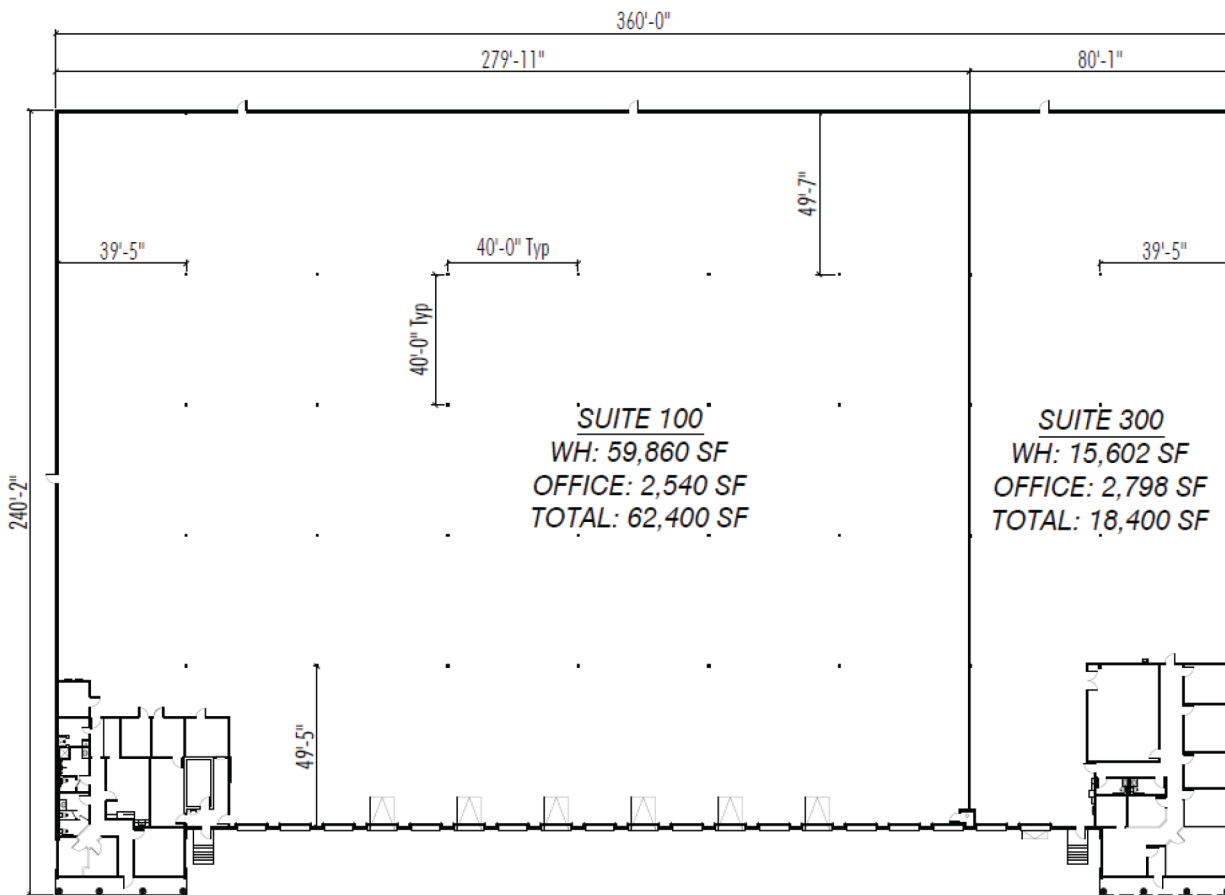

For Leasing Information:

Nat Weikert
C 678.575.4607
Nat.weikert@onpacepartners.com

Calvin O'Keeffe
C 404.281.6404
Calvin@onpacepartners.com

Riley Buttorff
C 813.708.4301
Riley.buttorff@onpacepartners.com



FOR LEASE

3655 Atlanta Industrial Drive, Atlanta, GA 30331



Building 300
80,800 SF

Building 200
182,939 SF

TOTAL AVAILABLE: 227,487 SF
BUILDING 200: SUITE 200, SUITE 220*, SUITE 250
BUILDING 300: SUITE 100, SUITE 300

*Tenant is available to relocate

For Leasing Information:

Nat Weikert
C 678.575.4607
Nat.weikert@onpacepartners.com

Calvin O'Keeffe
C 404.281.6404
Calvin@onpacepartners.com

Riley Buttorff
C 813.708.4301
Riley.butterff@onpacepartners.com



Bridge does not have the responsibility to update the information to account for changes and makes no representation or warranty, expressed or implied, with respect to the accuracy or completeness of any of the information contained herein.