



Light Industrial Suite For Lease

**181 MAYHEW WAY, SUITE D
WALNUT CREEK, CA**

Area

±1,812 SF With two (2) grade level doors

Property Highlights

- Rare Industrial property located in the Walnut Creek/ Pleasant Hill border, in close proximity to I-680, Hwy 24, Walnut Creek and local retail amenities
- Each unit contains 120/208v, 3 phase, electrical service (tenant to verify)
- Minimum ceiling clearance: ±12'-±13'
- Each unit has at least one grade level loading door



For information, please contact:

Tyler Epting

Managing Director

t 925-974-0238

tyler.epting@nrmk.com

CA RE Lic. #01317533

Kris Hagar

Director

t 925-974-0119

kris.hagar@nrmk.com

CA RE Lic. #02009499

nrmk.com

NEWMARK

The distributor of this communication is performing acts for which a real estate license is required. The information contained herein has been obtained from sources deemed reliable but has not been verified and no guarantee, warranty or representation, either express or implied, is made with respect to such information. Terms of sale or lease and availability are subject to change or withdrawal without notice.
14-1263 01/24

FLOOR PLAN

181 MAYHEW WAY SUITE D: ±1,812 SF

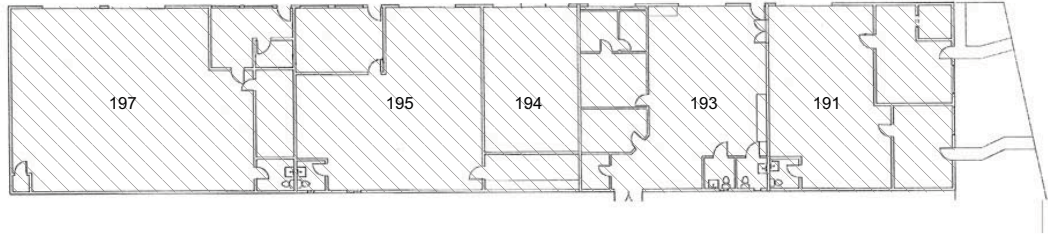

YARD

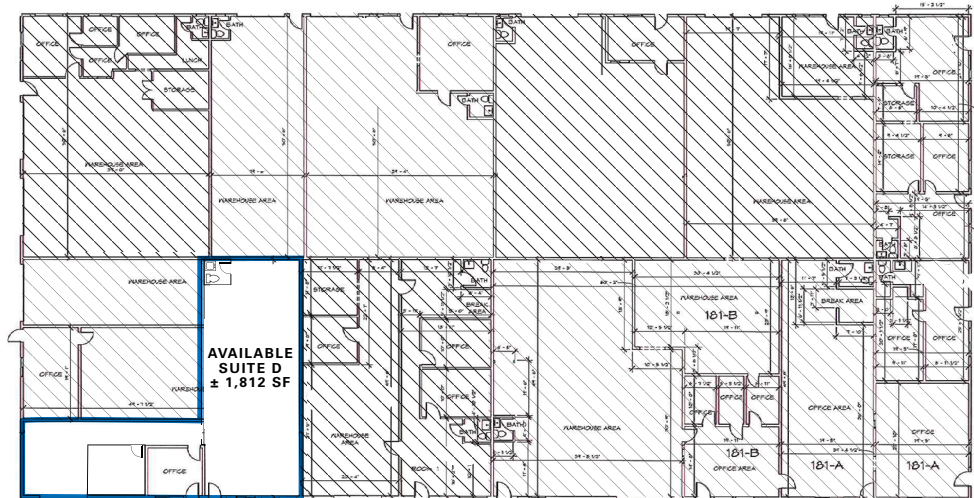
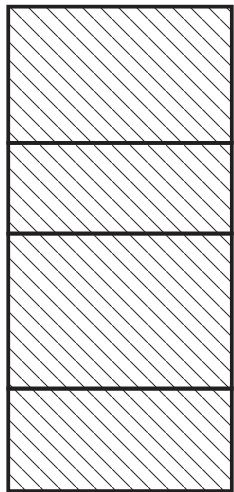

Vincent Road

Mayhew Way



Leased

△ Grade Level Roll-Up Door

For information, please contact:

Tyler Epting
 Managing Director
 t 925-974-0238
 tyler.epting@nmrk.com
 CA RE Lic. #01317533

Kris Hagar
 Director
 t 925-974-0119
 kris.hagar@nmrk.com
 CA RE Lic. #02009499

nmrk.com



The distributor of this communication is performing acts for which a real estate license is required. The information contained herein has been obtained from sources deemed reliable but has not been verified and no guarantee, warranty or representation, either express or implied, is made with respect to such information. Terms of sale or lease and availability are subject to change or withdrawal without notice. 14-1263 01/24