

get **MULTI** family



SIX ON HEATHERBRAE

2140-2144 W. Heatherbrae Dr, Phoenix, AZ 85015

Sophia Willets | 480.375.0227 | sophia@gracecre.com
Garrett Pedicini | 602.791.9497 | garrett@gracecre.com



CONFIDENTIALITY & DISCLAIMER

All materials and information received or derived from getMULTIfamily, its directors, officers, agents, advisors, affiliates and/or any third party sources are provided without representation or warranty as to completeness, veracity, or accuracy, condition of the property, compliance or lack of compliance with applicable governmental requirements, developability or suitability, financial performance of the property, projected financial performance of the property for any party's intended use or any and all other matters.

Neither getMULTIfamily, its directors, officers, agents, advisors, or affiliates makes any representation or warranty, express or implied, as to accuracy or completeness of the any materials or information provided, derived, or received. Materials and information from any source, whether written or verbal, that may be furnished for review are not a substitute for a party's active conduct of its own due diligence to determine these and other matters of significance to such party. getMULTIfamily will not investigate or verify any such matters or conduct due diligence for a party unless otherwise agreed in writing.

EACH PARTY SHALL CONDUCT ITS OWN INDEPENDENT INVESTIGATION AND DUE DILIGENCE.

Any party contemplating or under contract or in escrow for a transaction is urged to verify all information and to conduct their own inspections and investigations including through appropriate third party independent professionals selected by such party. All financial data should be verified by the party including by obtaining and reading applicable documents and reports and consulting appropriate independent professionals. getMULTIfamily makes no warranties and/or representations regarding the veracity, completeness, or relevance of any financial data or assumptions. getMULTIfamily does not serve as a financial advisor to any party regarding any proposed transaction. All data and assumptions regarding financial performance, including that used for financial modeling purposes, may differ from actual data or performance. Any estimates of market rents and/or projected rents that may be provided to a party do not necessarily mean that rents can be established at or increased to that level. Parties must evaluate any applicable contractual and governmental limitations as well as market conditions, vacancy factors and other issues in order to determine rents from or for the property.

Legal questions should be discussed by the party with an attorney. Tax questions should be discussed by the party with a certified public accountant or tax attorney. Title questions should be discussed by the party with a title officer or attorney. Questions regarding the condition of the property and whether the property complies with applicable governmental requirements should be discussed by the party with appropriate engineers, architects, contractors, other consultants and governmental agencies. All properties and services are marketed by getMULTIfamily in compliance with all applicable fair housing and equal opportunity laws.

TABLE OF CONTENTS

PROPERTY SUMMARY	4
PROPERTY INFORMATION	5
PROPERTY DESCRIPTION	6
ADDITIONAL PHOTOS	7
LOCATION INFORMATION	8
REGIONAL MAP	9
LOCATION MAP	10
FINANCIAL ANALYSIS	11
FINANCIAL SUMMARY	12
INCOME & EXPENSES	13
RENT ROLL	14
SALE COMPARABLES	15
SALE COMPS	16
SALE COMPS MAP & SUMMARY	17
DEMOGRAPHICS	18



get **MULTI** family

SECTION 1

PROPERTY INFORMATION

SIX ON HEATHERBRAE

2140-2144 W. Heatherbrae Dr, Phoenix, AZ 85015



Six on Heatherbrae

Six on Heatherbrae presents a compelling value-add multifamily investment consisting of spacious two-bedroom, one-bath units, each featuring central air conditioning and private, generously sized backyards--an increasingly rare amenity in this asset class. The property is fully gated, offering enhanced security and tenant appeal. Current rents are significantly below market at approximately \$995 per unit, all on month-to-month leases, providing immediate upside. With strategic renovations, rents are projected to achieve \$1,300 to \$1,450 per unit, creating a clear path to increased cash flow and asset appreciation. An on-site laundry facility offers additional income potential and operational efficiency. The offering includes two triplex buildings combined purchase price: \$950,000.

* 2140 W Heatherbrae - \$475,000 must be purchased together

* 2144 W Heatherbrae - \$475,000 must be purchased together

Additionally, the adjacent property at 2134 W Heatherbrae will be coming to market at \$475,000, presenting a rare opportunity to acquire all three triplexes (9 total units) for a combined price of \$1,425,000.

The property is centrally located with strong rental demand drivers and accessibility. Financing options include conventional and commercial loan structures.

All facts and figures are approximate. Buyer to verify all information. Seller is Holds an active real estate Brokers license in AZ and FL

Additional Notes

Lot Size: 8,486 SF (0.195 AC)

Building SF: 5,508 (2,754/building)

Zoning: R-3

Year Built: 1963



ADDITIONAL PHOTOS



get **MULTI** family

SECTION 2

**LOCATION
INFORMATION**

SIX ON HEATHERBRAE

2140-2144 W. Heatherbrae Dr, Phoenix, AZ 85015



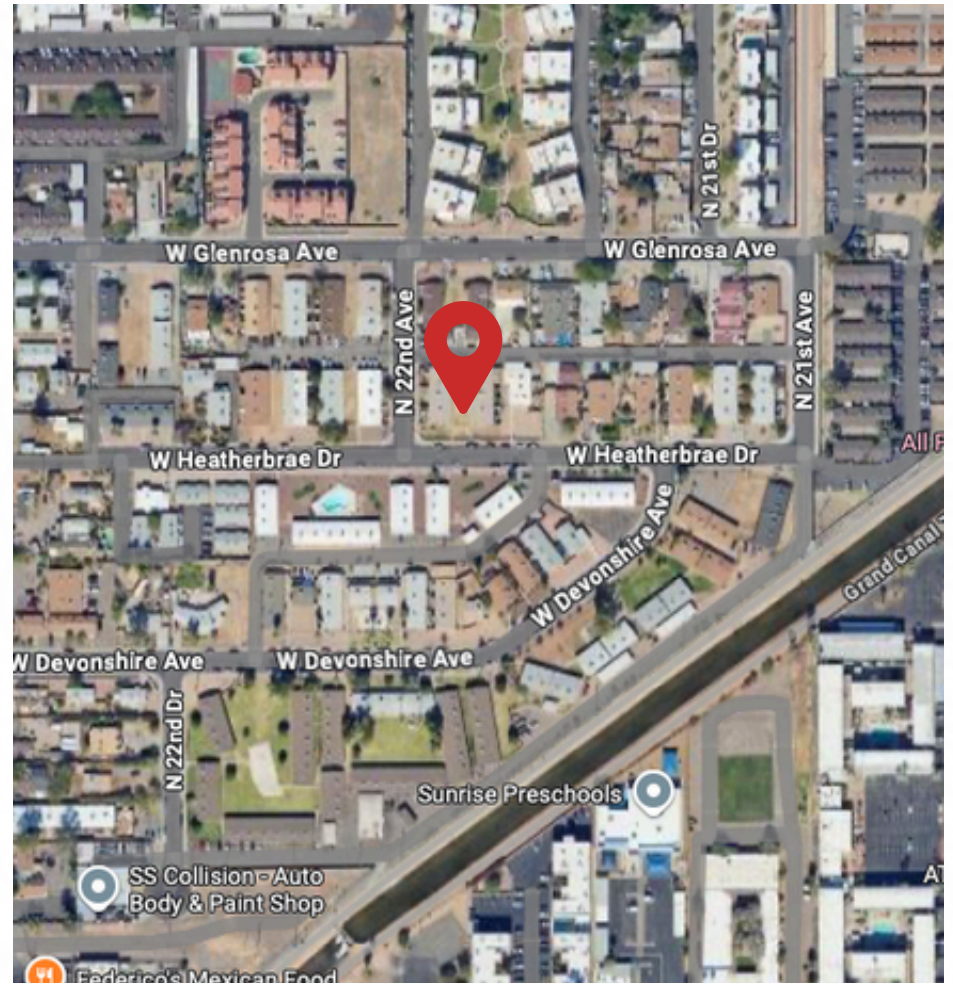
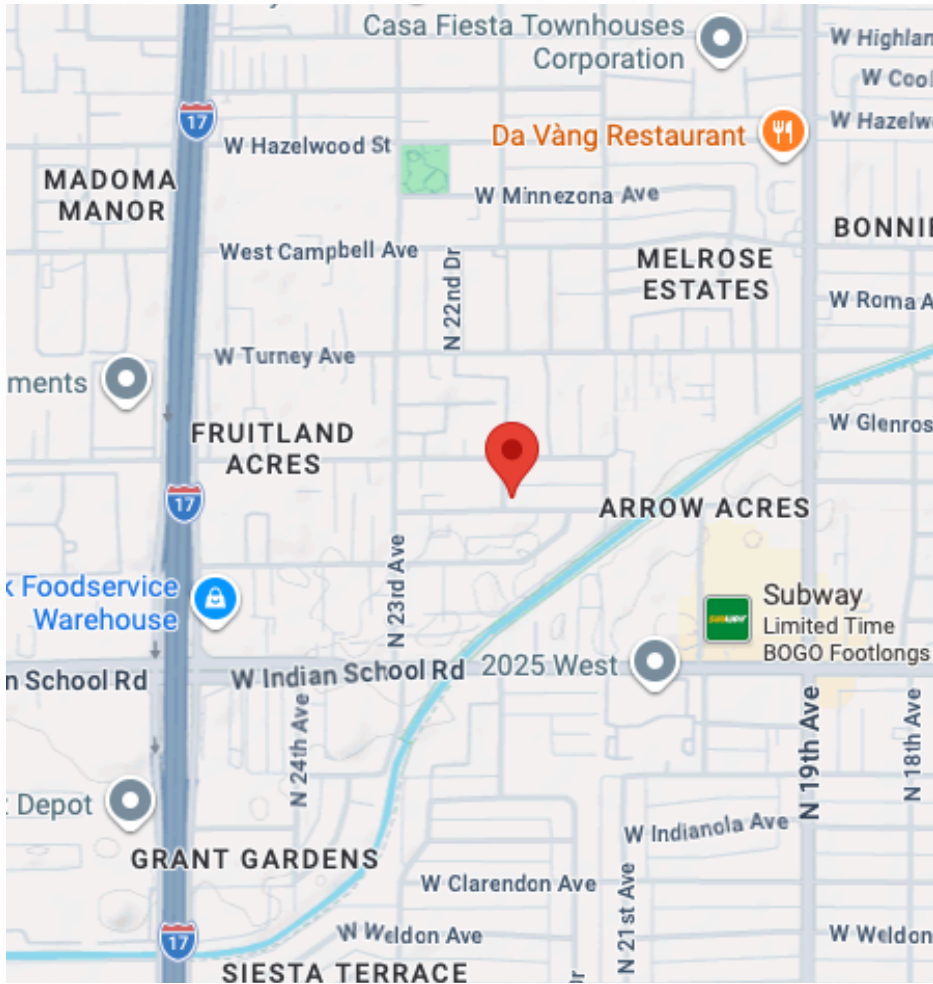

TERRAIN VIEW

SATELLITE VIEW

LOCATION MAP



SATELLITE VIEW

get **MULTI** family

SECTION 3

FINANCIAL ANALYSIS

SIX ON HEATHERBRAE

2140-2144 W. Heatherbrae Dr, Phoenix, AZ 85015



FINANCIAL SUMMARY



INVESTMENT OVERVIEW	
Price	\$950,000
Price per SF	\$172/SF
Price per Unit	\$158,333/Unit
Pro-Forma CAP Rate	7.13%

OPERATING DATA	
Pro-Forma Scheduled Income	\$93,600
Less: Operating Expenses	(\$21,171)
Less: Vacancy Factor (5%)	(\$4,680)
Net Operating Income	\$67,749

INCOME EXPENSES



INCOME SUMMARY	ANNUAL
Pro-Forma Rental Income	\$93,600
Vacancy Factor (5%)	(\$4,680)
GROSS INCOME	\$88,920

EXPENSES SUMMARY	ANNUAL
Utilities	\$4,600
Maintenance	\$3,000
Landscaping	\$1,200
Management	\$4,320
Insurance	\$4,800
Taxes	\$3,251
OPERATING EXPENSES	\$21,171
NET OPERATING INCOME	\$67,749

RENT ROLL



SUITE	BEDROOMS	BATHROOMS	SIZE SF	MARKET RENT	ANNUAL MKT RENT	ACTUAL RENT	Lease End
1	2	1	918 SF	\$1,300	\$15,600	\$850	MTM
2	2	1	918 SF	\$1,300	\$15,600	\$850	MTM
3	2	1	918 SF	\$1,300	\$15,600	\$850	MTM
4	2	1	918 SF	\$1,300	\$15,600	\$850	MTM
5	2	1	918 SF	\$1,300	\$15,600	\$850	MTM
6	2	1	918 SF	\$1,300	\$15,600	\$850	MTM
TOTALS			5,508 SF	\$7,800	\$93,600	\$5,100	
AVERAGES			918 SF	\$1,300	\$15,600	\$850	

get **MULTI** family

SECTION 4

DEMOGRAPHICS

SIX ON HEATHERBRAE

2140-2144 W. Heatherbrae Dr, Phoenix, AZ 85015

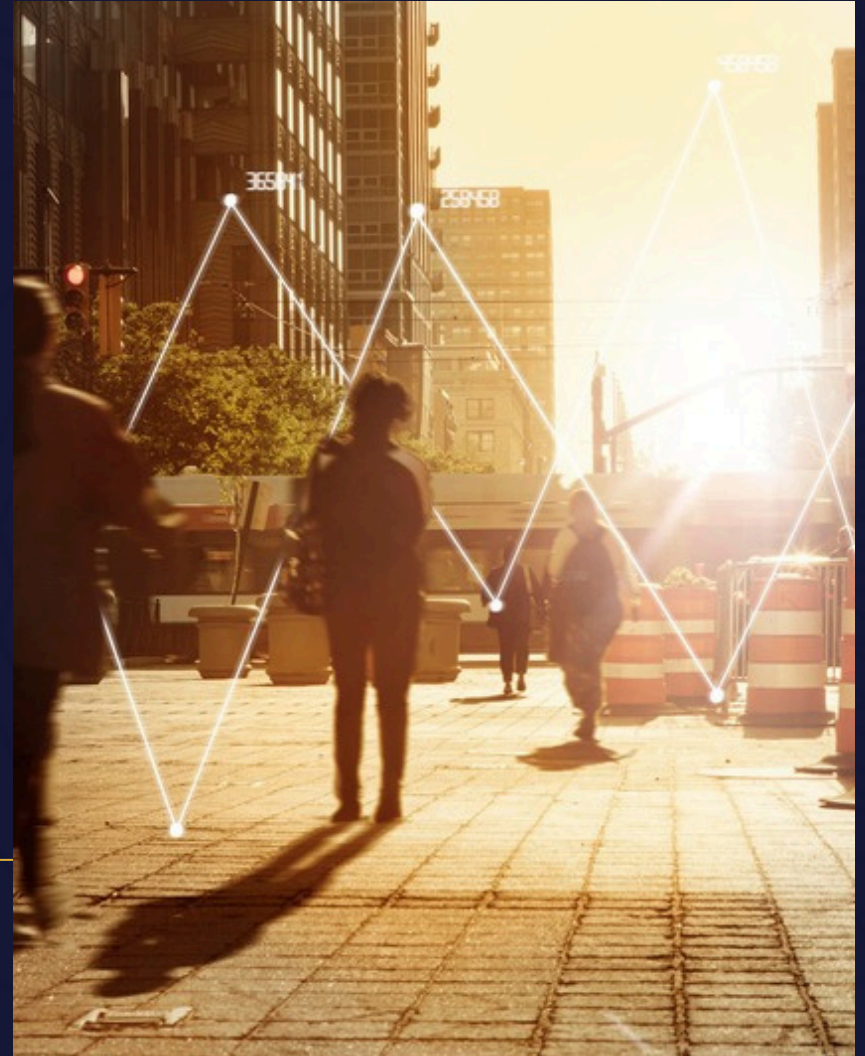

2144 W HEATHERBRAE DR, PHOENIX, AZ 85015

FOOD REPORT

NEIGHBORHOOD EATS

This home is located near **159** moderately priced restaurants and has an **above average** variety of cuisines.

182 ★★★+
WITHIN 5 MILES

\$	99
\$\$	60
\$\$\$	9
\$\$\$\$	3

Demographics data derived from CoStar

GOOD EATS BY CATEGORY

AMERICAN	61
FAST FOOD	19
DELIS	14
MEXICAN	12
CAFES, COFFEE AND TEA	11
ASIAN	11
CHINESE	8
BARs	6
SPORTS BARs	5
OTHER	16

ListReports DISCLAIMER: The information in this report is from third-party sources and its accuracy cannot be guaranteed.

2144 W HEATHERBRAE DR, PHOENIX, AZ 85015

AREA REPORT

VERY CONVENIENT

This home is in a **very convenient** area. Some daily errands in this location **require a car** and most major services are within **1 mile**.

CHASE ATM	ARCO GAS	MEDICAL	GROCERIES	CLEANERS
0.2 MILES	0.2 MILES	0.2 MILES	0.3 MILES	0.3 MILES
MEDIA	GYM	COFFEE	CVS PHARMACY	
1.7 MILES	1 MILE	0.5 MILES	0.4 MILES	

ListReports DISCLAIMER: The information in this report is from third-party sources and its accuracy cannot be guaranteed.

2144 W HEATHERBRAE DR, PHOENIX, AZ 85015

SCHOOL REPORT

SCHOOLS IN YOUR AREA

The assigned schools are **average** for the area. There are also **32** private schools and **63** charter schools within **5 miles**.

K-5	WESTWOOD ELEMENTARY SCHOOL ASSIGNED	1 RATING	1.9 MILES
6-8	CHOICE LEARNING ACADEMY ASSIGNED	2 RATING	1.3 MILES
9-12	CENTRAL HIGH SCHOOL ASSIGNED	4 RATING	0.6 MILES

ListReports DISCLAIMER: School data is provided by ATYOM Data Solutions and agent selection. It is intended for reference only. Contact the school or district directly to verify enrollment eligibility.

2144 W HEATHERBRAE DR, PHOENIX, AZ 85015

OUTDOOR REPORT

THE GREAT OUTDOORS

This home is located near a variety of outdoor activities.

POPULAR

PARK TAWA PARK	1.1 MILES
GOLF COURSE ENCANTO 18 HOLE GOLF COURSE	1.6 MILES
DOG PARK STEELE INDIAN SCHOOL PARK	2.1 MILES
LAKE DR C R. BIRD, MD	5 MILES

29 GOLF COURSES
11 PARKS
3 DOG PARKS
2 LAKES
WITHIN 10 MILES

ListReports DISCLAIMER: The information in this report is from third-party sources and its accuracy cannot be guaranteed.

get **MULTI** family

SECTION 5

THE TEAM



SIX ON HEATHERBRAE

2140-2144 W. Heatherbrae Dr, Phoenix, AZ 85015



GARRETT PEDICINI

Garrett is a dynamic commercial real estate professional with a proven track record in acquisitions, sales, and business development. While earning his degree in Economics from Arizona State University, he joined LevRose Commercial Real Estate as a Junior Agent but earned a permanent place on the team after graduation. He continues to leverage his market knowledge to deliver results-driven solutions. Garrett's expertise spans over \$80 million in commercial property sales and leases. As a commercial agent, he advised clients on site selection, property valuations, market analysis, and enhancing client portfolios. As a member of NAIOP and ICSC, Garrett continues to refine his industry knowledge. Recognized as an Emerging Professional by Commercial Executive Magazine, Garrett embodies innovation, leadership, and a commitment to excellence in commercial real estate.

O: (602) 223-1721 | C: (602) 791-9497 | garrett@gracecre.com | LIC: SA687268000



SOPHIA WILLETS

Sophia Willets, the owner and lead broker of Grace CRE, is a seasoned professional with a deep passion for commercial real estate. She leads the company with a client-first mentality bring maximum returns to her investors. Unlike larger, more traditional brokerages, she is committed to full-market exposure and ethical representation to every deal. Since starting her career in 2013, Sophia has completed over 1,000 transactions and over 30 personal investments, achieving over One Billion dollars in returns for her clients. With offices in Southeast Florida and Arizona, two of the fastest growing real estate market, she can provide a variety of unique investments opportunities to meet your financial goals.

O: (561) 269-9525 | C: (480) 375-0227 | sophia@gracecre.com | LIC: BR648866000 (AZ) / BK3595388 (FL)



VISION. STRATEGY. RESULTS.



FOR MORE INFORMATION CONTACT

Sophia Willets | (480) 375-0227 | sophia@gracecre.com

Garrett Pedicini | (602) 791-9497 | garrett@gracecre.com

Fort Lauderdale, FL Office
200 East Las Olas Boulevard, Floor 14
(561) 269-9525

Scottsdale, AZ Office
15051 N Kierland Blv, Floor 2 & 3
(602) 975-5516

gracecre.com