



AVAILABLE - ±16,274 TO 22,308 SF FLEX/INDUSTRIAL

18475 BANDILIER CIRCLE | FOUNTAIN VALLEY, CA



PROPERTY FEATURES:

- » ±22,308 SF Flex/Industrial Building with ±9,881 SF of Single-Story Office (*Can be Reduced*)
- » Divisible to 16,274 SF with ±7,851 SF of Office (*Can be Reduced*)
- » High-Image Building with Extensive Glass-line
- » High Identity, Located on the Corner of Ellis Avenue and Bandilier Circle
- » Two (2) Ground Level Loading Doors
- » 1,600 Amps of Power (Two 800 Amp Panels) (*verify*)
- » 2:1 Car Parking Ratio
- » 18' Warehouse Clearance
- » Secured Parking/Yard Possible
- » Fire Sprinklers
- » Immediate Access to San Diego (405) Freeway
- » Near Coastal Communities and Irvine Business Complex

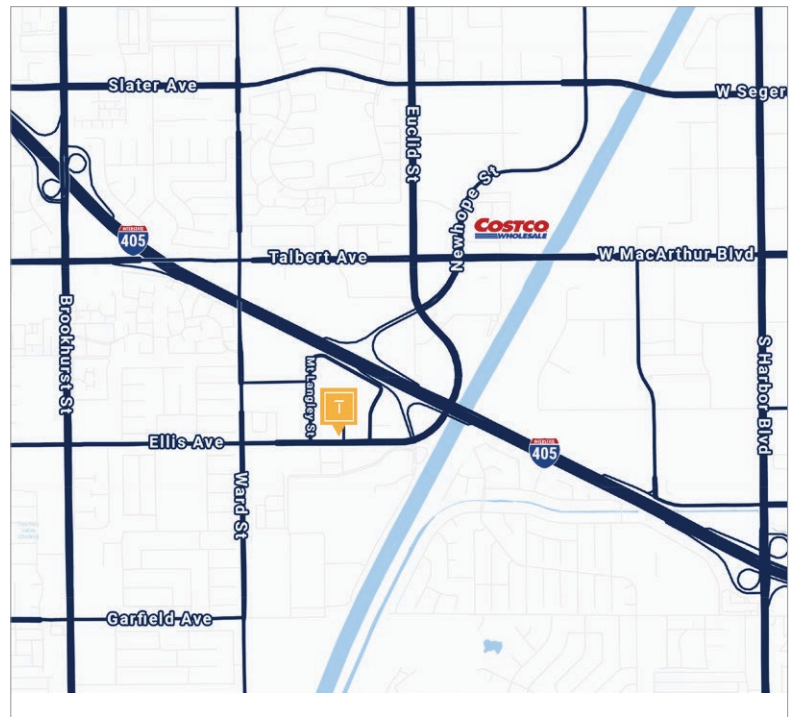

CONTACT US:

PAT LACEY

Executive Director
 (714) 875-4134
 pat@tidemarkrealestate.com
 DRE 00988663

TAYLOR SNYDER, MBA

Senior Vice President
 (949) 533-1321
 taylor@tidemarkrealestate.com
 DRE Lic. 02092420

WILL GREUBEL

Senior Vice President
 (714) 614-7623
 will@tidemarkrealestate.com
 DRE Lic. 02039807

JIM SNYDER, CCIM, CPM®

Chief Executive Officer
 (949) 533-1190
 jim@tidemarkrealestate.com
 DRE 00872220

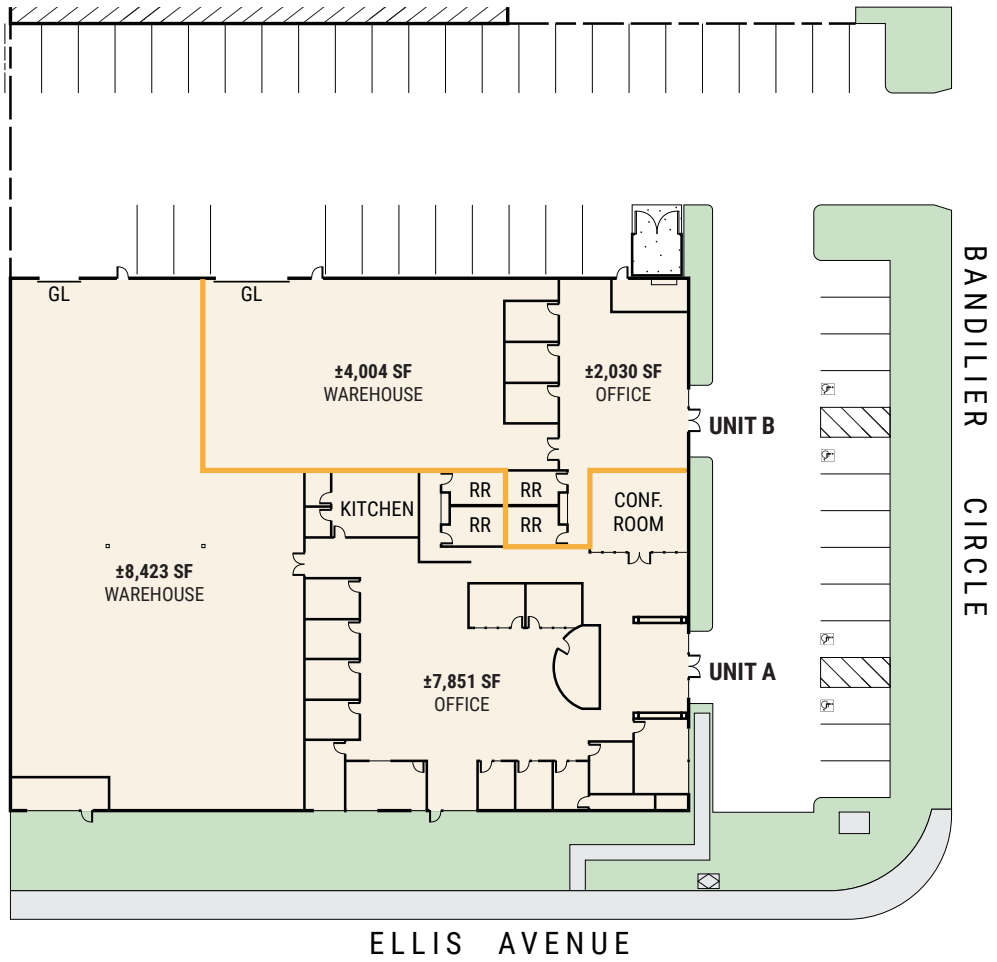

CONTACT US:

PAT LACEY
 Executive Director
 (714) 875-4134
 pat@tidemarkrealestate.com
 DRE 00988663

TAYLOR SNYDER, MBA
 Senior Vice President
 (949) 533-1321
 taylor@tidemarkrealestate.com
 DRE Lic. 02092420

WILL GREUBEL
 Senior Vice President
 (714) 614-7623
 will@tidemarkrealestate.com
 DRE Lic. 02039807

JIM SNYDER, CCIM, CPM®
 Chief Executive Officer
 (949) 533-1190
 jim@tidemarkrealestate.com
 DRE 00872220



DISCLAIMER: The information contained herein has been obtained from the property owner or other third party and is provided to you without verification as to accuracy. We (Tidemark Real Estate Services, Inc., its brokers, employees, agents, principals, officers, directors and affiliates) make no warranty or representation regarding the information, property, or transaction. You and your attorneys, advisors and consultants should conduct your own investigation of the property and transaction.