



ARES
INDUSTRIAL
MANAGEMENT

TUALATIN DISTRIBUTION CENTER

12220-12370 SW CIMINO ST, TUALATIN, OR, 97062

±86,481 Leasable SQ FT | Class A Warehouse Facility

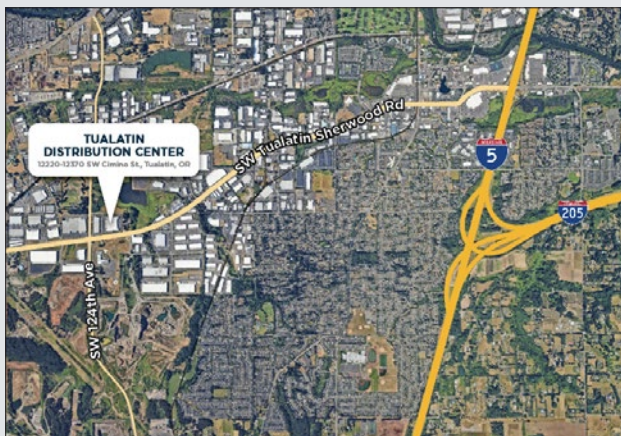

BUILDING HIGHLIGHTS

- ±86,481 SF with ±8,000 SF of Office
- 32' minimum Clear Height
- Cross-Loaded; 20 Dock; 2 Grade
- 600 Amp, 277/480V, 3-Phase power
- LED Lighting + Warehouse Skylights
- ESRF Sprinklers
- 7" reinforced, 4,000 PSI concrete floor
- 3 miles to I-5

Please call for lease rates & availability

AARON WATT
Executive Managing Director
+1 503 279 1779
aaron.watt@cushwake.com

KEEGAN CLAY
Executive Director
+1 503 279 1704
keegan.clay@cushwake.com





**ARES
INDUSTRIAL
MANAGEMENT**

TUALATIN DISTRIBUTION CENTER

12220-12370 SW CIMINO ST, TUALATIN, OR, 97062

±86,481 Leasable SQ FT | Class A Warehouse Facility

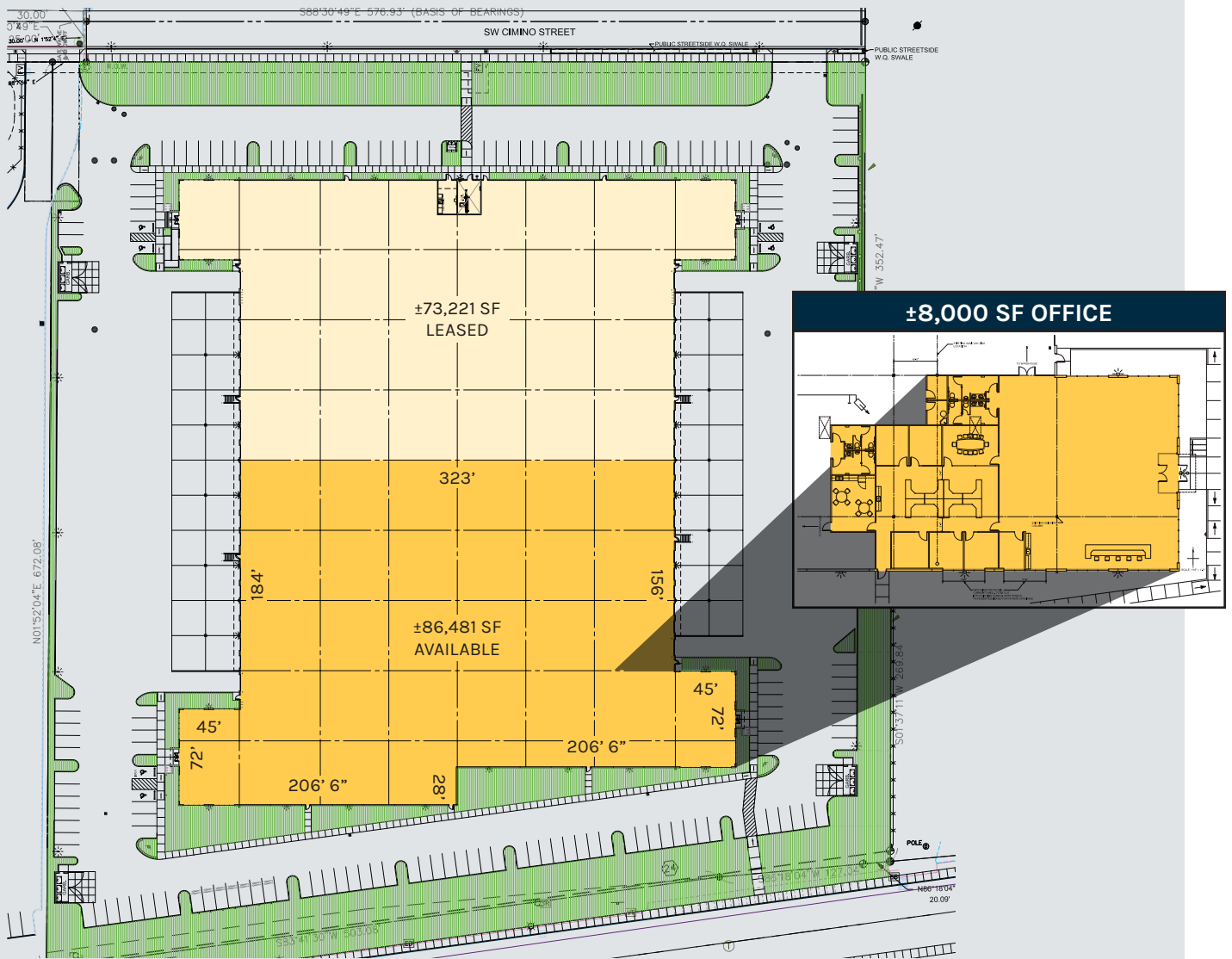

AARON WATT
Executive Managing Director
+1 503 279 1779
aaron.watt@cushwake.com

KEEGAN CLAY
Executive Director
+1 503 279 1704
keegan.clay@cushwake.com

