

MEDICAL/OFFICE SUITES FOR LEASE  
2145 & 2225 E. TAHQUITZ  
PALM SPRINGS, CA

**LEE & ASSOCIATES**  
COMMERCIAL REAL ESTATE SERVICES

Exterior  
Renovations  
Done!



- Excellent location in the heart of Palm Springs near Palm Springs City Hall, Palm Springs Courthouse & Desert Regional Medical Center
- Flexible suite sizes ranging from ±918 SF to ±3,645 SF
- Tenant improvement allowance available for qualified, long-term tenants
- Zoned for medical
- Ample parking



**MAGGIE MONTEZ**  
mmontez@leedesert.com  
760.346.2520  
LIC #01070683

**SHAWNA STRANGE**  
sstrange@leedesert.com  
760.346.2533  
LIC #01718495

All information furnished regarding property for sale, rental or financing is from sources deemed reliable, but no warranty or representation is made to the accuracy thereof and same is submitted to errors, omissions, change of price, rental or other conditions prior to sale, lease or financing or withdrawal without notice. No liability of any kind is to be imposed on the broker herein.



MEDICAL/OFFICE SUITES FOR LEASE  
**2145 & 2225 E. TAHQUITZ**  
PALM SPRINGS, CA

**2145 BUILDING FLOOR PLAN**

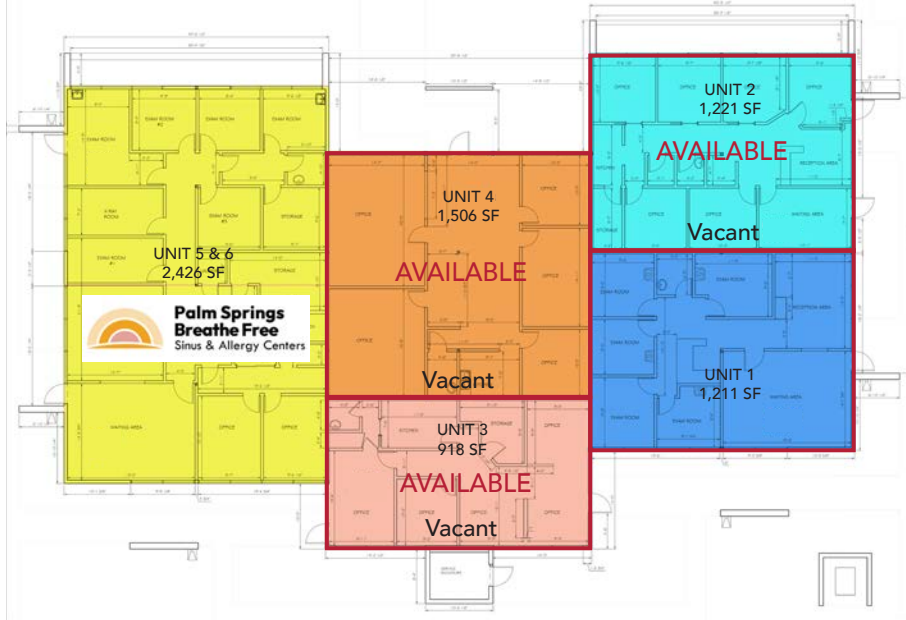

**2225 BUILDING FLOOR PLAN**

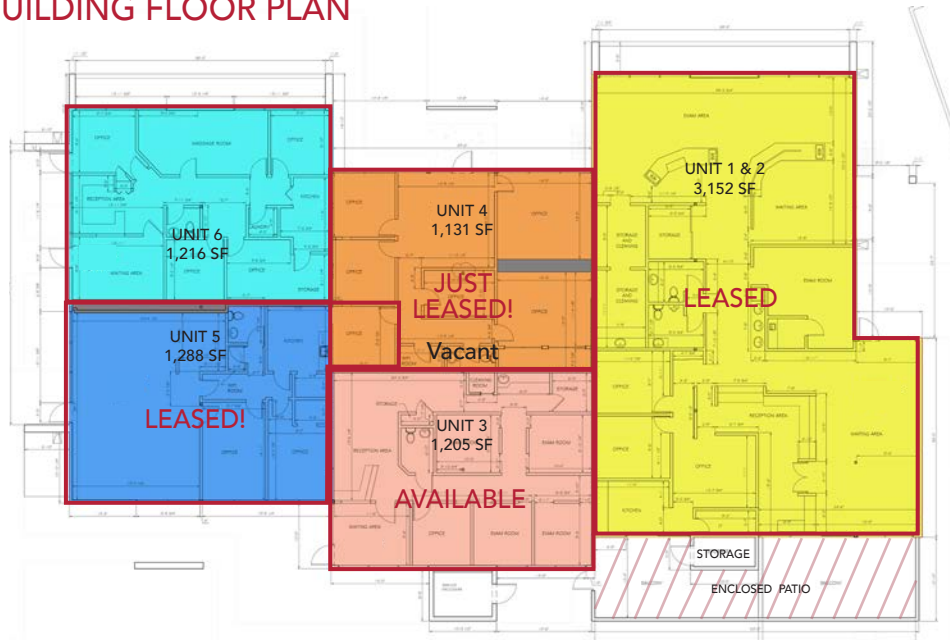

**MAGGIE MONTEZ**  
mmontez@leedesert.com  
760.346.2520  
LIC #01070683

**SHAWNA STRANGE**  
sstrange@leedesert.com  
760.346.2533  
LIC #01718495

All information furnished regarding property for sale, rental or financing is from sources deemed reliable, but no warranty or representation is made to the accuracy thereof and same is submitted to errors, omissions, change of price, rental or other conditions prior to sale, lease or financing or withdrawal without notice. No liability of any kind is to be imposed on the broker herein.

MEDICAL/OFFICE SUITES FOR LEASE  
**2145 & 2225 E. TAHQUITZ**  
PALM SPRINGS, CA



**MAGGIE MONTEZ**  
mmontez@leedesert.com  
760.346.2520  
LIC #01070683

**SHAWNA STRANGE**  
sstrange@leedesert.com  
760.346.2533  
LIC #01718495

All information furnished regarding property for sale, rental or financing is from sources deemed reliable, but no warranty or representation is made to the accuracy thereof and same is submitted to errors, omissions, change of price, rental or other conditions prior to sale, lease or financing or withdrawal without notice. No liability of any kind is to be imposed on the broker herein.