



*Property Summary*



**DAILY TRAFFIC CONDITIONS**

TRAFFIC COUNT	DAILY TRAFFIC
COUNT	49,595
STREET	N. Prospect Ave.

\* Figures shown represent estimates

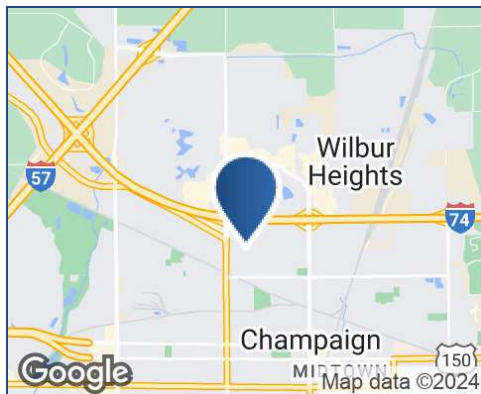

**DEMOGRAPHICS - 2024**

DEMOGRAPHICS	1 MILE	3 MILE	5 MILE
Estimated Population	11,741	93,970	142,837
Average HH Income	\$96,372	\$74,702	\$93,932
Estimated Households	5,596	38,434	60,253

**PROPERTY HIGHLIGHTS**

- Located in the Champaign-Urbana Region - next to The Home Depot
- Located just off the prominent intersection of I-74 and Prospect Ave. with two signals at the property
- Excellent visibility from I-74 on Champaign's strongest retail corridor
- Join major retailers on Prospect Ave. or nearby including Target, Ashley, Sam's Club, Ross Dress For Less, Best Buy, Meijer, AMC, Walmart, Kroger, Office Depot Office Max, HomeGoods, Costco Wholesale, Hobby Lobby, Kohl's, Dick's, Barnes & Noble, and more



**KEITH VALENTINE**      **JAY SIKORSKI**  
 678.718.1882              217.352.7712  
 KValentine@retail-pa.com      jas@cbcdr.com

Retail Property Advisors // 678.718.1880 // 2100 RiverEdge Pkwy. // Suite 1050, Atlanta, GA 30328 // Retail-PA.com

ATLANTA // TAMPA // PASADENA, CA // AUBURN // SARASOTA // BALTIMORE

No warranty or representation, expressed or implied, is made as to the accuracy of the information contained herein, and same is submitted subject to errors, omissions, change of price, rental or other conditions, withdrawal without notice, any special list conditions imposed by our Principals.



# ±57,581 SF CHAMPAIGN, IL

Bloomington Rd. & Hagan Rd., Champaign, IL 61821

## Location Map

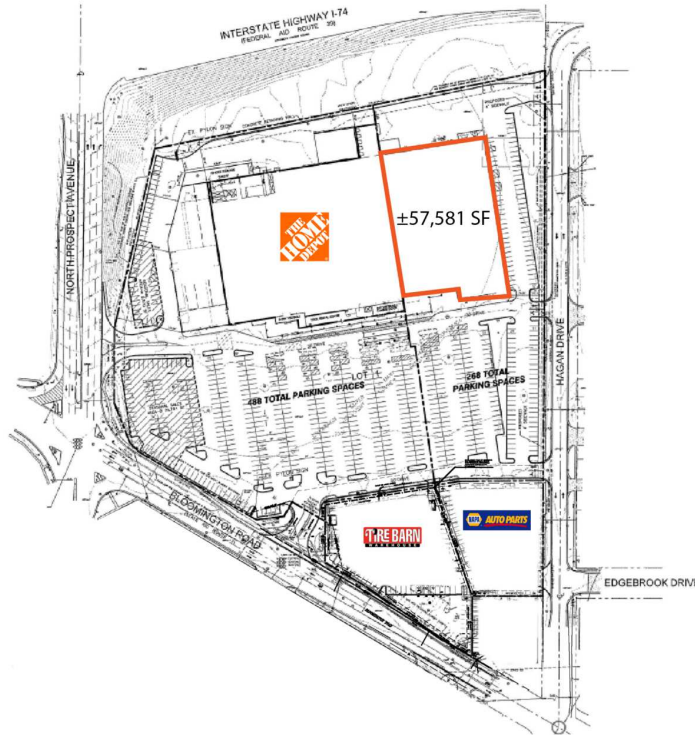
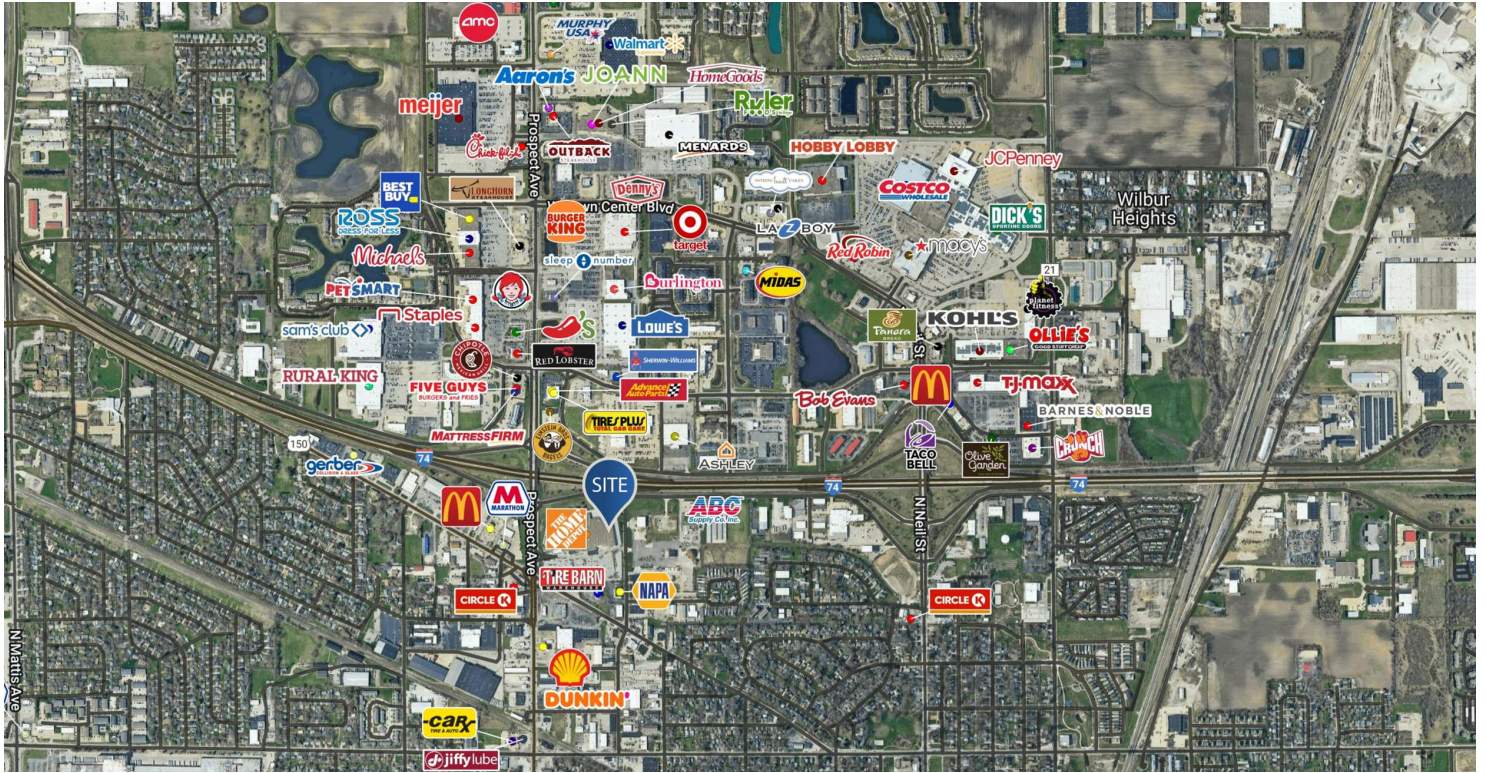

KEITH VALENTINE  
678.718.1882  
KValentine@retail-pa.com

JAY SIKORSKI  
217.352.7712  
jas@cbcdr.com

Retail Property Advisors // 678.718.1880 // 2100 RiverEdge Pkwy. // Suite 1050, Atlanta, GA 30328 // Retail-PA.com

ATLANTA // TAMPA // PASADENA, CA // AUBURN // SARASOTA // BALTIMORE

No warranty or representation, expressed or implied, is made as to the accuracy of the information contained herein, and same is submitted subject to errors, omissions, change of price, rental or other conditions, withdrawal without notice, any special list conditions imposed by our Principals.