

5993 E. FOURTEEN MILE ROAD
STERLING HEIGHTS, MICHIGAN



**SIGNATURE
ASSOCIATES**
KNOW SIGNATURE | KNOW RESULTS

INDUSTRIAL FOR LEASE
11,954 Square Feet Available

BRAND NEW CONSTRUCTION



PROPERTY FEATURES

- 11,954 square feet available
- 1,280 square feet office
- 22' clear height
- (2) 12' x 14' grade level doors
- Zoned M-1
- New everything
- Concrete parking lot
- Tremendous frontage on Fourteen Mile in the Mound Road Corridor
- Lease Rate: \$11.95/sq. ft. NNN



For more information, please contact:

BEN WILKIEMEYER
(248) 359 0624
bwilkiemeyer@signatureassociates.com

MARVIN PETROUS
(248) 359 0647
mpetrous@signatureassociates.com

SIGNATURE ASSOCIATES
One Towne Square, Suite 1200
Southfield, MI 48076
www.signatureassociates.com

5993 E. Fourteen Mile Road – Sterling Heights, Michigan Industrial For Lease

11,954
Square Feet
AVAILABLE

Site Plan

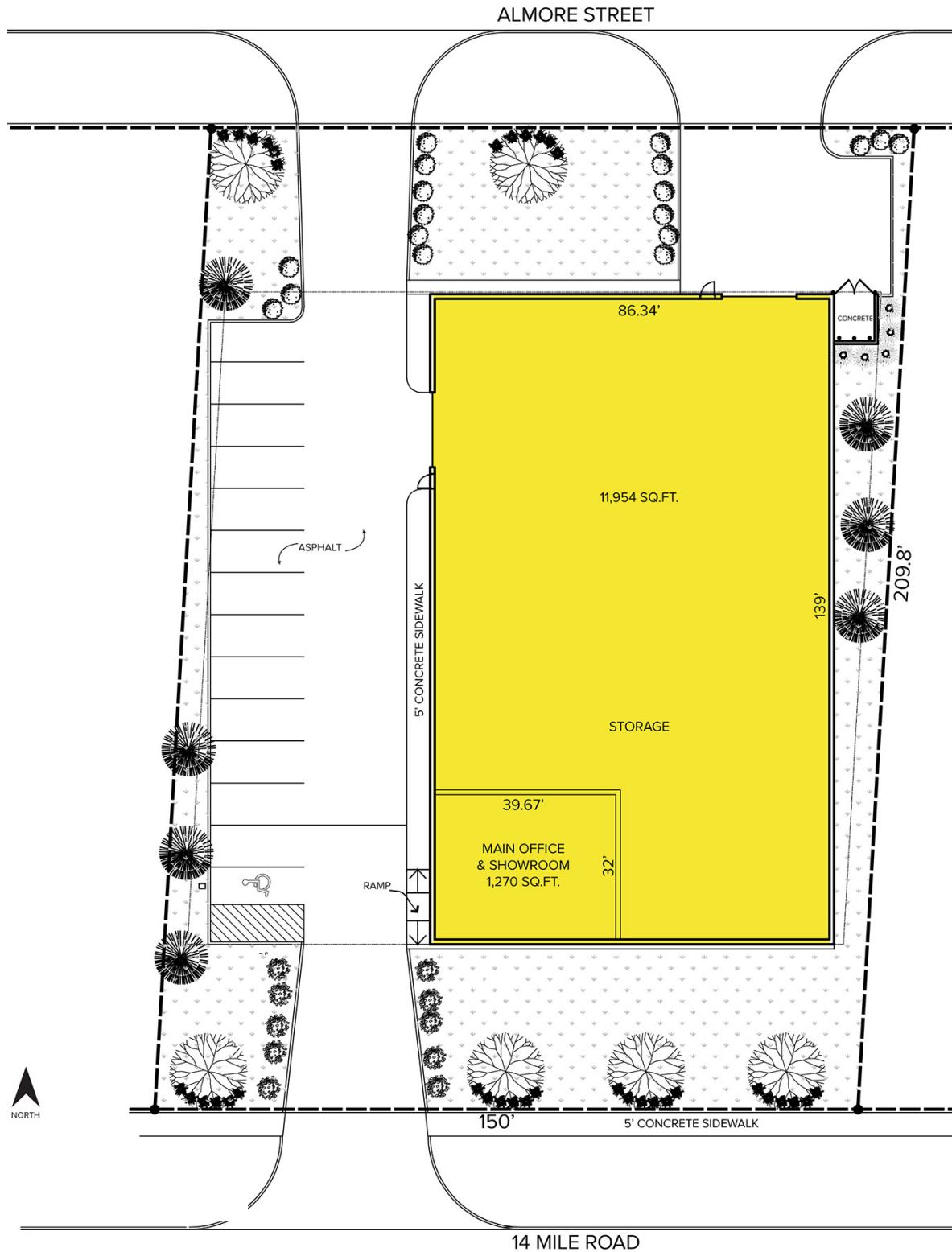

For more information, please contact:

BEN WILKIEMEYER

(248) 359 0624

bwilkiemeyer@signatureassociates.com

MARVIN PETROUS

(248) 359 0647

mpetrous@signatureassociates.com

SIGNATURE ASSOCIATES

One Towne Square, Suite 1200

Southfield, MI 48076

www.signatureassociates.com

5993 E. Fourteen Mile Road – Sterling Heights, Michigan

Industrial For Lease

11,954
Square Feet
AVAILABLE

Floor Plan

ALMORE ROAD

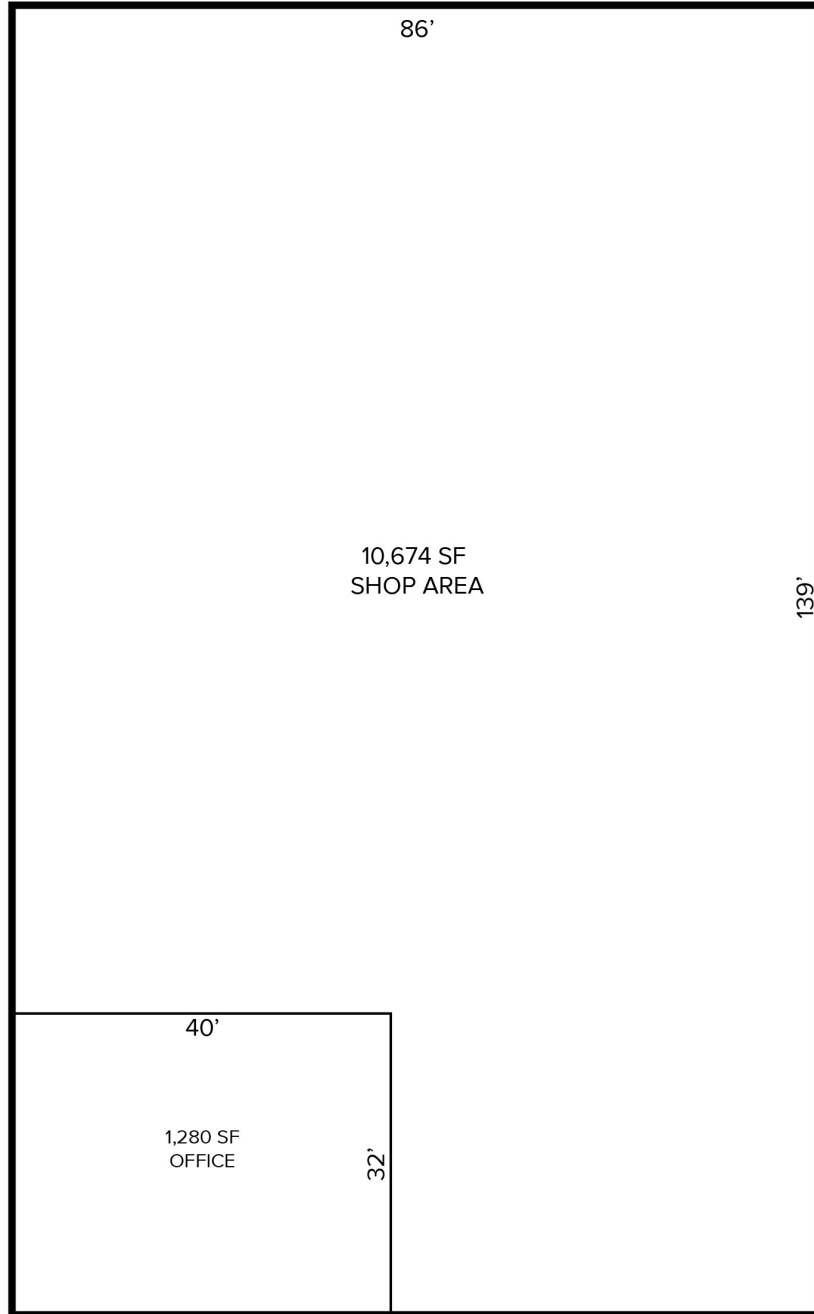

14 MILE ROAD



NORTH

For more information, please contact:

BEN WILKIEMEYER

(248) 359 0624

bwilkiemeyer@signatureassociates.com

MARVIN PETROUS

(248) 359 0647

mpetrous@signatureassociates.com

SIGNATURE ASSOCIATES

One Towne Square, Suite 1200

Southfield, MI 48076

www.signatureassociates.com

5993 E. Fourteen Mile Road – Sterling Heights, Michigan

Industrial For Lease

11,954
Square Feet
AVAILABLE

Aerial



For more information, please contact:

BEN WILKIEMEYER
(248) 359 0624
bwilkiemeyer@signatureassociates.com

MARVIN PETROUS
(248) 359 0647
mpetrous@signatureassociates.com

SIGNATURE ASSOCIATES
One Towne Square, Suite 1200
Southfield, MI 48076
www.signatureassociates.com