

ILIFF BUSINESS PARK

OFFICE/WAREHOUSE SPACE FOR LEASE



S. TRENTON WAY
&
E. ILIFF AVE.
DENVER, CO 80231



AVAILABILITY INFORMATION

AVAILABLE:	Suite G
SIZE:	4,074 SF
CLEAR HEIGHT:	12' - 13'
LOADING:	One (1) Drive-In
ELECTRICAL:	3-Phase
SPRINKLER:	None
RATE:	\$13.50/SF NNN
EXPENSES:	\$5.63/SF (Est. for 2026)
POWER:	To Be determined
HVAC:	Fully Conditioned

HIGHLIGHTS

- Iliff Business Park offers excellent individual signage
- Abundant parking and great access to I-25 and I-225
- Located in Unincorporated Arapahoe County
- Aggressive and creative ownership
- Multiple large contiguous options



CODY SHEESLEY
+1 303 309 3520
cody.sheesley@colliers.com

T.J. SMITH, SIOR
+1 303 283 4576
tj.smith@colliers.com



2452 S. TRENTON WAY | SUITE G | DENVER, CO 80231

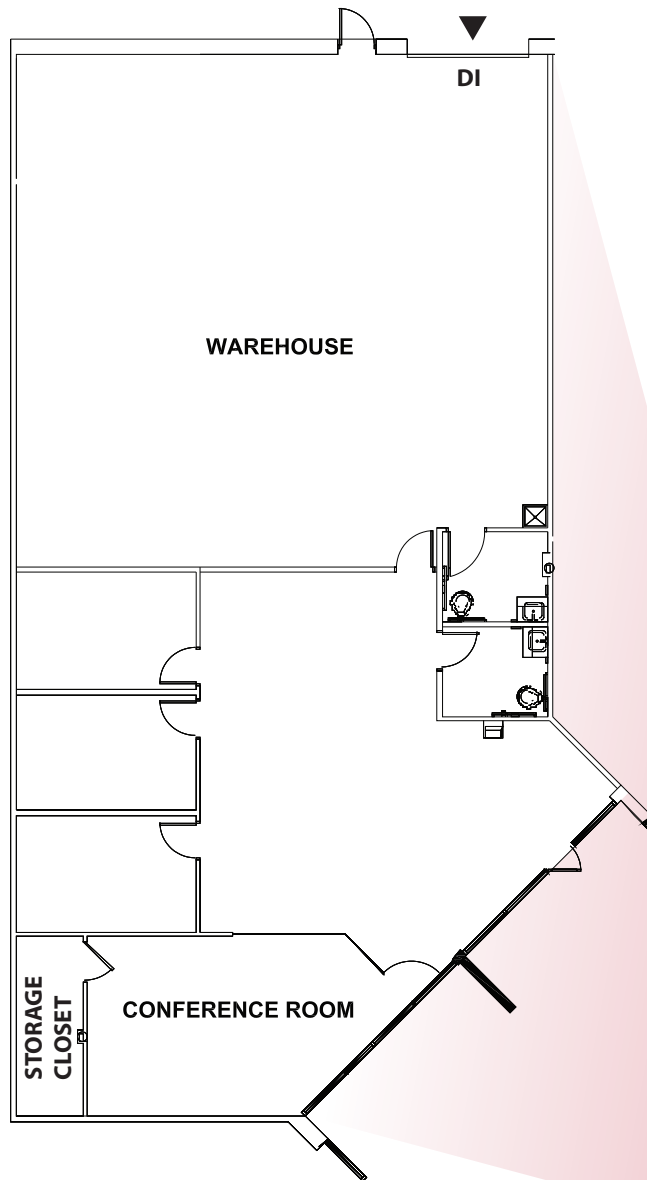

FLOOR PLAN

Suite G
4,074 SF



COLLIERS DENVER

4643 S. Ulster Street | Suite 1000 | Denver, CO 80237
+1 303 745 5800 fax +1 303 745 5888 | colliers.com/denver

No warranty or representation is made as to the accuracy of the foregoing information.
Terms of sale or lease and availability are subject to change or withdrawal without notice.

BROKER DISCLOSURE

