



FOR SUBLEASE | CHESTERFIELD VILLAGE 1 - OFFICE SPACE

**16090 SWINGLEY RIDGE RD**

CHESTERFIELD, MO 63017



FOR SUBLEASE | CHESTERFIELD VILLAGE 1 - OFFICE SPACE

# 16090 SWINGLEY RIDGE RD

CHESTERFIELD, MO 63017

Brandon Wappelhorst, CCIM, SIOR  
bwappelhorst@sansonegroup.com

Tom Bajardi, CCIM, SIOR  
tbajardi@sansonegroup.com

Nick Fiquette, CCIM, SIOR  
nfiquette@sansonegroup.com

## Property Features

- 10,909 RSF
- Occupancy date 5/1/2026
- Sublease through 12/31/2029
- High end build out, fully furnished
- Conference/training room
- Fitness center
- Tenant lounge
- Self-serve fresh food market
- Parking ratio 4.0/1,000
- **Contact broker for pricing**



314.727.6664

[SANSONEGROUP.COM](https://www.sansonegroup.com)

120 S. Central Ave. | Ste. 500 | St. Louis, MO 63105

The information contained herein is not warranted, although it has been obtained from the owner of the property or from other sources that we deem reliable. It is subject to change without notice. Seller and broker make no representation as to the environmental condition of the property and recommend purchaser's independent investigation.

FOR SUBLEASE | CHESTERFIELD VILLAGE 1 - OFFICE SPACE

# 16090 SWINGLEY RIDGE RD

CHESTERFIELD, MO 63017

Brandon Wappelhorst, CCIM, SIOR  
bwappelhorst@sansonegroup.com

Tom Bajardi, CCIM, SIOR  
tbajardi@sansonegroup.com

Nick Fiquette, CCIM, SIOR  
nfiquette@sansonegroup.com

## Floor Plan | 10,909 RSF Available

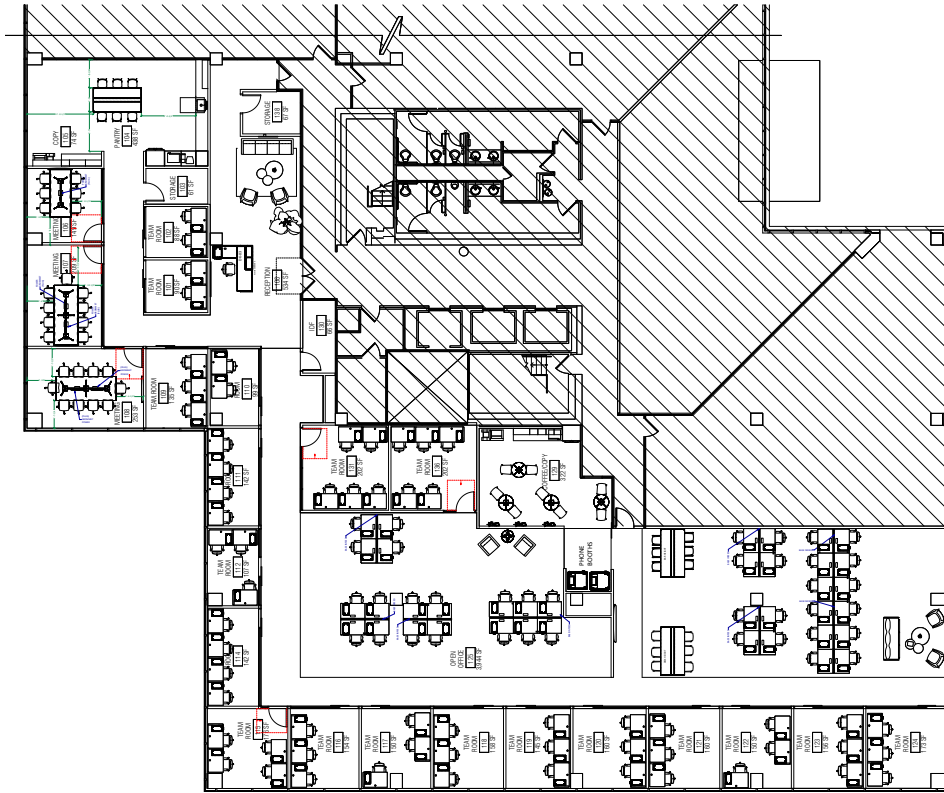

## Site Map

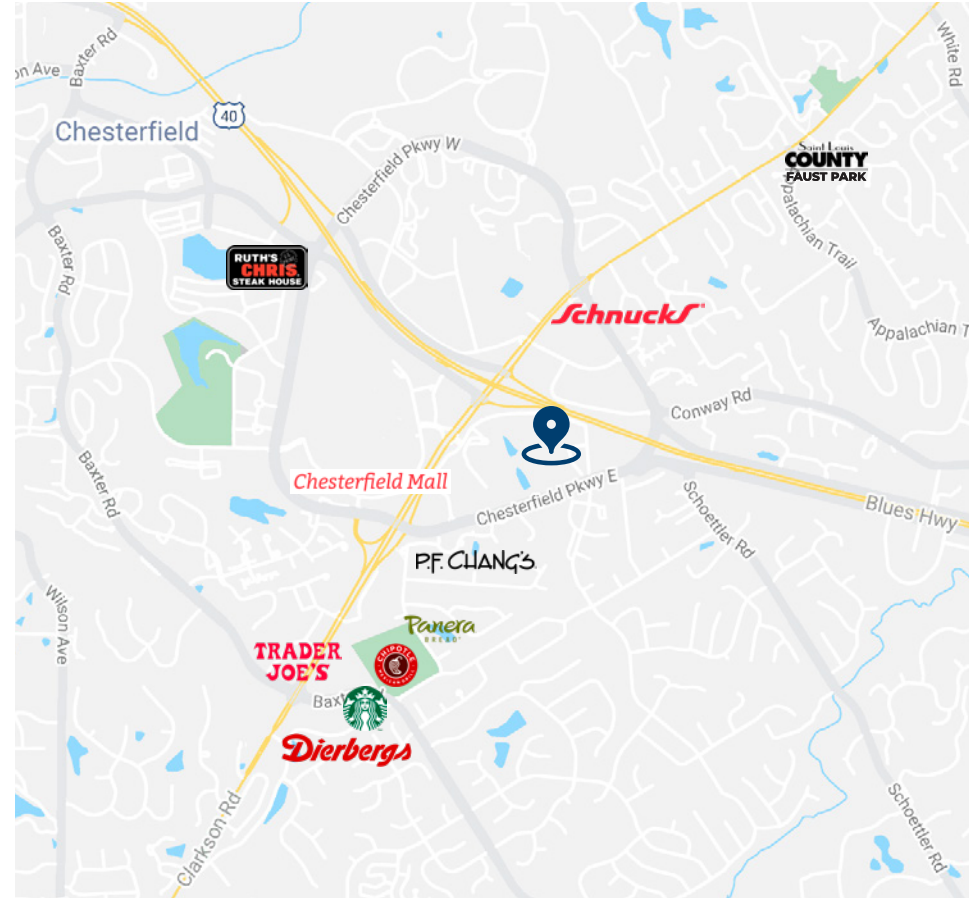

314.727.6664

[SANSONEGROUP.COM](http://SANSONEGROUP.COM)

120 S. Central Ave. | Ste. 500 | St. Louis, MO 63105

The information contained herein is not warranted, although it has been obtained from the owner of the property or from other sources that we deem reliable. It is subject to change without notice. Seller and broker make no representation as to the environmental condition of the property and recommend purchaser's independent investigation.