



AVAILABLE FOR LEASE

2353 CEPHEUS COURT  
**BAKERSFIELD, CA**



# FOR LEASE

## 2353 CEPHEUS COURT



Available February 1, 2026

Concrete tilt-up industrial building located in the fast-growing Airport submarket.

Close proximity to a variety of amenities—restaurants, gas stations, hotels, and other industrial users—providing convenience for user.

Ample parking space, with a fully fenced, paved yard.

Easy access to/from major transportation hubs—Hwy 99, Hwy 65, and I-5 via 7th Standard Road.

### PROPERTY HIGHLIGHTS

<b>Total Available:</b>	±6,000 SF
<b>Office:</b>	±2,220 SF
<b>Lot Size:</b>	0.75 Acres
<b>Clear Height:</b>	14' - 16'
<b>Loading:</b>	(1) 12' x 12' Roll-Up Door
<b>Power:</b>	400 Amps, 480/277 V, 3 Ph
<b>Zoning:</b>	M-2 PD H, County of Kern
<b>Asking Rent:</b>	\$1.35psf/month + CAMs, Industrial Gross



# FOR LEASE

# 2353 CEPHEUS COURT



SITE PLAN

FLOOR PLAN

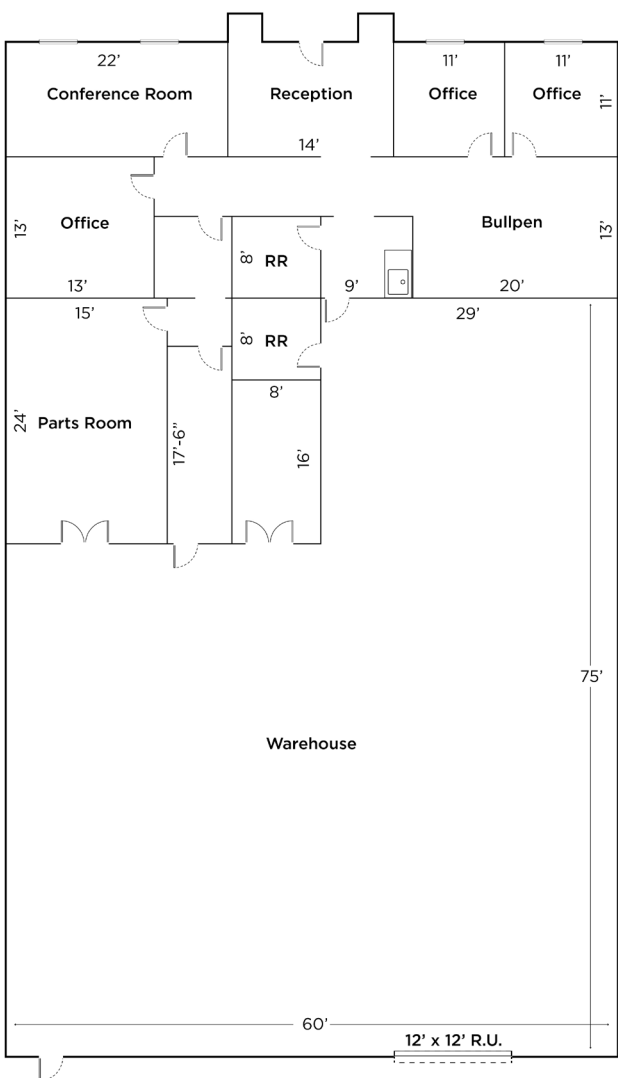
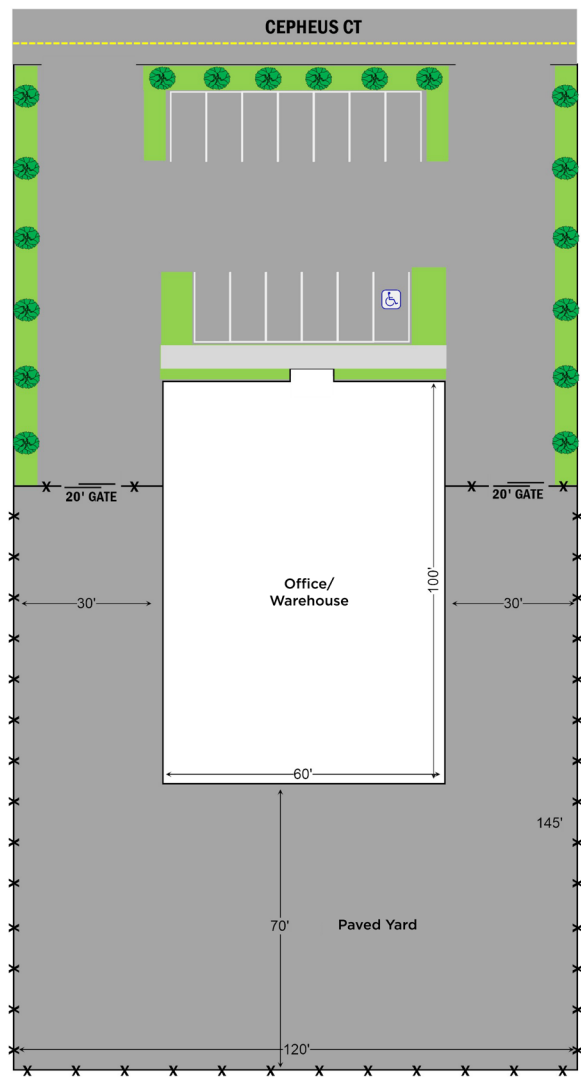



# FOR LEASE

## 2353 CEPHEUS COURT







**For more information, please contact:**

**Wayne Kress, SIOR**

Executive Director  
wayne.kress@cushwake.com  
+1 661 706 5692  
Lic. #00834680

**Coby Vance**

Senior Director  
coby.vance@cushwake.com  
+1 661 203 4400  
Lic. #01449929

**Scott Reynolds**

Director  
scott.reynolds@cushwake.com  
+1 661 330 7616  
Lic. #01382493

5060 California Ave, Suite 1000  
Bakersfield, CA  
PH: +1 661 327 2263  
cushmanwakefield.com  
Lic. #01880493

©2025 Cushman & Wakefield. All rights reserved. The information contained in this communication is strictly confidential. This information has been obtained from sources believed to be reliable but has not been verified. NO WARRANTY OR REPRESENTATION, EXPRESS OR IMPLIED, IS MADE AS TO THE CONDITION OF THE PROPERTY (OR PROPERTIES) REFERENCED HEREIN OR AS TO THE ACCURACY OR COMPLETENESS OF THE INFORMATION CONTAINED HEREIN, AND SAME IS SUBMITTED SUBJECT TO ERRORS, OMISSIONS, CHANGE OF PRICE, RENTAL OR OTHER CONDITIONS, WITHDRAWAL WITHOUT NOTICE, AND TO ANY SPECIAL LISTING CONDITIONS IMPOSED BY THE PROPERTY OWNER(S). ANY PROJECTIONS, OPINIONS OR ESTIMATES ARE SUBJECT TO UNCERTAINTY AND DO NOT SIGNIFY CURRENT OR FUTURE PROPERTY PERFORMANCE.

