



50' CLEAR



GREAT LOCATION



FEATURES

- Build-to-Suit opportunity for 40,000-300,000± SF of Class A high-bay warehouse
- 22 Continental has conceptals for 125,000± SF
- 24 Continental has full site approval for 116,000± SF
- Both sites can be combined for a potential of 300,000± SF total
- Highly desirable location within the Seacoast
- Less than a mile to Route 101 with lighted access
- With a variance, clear height can go to 60'
- Flexibility to customize space
- LEASE RATE: Starting at \$13.75/SF NNN (Estimated Base Building)
- Contact broker for estimated NNN expenses.
- SALE PRICE: Contact broker for details.



RENDERINGS



OPTIONS:

22 CONTINENTAL DRIVE

- Up to 40,000 - 125,000± SF
- Conceptual plan in place
- 240' x 480' building

24 CONTINENTAL DRIVE

- Up to 40,000 - 116,000± SF
- Full site plan approval in place

22 - 24 CONTINENTAL DRIVE

- Up 300,000± SF
- Conceptual plan in place

- Up to 40,000 - 300,000± SF
- Conceptual plan in place
- 50' clear height
- (12) Loading docks
- Municipal water/sewer and natural gas
- Base building spec of 5% air-conditioned office space
- Ample parking for trailers and cars
- Zoned industrial/commercial
- Lease Rate: Starting at \$13.75



PLANS

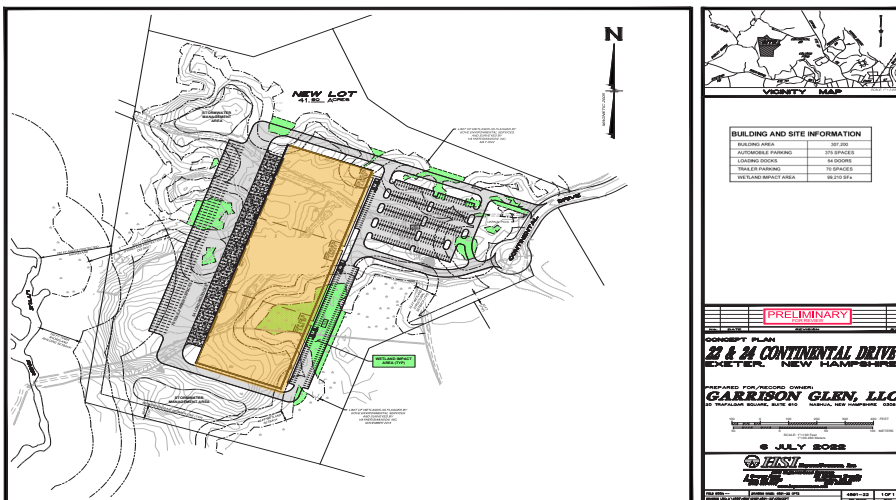
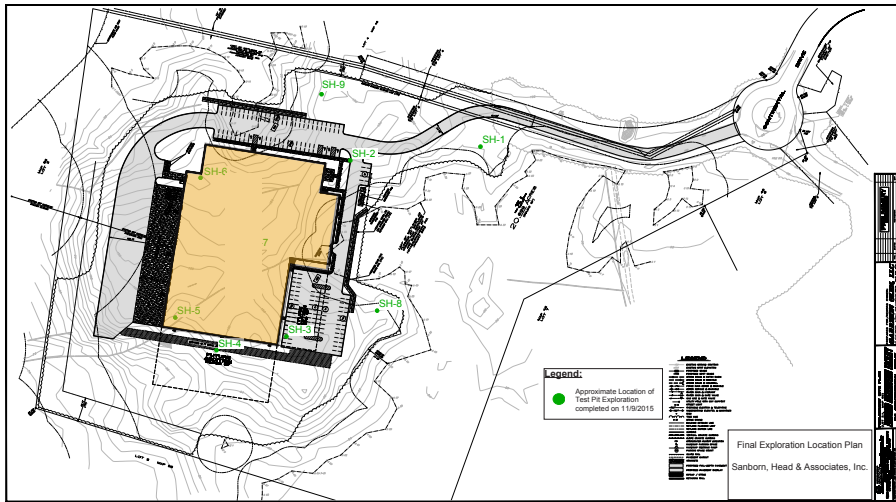
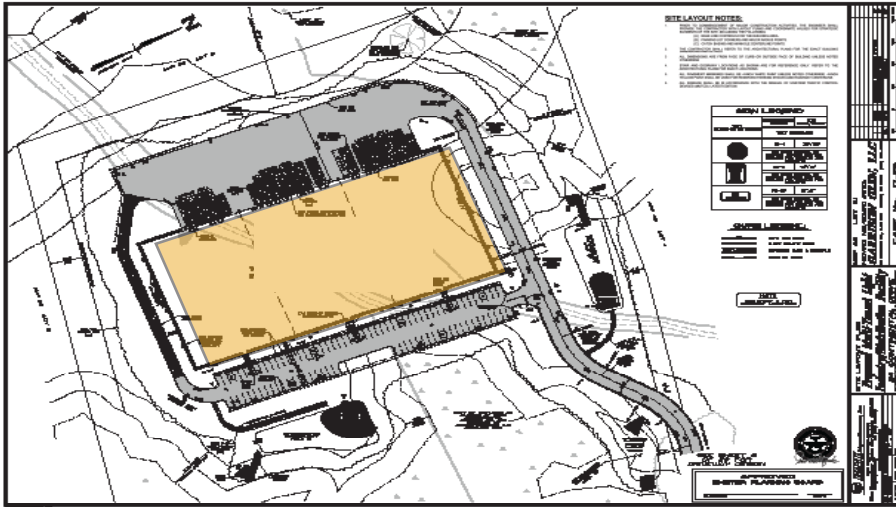

FOR SALE OR LEASE | BUILD-TO-SUIT WAREHOUSE/MANUFACTURING

22 - 24 CONTINENTAL DRIVE, EXETER, NH 03833



DRIVE TIMES

ROUTE 101	1 MIN
PORTSMOUTH, NH	23 MIN
CONCORD, NH	42 MIN
MANCHESTER, NH	30 MIN
NASHUA, NH	48 MIN
PORTLAND, ME	1 HR 5 MIN
BOSTON, MA	1 HR 12 MIN

22 - 24 Continental Drive
Exeter, NH



CONTACT US



CHRISTIAN STALLKAMP
Senior Broker | Partner
+1 603.828.3818 C
+1 603.570.2696 D
cstallkamp@boulos.com



Michael Tamposi
Partner
+1 603.315.4348 C
+1 603.333.1333 D
mtamposi@boulos.com

©2023 Boulos Holdings, LLC d/b/a The Boulos Company. All rights reserved. This information has been obtained from sources believed reliable, but has not been verified for accuracy or completeness. You should conduct a careful, independent investigation of the property and verify all information. Any reliance on this information is solely at your own risk. The Boulos Company and The Boulos Company logo are service marks of The Boulos Company, Inc. and Boulos Holdings, LLC. All other marks displayed on this document are the property of their respective owners. Photos herein are the property of their respective owners. Use of these images without the express written consent of the owner is prohibited.