



# For sublease

1934 W. Beaver St.  
Jacksonville, FL

Full building  
±32,760 SF

September 2029 expiration

## Property specifications

- ±32,760 SF
- ±3,276 SF office
- Fully fenced ±3.05 ac. site
- Zoned IL
- Built in 1996
- Five dock doors
- Two oversized (20' x 20') drive-ins
- Pitched roof with 27'-31' clear
- 40' x 40' column spacing
- Truck scale on-site

### Ben Easton

Associate

[ben.easton@jll.com](mailto:ben.easton@jll.com)

+1 904 559 3908

### Cole Broussard

Associate

[cole.broussard@jll.com](mailto:cole.broussard@jll.com)

+1 904 559 3924

### Ross Crabtree

Managing Director

[ross.crabtree@jll.com](mailto:ross.crabtree@jll.com)

+1 904 559 3915

# For sublease

32,760 SF industrial space

Prime Westside Location

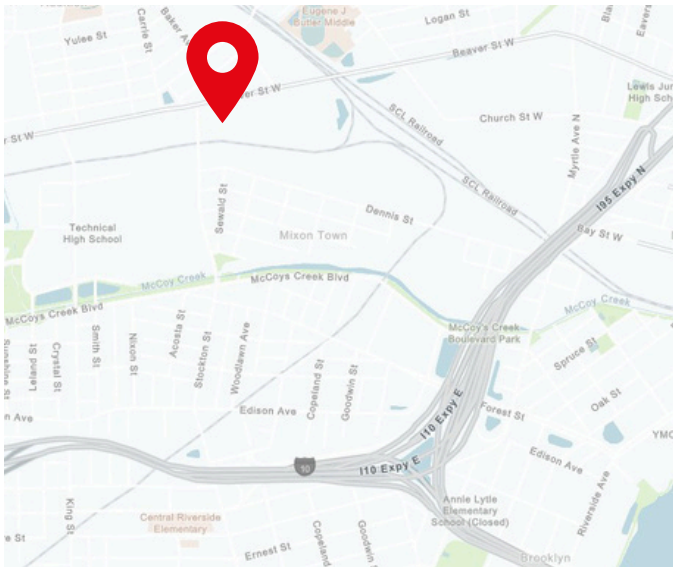

## Location highlights

- Located at the intersection of Beaver St. and Stockton St.
- Highly accessible Westside location
- Quick access to Downtown Jacksonville
- Direct access to I-95 & I-10

**1.3**

miles to I-95

**1.7**

miles to I-10

**5**

miles to I-295

**5.7**

miles to  
JaxPort Tallyrand

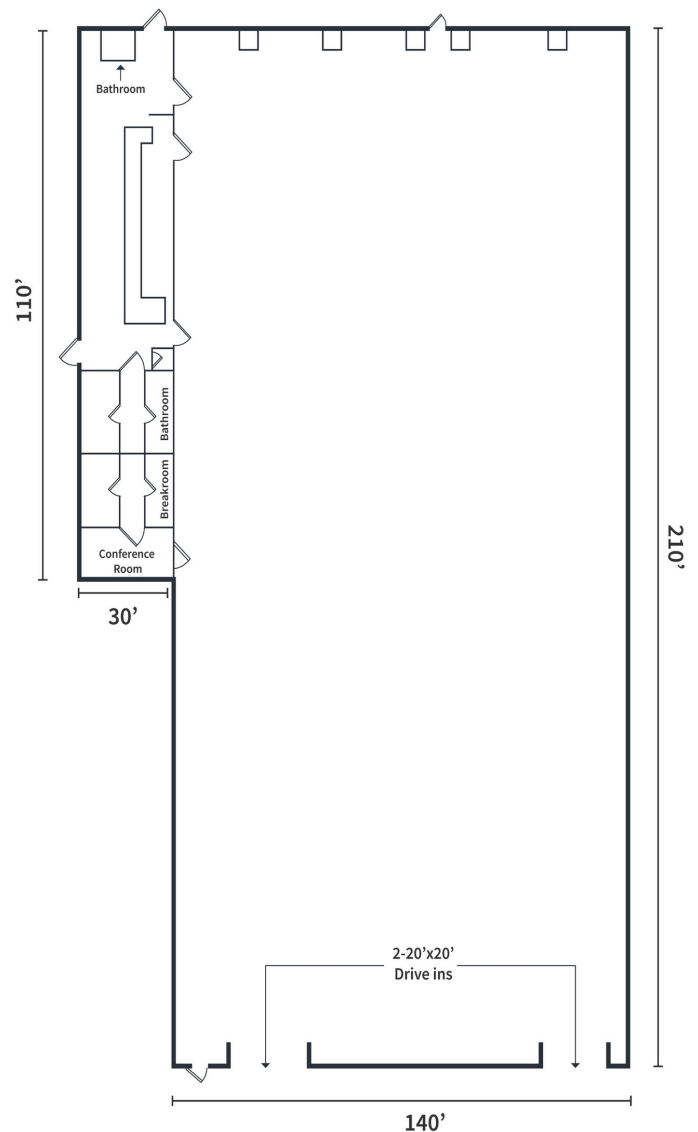

**Ben Easton**  
Associate  
ben.easton@jll.com  
+1 904 559 3908

**Cole Broussard**  
Associate  
cole.broussard@jll.com  
+1 904 559 3924

**Ross Crabtree**  
Managing Director  
ross.crabtree@jll.com  
+1 904 559 3915